

STATE OF ILLINOIS  
DEPARTMENT OF TRANSPORTATION  
DIVISION OF HIGHWAYS

**PROPOSED  
HIGHWAY PLANS**

**SURFACE TRANSPORTATION URBAN PROGRAM  
FAU ROUTE 6106 (BUCKLIN AVENUE)  
SECTION 08-00076-00-RP  
PROJECT NO.: M-5036 (023)  
PAVEMENT RECONSTRUCTION  
CITY OF LASALLE  
LASALLE COUNTY  
JOB NO.: C-93-103-09**

F. A. U. NO.	SECTION	COUNTY	TOTAL SHEETS	SHEET NO.
6106	08-00076-00-RP	LASALLE	10	1
STA.	TO STA.			
FED. ROAD DIST. NO. 3	ILLINOIS	FED. AID PROJECT	M-5036(023)	

CONTRACT #87395

**INDEX OF SHEETS**

1. COVER SHEET
2. GENERAL NOTES & TYPICAL SECTIONS
3. SUMMARY OF QUANTITIES
- 4.-6. PLAN AND PROFILES
- 7.-9. INTERSECTION DETAILS
10. CONSTRUCTION DETAILS

**HIGHWAY STANDARDS**

- |             |   |
|-------------|---|
| 000001-05   | STANDARD SYMBOLS, ABBREVIATIONS, AND PATTERNS                 |
| 001001-02   | AREAS OF REINFORCEMENT BARS                                   |
| 420001-07   | PAVEMENT JOINTS   |
| 420101-04   | 24' (7.2m) JOINTED PCC PAVEMENT                               |
| 420111-02   | PCC PAVEMENT ROUNDOUTS  |
| 424001-05   | CURB RAMPS FOR SIDEWALKS                                      |
| 606001-04   | CONC. CURB TYPE B AND COMBINATION CONC. CURB AND GUTTER       |
| 701501-05   | URBAN LANE CLOSURE, 2L, 2W, UNDIVIDED                         |
| 701801-04   | LANE CLOSURE MULTILANE 1W OR 2W CROSSWALK OR SIDEWALK CLOSURE |
| 701901-01   | TRAFFIC CONTROL DEVICES                                       |
| B.L.R. 10-6 | PCC PAVEMENT SPECIAL (NONREINFORCED)                          |

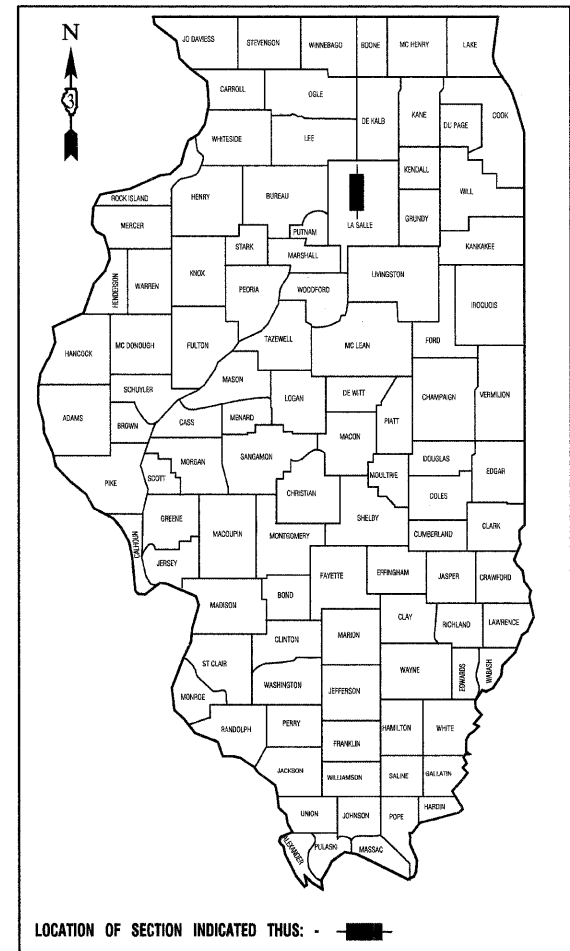

**FUNCTIONAL CLASSIFICATION  
URBAN COLLECTOR**

2030 ADT = 2,500  
P.V. = 95.0% S.U. = 5.0% M.V. = 0.0%

STATE OF ILLINOIS  
DEPARTMENT OF TRANSPORTATION  
DIVISION OF HIGHWAYS

SUBMITTED April 9 20 10  
Michael J. Furlan  
CITY ENGINEER

PASSED 4-9 20 10  
John J. [Signature]  
DISTRICT 3 IMPLEMENTATION ENGINEER

RELEASING FOR BID BASED ON LIMITED REVIEW  
4-9 20 10  
George Lynn [Signature]  
DEPUTY DIRECTOR OF HIGHWAYS, REGION 2 ENGINEER



PREPARED BY OR UNDER THE DIRECT SUPERVISION OF:

Michael J. Furlan  
Exp 11/30/2010

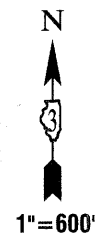

**END IMPROVEMENTS  
BUCKLIN AVENUE STA 41+62  
(AT O'CONNOR AVENUE)**

**BEGIN IMPROVEMENTS  
BUCKLIN AVENUE STA 16+46  
(AT ELEVENTH STREET)**

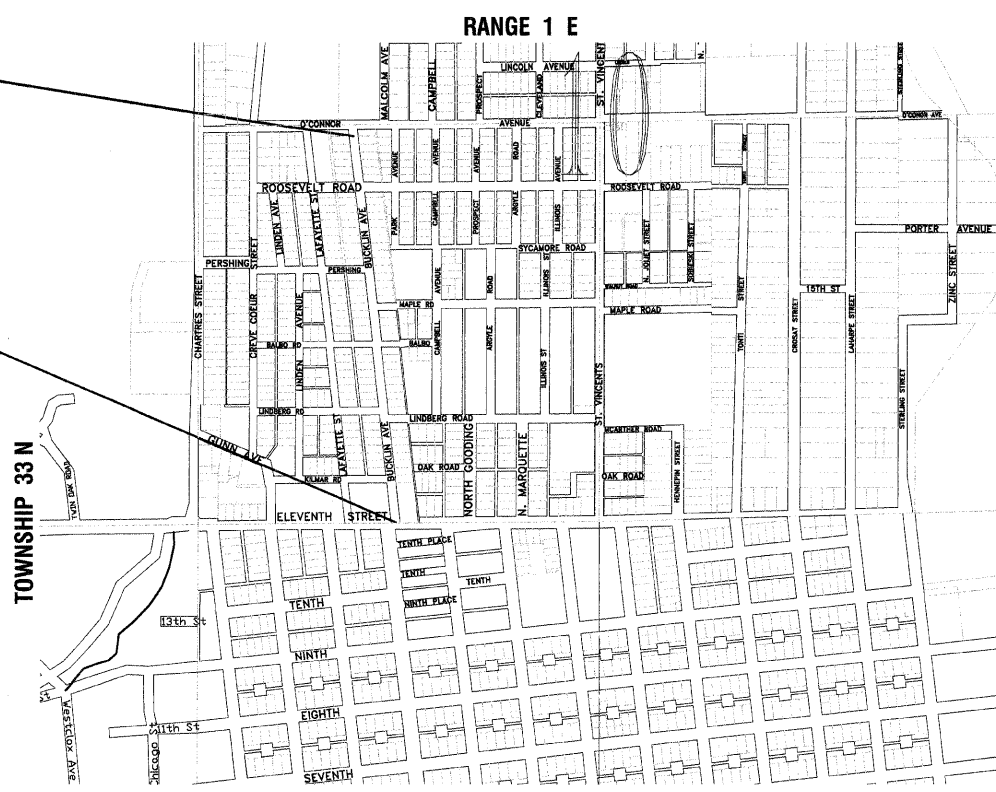

**LOCATION MAP**

GROSS LENGTH=2,523 FEET=0.48 MILES  
NET LENGTH=2,523 FEET=0.48 MILES

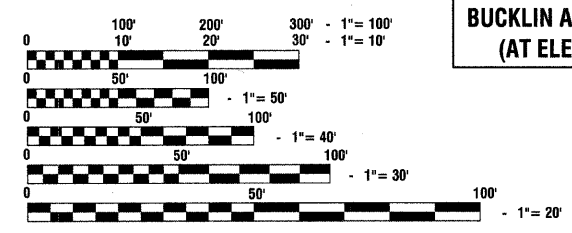

FULL SIZE PLANS HAVE BEEN PREPARED USING STANDARD ENGINEERING SCALES, REDUCED SIZED PLANS WILL NOT CONFORM TO STANDARD SCALES, IN MAKING MEASUREMENTS ON REDUCED PLANS, THE ABOVE SCALES MAY BE USED.

J. U. L. I. E.  
JOINT UTILITY LOCATION INFORMATION FOR EXCAVATION  
1-800-892-0123 or 811

I.D.O.T. FEDERAL AID DESIGN ENGINEER.  
CONSULTANTS: ROBINSON ENGINEERING, LTD. 708-331-6700 10245-COVR-01 - COVER

**CONTRACT NO. 87395**

**PRINTED BY THE AUTHORITY  
OF THE STATE OF ILLINOIS**

**GENERAL NOTES:**

- BEFORE STARTING ANY EXCAVATION, THE CONTRACTOR SHALL CALL "J.U.L.I.E." AT (800) 892-0123 FOR FIELD LOCATIONS OF BURIED ELECTRIC, TELEPHONE AND GAS UTILITIES. (48 HOUR NOTIFICATION IS REQUIRED).
- UTILITIES INDICATED ON THE PLANS ARE PROVIDED FOR THE CONTRACTORS USE AND ARE BASED UPON INFORMATION AVAILABLE AT THE TIME OF THE ADVERTISEMENT FOR BIDS. THE OWNER AND ENGINEER DO NOT GUARANTEE THE ACCURACY OF UTILITIES INFORMATION.
- IT SHALL BE THE CONTRACTOR'S RESPONSIBILITY TO VERIFY ALL DIMENSIONS AND CONDITIONS EXISTING IN THE FIELD PRIOR TO CONSTRUCTION AND ORDERING OF MATERIALS.
- ALL REFERENCES TO THE STANDARD SPECIFICATIONS THROUGHOUT THE PLANS SHALL BE INTERPRETED AS THE LATEST EDITION OF THE STANDARD SPECIFICATIONS FOR ROAD AND BRIDGE CONSTRUCTION FOR THE ILLINOIS DEPARTMENT OF TRANSPORTATION.
- THE CONTRACTOR SHALL PROTECT AND CAREFULLY PRESERVE ALL SECTION OR SUBSECTION MONUMENTS OR PROPERTY OR REFERENCE MARKERS UNTIL THE OWNER, HIS AGENT OR AN AUTHORIZED SURVEYOR HAS WITNESSED OR OTHERWISE REFERENCED THEIR LOCATIONS.
- THE CONTRACTOR SHALL COOPERATE WITH THE CITY IN ANY UNDERGROUND UTILITY CONSTRUCTION WHICH THE CITY MAY WANT TO PLACE DURING THE CONTRACTORS OPERATIONS.
- THE CONTRACTOR SHALL BE RESPONSIBLE FOR CONTACTING THE OWNERS OF ALL EXISTING FACILITIES SO THAT THE UTILITIES AND ALL THEIR APPURTENANCES MAY BE LOCATED AND ADJUSTED OR MOVED, IF NECESSARY, PRIOR TO THE START OF CONSTRUCTION OPERATIONS, THE CONTRACTOR SHALL COOPERATE WITH ALL UTILITY OWNERS AS PROVIDED FOR IN THE STANDARD SPECIFICATIONS.
- WHENEVER DURING CONSTRUCTION OPERATIONS ANY LOOSE MATERIAL IS DEPOSITED IN THE FLOW LINE OF DRAINAGE STRUCTURES SUCH THAT THE NATURAL FLOW OF WATER IS OBSTRUCTED, IT SHALL BE REMOVED AT THE CLOSE OF EACH WORKING DAY. AT THE CONCLUSION OF CONSTRUCTION OPERATIONS ALL DRAINAGE STRUCTURES SHALL BE FREE FROM DIRT AND DEBRIS. THE WORK SPECIFIED ABOVE WILL NOT BE PAID FOR SEPARATELY, BUT SHALL BE CONSIDERED AS INCIDENTAL TO THE CONTRACT.
- EXISTING ROAD SIGNS THAT INTERFERE WITH CONSTRUCTION WILL BE REMOVED OR RELOCATED AS DIRECTED BY THE ENGINEER. AFTER THE CONSTRUCTION IS COMPLETED, THE CONTRACTOR WILL REPLACE THE SIGNS AS DIRECTED BY THE ENGINEER. THIS WORK WILL NOT BE PAID SEPARATELY BUT SHALL BE CONSIDERED INCIDENTAL TO THE CONTRACT AND NO COMPENSATION WILL BE ALLOWED. ANY SIGNS DAMAGED BY THE CONTRACTOR SHALL BE REPLACED AT HIS EXPENSE.
- ABANDONED UNDERGROUND UTILITIES THAT CONFLICT WITH CONSTRUCTION SHALL BE DISPOSED OUTSIDE THE LIMITS OF THE RIGHT OF WAY ACCORDING TO ARTICLE 202.03 OF THE STANDARD SPECIFICATIONS AND AS DIRECTED BY THE ENGINEER. THIS WORK WILL NOT BE PAID FOR SEPARATELY BUT SHALL BE CONSIDERED INCIDENTAL TO EARTH EXCAVATION AND NO ADDITIONAL COMPENSATION WILL BE ALLOWED.
- EXPENSE INVOLVED IN CONNECTING PROPOSED SEWER TO EXISTING SEWER OR PROPOSED SEWER TO EXISTING SEWER STRUCTURES OR PROPOSED SEWER STRUCTURES TO EXISTING SEWER WITH A CONCRETE COLLAR OR AS SPECIFIED BY THE ENGINEER SHALL BE CONSIDERED INCIDENTAL TO THE ITEM BEING CONNECTED.
- ALL STEEL PLATES, FRAMES, GRATES, LIDS AND BOXES REMOVED FROM EXISTING WATER SERVICE OR SEWER STRUCTURES WHICH ARE TO BE ABANDONED OR ADJUSTED WITH A NEW OR DIFFERENT FRAME AND LID SHALL BE THE PROPERTY OF THE CONTRACTOR. NO ADDITIONAL COMPENSATION SHALL BE ALLOWED FOR STOCKPILING AND DISPOSAL OF THESE ITEMS.
- ALL FRAMES WITH CLOSED LIDS TO BE FURNISHED AS PART OF THIS CONTRACT FOR CONSTRUCTION, ADJUSTMENT OR RECONSTRUCTION OF ANY MANHOLE, CATCH BASIN, INLET, VALVE VAULT OR METER VAULT SHALL HAVE WORDING CAST INTO THE LID AS FOLLOWS:
  - ALL LIDS TO BE USED ON STORM SEWER STRUCTURES SHALL BEAR THE WORD STORM.
  - ALL LIDS TO BE USED ON SANITARY SEWER STRUCTURES SHALL BEAR THE WORD SANITARY.
  - ALL LIDS TO BE USED ON WATER SYSTEM STRUCTURES SHALL BEAR THE WORD WATER.
 THIS SHALL BE CONSIDERED INCIDENTAL TO THE FRAME AND CLOSED LID PROVIDED.
- SAWCUTTING OF EXISTING CURB AND GUTTER, SIDEWALK AND DRIVEWAYS REQUIRED FOR THE CONSTRUCTION OF THIS IMPROVEMENT SHALL NOT BE PAID FOR SEPARATELY, BUT SHALL BE CONSIDERED INCIDENTAL TO THE CONTRACT.
- SAWCUTTING OF CONCRETE PAVEMENT AND CURBS SHALL COMMENCE AS SOON AS THE CONCRETE HAS HARDENED SUFFICIENTLY TO PERMIT SAWING WITHOUT EXCESSIVE RAVELLING AND WITHIN SIX HOURS OF CONCRETE PLACEMENT. IN NO CASE SHALL CONCRETE BE ALLOWED TO SIT OVERNIGHT BEFORE SAWCUTTING COMMENCES.
- ALL RADII FOR PROPOSED CURB AND GUTTER OR PROPOSED CURB ARE TO THE BACK OF CURB AND SHALL BE AS SPECIFIED IN THE PLANS.
- SANITARY SEWER SHALL BE BACKFILLED IN ACCORDANCE WITH THE TRENCH BACKFILL DETAIL AS ILLUSTRATED IN THE PLANS AND WITH ARTICLE 550.07 OF THE STANDARD SPECIFICATIONS. COMPACTION OF BACKFILL MATERIAL SHALL BE IN ACCORDANCE WITH METHOD 1 ONLY. METHOD 2 AND 3 WILL ONLY BE PERMITTED UPON APPROVAL OF THE ENGINEER.
- SANITARY SEWER STRUCTURES OFFSET LOCATIONS GIVEN ON THE DETAILED PLANS ARE TO THE FOLLOWING POINTS FROM THE TRANSIT LINE AS SHOWN ON THE PLANS:
  - FOR STRUCTURES IN THE CURB LINE: TO THE EDGE OF PAVEMENT
  - FOR ALL OTHER STRUCTURE LOCATIONS: TO THE CENTER OF THE STRUCTURE

- WHEN EXISTING DRAINAGE FACILITIES ARE DISTURBED, THE CONTRACTOR SHALL PROVIDE AND MAINTAIN TEMPORARY OUTLETS AND CONNECTIONS FOR ALL PRIVATE OR PUBLIC DRAINS, SEWERS OR CATCH BASINS. HE SHALL PROVIDE FACILITIES TO TAKE IN ALL STORM WATER WHICH WILL BE RECEIVED BY THESE DRAINS AND SEWERS AND DISCHARGE THE SAME. HE SHALL PROVIDE AND MAINTAIN AN EFFICIENT PUMPING PLANT, IF NECESSARY, AND A TEMPORARY OUTLET AND BE PREPARED AT ALL TIMES TO DISPOSE OF THE WATER RECEIVED FROM THESE TEMPORARY CONNECTIONS UNTIL SUCH TIME AS THE PERMANENT CONNECTIONS WITH SEWERS ARE BUILT AND IN SERVICE. THIS WORK WILL NOT BE PAID FOR DIRECTLY, BUT SHALL BE CONSIDERED INCIDENTAL TO THE CONTRACT.
- ALL SIDEWALKS AT ALLEY AND ROADWAY INTERSECTIONS SHALL BE CONSTRUCTED WITH HANDICAPPED RAMPS IN ACCORDANCE WITH THE CORRESPONDING DETAIL INCLUDED IN THE PLANS AND STANDARD 424001-05.
- ALL AREAS OF DEPRESSED CURB SHALL BE LOCATED IN THE FIELD BY THE ENGINEER PRIOR TO CURB PLACEMENT.
- FRAME ELEVATIONS GIVEN ON THE PLANS ARE ONLY TO ASSIST THE CONTRACTOR IN DETERMINING THE APPROXIMATE OVERALL HEIGHT OF THE STRUCTURE. FRAMES ON ALL NEW STRUCTURES WILL BE ADJUSTED TO THE FINAL ELEVATION OF THE AREA IN WHICH THEY ARE LOCATED AS PART OF THE STRUCTURE COST.
- ANY SHEETING OR SHORING USED ON THIS IMPROVEMENT SHALL BE CONSIDERED INCIDENTAL TO THE COST OF THE CONTRACT

**RIGID PAVEMENT-STRUCTURAL DESIGN INFORMATION**

DESIGN PERIOD: 20 YEARS  
 STRUCTURAL DESIGN TRAFFIC: YEAR 2020  
 CLASS II ROAD  
 PERCENT OF STRUCTURAL DESIGN TRAFFIC IN DESIGN LANE  
 P=50 S=50 M=50  
 P.C. 95% (2023 VPD)  
 S.U. 5% (107 VPD)  
 M.U. 0% (0 VPD)  
 TRAFFIC FACTOR: TF=0.175  
 SOIL SUPPORT RATING: POOR  
 PAVEMENT STRUCTURE  
 SURFACE TYPE: PORTLAND CEMENT CONCRETE PAVEMENT: 8" JOINTED W/15' JOINT SPACING  
 BASE TYPE: AGGREGATE BASE, CA-6, 4"

City of LaSalle  
 Section 08-00076-00-RS  
 LaSalle County  
 Contract No. 87395

	HMA Binder (Patches)	HMA Level Binder	HMA Surface
PG Grade	PG 64-22	PG 64-22	PG 64-22
Design Air Voids	4% @ N50	4% @ N50	4% @ N50
Mixture Composition	IL 19.0	IL 9.5	IL 12.5 or IL 9.5
Friction Aggregate			Mixture "C"
Density Test Method	Cores	Satisfaction of Engineer	Cores

**UTILITY ADJUSTMENTS**

STATION	LOCATION	MH ADJUST	WV ADJUST
19+02	17.6 LEFT		1
19+41	17.1 LEFT	1	
19+90	3.2 LEFT	1	
20+00	0.0 RIGHT	1	
23+17	0.0 RIGHT	1	
23+67	0.0 RIGHT	1	
27+93	10.0 LEFT	1	
28+00	24.0 LEFT		1
28+18	1.0 RIGHT	1	
28+30	24.0 LEFT		1
28+34	22.0 LEFT		1
28+44	10.0 LEFT	1	
30+63	1.0 RIGHT	1	
33+18	1.0 RIGHT	1	
36+69	1.0 RIGHT	1	
38+15	1.0 RIGHT	1	
TOTAL		12	4

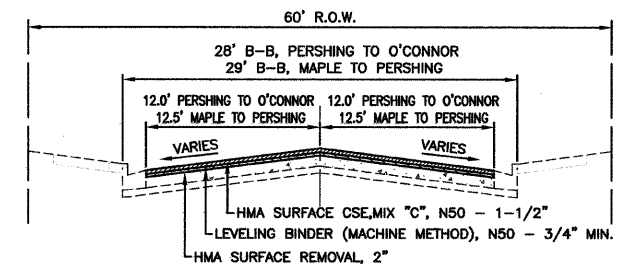

**BUCKLIN AVENUE - PROP. TYP. SECTION**

MAPLE TO O'CONNOR  
 STA. 31+00 TO STA. 41+62

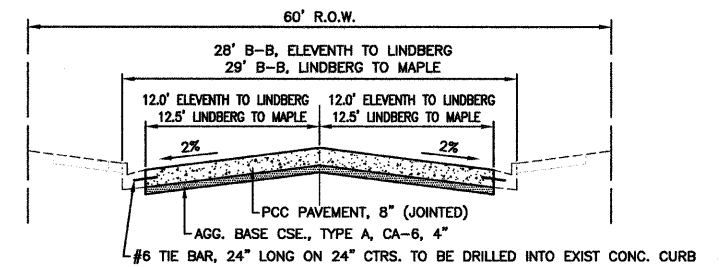

**BUCKLIN AVENUE - PROP. TYP. SECTION**

ELEVENTH TO MAPLE  
 STA. 16+04 TO STA. 31+00

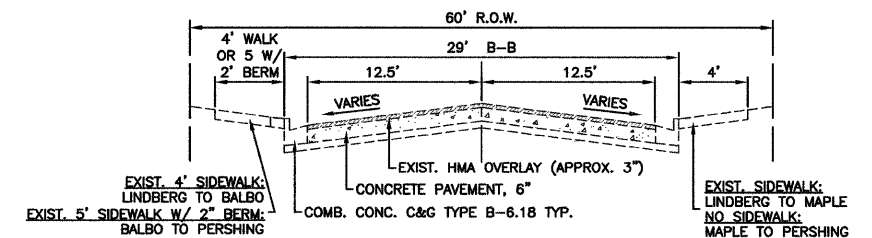

**BUCKLIN AVENUE - EXIST. TYP. SECTION**

LINDBERG TO PERSHING  
 STA. 23+17 TO STA. 33+16

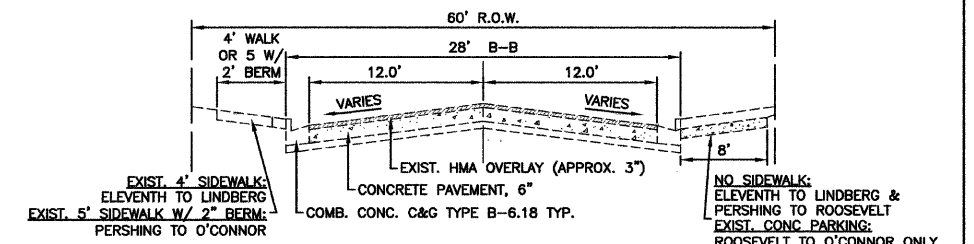

**BUCKLIN AVENUE - EXIST. TYP. SECTION**

ELEVENTH TO LINDBERG STA. 16+04 TO STA. 23+17  
 PERSHING TO O'CONNOR STA. 33+16 TO STA. 41+62

FILE NAME = 10243-NOTE-01 - NOTE-1	USER NAME =	DESIGNED -- M FURLAN	REVISED --	<b>STATE OF ILLINOIS DEPARTMENT OF TRANSPORTATION</b>	<b>CITY OF LASALLE PROPOSED HIGHWAY PLANS - BUCKLIN AVENUE GENERAL NOTES AND TYPICAL SECTIONS</b>	F.A.U. RTE.	SECTION	COUNTY	TOTAL SHEETS	SHEET NO.	
	PLOT SCALE =	CHECKED -- M FURLAN	REVISED --			6106	08-00076-00-RP	LASALLE	10	2	
	PLOT DATE = 4-2-2010	DRAWN -- JJB	REVISED --			CONTRACT NO. 87395					
		CHECKED -- BOB	REVISED --			FED. ROAD DIST. NO. 3 ILLINOIS FED. AID PROJECT M-5036(023)					

SUMMARY OF QUANTITIES					PARTICIPATING	NON-PARTICIPATING
					PAVEMENT	PAVEMENT
S.I.	CODE NO.	PAY ITEM	UNIT	QUAN	CONSTRUCTION TYPE CODE	
					J000 - 2A	Y060
	20800150	TRENCH BACKFILL	CU YD	1592		1592
	35100300	AGGREGATE BASE COURSE, TYPE A 4"	SQ YD	4607	4607	
	35800100	PREPARATION OF BASE	SQ YD	4607	4607	
*	40201000	AGGREGATE FOR TEMPORARY ACCESS	TON	130	130	
	40600100	BITUMINOUS MATERIALS (PRIME COAT)	GALLON	296	296	
	40600625	LEVELING BINDER (MACHINE METHOD), N50	TON	125	125	
	40603310	HOT-MIX ASPHALT SURFACE COURSE, MIX "C", N50	TON	250	250	
	42000301	PORTLAND CEMENT CONCRETE PAVEMENT 8" (JOINTED)	SQ YD	4607	4607	
	42400100	PORTLAND CEMENT CONCRETE SIDEWALK 4 INCH	SQ FT	1570	1570	
	42400800	DETECTABLE WARNINGS	SQ FT	160	160	
	44000157	HOT-MIX ASPHALT SURFACE REMOVAL, 2"	SQ YD	2964	2964	
	44000600	SIDEWALK REMOVAL	SQ FT	1158	1158	
*	44001700	COMBINATION CONCRETE CURB AND GUTTER REMOVAL AND REPLACEMENT	FOOT	417	417	
*	44004400	PAVEMENT REMOVAL (SPECIAL)	SQ YD	4607	4607	
	44201723	CLASS D PATCHES, TYPE IV, 6 INCH	SQ YD	7	7	
	60255500	MANHOLES TO BE ADJUSTED	EACH	12	12	
	60266600	VALVE BOXES TO BE ADJUSTED	EACH	4	4	
	67100100	MOBILIZATION	LSUM	1	1	
	70102620	TRAFFIC CONTROL AND PROTECTION, STANDARD 701501	LSUM	1	1	
	70102640	TRAFFIC CONTROL AND PROTECTION, STANDARD 701801	LSUM	1	1	
△	78001110	PAINT PAVEMENT MARKING - LINE 4"	FOOT	630	630	
*	△ X0324585	SANITARY SEWER SERVICE REMOVAL AND REPLACEMENT	EACH	46		46
*	△ XX005891	WATER SERVICE RECONNECTIONS	EACH	14		14
*	Z0042300	PORTLAND CEMENT CONCRETE SIDEWALK CURB	FOOT	441	441	
*	△ Z0056700	SANITARY SEWER 4"	FOOT	230		230
*	△ Z0056800	SANITARY SEWER 6"	FOOT	230		230
*	△ Z0059700	SANITARY SEWER, TYPE 2 10"	FOOT	1366		1366
*	△ Z0060200	SANITARY SEWER, TYPE 2 24"	FOOT	50		50

\* - INDICATES SPECIAL PROVISION  
 △ - INDICATES SPECIALTY ITEMS

SEE DRAWING FOR REVISIONS

SECTION 10, TOWNSHIP 33, RANGE 1E

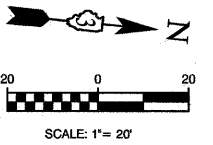

DATE	
BY	
SURVEYED	
ALIGNED	
CHECKED	
NOTED	
FILE NO.	
PLAN	
NOTE BOOK	
CHECKED	
FILE NAME	

DATE	
BY	
SURVEYED	
GRADES	
CHECKED	
NOTED	
PROFILE	
NOTE BOOK	
FILE NO.	

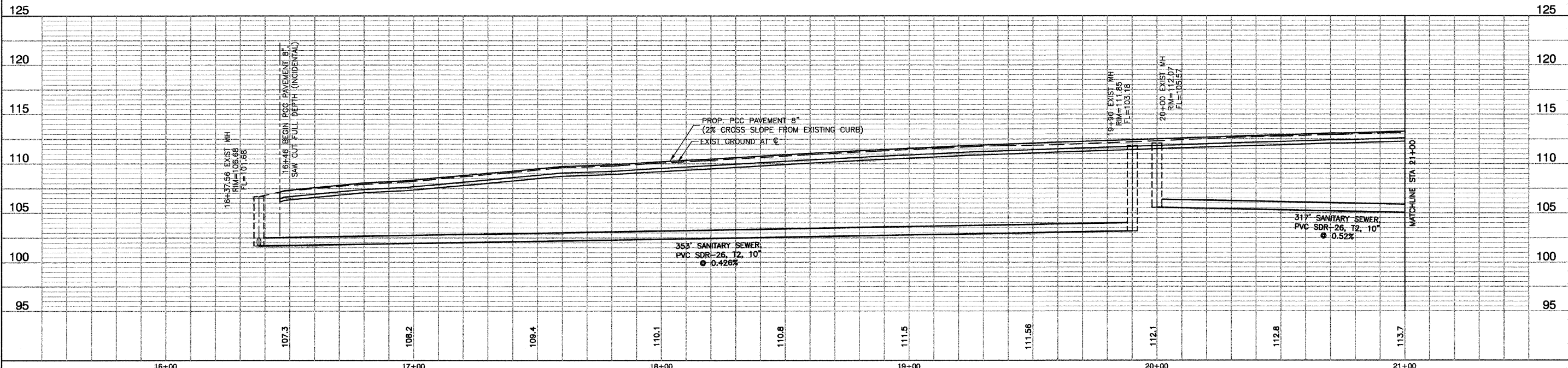
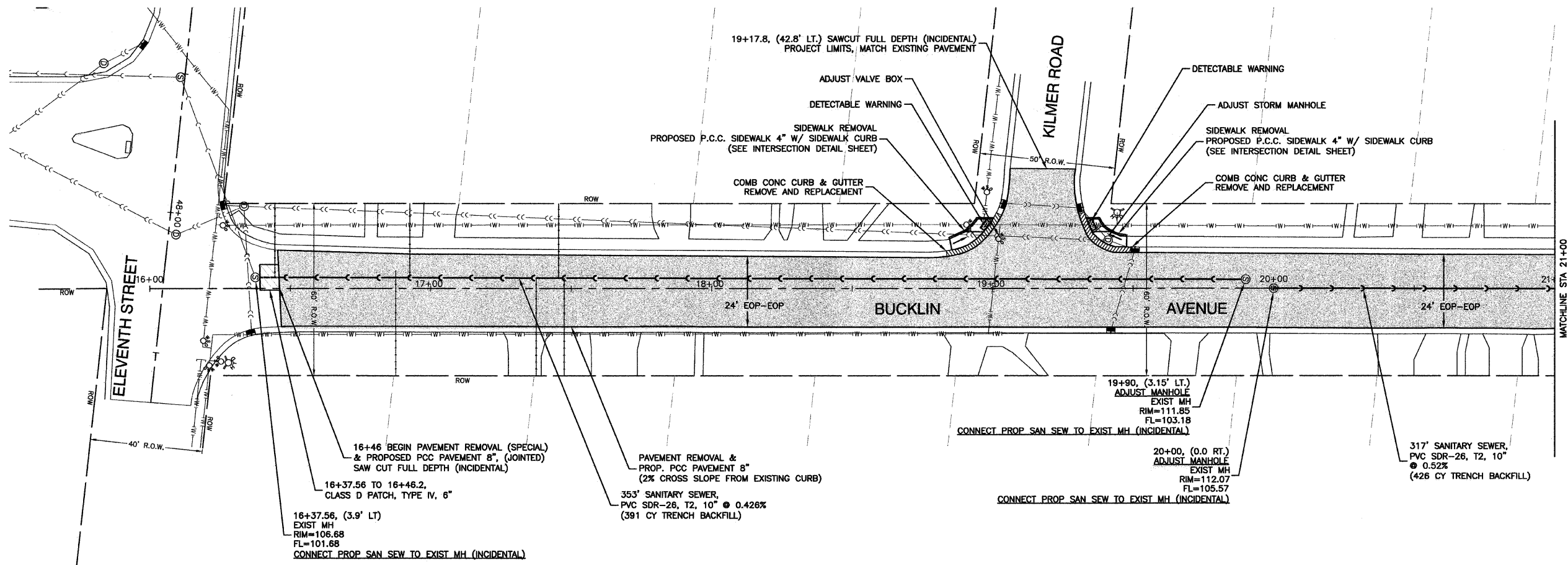

FILE NAME = 10243-PLPR-01 - PLPR01	USER NAME =	DESIGNED - M FURLAN	REvised -	<b>STATE OF ILLINOIS DEPARTMENT OF TRANSPORTATION</b>	<b>CITY OF LASALLE PROPOSED HIGHWAY PLANS - BUCKLIN AVENUE PLAN &amp; PROFILE</b>	F.A.U. RTE. 6106	SECTION 08-00076-00-RP	COUNTY LASALLE	TOTAL SHEETS 10	SHEET NO. 4		
PLOT SCALE =	DRAWN - JJB	CHECKED - M FURLAN	REvised -			SCALE:	SHEET NO. 4 OF 10 SHEETS	STA.	TO STA.	CONTRACT NO. 87395		
PLOT DATE = 4-2-2010	CHECKED - BDB	DRAWN - JJB	REvised -			FED. ROAD DIST. NO. 3	ILLINOIS	FED. AID PROJECT M-5036(023)				
		CHECKED - BDB	REvised -									

LAST SAVED: 04/02/2010 10:43:03 AM  
PLOTTED BY: BDB 04/02/2010 10:43:03 AM

SECTION 10, TOWNSHIP 33, RANGE 1E

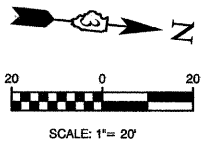

DATE	BY	SURVEYED	CHECKED
		ALIGNMENT	NOTED
		NOTE BOOK	FILE NAME
		NO.	

DATE	BY	SURVEYED	CHECKED
		GRADES	NOTED
		NOTE BOOK	FILE NAME
		NO.	

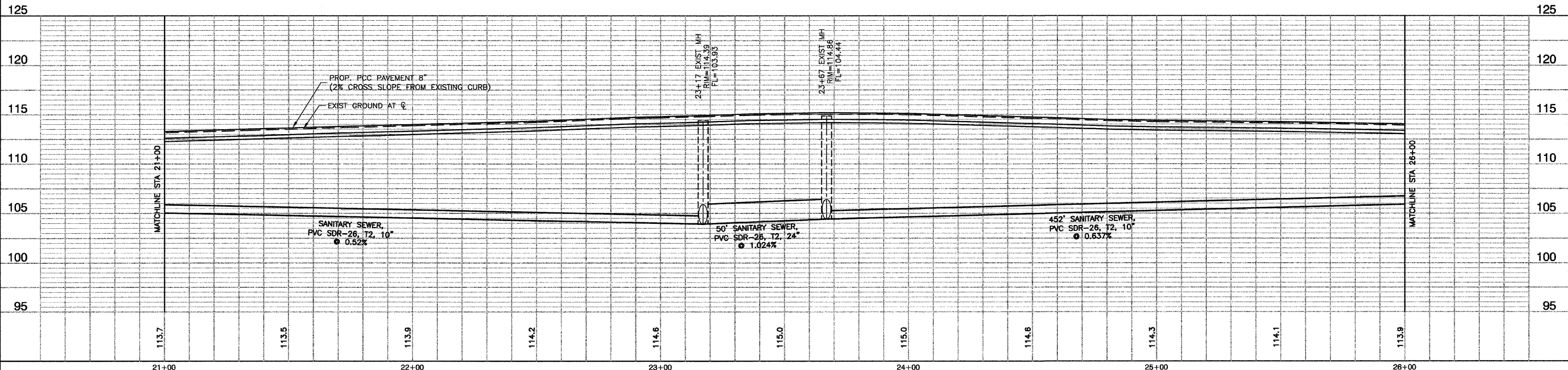
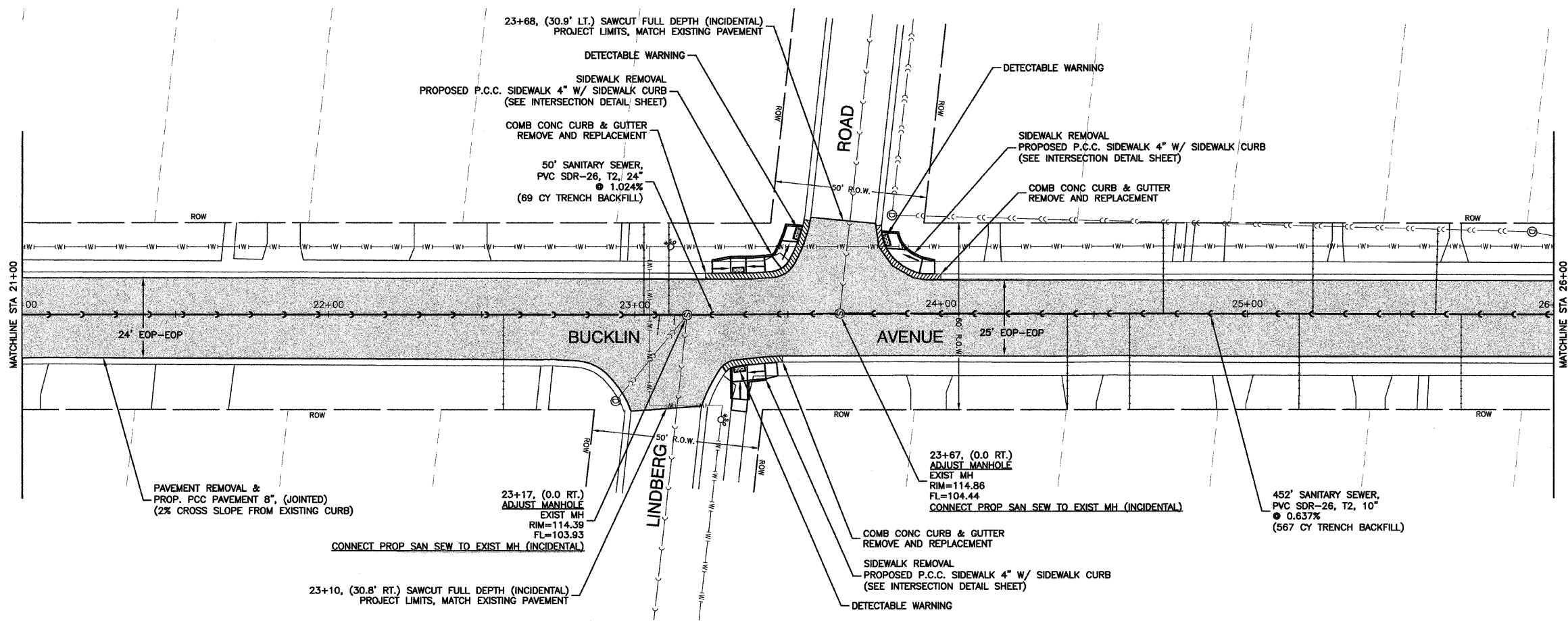

FILE NAME = 10243-PLPR-01 - PLPR02	USER NAME =	DESIGNED - M FURLAN	REVISED -	<p style="text-align: center;"><b>STATE OF ILLINOIS</b> <b>DEPARTMENT OF TRANSPORTATION</b></p>	<p><b>CITY OF LASALLE</b> <b>PROPOSED HIGHWAY PLANS - BUCKLIN AVENUE</b> <b>PLAN &amp; PROFILE</b></p>		F.A.U. RTE. 6106	SECTION 08-00076-00-RP	COUNTY LASALLE	TOTAL SHEETS 10	SHEET NO. 5	
PLOT SCALE =	DRAWN - JJB	CHECKED - M FURLAN	REVISED -		SCALE:	SHEET NO. 5 OF 10 SHEETS	STA. TO STA.	FED. ROAD DIST. NO. 3	ILLINOIS	FED. AID PROJECT M-5036(023)		
PLOT DATE = 4-2-2010	CHECKED - BDB											

LIST SAILED BY: JCB/AVS ON 4/2/10  
PLOTTED BY: JVB/SRW/PS ON 4/2/10

SECTION 10, TOWNSHIP 33, RANGE 1E

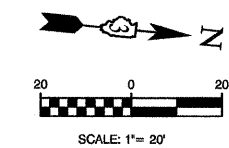

PLAN

DATE	BY

SUBMITTED BY: \_\_\_\_\_  
 CHECKED BY: \_\_\_\_\_  
 DATE: \_\_\_\_\_

PROFILE

DATE	BY

SUBMITTED BY: \_\_\_\_\_  
 CHECKED BY: \_\_\_\_\_  
 DATE: \_\_\_\_\_

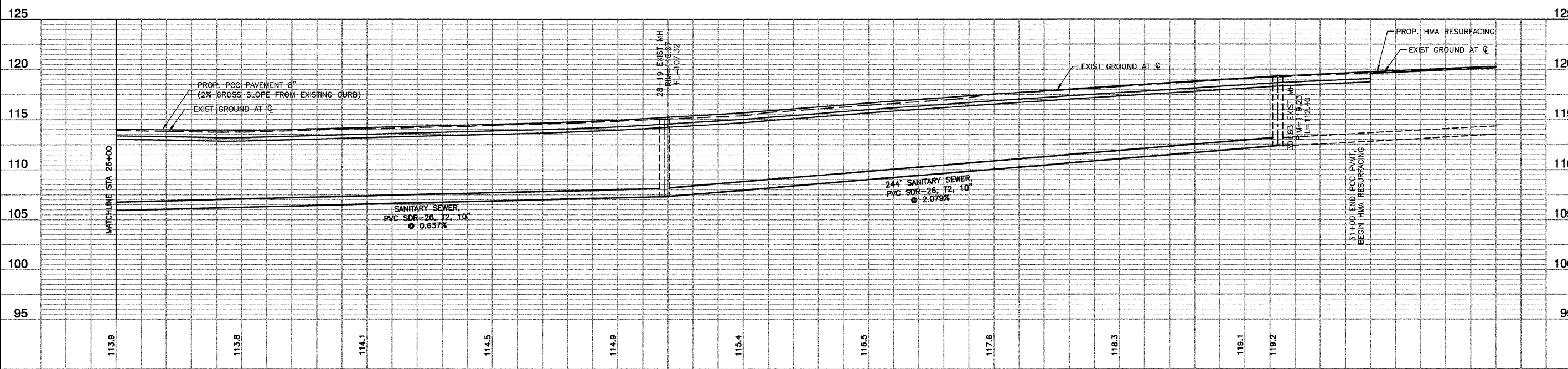
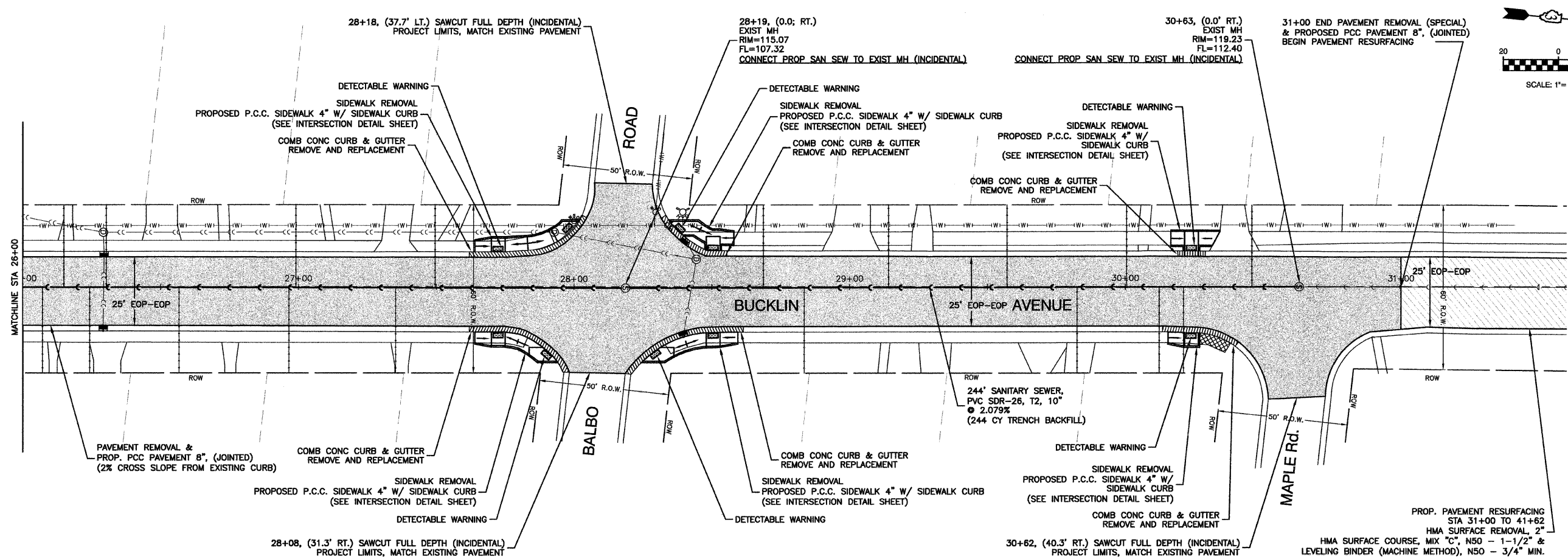

FILE NAME = 10243-PLPR-01 - PLPR03	USER NAME =	DESIGNED — M FURLAN	REvised —	STATE OF ILLINOIS DEPARTMENT OF TRANSPORTATION	CITY OF LASALLE PROPOSED HIGHWAY PLANS - BUCKLIN AVENUE PLAN & PROFILE		F.A.U. R.T.E. 6106	SECTION 08-00076-00-RP	COUNTY LASALLE	TOTAL SHEETS 10	SHEET NO. 6
	PLOT SCALE =	CHECKED — M FURLAN	REvised —		SCALE:	SHEET NO. 6 OF 10 SHEETS	STA. TO STA.	FED. ROAD DIST. NO. 3	ILLINOIS	FED. AID PROJECT M-5036(023)	CONTRACT NO. 87395
	PLOT DATE = 4-2-2010	DRAWN — JJB	REvised —								
		CHECKED — BDB	REvised —								

LAST REVISED BY: JJB/MAZ/CA 4/2/10  
 PLOTTED BY: JJB/MAZ/CA 4/2/10

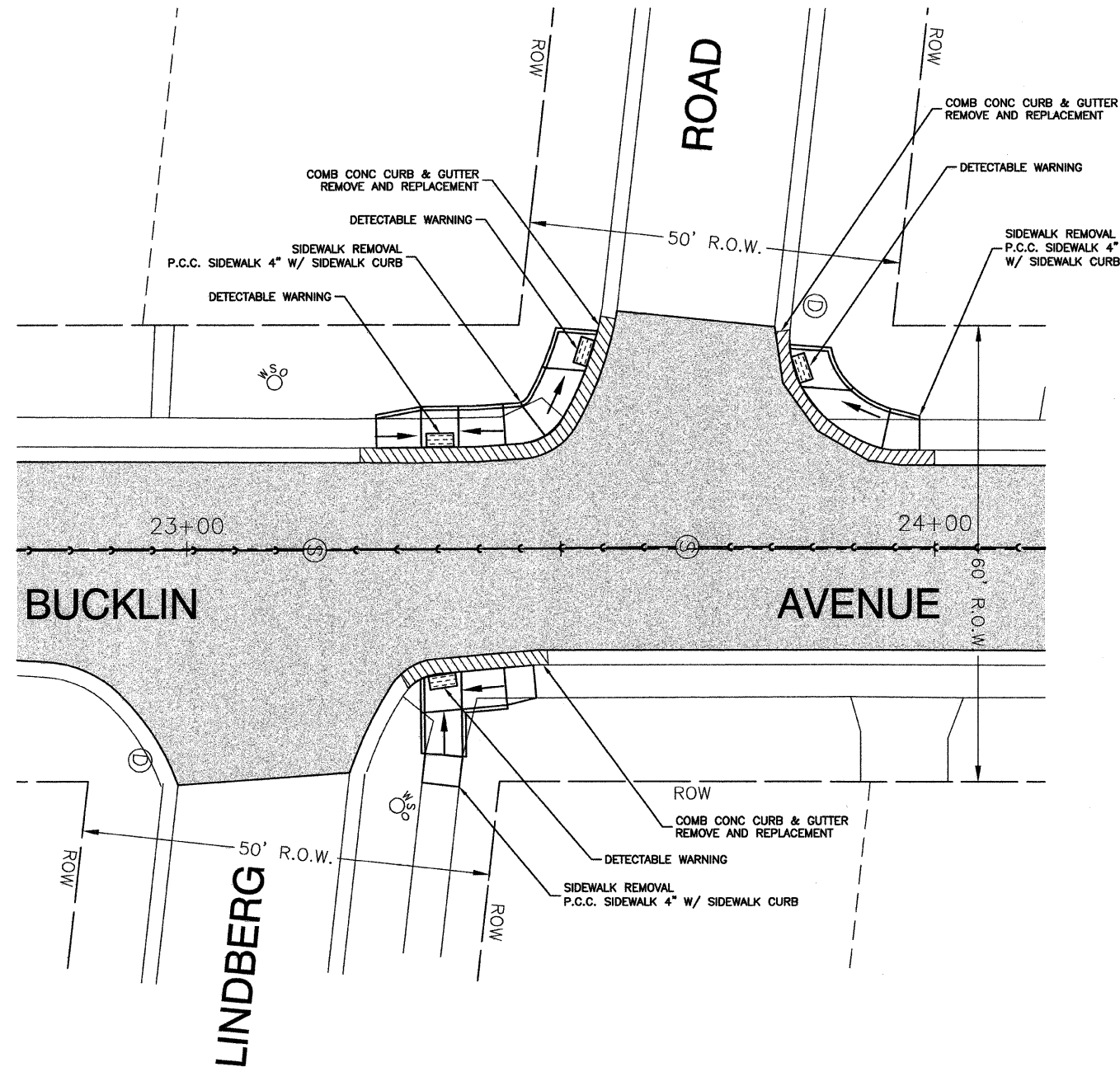
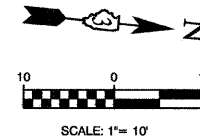
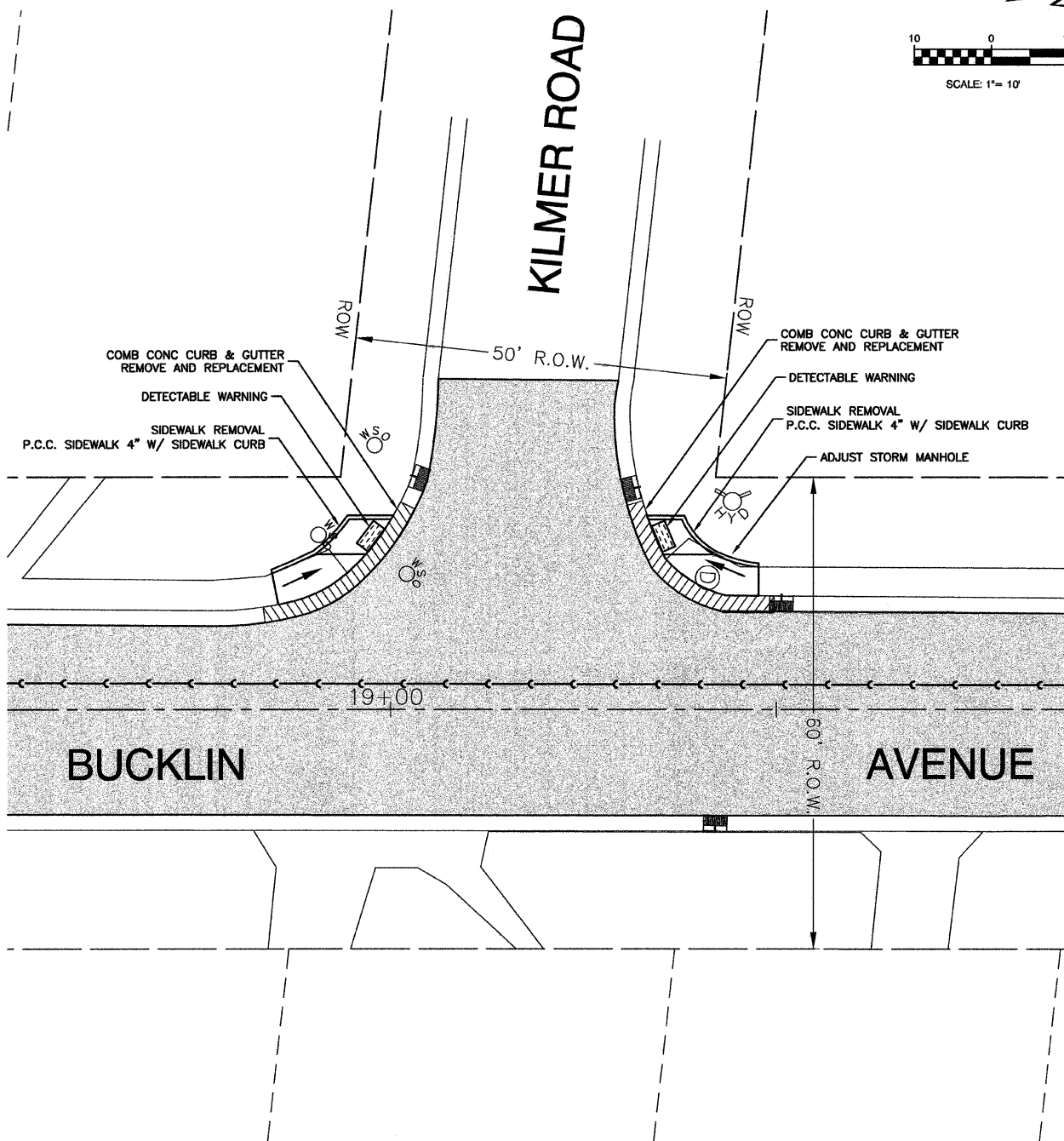
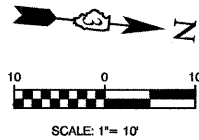

FILE NAME = 10243-PLAN-01 - P01	USER NAME =	DESIGNED -- M FURLAN	REVISED --
		CHECKED -- M FURLAN	REVISED --
	PLOT SCALE =	DRAWN -- JJB/JRA	REVISED --
	PLOT DATE = 4-2-2010	CHECKED -- BDB	REVISED --

STATE OF ILLINOIS  
DEPARTMENT OF TRANSPORTATION

CITY OF LASALLE		F.A.U. RTE.	SECTION	COUNTY	TOTAL SHEETS	SHEET NO.
PROPOSED HIGHWAY PLANS - BUCKLIN AVENUE		6106	08-00076-00-RP	LASALLE	10	7
INTERSECTION DETAILS		CONTRACT NO. 87395				
SCALE:	SHEET NO. 7 OF 10 SHEETS	STA.	TO STA.		FED. ROAD DIST. NO. 3 ILLINOIS	FED. AID PROJECT M-5036(023)

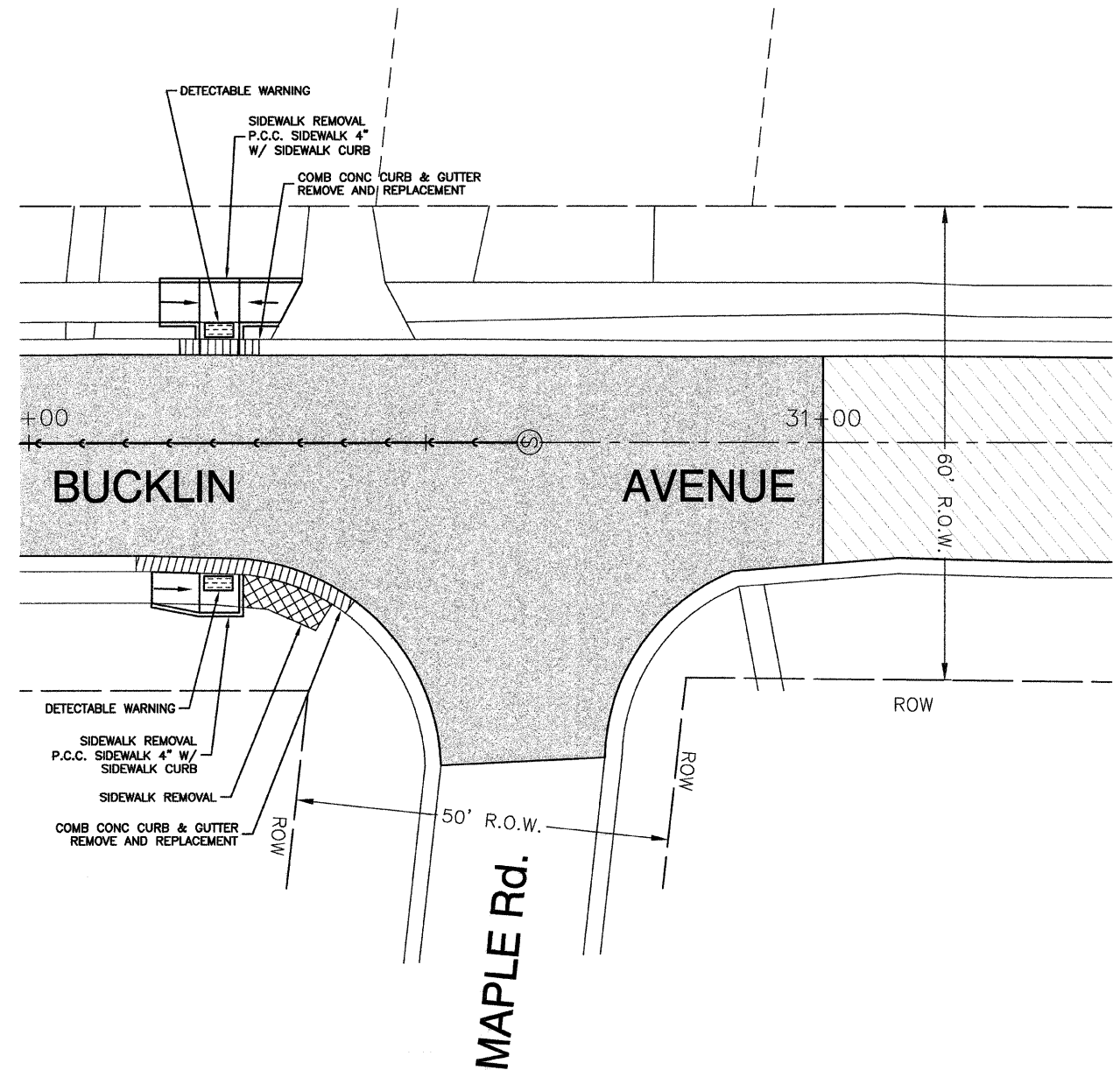
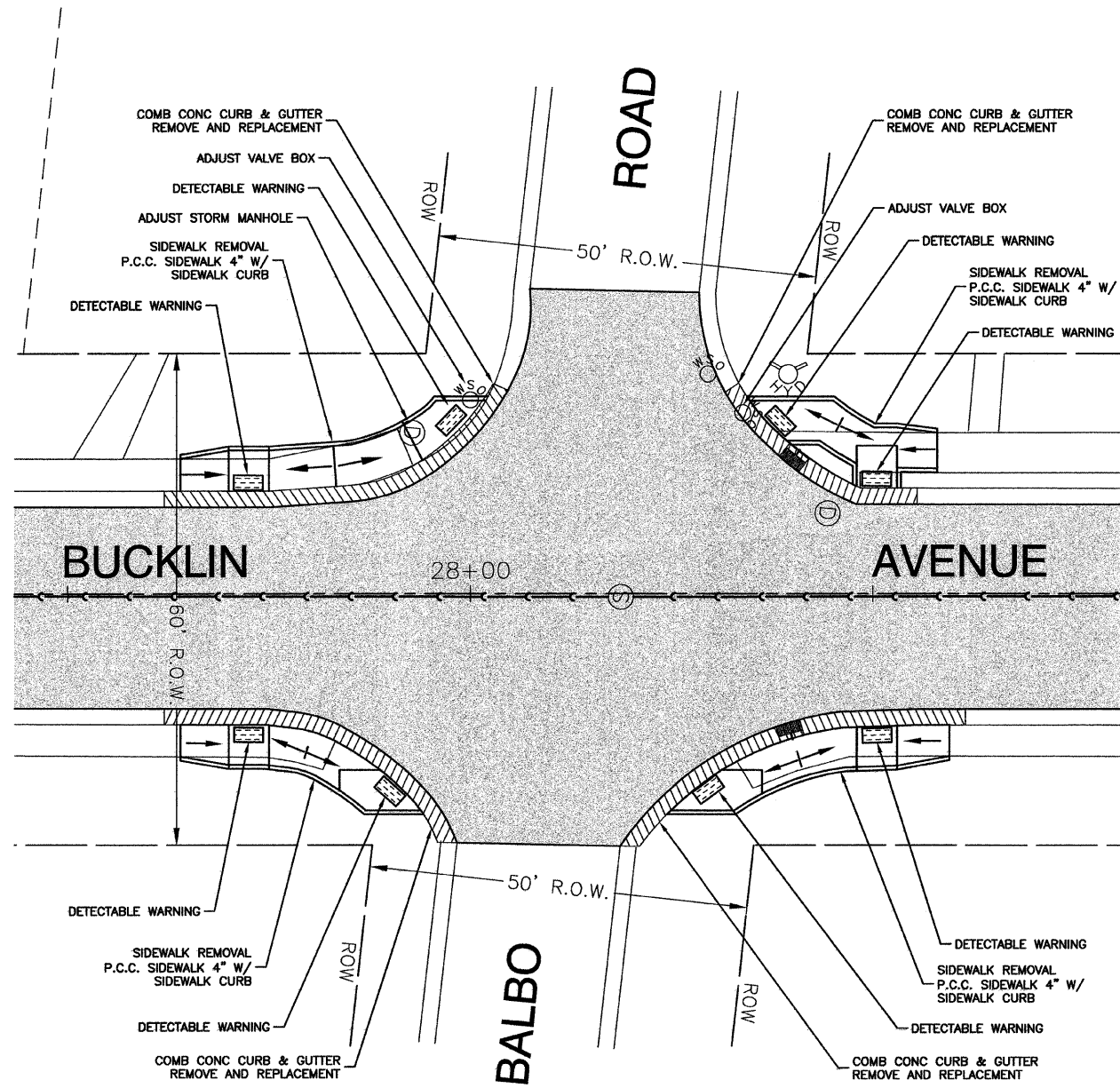
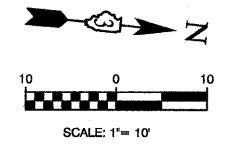
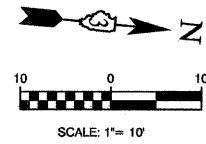

FILE NAME = 10243-PLAN-01 - P02

USER NAME =  
 PLOT SCALE =  
 PLOT DATE = 4-2-2010

DESIGNED — M FURLAN  
 CHECKED — M FURLAN  
 DRAWN — JJB/JRA  
 CHECKED — BDB

REVISED —  
 REVISED —  
 REVISED —  
 REVISED —

STATE OF ILLINOIS  
 DEPARTMENT OF TRANSPORTATION

CITY OF LASALLE  
 PROPOSED HIGHWAY PLANS - BUCKLIN AVENUE  
 INTERSECTION DETAILS

SCALE: SHEET NO. 8 OF 10 SHEETS STA. TO STA.

F.A.U. RTE.	SECTION	COUNTY	TOTAL SHEETS	SHEET NO.
6106	08-0076-00-RP	LASALLE	10	8
CONTRACT NO. 87395				
FED. ROAD DIST. NO. 3 ILLINOIS FED. AID PROJECT M-5036(023)				



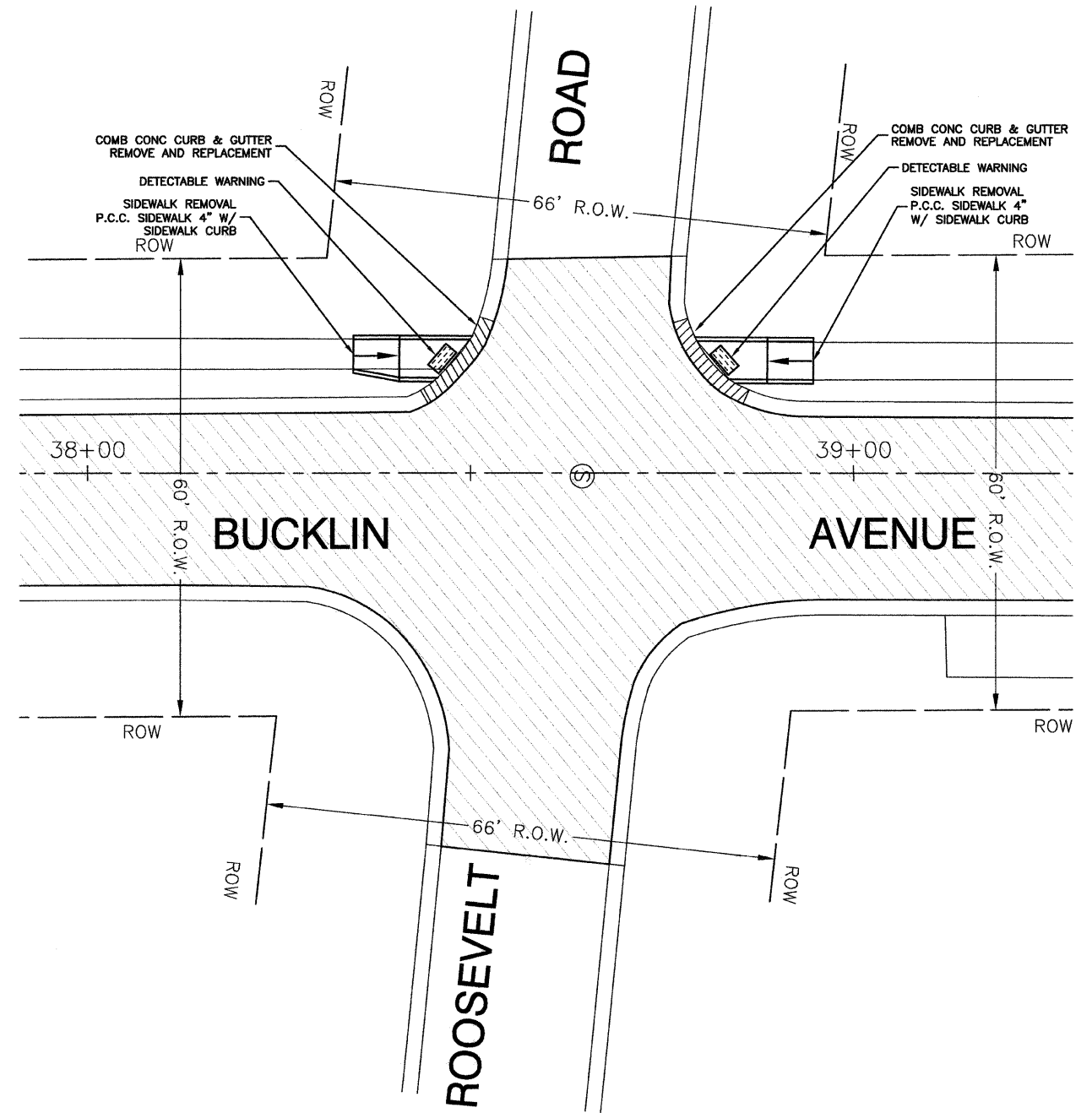
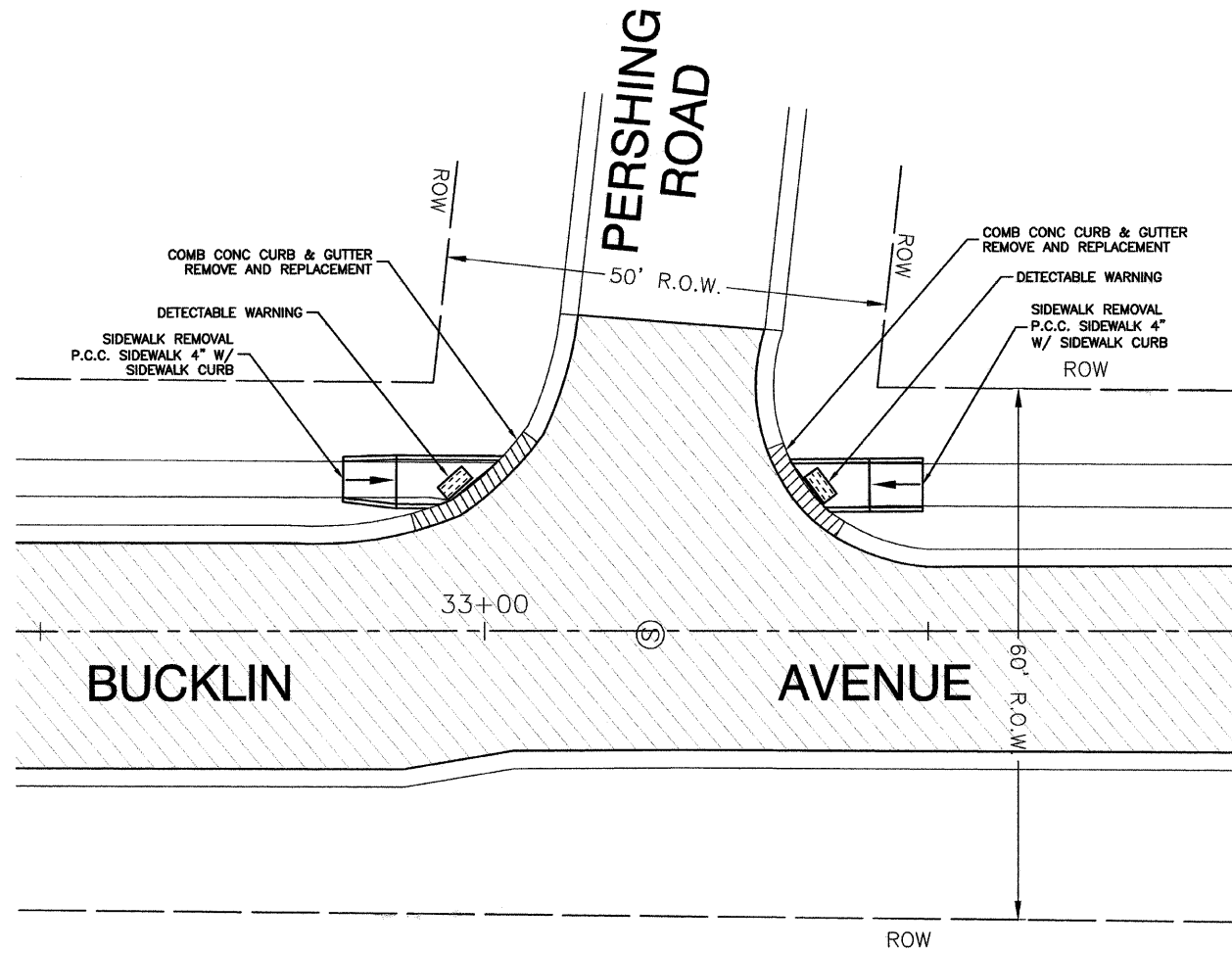
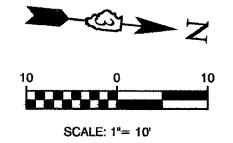
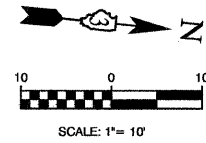

FILE NAME = 10243-PLAN-01 - P03	USER NAME =	DESIGNED -- M FURLAN	REVISED --
		CHECKED -- M FURLAN	REVISED --
	PLOT SCALE =	DRAWN -- JJB/JRA	REVISED --
	PLOT DATE = 4-2-2010	CHECKED -- BDB	REVISED --

STATE OF ILLINOIS  
DEPARTMENT OF TRANSPORTATION

CITY OF LASALLE	
PROPOSED HIGHWAY PLANS - BUCKLIN AVENUE	
INTERSECTION DETAILS	
SCALE:	STA. TO STA.
SHEET NO. 9	OF 10 SHEETS

F.A.U. RTE.	SECTION	COUNTY	TOTAL SHEETS	SHEET NO.
6106	08-00076-00-RP	LASALLE	10	9
CONTRACT NO. 87395				
FED. ROAD DIST. NO. 3 ILLINOIS FED. AID PROJECT M-5036(023)				

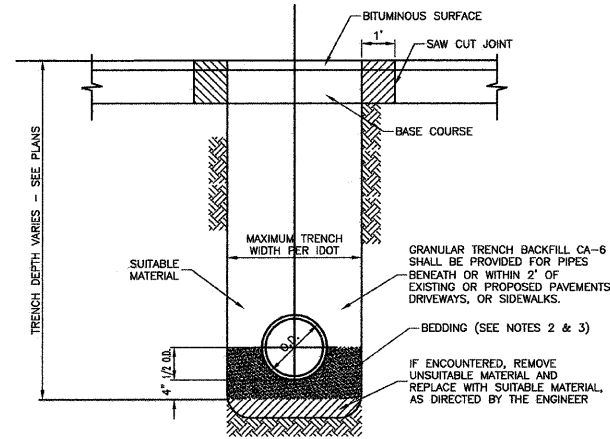

- NOTES:**
- TRENCH SHALL BE IN ACCORDANCE WITH OSHA SAFETY STANDARDS.
  - BEDDING SHALL BE REQUIRED TO BE A MINIMUM THICKNESS EQUAL TO 1/4 OF THE OUTSIDE DIAMETER OF THE PIPE BUT SHALL NOT BE MORE THAN 8" AND LESS THAN 4". AS A MINIMUM, BEDDING AND HAUNCHING MATERIAL SHALL CONFORM TO THE REQUIREMENTS OF THE "STANDARD SPECIFICATIONS FOR ROAD AND BRIDGE CONSTRUCTION." THE GRADATIONS SHALL EITHER BE FA-1 OR FA-2.

**TRENCH BACKFILL DETAIL FOR SANITARY SEWER**

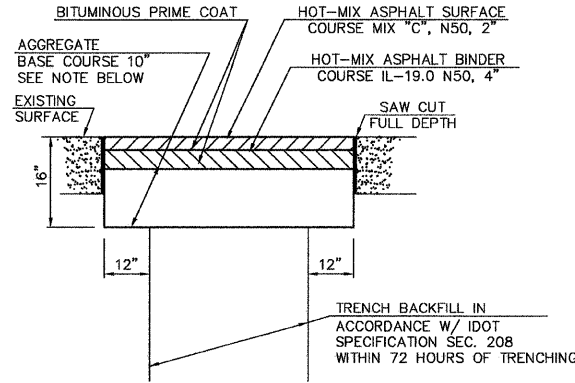

**NOTE:**  
CONTRACTOR TO PLACE AGGREGATE, 16" THICK TO TOP SURFACE OF EXISTING PAVEMENT TO BE REMOVED AT LOCATIONS SHOWN ON PLANS TO PROVIDE TEMPORARY SURFACING UNTIL PLACEMENT OF PAVEMENT SURFACE. CONTRACTOR TO REMOVE THE 6" OF AGGREGATE PRIOR TO PLACEMENT OF BITUMINOUS SURFACE. PAYMENT TO BE AT THE CONTRACT PRICE PER SQUARE YARD AND WORK SHALL INCLUDE ALL LABOR AND MATERIALS REQUIRED TO RESTORE PAVEMENT AS DETAILED, INCLUDING PLACING AND REMOVING THE ADDITIONAL AGGREGATE REQUIRED FOR TEMPORARY SURFACE.

**PAVEMENT PATCHING DETAIL**  
NOT TO SCALE

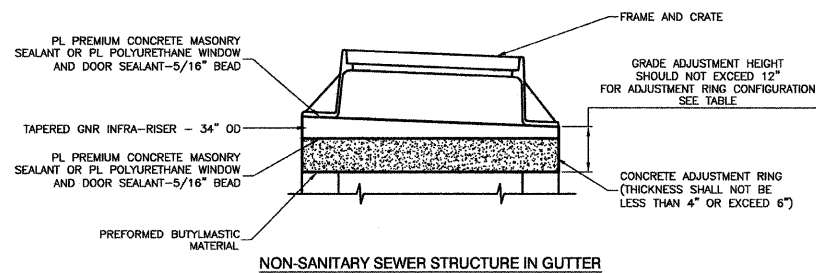
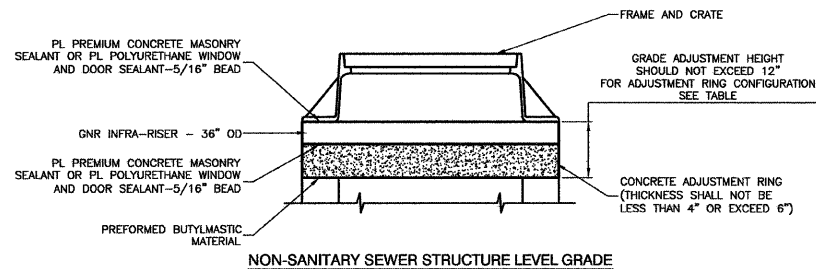
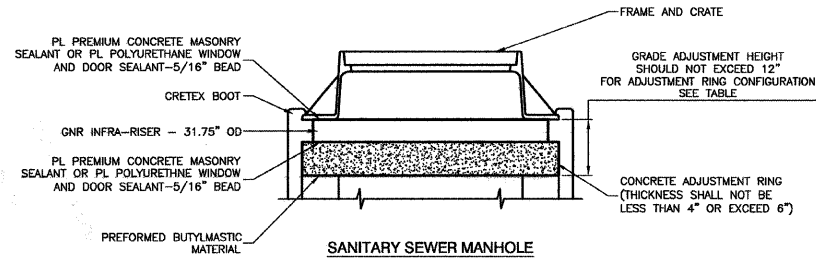

**ADJUSTMENT RING DETAIL**

**ADJUSTMENT RING TABLE**

ADJUSTMENT HEIGHT	CONCRETE	RUBBER
0"	-	-
1"	-	1"
2"	-	2"
3"	-	3"
4"	4"	-
5"	4"	1"
6"	4"	2"
7"	4"	3"
8"	4", 4"	-
9"	6"	3"
10"	4", 4"	2"
11"	4", 4"	3"
12"	6", 4"	2"

**NOTE:**  
GRADE ADJUSTMENT HEIGHT SHOULD NOT EXCEED 12"

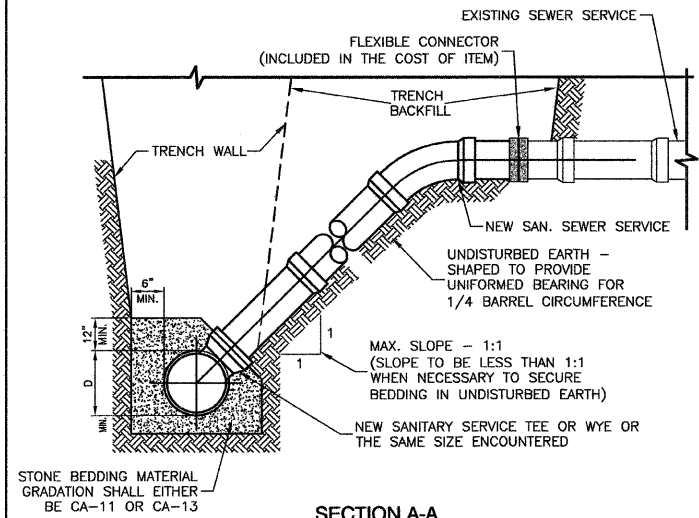
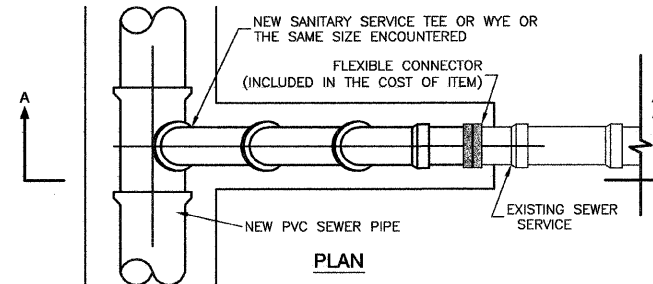

**TYPICAL SANITARY SEWER SERVICE CONNECTION REPLACEMENT**

**CONSTRUCTION DETAILS**

FILE NAME = 10243-DT1S-01 - DETAILS	USER NAME =	DESIGNED - M FURLAN	REVISED -	STATE OF ILLINOIS DEPARTMENT OF TRANSPORTATION	CITY OF LASALLE PROPOSED HIGHWAY PLANS - BUCKLIN AVENUE CONSTRUCTION DETAILS	F.A.U. RTE.	SECTION	COUNTY	TOTAL SHEETS	SHEET NO.	
	PLOT SCALE =	CHECKED - M FURLAN	REVISED -			6106	08-0076-00-RP	LASALLE	10	10	
	PLOT DATE = 4-2-2010	DRAWN - JJB/JFA	REVISED -			CONTRACT NO. 87395					
		CHECKED - BDB	REVISED -			FED. ROAD DIST. NO. 3   ILLINOIS   FED. AID PROJECT M-5036(023)					