

STATE OF ILLINOIS
DEPARTMENT OF TRANSPORTATION
DIVISION OF HIGHWAYS
PLANS FOR PROPOSED
HIGHWAY BRIDGE PROGRAM

MARTINTON ROAD DISTRICT
SECTION 04-16101-02-BR
IROQUOIS COUNTY
PROJECT NO. BROS-075 (136)
T.R. 244
C-93-050-10
CONTRACT NO. 87445

ROUTE NO.	SECTION	COUNTY	TOTAL SHEETS	SHEET NO.
T.R. 244	04-16101-02-BR	IROQUOIS	24	1
		ILLINOIS	MARTINTON ROAD DISTRICT	

CONTRACT NO. 87445

SHEET NO.	TITLE
1.	COVER SHEET
2.	SUMMARY OF QUANTITIES, GENERAL NOTES & TYPICAL SECTIONS
3.	PLAN AND PROFILE SHEET
4.-19.	BRIDGE PLANS
20.-24.	STATION CROSS SECTIONS

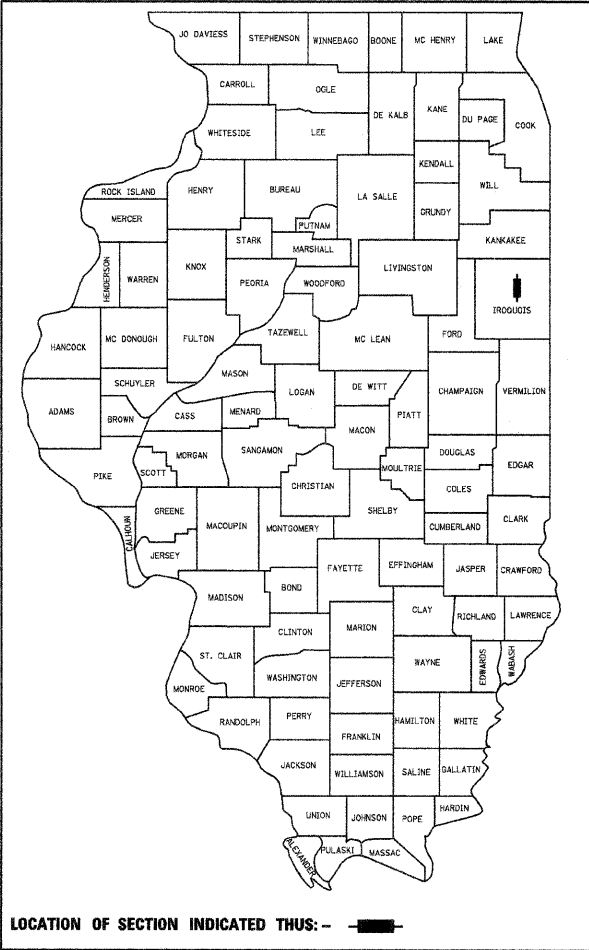

CLASSIFICATION: LOCAL ROAD (NON-URBAN)
DESIGN VOLUME: UNDER 250 ADT
CURRENT ADT: 85 (2009)
DESIGN SPEED: 30 MPH

TOLL FREE JOINT UTILITY LOCATING
 INFORMATION FOR EXCAVATORS (J.U.L.I.E.)
 TELEPHONE NUMBER 1-800-892-0123

- STANDARDS**
- 280001-05 TEMPORARY EROSION CONTROL SYSTEMS
 - 515001-03 NAME PLATE FOR BRIDGES
 - 601101-01 CONCRETE HEADWALL FOR PIPE DRAIN
 - 635006-03 REFLECTOR AND TERMINAL MARKER PLACEMENT
 - 701901-01 TRAFFIC CONTROL DEVICES
 - 720011-01 METAL POSTS FOR SIGNS, MARKERS AND DELINEATORS
 - 728001-01 TELESCOPING STEEL SIGN SUPPORT
 - 729001-01 APPLICATIONS OF TYPES A & B METAL POSTS (FOR SIGNS AND MARKERS)
 - BLR 21-8 TYPICAL APPLICATION OF TRAFFIC CONTROL DEVICES FOR CONSTRUCTION ON RURAL LOCAL HIGHWAYS

STA. 38+50 - SPECIAL BRIDGE DESIGN
 3-SPAN CONTINUOUS STEEL WIDE FLANGE (COMPOSITE) BEAM BRIDGE (24" DEPTH);
 THREE SPANS @ 40'-0", 50'-0", 40'-0";
 30'-0" O.-O. ROADWAY; 132'-10 5/8" BK.-BK. ABUTS.; SKEW = 30° LT.
 EXISTING S.N. 038-4533
 PROPOSED S.N. 038-4556

IMPROVEMENT ENDS
 STA. 41+50

IMPROVEMENT BEGINS
 STA. 35+00

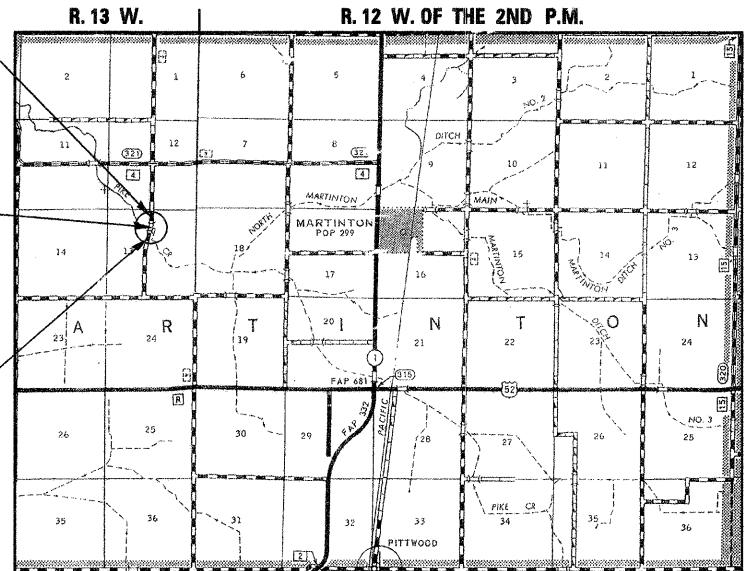

LOCATION PLAN

GROSS LENGTH OF SECTION = 650 FEET = 0.123 MILES
 NET LENGTH OF SECTION = 650 FEET = 0.123 MILES



SCALES

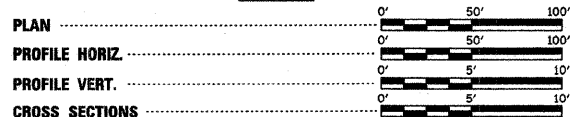

Contract 87445

4440 ASH GROVE
 SPRINGFIELD, IL 62711
 (217) 793-8600
 www.fehr-graham.com

FEHR-GRAHAM & ASSOCIATES, LLC
 ENGINEERING AND SCIENCE CONSULTANTS
 PEORIA, IL; ROCKFORD, IL; ROCKFORD, IL; MONROE, IL; SPRINGFIELD, IL



Gary J. Cartwright 12-7-09
 ILLINOIS PROFESSIONAL NO. 43408
 EXPIRES 11-30-09

APPROVED December 9, 2009
[Signature]
 COUNTY ENGINEER

PASSED 12-16, 2009
[Signature]
 DISTRICT THREE ENGINEER OF LOCAL ROADS & STREETS

RELEASED FOR BID
 BASED ON LIMITED REVIEW 12-16, 2009
[Signature]
 DEPUTY DIRECTOR OF HIGHWAYS, REGION TWO ENGINEER

STATE OF ILLINOIS
 DEPARTMENT OF TRANSPORTATION