

F.A.P. RTE.	SECTION	COUNTY	TOTAL SHEETS	SHEET NO.
399	36R-1,37R-2	TAZEWELL	449	88
STA 7+663.000		TO STA 10+097.000		
FED. ROAD DIST. NO. 4		ILLINOIS FED. AID PROJECT		

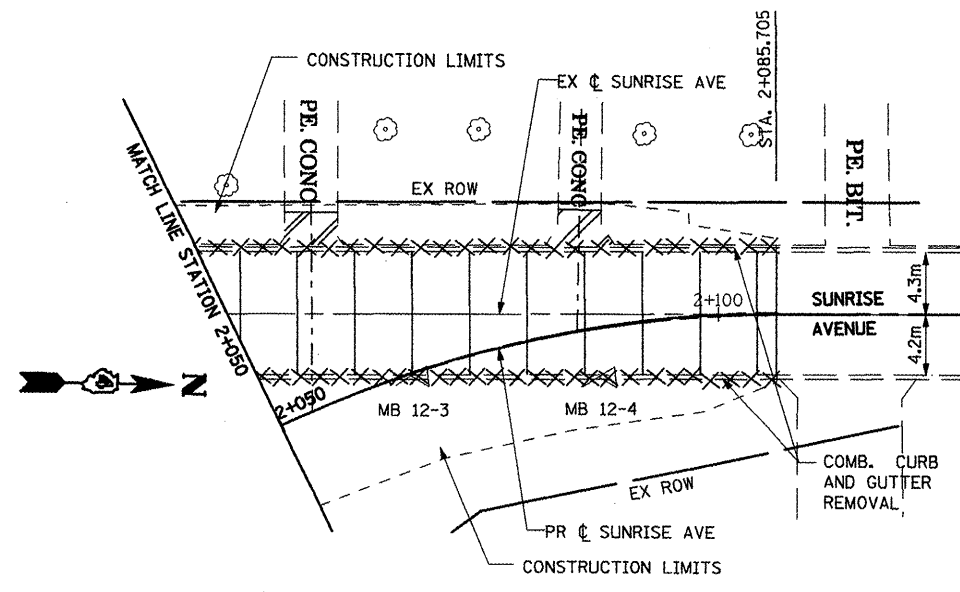

- LEGEND:**
- PAVEMENT REMOVAL
 - PAVED SHOULDER REMOVAL
 - DRIVEWAY PAVEMENT REMOVAL
 - REMOVAL AND DISPOSAL OF UNSUITABLE MATERIAL
 - CURB AND GUTTER REMOVAL
 - TREE REMOVAL
 - SOIL BORING
 - MAILBOX TO BE RELOCATED
 - MB X-X

NOTE:
 SEE DRAINAGE AND UTILITIES PLAN SHEETS FOR EXISTING PIPE, CULVERTS AND STRUCTURE REMOVALS AND FOR LOCATION OF EXISTING UTILITIES.

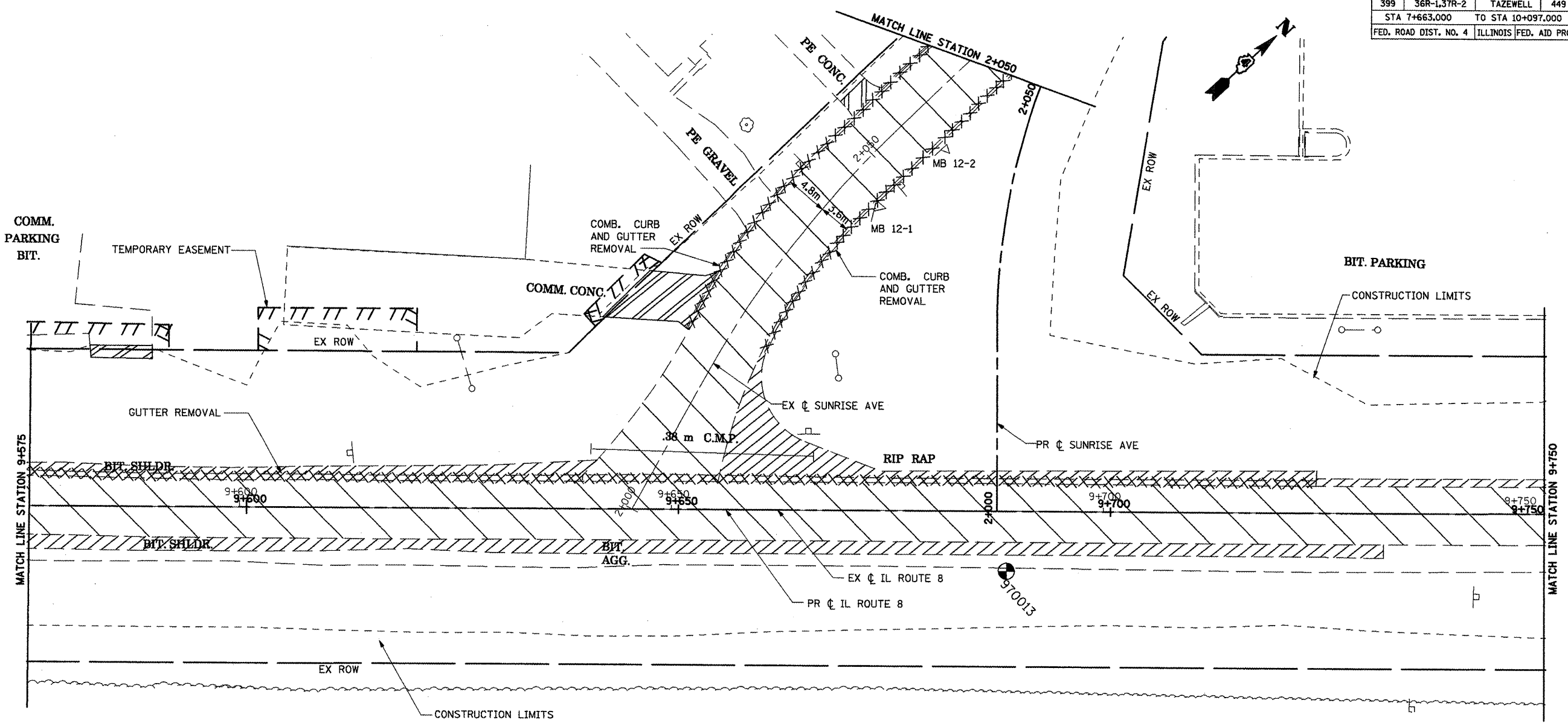
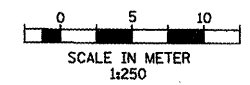

REVISIONS		ILLINOIS DEPARTMENT OF TRANSPORTATION ILLINOIS ROUTE 8 - SEGMENT 2 EXISTING PLAN AND REMOVALS STA. 9+575 TO STA. 9+750
NAME	DATE	
		SCALE: 1:250 DATE: DECEMBER, 2003

DRAWN BY: RLK
CHECKED BY: SAE