

F.A.P. RTE.	SECTION	COUNTY	TOTAL SHEETS	SHEET NO.
399	36R-1,37R-2	TAZEWELL	449	98
STA 7+663.000		TO STA 10+097.000		
FED. ROAD DIST. NO. 4		ILLINOIS FED. AID PROJECT		

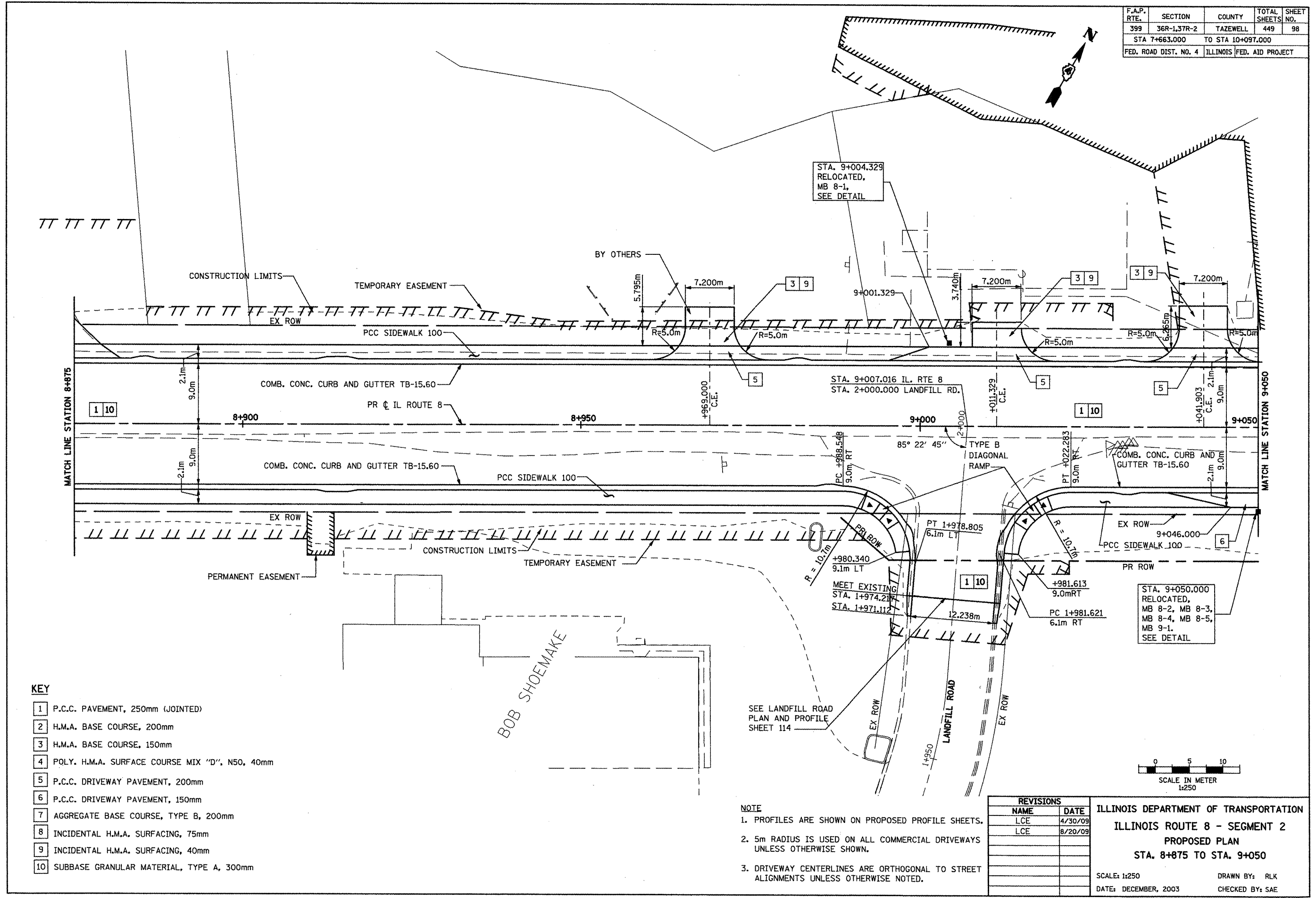

- KEY**
- 1 P.C.C. PAVEMENT, 250mm (JOINTED)
 - 2 H.M.A. BASE COURSE, 200mm
 - 3 H.M.A. BASE COURSE, 150mm
 - 4 POLY. H.M.A. SURFACE COURSE MIX "D", N50, 40mm
 - 5 P.C.C. DRIVEWAY PAVEMENT, 200mm
 - 6 P.C.C. DRIVEWAY PAVEMENT, 150mm
 - 7 AGGREGATE BASE COURSE, TYPE B, 200mm
 - 8 INCIDENTAL H.M.A. SURFACING, 75mm
 - 9 INCIDENTAL H.M.A. SURFACING, 40mm
 - 10 SUBBASE GRANULAR MATERIAL, TYPE A, 300mm

- NOTE**
1. PROFILES ARE SHOWN ON PROPOSED PROFILE SHEETS.
 2. 5m RADIUS IS USED ON ALL COMMERCIAL DRIVEWAYS UNLESS OTHERWISE SHOWN.
 3. DRIVEWAY CENTERLINES ARE ORTHOGONAL TO STREET ALIGNMENTS UNLESS OTHERWISE NOTED.

REVISIONS	
NAME	DATE
LCE	4/30/09
LCE	8/20/09

ILLINOIS DEPARTMENT OF TRANSPORTATION
ILLINOIS ROUTE 8 - SEGMENT 2
PROPOSED PLAN
STA. 8+875 TO STA. 9+050

SCALE: 1:250
DATE: DECEMBER, 2003

DRAWN BY: RLK
CHECKED BY: SAE

