

F.A.P. RTE.	SECTION	COUNTY	TOTAL SHEETS	SHEET NO.
399	36R-1, (37R-2)	TAZEWELL	449	277
STA.		TO STA.		
FED. ROAD DIST. NO. 4 ILLINOIS FED. AID PROJECT				

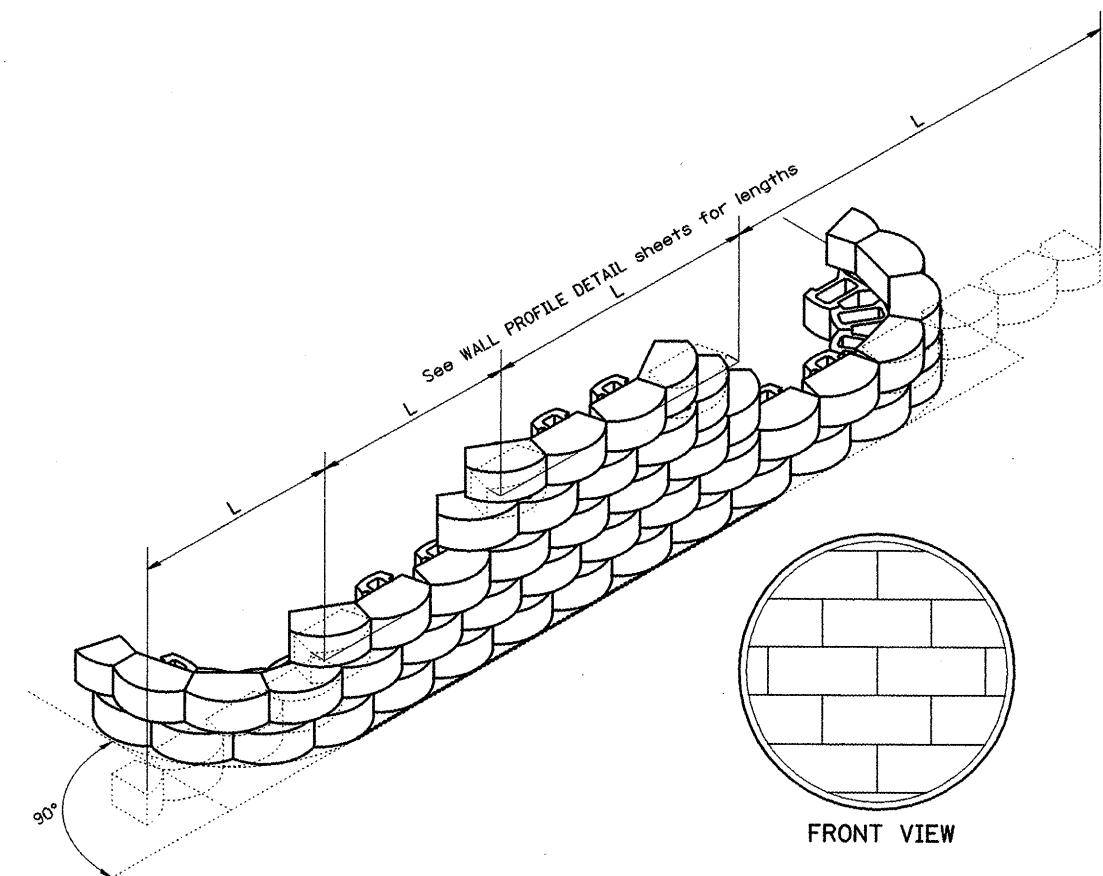

**INSTALLATION OF COURSES IN RUNNING BOND**

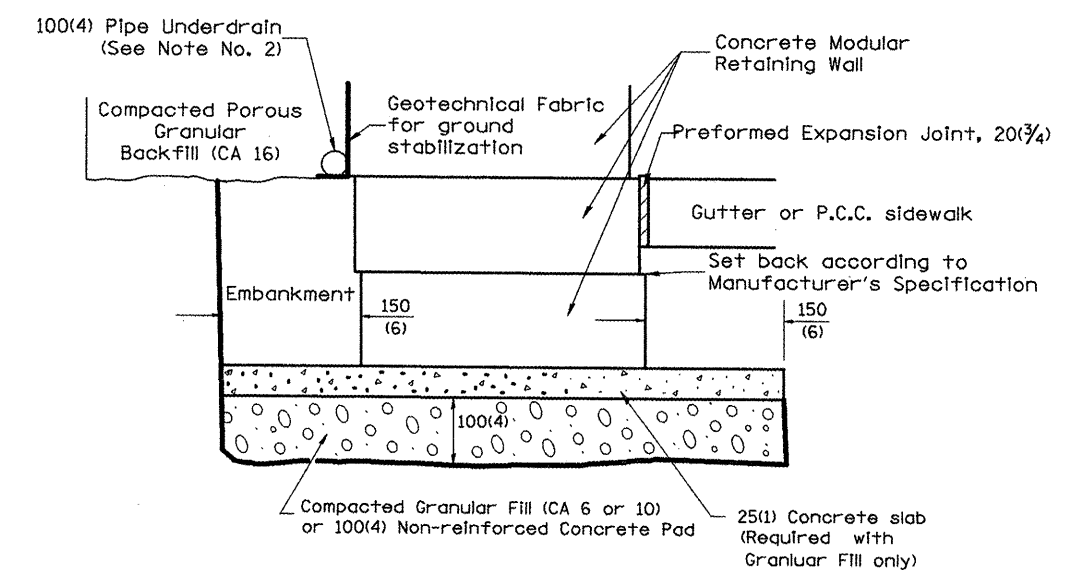

**LEVELING BASE PAD DETAIL**

**NOTES:**

1. At the Contractor's option the portion of the stone wall below top of sidewalk elevation may be constructed with class SI concrete. The width shall match the width of the modular block plus the 300(12) maximum trench.
2. 100(4) Pipe Underdrains shall outlet into inlets or storm sewer.
3. Pipe drains and pipe underdrains shall meet the requirements of the applicable portions of section 601 of the Standard Specifications.
4. Preformed expansion joint filler shall be placed between the gutter or sidewalk and the wall.
5. The geotechnical fabric shall meet the requirements of the applicable portions of Sections 210 and 1080 of the Standard Specifications.

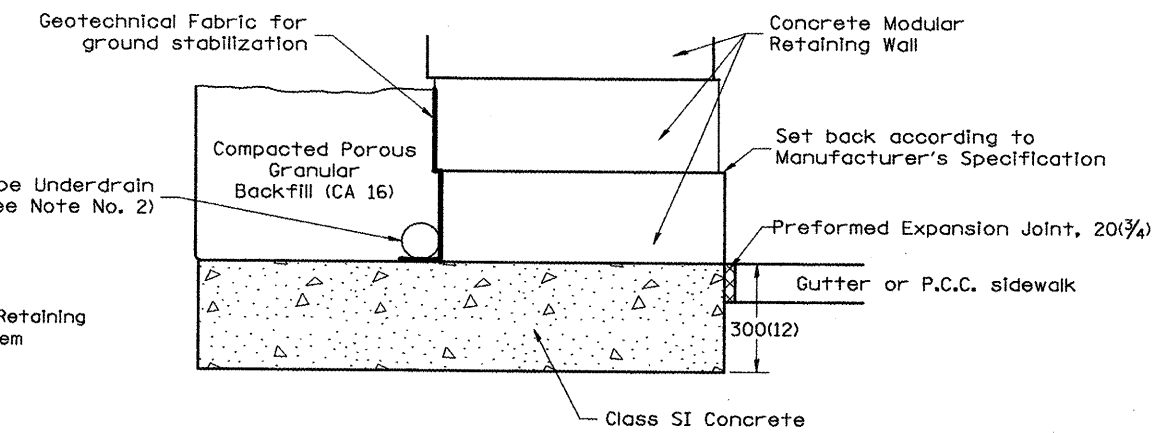
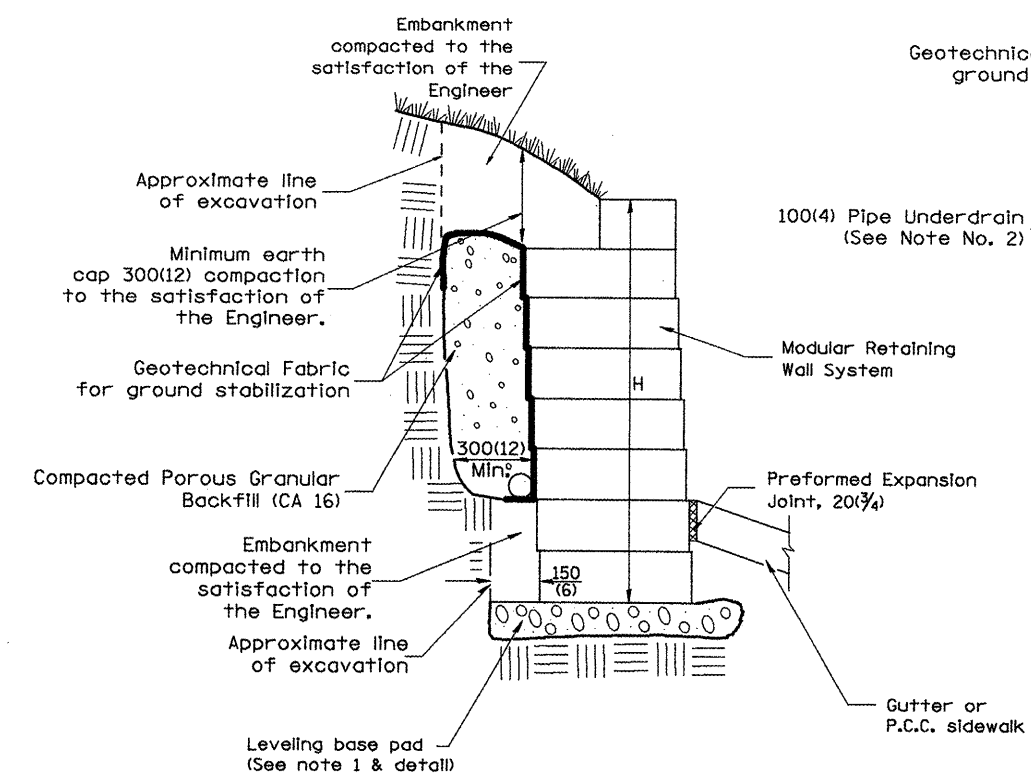

**LEVELING BASE PAD CONCRETE ALTERNATE (See Note 1)**

All dimensions are in millimeters (inches) unless otherwise noted.

ILLINOIS DEPARTMENT OF TRANSPORTATION	
DISTRICT CADD STANDARD	
MODULAR RETAINING WALL SYSTEM DETAIL	
CADD STD NO. 660101-D4	DRAWN BY CADD
SCALE: NOT DRAWN TO SCALE	CHECKED BY
DATE **DATE**	

DATE	REVISIONS	BY
1-1-97	RENUM L-5.05, NEW REVISION BOX, REVISED TITLE BOX	T.P.

1. Use in conjunction with Special Provisions for Modular Retaining Wall System, with name of three systems specified.  
 2. Use in conjunction with Special Provisions for Pipe Underdrains, CA 16, without Fabric Envelope.

DATE