

DATE: _____ BY: _____
 PLAN: _____
 SURVEYED: _____
 PLOTTED: _____
 CHECKED: _____
 NOTE BOOK: _____
 NO. _____
 STRUCTURE: _____
 NOTATION: _____

DATE: _____ BY: _____
 PROFILE: _____
 SURVEYED: _____
 PLOTTED: _____
 CHECKED: _____
 NOTE BOOK: _____
 NO. _____
 STRUCTURE: _____
 NOTATION: _____

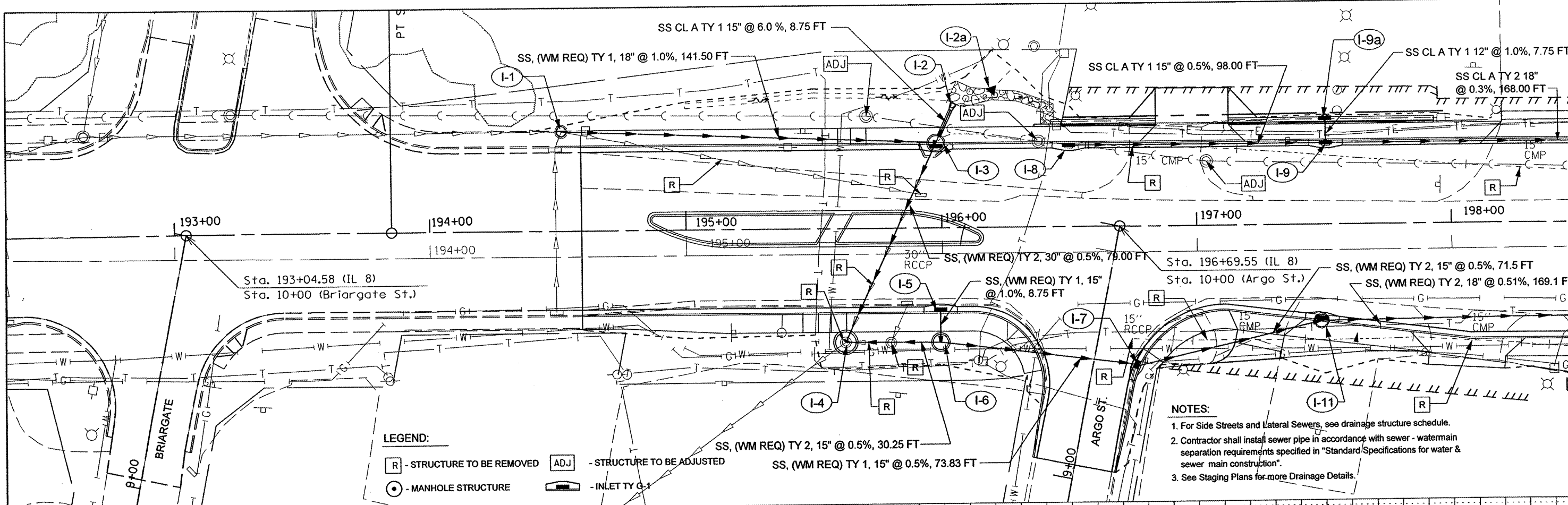

NOTES:
 1. For Side Streets and Lateral Sewers, see drainage structure schedule.
 2. Contractor shall install sewer pipe in accordance with sewer - watermain separation requirements specified in "Standard Specifications for water & sewer main construction".
 3. See Staging Plans for more Drainage Details.

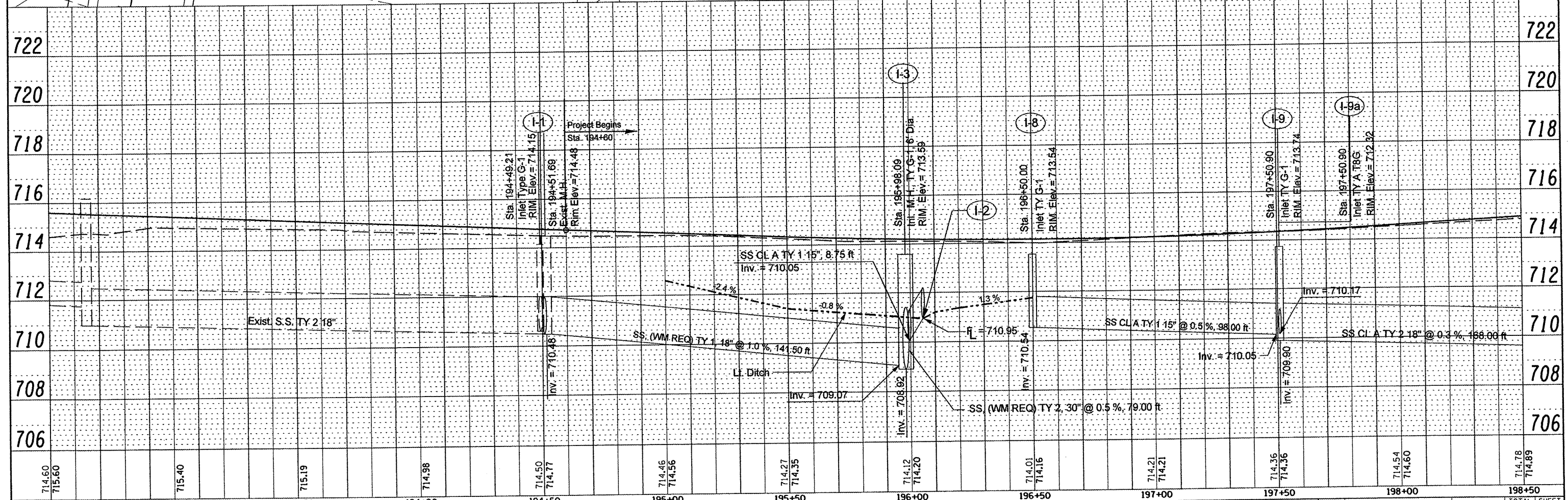

FILE NAME =	USER NAME = #USER#	DESIGNED - ENE	REVISED -	STATE OF ILLINOIS DEPARTMENT OF TRANSPORTATION	ILLINOIS ROUTE 8 DRAINAGE PLANS LT SIDE	F.A.U. RTE.	SECTION	COUNTY	TOTAL SHEETS	SHEET NO.
#FILE#	DRAWN - LEC	REVISED -	6775			04-00141-00-PP	TAZEWELL	187	73	
PLOT SCALE = #SCALE#	CHECKED - ENE	REVISED -	CONTRACT NO. 89352							
PLOT DATE = #DATE#	DATE	REVISED -	FED. ROAD DIST. NO. ILLINOIS FED. AID PROJECT							

MATCHLINE STA. 198+50.00
SEE ILLINOIS ROUTE 8 DRAINAGE PLANS LT SIDE
SHEET 2 OF 3