

Notes: Four steps monolithically with cap.

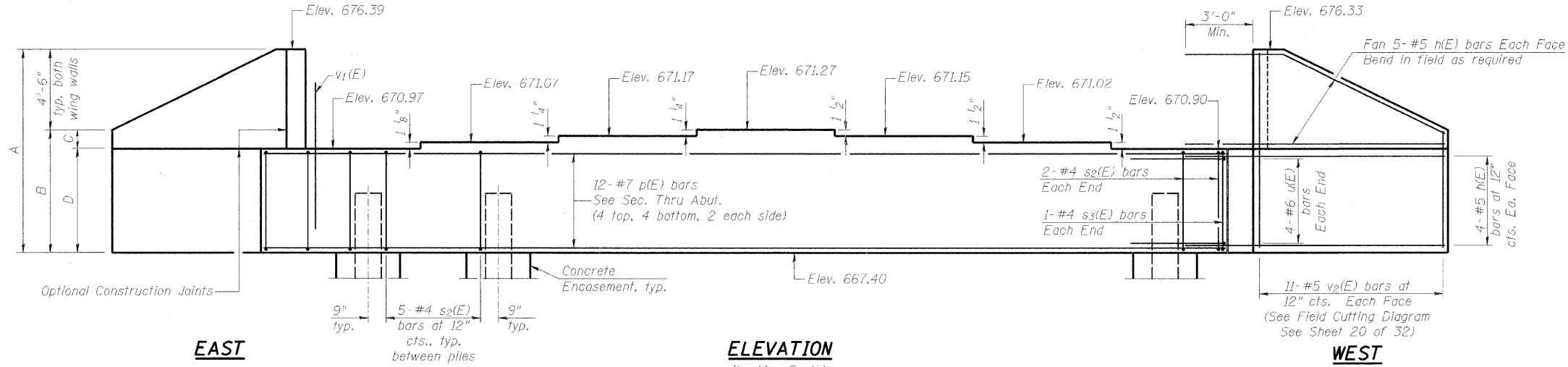

**BILL OF MATERIAL**

Bar	No.	Size	Length	Shape
n(E)	36	#5	14'-0"	
p(E)	12	#7	42'-10"	
s2(E)	39	#4	11'-5"	
s3(E)	2	#4	11'-9"	
u(E)	8	#6	9'-5"	
v1(E)	80	#5	4'-4"	
v2(E)	22	#5	12'-8"	
Structure Excavation		Cu. Yd.	194	
Concrete Structures		Cu. Yd.	19.6	
Reinforcement Bars, Epoxy Coated		Pound	2,650	
Furnishing Steel Piles, HP 12x53		Foot	350	
Driving Piles		Foot	350	
Pipe Underdrains for Structures, 4"		Foot	82	
Geocomposite Wall Drain		Sq. Yd.	49	
Porous Granular Embankment (Special)		Cu. Yd.	100	
Test Pile, HP 12x53		Each	1	
Concrete Encasement		Cu. Yd.	2.8	
Concrete Headwall for Pipe Drains		Each	2	

**WING WALL DIMENSIONS**

	East	West
A	8'-11 7/8"	8'-11 7/8"
B	4'-5 7/8"	4'-5 7/8"
C	11"	11 1/2"
D	3'-6 7/8"	3'-6"

1. For Pile Details and Concrete Encasement, see Sht. 21 of 32.
2. For Section Thru Abutment, Bar Bends and Bar Cutting Diagram see Sht. 20 of 32.

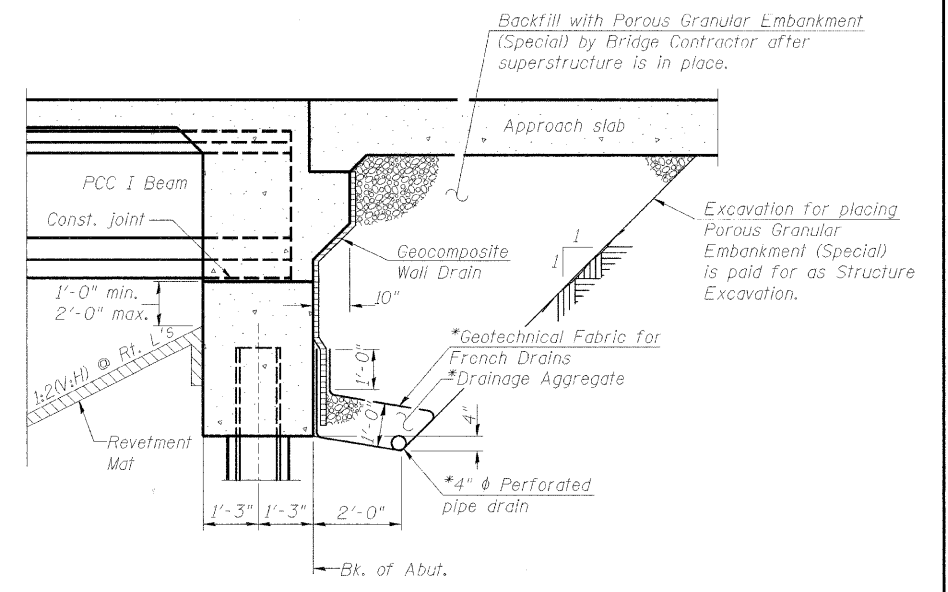
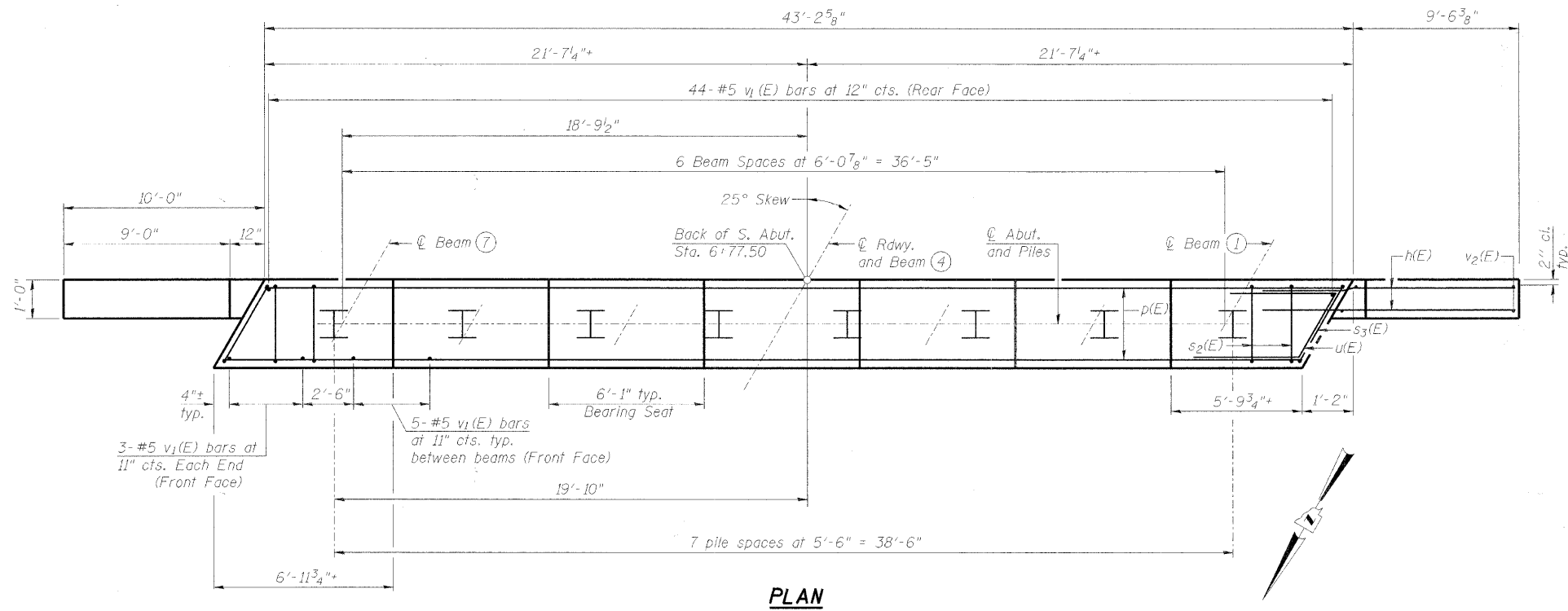

**SECTION THRU INTEGRAL ABUTMENT**

(Horiz. dim. @ Rt. L's)  
Typ. Both Abutments

Note: \*Included in the cost of Pipe Underdrains for Structures.  
All drainage system components shall extend to 2'-0" from the end of each wingwall except an outlet pipe shall extend until intersecting with the side slopes. The pipes shall drain into concrete headwalls. (See Article 601.05 of the Standard Specifications and Highway Standard 601101).

**SOUTH ABUTMENT DETAILS  
ELMORE ROAD BRIDGE  
OVER FRENCH CREEK**

DESIGNED P.J.L.	
CHECKED	LLV
DRAWN	MGM
CHECKED	P.J.L.

**PILE DATA**  
Type: HP 12x53  
Nominal Required Bearing: 419 kips  
Factored Resistance Available: 209.5 kips  
Est. Length: 50 ft.  
No. Production Piles: 7  
No. Test Piles: 1

**AECOM**  
111 NE Jefferson Ave.  
Peoria, Illinois 61602  
Ph: 309.676.8464  
Fax: 309.676.5445  
IL Design Firm Reg.  
No. 184-001518  
www.aecom.com

HWY	SECTION	COUNTY	TOTAL SHEETS	SHEET NO.
R-15	08-00092-00-BR	PEORIA	32	19
STRUCTURE NO. 072-3147		STATION 7+27		
FED. ROAD DIST. NO. ILLINOIS		FED. AID PROJECT BROS-0143(049)		