

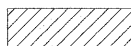

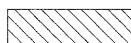

LEGEND - DRIVEWAYS

-  PORTLAND CEMENT CONCRETE DRIVEWAY PAVEMENT, 6"
-  PORTLAND CEMENT CONCRETE DRIVEWAY PAVEMENT, 8"
-  INCIDENTAL HOT-MIX ASPHALT SURFACING
-  AGGREGATE SURFACE COURSE, TYPE A
-  DETECTABLE WARNING
-  PAVEMENT PATCHING, TYPE IV, 9 INCH

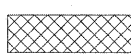
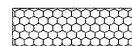

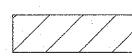
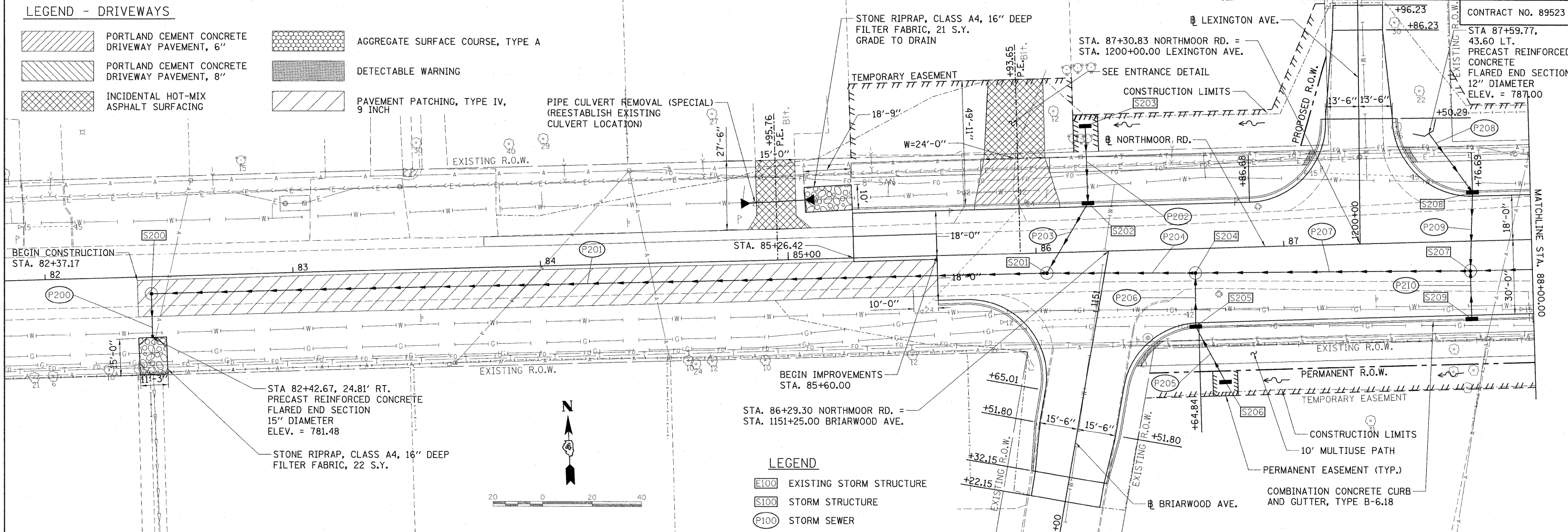
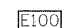
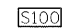
LEGEND

-  EXISTING STORM STRUCTURE
-  STORM STRUCTURE
-  STORM SEWER

STRUCTURE NUMBER	STATION	OFFSET	TYPE	RIM ELEVATION	INVERT ELEVATIONS			
					N	S	E	W
S200	82+42.67	6.85	RT. MANHOLES, TYPE A, 8"-DIAMETER, TYPE 1 FRAME, CLOSED LID	786.41		781.43	781.43	
S201	86+04.13	8.18	RT. MANHOLES, TYPE A, 8"-DIAMETER, TYPE 1 FRAME, CLOSED LID	788.26	783.86		781.72	781.72
S202	86+21.54	18.83	LT. INLETS, TYPE G-1	787.99	784.20	784.10		
S203	86+21.53	50.18	LT. INLETS, TYPE A, TYPE 8 GRATE	786.22		784.77		
S204	86+64.06	9.81	RT. MANHOLES, TYPE A, 5"-DIAMETER, TYPE 1 FRAME, CLOSED LID	788.70		784.41	781.98	781.98
S205	86+63.56	30.83	RT. INLETS, TYPE G-1	788.11	784.61	785.69		
S206	86+75.00	54.41	RT. INLETS, TYPE A, TYPE 8 GRATE	788.10	786.60			
S207	87+75.00	12.00	RT. CATCH BASINS, TYPE A, 5' DIAMETER, TYPE 1 FRAME, CLOSED LID	789.99	786.02	782.39	782.09	782.09
S208	87+75.00	18.83	LT. INLETS, TYPE G-1	789.73	786.66	786.23		
S209	87+75.00	30.83	RT. INLETS, TYPE G-1	789.49	782.54			

PIPE NUMBER	FROM STRUCTURE	U/S INVERT	TO STRUCTURE	D/S INVERT	CLASS/TYPE	DIAMETER	LENGTH	SLOPE	TRENCH BACKFILL
P200	S200	781.43	OUTLET	781.38	STORM SEWERS, CLASS A, TYPE 2	15	15.5	0.32%	2.9
P201	S201	781.72	S200	781.43	PRECAST CONCRETE BOX CULVERT	5x2'	353.5	0.08%	468.1
P202	S203	784.77	S202	784.20	STORM SEWERS, CLASS A, TYPE 2	12	29.5	1.93%	5.7
P203	S202	784.10	S201	783.86	STORM SEWERS, CLASS A, TYPE 2	12	27.5	0.87%	9.4
P204	S204	781.98	S201	781.72	STORM SEWERS, CLASS A, TYPE 2	42	54.0	0.48%	56.1
P205	S206	786.60	S205	785.69	STORM SEWERS, CLASS A, TYPE 1	12	23.5	3.87%	3.1
P206	S205	784.61	S204	784.41	STORM SEWERS, CLASS A, TYPE 2	12	17.5	1.14%	6.0
P207	S207	782.09	S204	781.98	STORM SEWERS, CLASS A, TYPE 2	42	106.0	0.10%	132.9
P208	HEADWALL	787.00	S208	786.66	STORM SEWERS, CLASS A, TYPE 2	12	28.0	1.21%	3.7
P209	S208	786.23	S207	786.02	STORM SEWERS, CLASS A, TYPE 2	12	27.0	0.78%	8.6
P210	S209	782.54	S207	782.39	STORM SEWERS, CLASS A, TYPE 2	12	15.0	1.00%	15.7

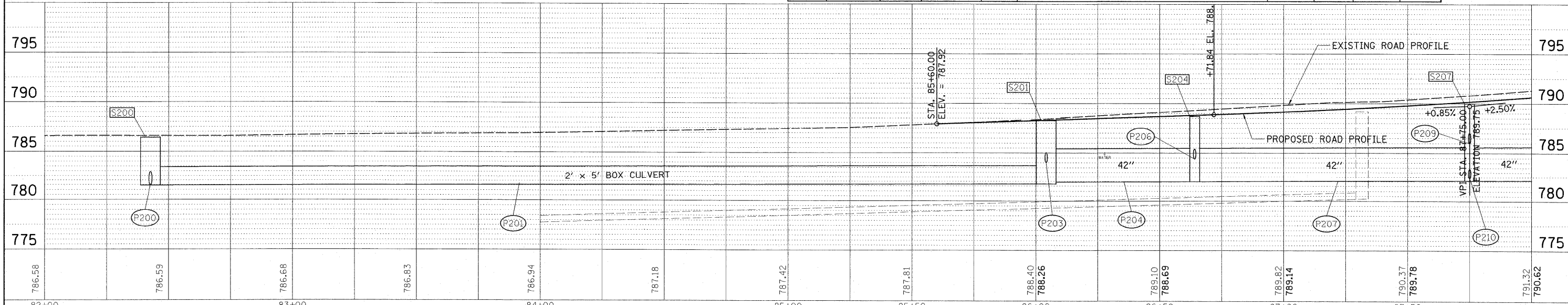

DATE: _____ BY: _____
 PLAN SURVEYED _____
 NOTE BOOK _____
 NO. _____

DATE: _____ BY: _____
 PROFILE SURVEYED _____
 NOTE BOOK _____
 NO. _____

DATE: _____ BY: _____
 STRUCTURE NOTATIONS CHECKED _____
 NO. _____

FILE NAME = I:\09Jobs\09L0027\CADD\Road\Sheet\c-781m.dgn	USER NAME = Ander00846	DESIGNED - MPB	REVISED -
PLOT SCALE = 20.0000' / in.	DRAWN - RLA	CHECKED - CAL	REVISED -
PLOT DATE = 04/01/2010	DATE - 03/19/10		REVISED -

**STATE OF ILLINOIS
 DEPARTMENT OF TRANSPORTATION**

NORTHMOOR RD. PLAN AND PROFILE

SCALE: 1"=20' SHEET NO. OF SHEETS STA. 85+26.42 TO STA. 88+00.00

F.A. RTE.	SECTION	COUNTY	TOTAL SHEETS	SHEET NO.
6647	08-00302-00-TL	PEORIA	102	21
6595	09-00047-02-TL			

CONTRACT NO. 89523
 FED. ROAD DIST. NO. ILLINOIS FED. AID PROJECT M-509(138)

MATCHLINE STA. 88+00.00

CONTRACT NO. 89523
 STA 87+59.77,
 43.60 LT.
 PRECAST REINFORCED
 CONCRETE
 FLARED END SECTION
 12" DIAMETER
 ELEV. = 787.00