

LEGEND

- E100 EXISTING STORM STRUCTURE
- S100 STORM STRUCTURE
- P100 STORM SEWER

PROPOSED WATERMAIN RELOCATION REFER TO COOPERATION WITH UTILITY COMPANIES SPECIAL PROVISION

LEGEND - DRIVEWAYS

- PORTLAND CEMENT CONCRETE DRIVEWAY PAVEMENT, 6"
- PORTLAND CEMENT CONCRETE DRIVEWAY PAVEMENT, 8"
- INCIDENTAL HOT-MIX ASPHALT SURFACING
- AGGREGATE SURFACE COURSE, TYPE A
- DETECTABLE WARNING
- CLASS D PATCHES, TYPE IV

STRUCTURE NUMBER	STATION	OFFSET	TYPE	RIM ELEVATION	INVERT ELEVATIONS			
					N	S	E	W
S141	252+02.00	42.77	RT. INLET, TYPE A, TYPE 8 GRATE	795.20		793.70		
S210	89+00.00	12.00	RT. MANHOLES, TYPE A, 5'-DIAMETER, TYPE 1 FRAME, CLOSED LID	792.66	788.66	786.41	782.21	
S211	89+00.00	18.83	LT. INLETS, TYPE G-1	792.43		788.93		
S212	89+00.00	30.82	RT. INLETS, TYPE G-1	792.19	786.56			
S213	90+95.68	69.43	LT. INLETS, TYPE G-1	796.87		793.37		

PIPE NUMBER	FROM STRUCTURE	U/S INVERT	TO STRUCTURE	D/S INVERT	CLASS/TYPE	DIAMETER	LENGTH	SLOPE	TRENCH BACKFILL
P212	S211	788.93	S210	788.66	STORM SEWERS, CLASS A, TYPE 2	12	27.0	1.00%	8.6
P213	S212	786.56	S210	786.41	STORM SEWERS, CLASS A, TYPE 2	12	15.0	1.00%	12.8
P214	S213	793.37	E102	792.36	STORM SEWERS, CLASS A, TYPE 2	12	101.5	1.00%	26.1

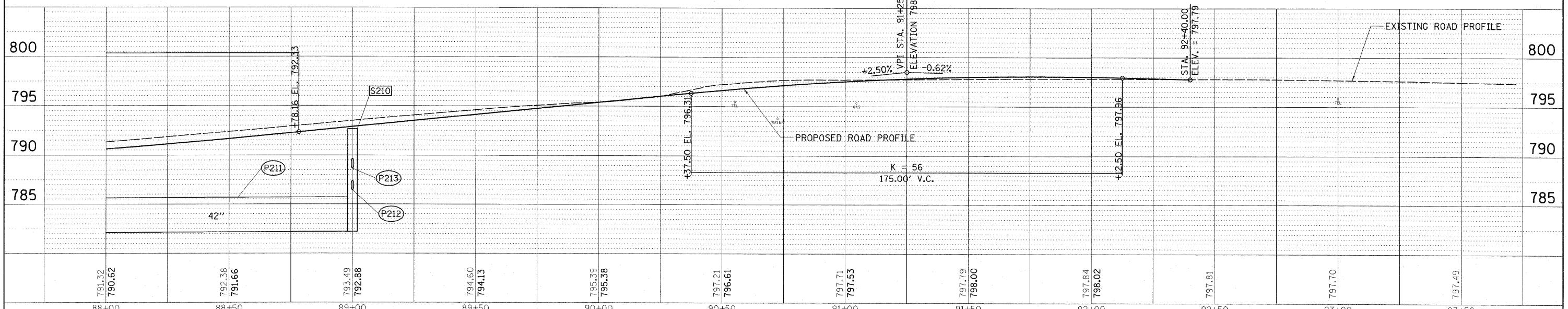

PLAN SURVEYED BY DATE
 CHECKED BY DATE
 NOTE BOOK NO. RT. OF WAY CHECKED
 NO. ADD FILE NAME

© Copyright Hanson Professional Services Inc. 2010
HANSON
 Hanson Professional Services Inc.

PROFILE SURVEYED BY DATE
 CHECKED BY DATE
 NOTE BOOK NO. GRADES CHECKED
 NO. B.M. NOTED
 STRUCTURE NOTATING CIRCD