

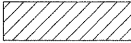

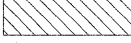

PLAN	SURVEYED	BY	DATE
	PLOTTED		
	CHECKED		
	NO. OF WAY CHECKED		
	PAID FILE NAME		

© Copyright Hanson Professional Services Inc. 2010
HANSON
 Hanson Professional Services Inc.

PROFILE	SURVEYED	BY	DATE
	PLOTTED		
	CHECKED		
	NO. OF WAY CHECKED		
	STRUCTURE NOTATIONS CHK'D		

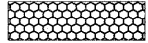
LEGEND - DRIVEWAYS

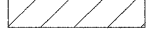
-  PORTLAND CEMENT CONCRETE DRIVEWAY PAVEMENT, 6"
-  PORTLAND CEMENT CONCRETE DRIVEWAY PAVEMENT, 8"
-  INCIDENTAL HOT-MIX ASPHALT SURFACING
-  AGGREGATE SURFACE COURSE, TYPE A
-  DETECTABLE WARNING
-  CLASS D PATCHES, TYPE IV

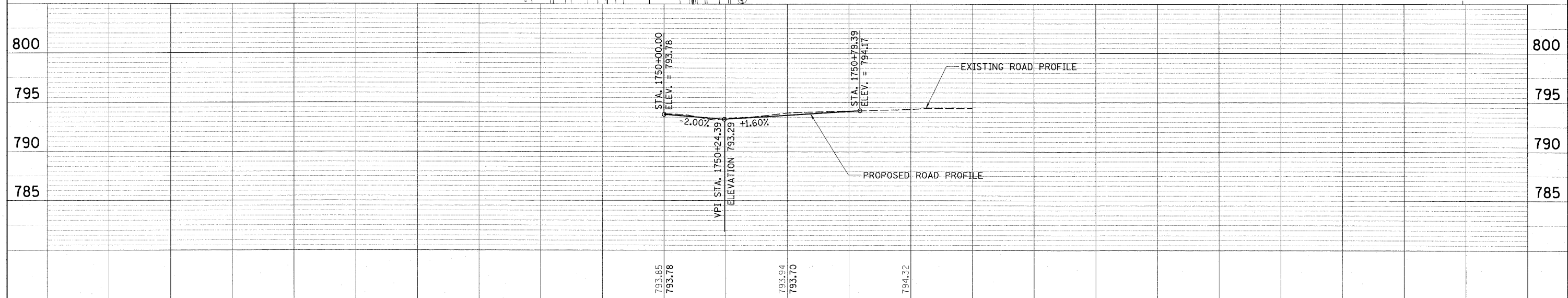
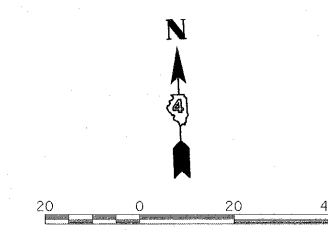
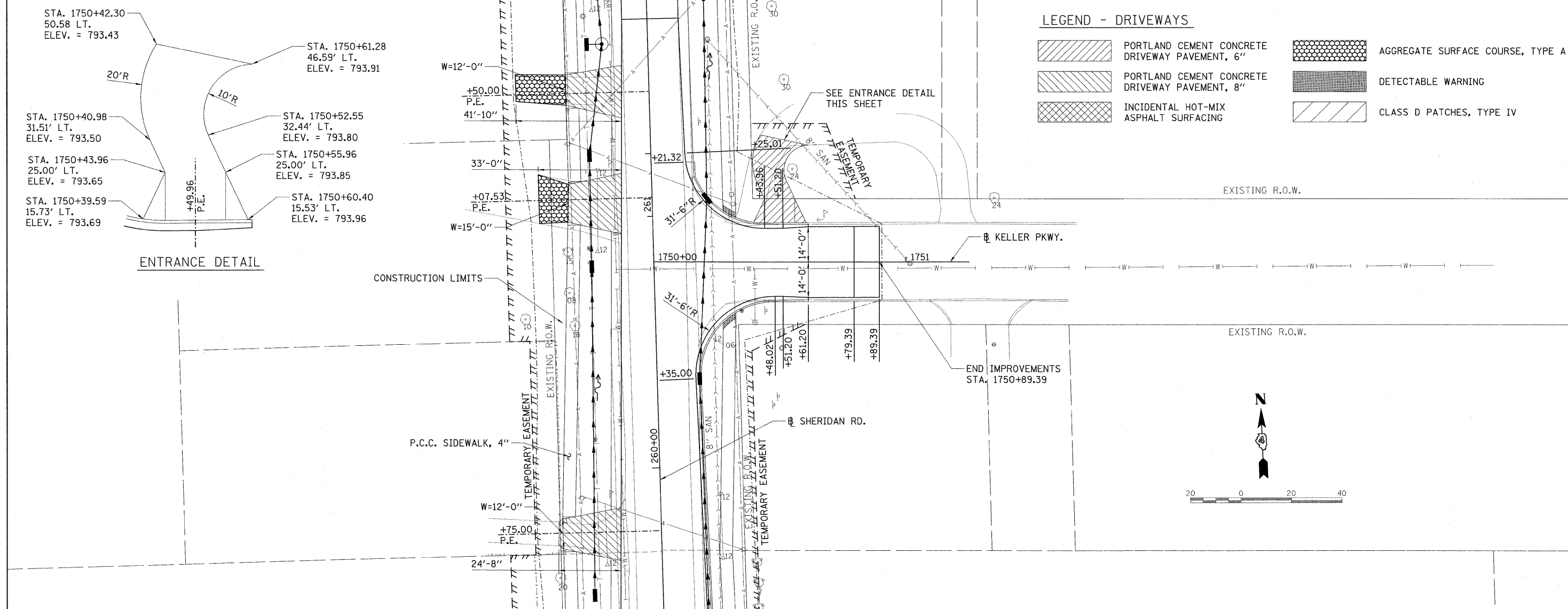

FILE NAME =	USER NAME = Ander-00846	DESIGNED - MPB	REVISED -	STATE OF ILLINOIS DEPARTMENT OF TRANSPORTATION	KELLER PKWY. PLAN AND PROFILE	F.A. RTE.	SECTION	COUNTY	TOTAL SHEETS	SHEET NO.
1:\89523\08-00302-00-TL\CADD\Road\Sheet\0-708kpl.dgn	PLOT SCALE = 20,0000' / 1in.	DRAWN - RLA	REVISED -			6647	08-00302-00-TL	PEORIA	102	28
PLOT DATE = 03/19/10	DATE = 03/19/10	CHECKED - CAL	REVISED -			6595	09-00047-02-TL			
		DATE = 03/19/10	REVISED -			CONTRACT NO. 89523				

SCALE: 1"=20' SHEET NO. OF SHEETS STA. 1750+00.00 TO STA. 1750+89.39 FED. ROAD DIST. NO. ILLINOIS FED. AID PROJECT M-5093(136)