

Pay Item #	Pay Item	Unit	Quantity
72000100	SIGN PANEL, TYPE 1	SQ. FT.	12
80500205	SERVICE INSTALLATION, TYPE B (MODIFIED)	EACH	1
81012600	CONDUIT IN TRENCH, 2" DIA., PVC	FOOT	195
81012800	CONDUIT IN TRENCH, 3" DIA., PVC	FOOT	248
81013000	CONDUIT IN TRENCH, 4" DIA., PVC	FOOT	125
81400700	HANDHOLE, PORTLAND CEMENT CONCRETE	EACH	4
81400720	DOUBLE HANDHOLE, PORTLAND CEMENT CONCRETE	EACH	1
81900200	TRENCH AND BACKFILL FOR ELECTRICAL WORK	FOOT	568
82102250	LUMINAIRE, SODIUM VAPOR, HORIZONTAL MOUNT, 250 WATT	EACH	4
85700205	FULL-ACTUATED CONTROLLER AND TYPE IV CABINET, SPECIAL	EACH	1
87301245	ELECTRIC CABLE IN CONDUIT, SIGNAL, NO. 14 5C	FOOT	1615
87301255	ELECTRIC CABLE IN CONDUIT, SIGNAL, NO. 14 7C	FOOT	2457
87301515	ELECTRIC CABLE IN CONDUIT, LEAD-IN, NO. 18 3 PAIR	FOOT	612
87502510	TRAFFIC SIGNAL POST, GALVANIZED STEEL, 17 FT.	EACH	1
87702940	STEEL COMBINATION MAST ARM ASSEMBLY AND POLE 42 FT.	EACH	1
87702950	STEEL COMBINATION MAST ARM ASSEMBLY AND POLE 44 FT.	EACH	1
87702980	STEEL COMBINATION MAST ARM ASSEMBLY AND POLE 50 FT.	EACH	1
87702990	STEEL COMBINATION MAST ARM ASSEMBLY AND POLE 54 FT.	EACH	1
87800100	CONCRETE FOUNDATION, TYPE A	FOOT	3
87800215	CONCRETE FOUNDATION, TYPE D	FOOT	3.5
87800415	CONCRETE FOUNDATION, TYPE E, 36-INCH DIAMETER	FOOT	56
88040070	SIGNAL HEAD, POLYCARBONATE, LED, 1-FACE, 3-SECTION, BRACKET MOUNTED	EACH	2
88040090	SIGNAL HEAD, POLYCARBONATE, LED, 1-FACE, 3-SECTION, MAST ARM MOUNTED	EACH	4
88040120	SIGNAL HEAD, POLYCARBONATE, LED, 1-FACE, 4-SECTION, MAST ARM MOUNTED	EACH	4
88040110	SIGNAL HEAD, POLYCARBONATE, LED, 1-FACE, 4-SECTION, BRACKET MOUNTED	EACH	4
88040160	SIGNAL HEAD, POLYCARBONATE, LED, 1-FACE, 5-SECTION, MAST ARM MOUNTED	EACH	2
88102717	PEDESTRIAN SIGNAL HEAD, LED, 1-FACE, BRACKET MOUNTED WITH COUNTDOWN TIMER	EACH	8
88200110	TRAFFIC SIGNAL BACKPLATE, LOUVERED	EACH	16
88500100	INDUCTIVE LOOP DETECTOR	EACH	10
88600100	DETECTOR LOOP, TYPE 1	FOOT	1801
88700200	LIGHT DETECTOR	EACH	4
88800100	PEDESTRIAN PUSH BUTTON	EACH	8
X0324134	BATTERY BACKUP SYSTEM WITH CABINET	EACH	1
X0324475	ELECTRIC CABLE IN CONDUIT NO. 6, 1/C	FOOT	2560
X8710022	FIBER OPTIC CABLE IN CONDUIT NO. 62.5/125, 2-MM12F & SM12F	FOOT	1856

NOTES:
1. ALL DISTURBED AREAS SHALL BE RESTORED AND LANDSCAPED TO PRIOR CONDITION.

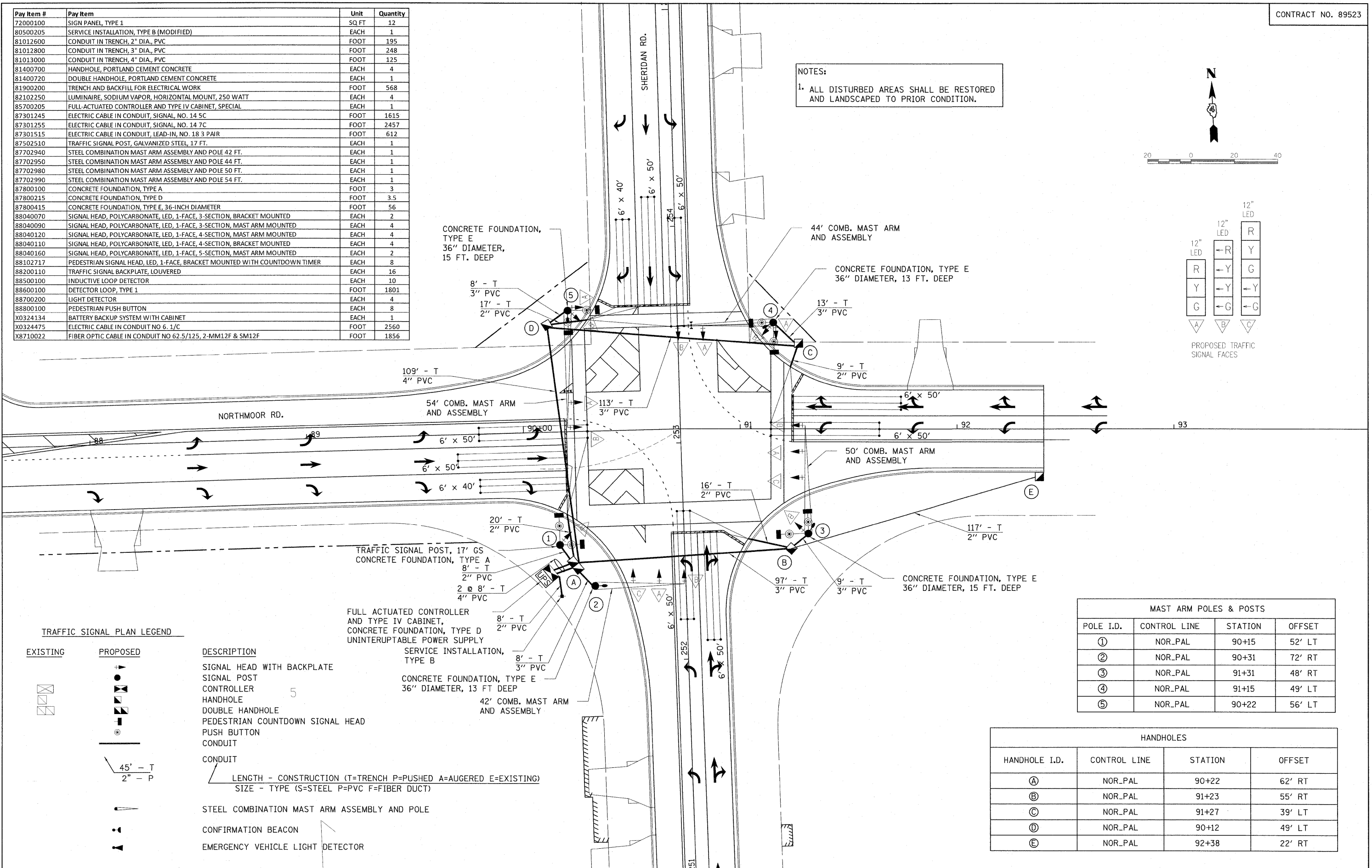

TRAFFIC SIGNAL PLAN LEGEND

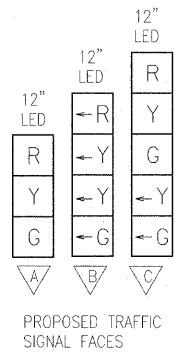
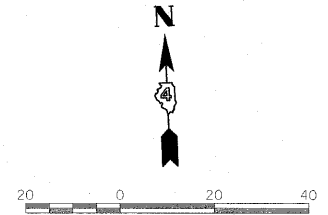
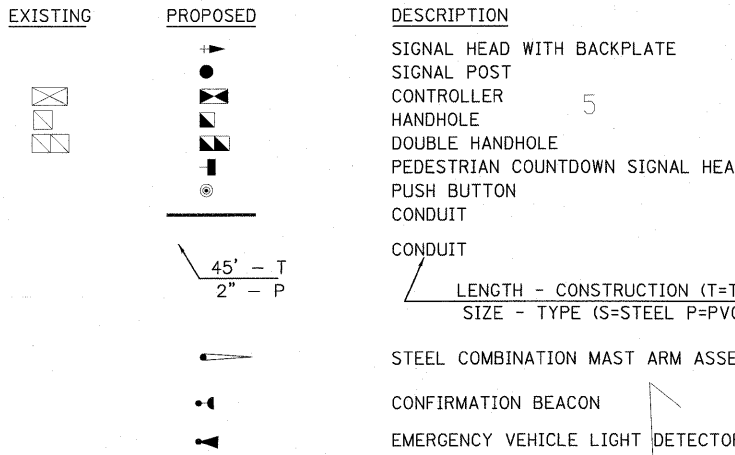

FULL ACTUATED CONTROLLER AND TYPE IV CABINET, CONCRETE FOUNDATION, TYPE D UNINTERRUPTIBLE POWER SUPPLY
 SERVICE INSTALLATION, TYPE B
 CONCRETE FOUNDATION, TYPE E 36" DIAMETER, 13 FT DEEP
 42' COMB. MAST ARM AND ASSEMBLY

MAST ARM POLES & POSTS			
POLE I.D.	CONTROL LINE	STATION	OFFSET
①	NOR_PAL	90+15	52' LT
②	NOR_PAL	90+31	72' RT
③	NOR_PAL	91+31	48' RT
④	NOR_PAL	91+15	49' LT
⑤	NOR_PAL	90+22	56' LT

HANDHOLES			
HANDHOLE I.D.	CONTROL LINE	STATION	OFFSET
Ⓐ	NOR_PAL	90+22	62' RT
Ⓑ	NOR_PAL	91+23	55' RT
Ⓒ	NOR_PAL	91+27	39' LT
Ⓓ	NOR_PAL	90+12	49' LT
Ⓔ	NOR_PAL	92+38	22' RT

© Copyright Hanson Professional Services Inc. 2010
HANSON
 Hanson Professional Services Inc.