

F.A.S. RTE.	SECTION	COUNTY	TOTAL SHEETS	SHEET NO.
1472	07-00073-09-WR	McLEAN	8	1
FED. ROAD DIST. NO. 5		ILLINOIS	CONTRACT NO. 91434	

**INDEX OF SHEETS**

- 1. COVER SHEET
- 2-3. TYPICAL CROSS SECTIONS
- 4-5. DETAILS
- 6-8. PLAN SHEETS

**STATE STANDARD DETAILS**

701001-02	OFF-RD OPERATIONS, 2L, 2W, MORE THAN 15' AWAY
701006-03	OFF-RD OPERATIONS, 2L, 2W, 15' TO 24" FROM PAVEMENT EDGE
701011-02	OFF-RD MOVING OPERATIONS, 2L, 2W, DAY ONLY
701201-03	LANE CLOSURE, 2L, 2W, DAY ONLY, FOR SPEEDS > 45 MPH
701301-03	LANE CLOSURE, 2L, 2W, SHORT TIME OPERATIONS
701326-03	LANE CLOSURE, 2L, 2W, PAVEMENT WIDENING, FOR SPEEDS > 45 MPH
701306-02	LANE CLOSURE, 2L, 2W, SLOW MOVING OPERATIONS DAY ONLY, FOR SPEEDS > 45 MPH
701901-01	TRAFFIC CONTROL DEVICES
781001-03	TYPICAL APPLICATIONS RAISED REFLECTIVE PAVEMENT MARKERS

**SUMMARY OF QUANTITIES**

ITEM NUMBER	ITEM	UNIT	QUANTITY
* 20200500	EARTH EXCAVATION (WIDENING)	CU YD	848
35600700	HOT-MIX ASPHALT BASE COURSE WIDENING, 6"	SQ YD	5,086
* 40600100	BITUMINOUS MATERIALS (PRIME COAT)	GALLON	4,100
* 40600300	AGGREGATE (PRIME COAT)	TON	200
* 40600625	LEVELING BINDER (MACHINE METHOD), N50	TON	2,100
40600982	HOT-MIX ASPHALT SURFACE REMOVAL - BUTT JOINT	SQ YD	286
40600990	TEMPORARY RAMP	SQ YD	40
* 40603080	HOT-MIX ASPHALT BINDER COURSE, IL-19.0, N50	TON	5,200
* 40603310	HOT-MIX ASPHALT SURFACE COURSE, MIX "C", N50	TON	2,900
* 40800010	BITUMINOUS MATERIALS (PRIME COAT)	GAL	200
* 40800030	AGGREGATE (PRIME COAT)	TON	15
* 40800050	INCIDENTAL HOT-MIX ASPHALT SURFACING	TON	250
* 44300300	AREA REFLECTIVE CRACK CONTROL TREATMENT, SYSTEM A	SQ YD	40,689
* 48101200	AGGREGATE SHOULDERS, TYPE B	TON	3,000
67100100	MOBILIZATION	L SUM	1
70103700	TRAFFIC CONTROL COMPLETE	L SUM	1
△ 78100100	RAISED REFLECTIVE PAVEMENT MARKER	EACH	190

\* SEE SPECIAL PROVISIONS  
 △ SPECIALTY ITEMS

J.U.L.I.E.  
 JOINT UTILITY LOCATION INFORMATION FOR EXCAVATION  
 1-800-892-0123  
 OR 811

**PROJECT ENGINEER  
 PROJECT MANAGER**

**CONTRACT NO. 91434**

STATE OF ILLINOIS  
 DEPARTMENT OF TRANSPORTATION  
 DIVISION OF HIGHWAYS  
**PLANS FOR PROPOSED  
 McLEAN COUNTY  
 FEDERAL AID SECONDARY (STP-SR)  
 PIPELINE RD (CH 31)  
 F.A.S. ROUTE 1472 SECTION 07-00073-09-WR  
 PROJECT #RS-1472(104)  
 JOB #C-95-324-10**

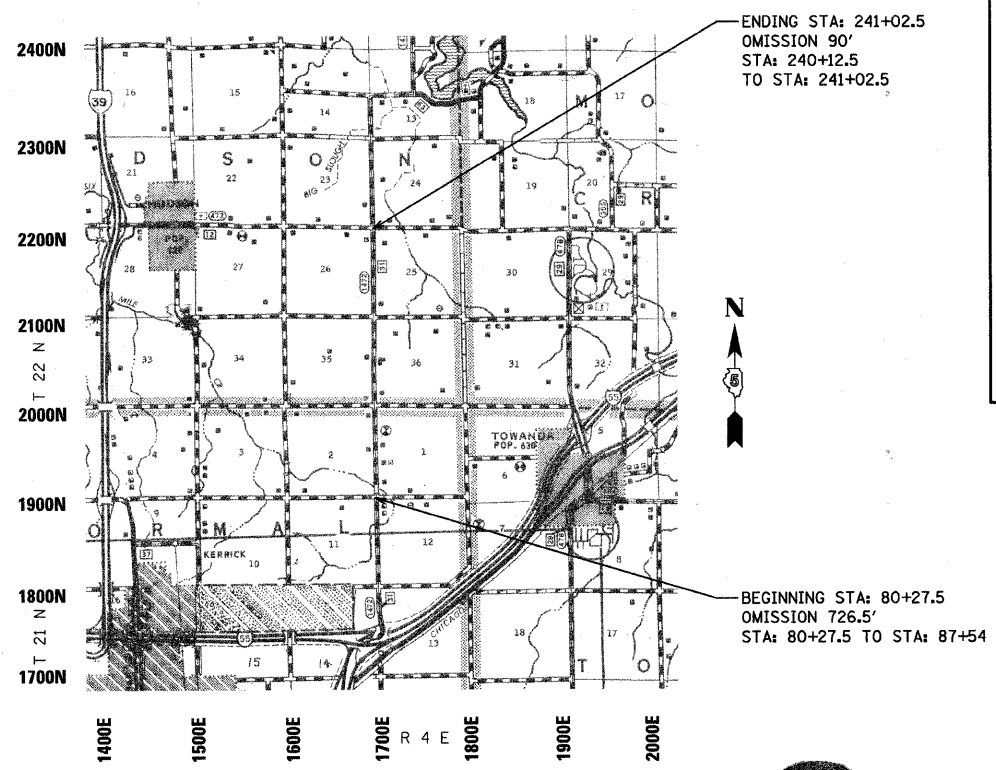
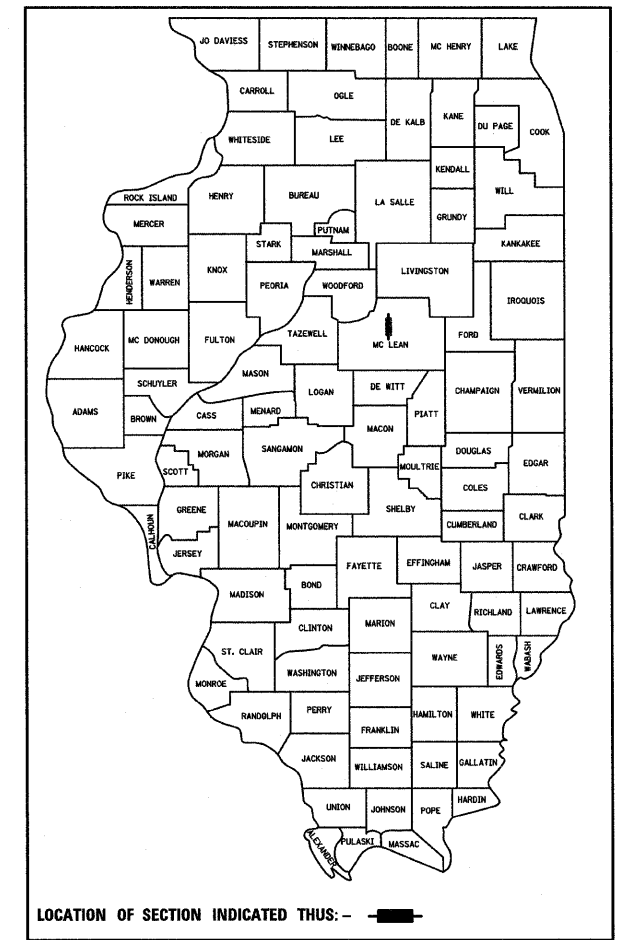

NOTE: THE TOTAL LENGTH OF THE PROPOSED PROJECT IS 16,075 FEET WITH A NET LENGTH OF 15,285.50 FEET (2.890 MILES)  
 NOTE: THESE PLANS MEET THE MINIMUM REQUIREMENTS FOR A 3R IMPROVEMENT.  
 NOTE: CURRENT ADT: 2100  
 FUNCTIONAL CLASSIFICATION: MAJOR COLLECTOR  
 NOTE: THE PLANS FOR SECTION 07-00073-09-WR ARE THOSE AS APPROVED IN SECTION 73 G.

JERRY W. STUBER  
 ILLINOIS PROFESSIONAL ENGINEER #57636  
 EXPIRES 11-30-2011

**McLEAN COUNTY  
 HIGHWAY DEPARTMENT**

APPROVED Feb. 23, 20 10  
[Signature]  
 COUNTY ENGINEER

PASSED 3/15 20 10  
[Signature]  
 DISTRICT FIVE ENGINEER OF  
 LOCAL ROADS & STREETS

Releasing For Bid Based on Limited Review MAR 16 20 10  
[Signature]  
 DEPUTY DIRECTOR OF HIGHWAYS,  
 REGION THREE ENGINEER

STATE OF ILLINOIS  
 DEPARTMENT OF TRANSPORTATION

**PRINTED BY THE AUTHORITY  
 OF THE STATE OF ILLINOIS**