

F.A.U. RTE.	SECTION	COUNTY	TOTAL SHEETS	SHEET NO.
8243	09-0003-00-RS	MONTGOMERY	10	7
STA. 8+00 TO STA. 13+50				
FED. ROAD DIST. NO.		ILLINOIS	FED. AID PROJECT	
CITY OF LITCHFIELD		93527		

TRAFFIC SIGNAL QUANTITIES IL RTE 16/UNION & STATE STREET				
CODE NO.	ITEM	UNIT	QUANTITY	
X0320872	VIDEO VEHICLE DETECTION SYSTEM	EACH	1	
89502375	REMOVE EXISTING TRAFFIC SIGNAL EQUIPMENT	EACH	1	
	ELECTRIC CABLE IN CONDUIT COMMUNICATION NO.14, 3C	FOOT	222	

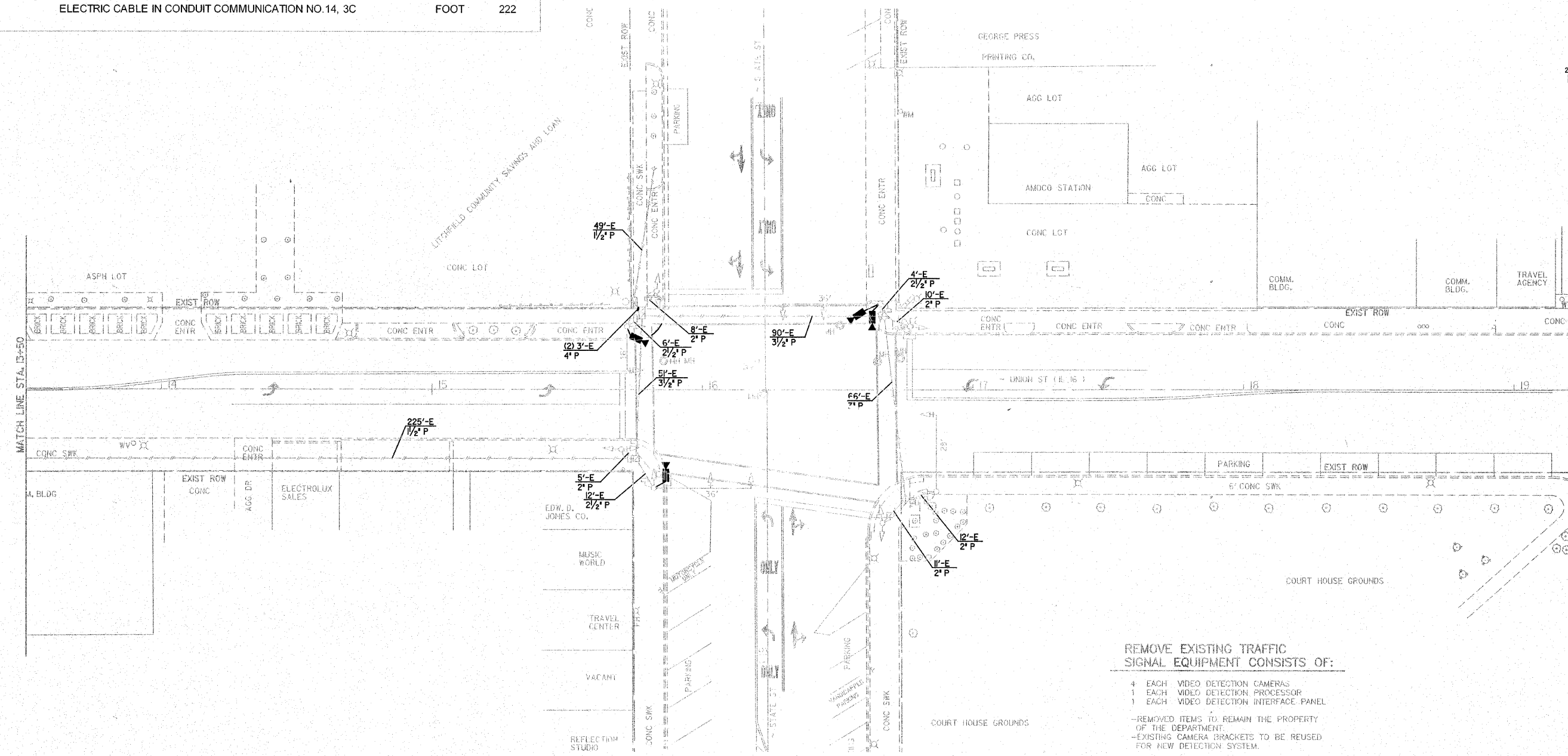
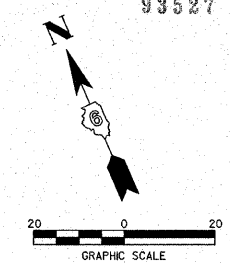

REMOVE EXISTING TRAFFIC SIGNAL EQUIPMENT CONSISTS OF:

- 4 EACH VIDEO DETECTION CAMERAS
- 1 EACH VIDEO DETECTION PROCESSOR
- 1 EACH VIDEO DETECTION INTERFACE PANEL

-REMOVED ITEMS TO REMAIN THE PROPERTY OF THE DEPARTMENT  
 -EXISTING CAMERA BRACKETS TO BE REUSED FOR NEW DETECTION SYSTEM.

REVISIONS	
NAME	DATE
PRELIM PS&E	10/23/09
PRE-FINAL	11/30/09
FINAL	2/19/10

ILLINOIS DEPARTMENT OF TRANSPORTATION  
 PROPOSED TRAFFIC SIGNAL LAYOUT

DATE: 5/06/09  
 DRAWN BY: A.J.T.  
 CHECKED BY: R.A.S.