

Existing Structure: Single span timber deck on steel stringers supported by closed timber abutments with timber wingwalls.  $\pm 30'-6"$  Bk.-Bk. Abutments,  $\pm 18'-0"$  Out.-Out. Deck. Steel Railing.  $\pm 0^\circ$  Skew.  
 Est. Quantity of Structural Steel =  $\pm 25,000$  lbs.  
 Benchmarks: BM #1 - 60d Nail & Washer in Power Pole, Sta. 6+37, 27' Rt., Elevation = 551.91  
 BM #2 - 60d Nail & Washer in Power Pole, Sta. 14+57, 26' Rt., Elevation = 546.01  
 Salvage: No Salvage

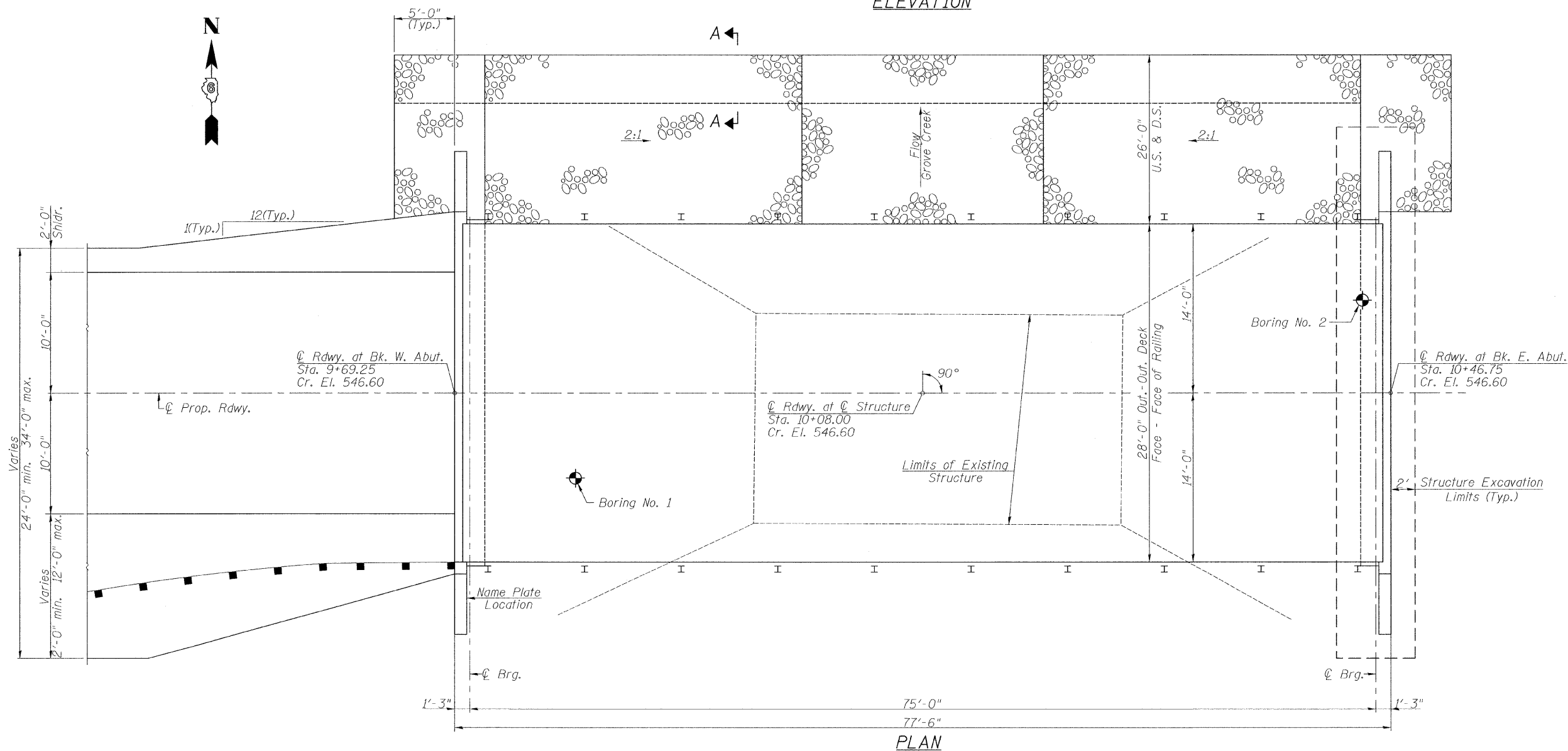

STA. 10+08.00  
 BUILT 20 BY  
 ROAD DISTRICT NO. 3  
 MENARD COUNTY  
 SECTION 08-03115-00-BR  
 PROJECT BROS-0129(025)  
 STR. NO. 065-3123 LOADING HL-93

NAME PLATE  
 (Standard 515001)

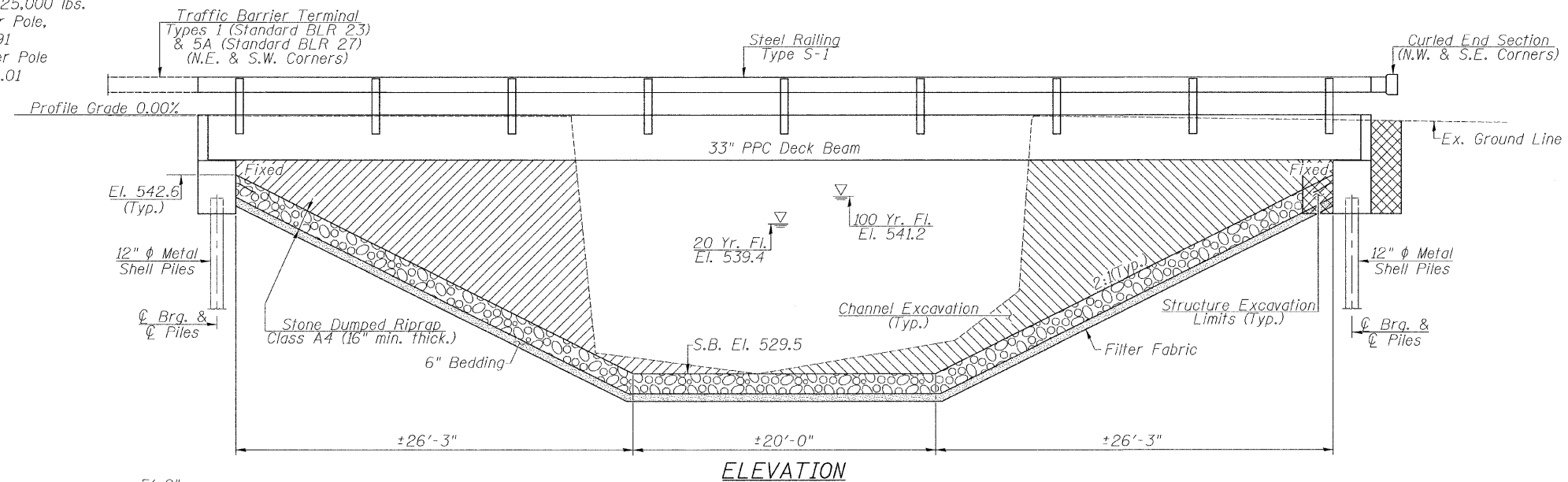
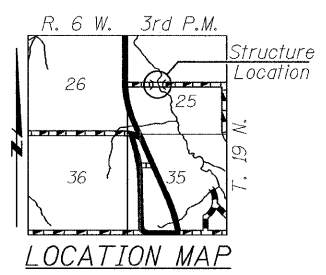

FILE NAME =	USER NAME = #USER#	DESIGNED - MAH	REVISED -	<b>Allen Henderson &amp; Associates, Inc.</b> Civil and Structural Engineers Springfield, IL. 62703 Phone: (217)544-8033 IL Design Firm No. 184-001907	<b>GENERAL PLAN &amp; ELEVATION</b>		T.R. RTE.	SECTION	COUNTY	TOTAL SHEETS	SHEET NO.
#FILE#	PLOT SCALE = #SCALE#	DRAWN - MJS	REVISED -				43	08-03115-00-BR	MENARD	15	4
	PLOT DATE = #DATE#	CHECKED -	REVISED -		SCALE: SHEET NO. 4 OF 15 SHEETS STA. 8+25.00 TO STA. 12+50.00		FED. ROAD DIST. NO. [ILLINOIS] FED. AID PROJECT		CONTRACT NO. 93530		
		DATE -	REVISED -								