

COUNTY	ROUTE	SECTION	TOTAL SHEETS	SHEET NO.
ADAMS	FAS 1603	10-00205-01-RS	12	9

STATION 270+00 TO STATION 300+00  
PROJECT NO. RS-1603(102)

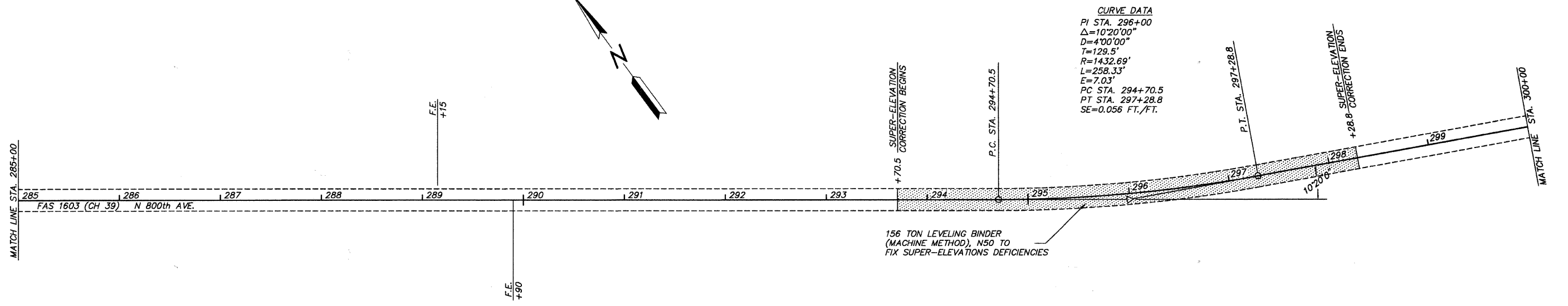
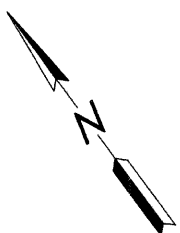
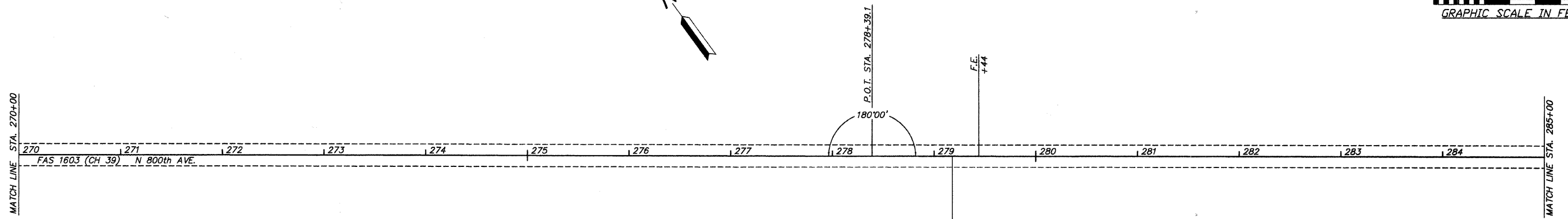
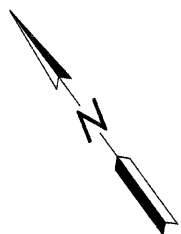
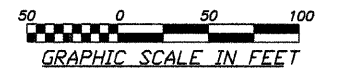

**CURVE DATA**  
 PI STA. 296+00  
 $\Delta = 10^{\circ}20'00''$   
 $D = 4^{\circ}00'00''$   
 $T = 129.5'$   
 $R = 1432.69'$   
 $L = 258.33'$   
 $E = 7.03'$   
 PC STA. 294+70.5  
 PT STA. 297+28.8  
 $SE = 0.056 \text{ FT./FT.}$

156 TON LEVELING BINDER  
 (MACHINE METHOD), N50 TO  
 FIX SUPER-ELEVATIONS DEFICIENCIES