

COUNTY	ROUTE	SECTION	TOTAL SHEETS	SHEET NO.
ADAMS	FAS 1603	10-00205-01-RS	12	10
STATION 300+00 TO STATION 315+00				
PROJECT NO. RS-1603(102)				

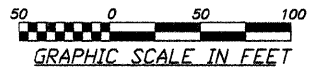

**CURVE DATA**  
 PI STA. 304+00  
 $\Delta=37^{\circ}30'00''$   
 $D=12^{\circ}00'00''$   
 $T=162.34'$   
 $R=478.3'$   
 $L=312.5'$   
 $E=26.81'$   
 PC STA. 302+38.7  
 PT STA. 305+51.2  
 $SE=0.083$  FT./FT.

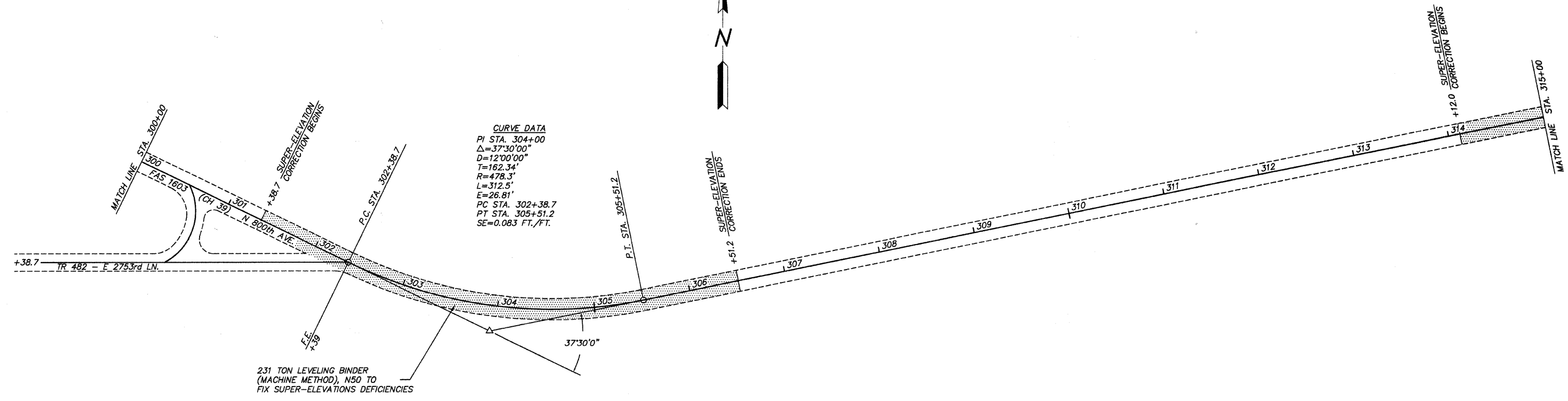

231 TON LEVELING BINDER  
 (MACHINE METHOD), N50 TO  
 FIX SUPER-ELEVATIONS DEFICIENCIES

MATCH LINE STA. 300+00  
 FAS 1603  
 (CH 39)

N 800th AVE

P.C. STA. 302+38.7

P.T. STA. 305+51.2

SUPER-ELEVATION  
 CORRECTION BEGINS  
 +38.7

SUPER-ELEVATION  
 CORRECTION ENDS  
 +51.2

SUPER-ELEVATION  
 CORRECTION BEGINS  
 +12.0  
 MATCH LINE STA. 315+00

+38.7 TR 482 - E 2753rd LN.

F.F. +39

37°30'0"