

FINAL SURVEY	SURVEYED	DATE
NOTE BOOK	PLOTTED	
NO.	TEMPLATE	
	AREAS	
	CHECKED	

ORIGINAL SURVEY	SURVEYED	DATE
NOTE BOOK	PLOTTED	
NO.	TEMPLATE	
	AREAS	
	CHECKED	

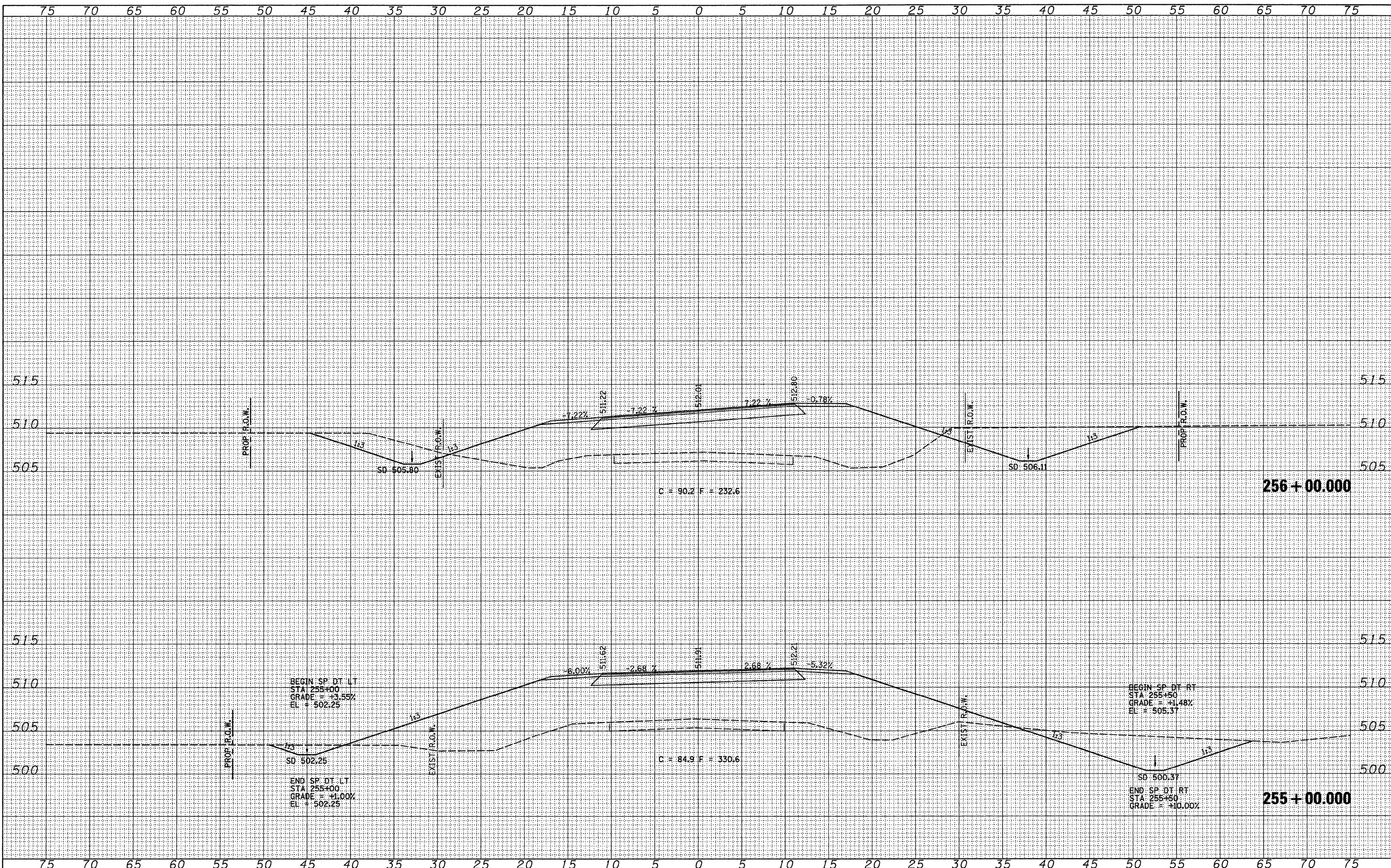

FILE NAME = v:\transportation\2839\2839\sheet.dgn	USER NAME = jolson	DESIGNED -	REVISED -	<b>STATE OF ILLINOIS</b> <b>DEPARTMENT OF TRANSPORTATION</b>	<b>LITERBERRY-PRENTICE ROAD (CH 19)</b> <b>CROSS SECTION SHEETS</b>			F.A.S. RTE. 611	SECTION 05-00093-03-FP	COUNTY MORGAN	TOTAL SHEETS 31	SHEET NO. 22
	PLT SCALE = 5.000' / IN.	DRAWN -	REVISED -		SCALE:	SHEET NO. 7 OF 16 SHEETS	STA. 255+00.000 TO STA. 256+00.000	CONTRACT NO. 93535				
	PLT DATE = 2/26/2010	CHECKED -	REVISED -		ILLINOIS FED. AID PROJECT							
		DATE -	REVISED -									