

FINAL SURVEY	SURVEYED	DATE
NOTE BOOK	PLOTTED	BY
NO.	TEMPLATE	
	AREAS	
	CHECKED	

ORIGINAL SURVEY	SURVEYED	DATE
NOTE BOOK	PLOTTED	BY
NO.	TEMPLATE	
	AREAS	
	CHECKED	

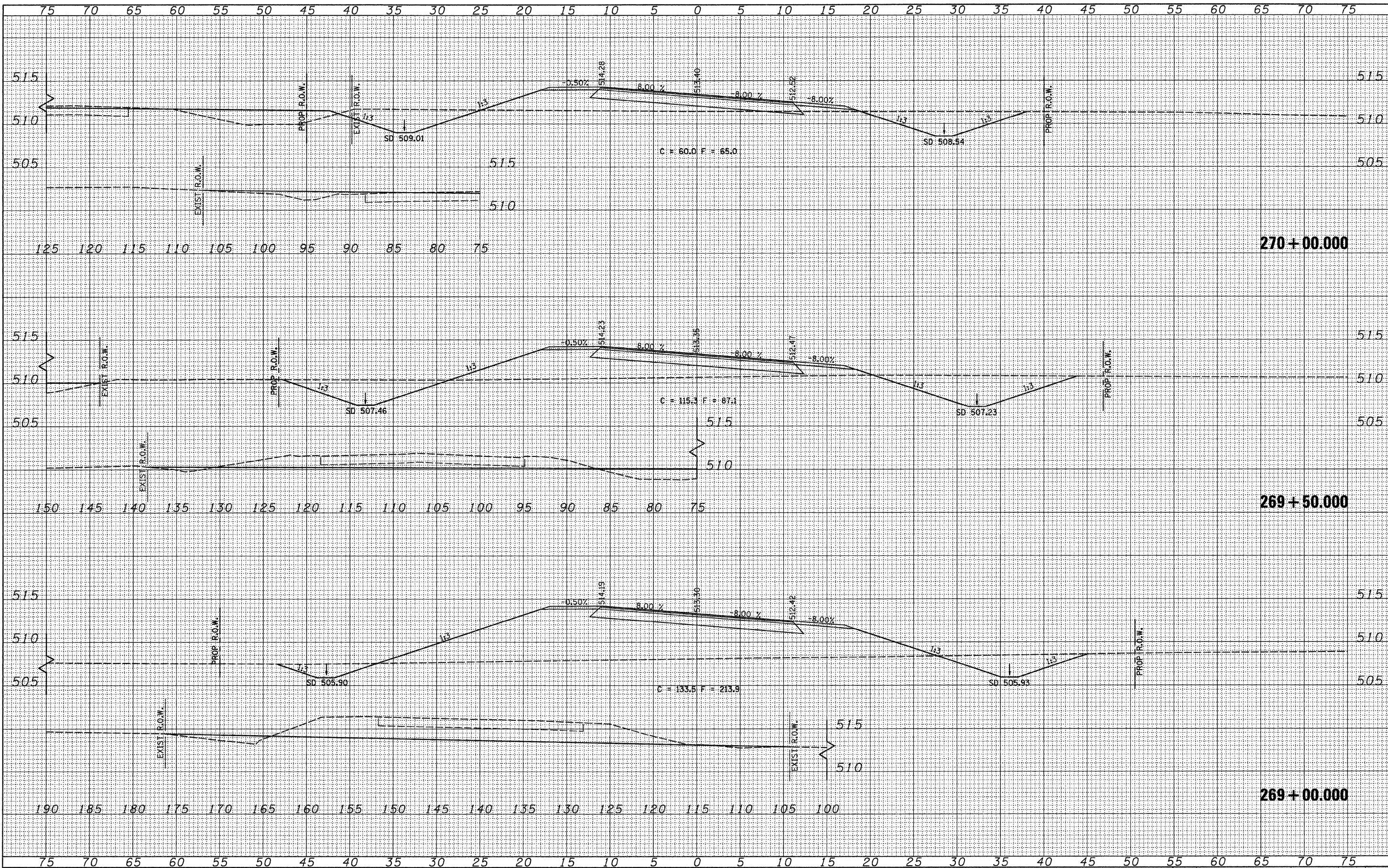

FILE NAME = v:\transportation\2839\2839\sheet.dgn	USER NAME = jelson	DESIGNED -	REVISED -	STATE OF ILLINOIS DEPARTMENT OF TRANSPORTATION	LITERBERRY-PRENTICE ROAD (CH 19) CROSS SECTION SHEETS			F.A.S.1 RTE. 611	SECTION 05-00093-03-FP	COUNTY MORGAN	TOTAL SHEETS 31	SHEET NO. 29
PLOT SCALE = 5.000' / IN.	PLOT DATE = 2/26/2010	DRAWN -	REVISED -		SCALE:	SHEET NO. 14 OF 16 SHEETS	STA. 269+00.000 TO STA. 270+00.000	CONTRACT NO. 93535		ILLINOIS FED. AID PROJECT		
		CHECKED -	REVISED -									
		DATE -	REVISED -									