

DATE	
BY	
PLAN	
NO.	
DATE	
BY	
PROFILE	
NO.	
DATE	
BY	

DATE	
BY	
PROFILE	
NO.	
DATE	
BY	

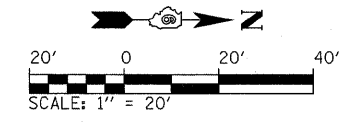

**BENCHMARK**  
 BM "1": CHISELED SQUARE ON NW CORNER  
 OF EXISTING WINGWALL  
 STA. 2+23.74, 15.56' LT.  
 ELEV. = 667.71

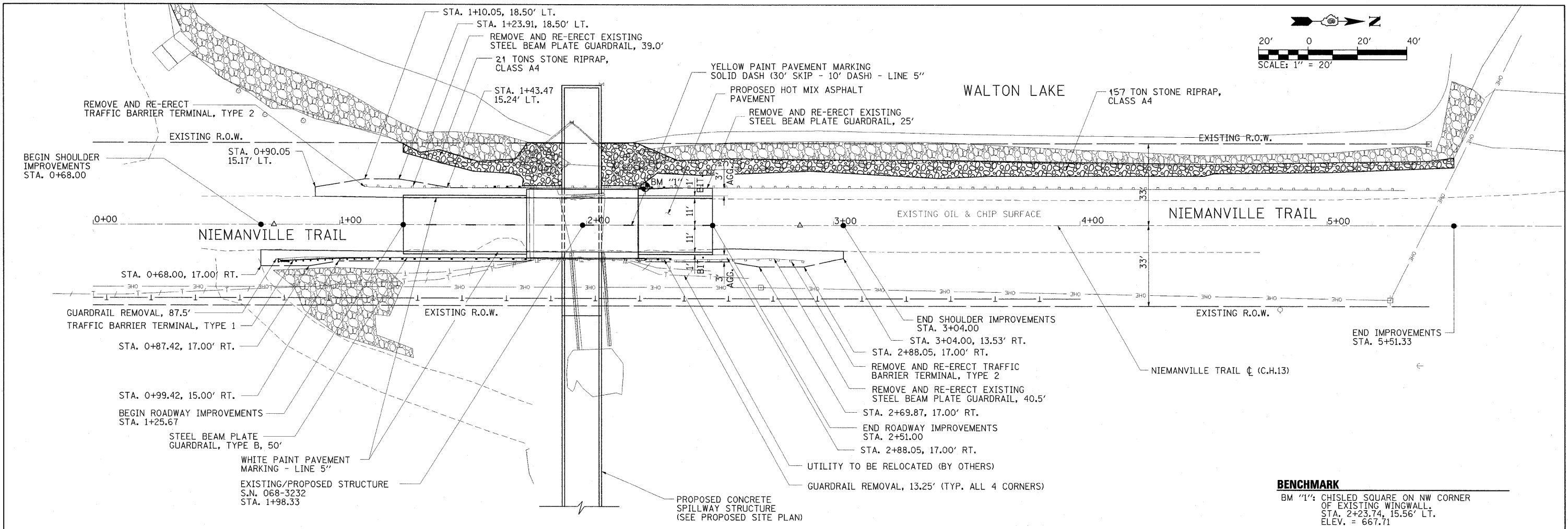
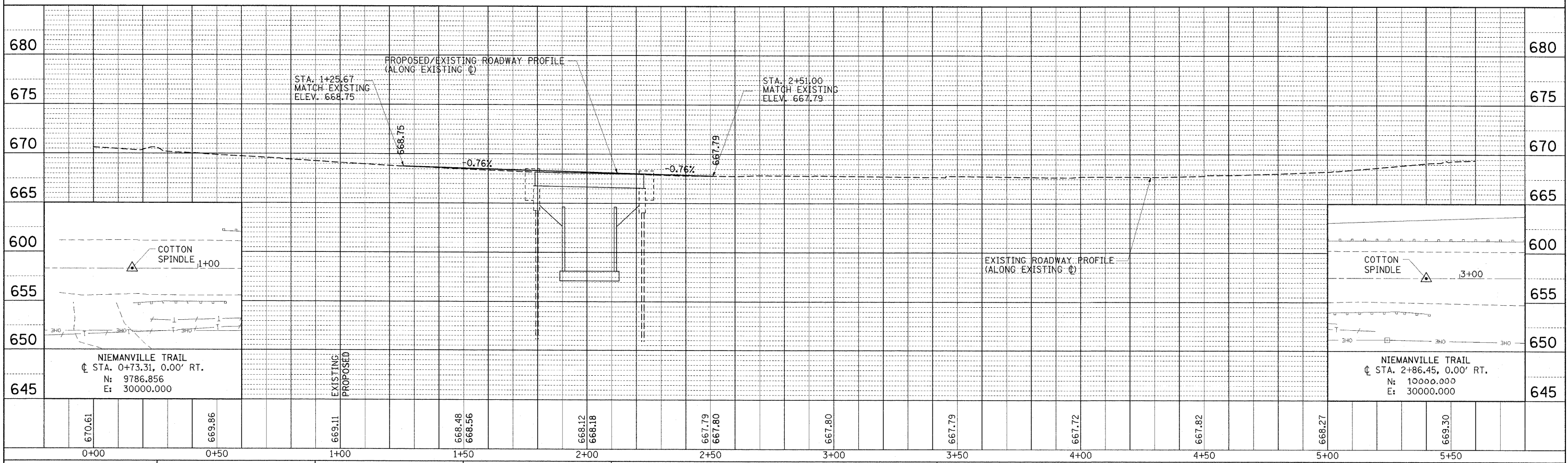

FILE NAME =	USER NAME = Kristi.KLT	DESIGNED -	REVISED -	<b>PLAN AND PROFILE</b> <b>S.N. 068-3232</b> <b>NIEMANVILLE TRAIL OVER SPILLWAY AT WALTON LAKE</b> SCALE: 1" = 20' SHEET NO. 8 OF 32 SHEETS STA. 0+00.00 TO STA. 5+00.00	F.A.U. RTE.	SECTION	COUNTY	TOTAL SHEETS	SHEET NO.
J:\Montgomery\0900110 niemanville	draw\Sheets\P&P.dgn	DRAWN - GLD	REVISED -		8243	09-134-00-DR	MONTGOMERY	32	8
	PLOT SCALE = 20.000000 IN.	CHECKED -	REVISED -		CONTRACT NO. <b>93537</b>				
	PLOT DATE = 3/3/2010	DATE = 1/15/2010	REVISED -		FED. ROAD DIST. NO. 6 [ILLINOIS] FED. AID PROJECT				