

MAINTENANCE OF TRAFFIC GENERAL NOTES

- 1.) ALL SIGNING SHALL BE IN ACCORDANCE WITH THE APPLICABLE PROVISIONS OF THE STATE OF ILLINOIS "STANDARD SPECIFICATIONS FOR ROAD AND BRIDGE CONSTRUCTION" ADOPTED JANUARY 1, 2007, THE DETAILS IN THESE PLANS AND THE LATEST EDITION OF THE STATE OF ILLINOIS "MANUAL ON UNIFORM TRAFFIC CONTROL DEVICES".
- 2.) ALL MAINTENANCE OF TRAFFIC SIGNS SHALL BE PROVIDED, PLACED AND MAINTAINED BY THE CONTRACTOR.
- 3.) THE CONTRACTOR SHALL PROCEED WITH THE WORK IN AN EXPEDIENT MANNER TO MINIMIZE THE TIME THAT THE CLOSURE IS IN EFFECT.
- 4.) THE CONTRACTOR SHALL SUPPLY TO THE ENGINEER THE NAMES AND PHONE NUMBERS OF HIS REPRESENTATIVES ON THE CONSTRUCTION SITE AND HIS REPRESENTATIVES RESPONSIBLE FOR THE DETOUR SIGNING AND MAINTENANCE OF TRAFFIC PRIOR TO THE START OF WORK.
- 5.) LONGITUDINAL DIMENSIONS SHOWN ON THESE PLANS MAY BE ADJUSTED TO FIT FIELD CONDITIONS AS DIRECTED BY THE ENGINEER.
- 6.) ALL EXISTING SIGNING THAT IS NOT APPLICABLE WHILE THE ROAD CLOSURE IS IN EFFECT SHALL BE REMOVED OR COMPLETELY COVERED BY THE CONTRACTOR. THIS WORK SHALL BE CONSIDERED INCLUDED IN THE COST OF TRAFFIC CONTROL COMPLETE.
- 7.) ALL ROAD CLOSURE SIGNS SHALL BE POST MOUNTED UNLESS OTHERWISE NOTED.
- 8.) ALL ROAD CLOSURE SIGNING, EXCEPT REGULATORY SIGNS, SHALL HAVE BLACK LEGNEDS ON FLUORESCENT ORANGE BACKGROUNDS AND STANDARD BLACK BORDERS. ALL ROAD CLOSURE SIGNS SHALL BE NEW OR LIKE NEW CONDITION.
- 9.) AS A MINIMUM, ALL AMBER FLASHING LIGHTS THAT ARE REQUIRED FOR THE CLOSURE SIGNAGE SHALL MEET THE REQUIREMENTS FOR TYPE A-LOW INTENSITY FLASHING LIGHTS PER ARTICLE 1106.02(a) OF THE STANDARD SPECIFICATIONS. ALL LIGHTS SHALL OPERATE DURING HOURS OF DARKNESS. ONLY LIGHTS THAT HAVE BEEN APPROVED BY THE ILLINOIS DEPARTMENT OF TRANSPORTATION AND MONTGOMERY COUNTY SHALL BE USED.
- 10.) THE "ROAD CLOSED" SIGN ON A TYPE III BARRICADE SHALL BE MOUNTED ACCORDING TO STANDARD 701901. ALL TYPE III BARRICADES SHALL HAVE TWO AMBER TYPE A-LOW INTENSITY FLASHING LIGHTS.
- 11.) CONSTRUCTION EQUIPMENT SHALL NOT BE PARKED IMMEDIATELY BEHIND THE TYPE III BARRICADES DURING NON-WORKING HOURS. IN ANY EVENT, ARTICLES 701 THRU 703 OF THE STANDARD SPECIFICATIONS SHALL APPLY.
- 12.) THE ENGINEER SHALL BE NOTIFIED AT LEAST TWO WEEKS BEFORE THE ROAD IS TO BE OPENED TO TRAFFIC. THE ENGINEER WILL COORDINATE WITH THE CITY, COUNTY AND THE APPROPRIATE LOCAL AGENCIES.
- 13.) THE CONTRACTOR SHALL MAINTAIN ACCESS TO ALL DRIVEWAY AND POINTS OF ACCESS DURING ALL PERIODS OF CONSTRUCTION.
- 14.) FOR STABILIZATION, ALL TYPE III BARRICADES SHALL REQUIRE A MINIMUM OF 8 SANDBAGS PER BARRICADE.

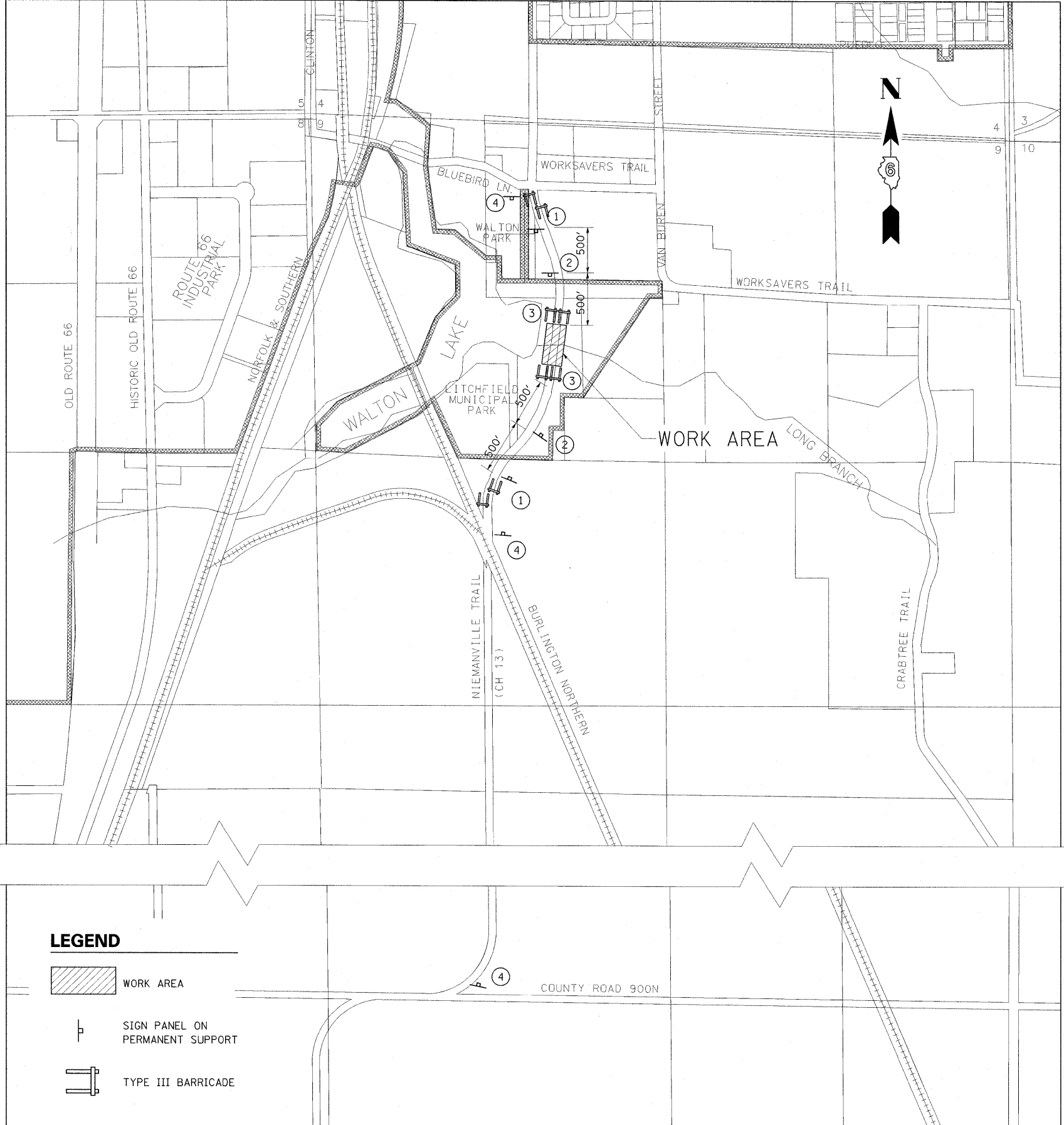
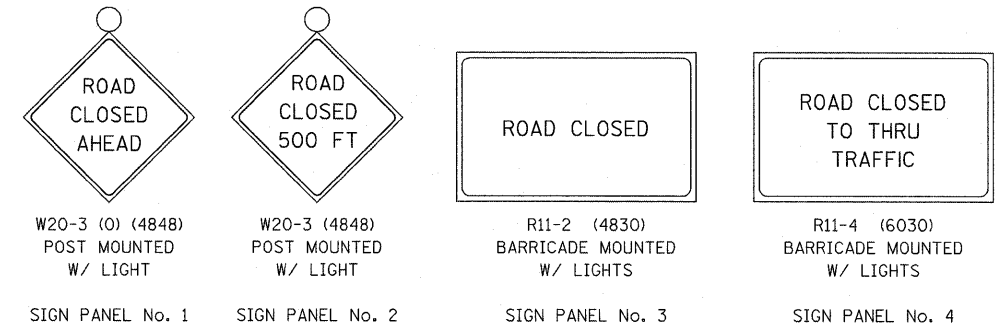

LEGEND

- WORK AREA
- SIGN PANEL ON PERMANENT SUPPORT
- TYPE III BARRICADE

FILE NAME = ...\\Sheets\MOT_detour_plan.dgn	USER NAME = Kristin Timmons	DESIGNED - KLT/JJF	REVISED -
		DRAWN - GLD	REVISED -
		CHECKED - KLT/JJF	REVISED -
		DATE - 3/2/2010	REVISED -

**NIEMANVILLE TRAIL
MONTGOMERY COUNTY, ILLINOIS**

**MAINTENANCE OF TRAFFIC
ROAD CLOSURE PLAN**

SCALE: N/A SHEET NO. 9 OF 32 SHEETS STA. N/A TO STA. N/A

F.A.U. RTE. 8243	SECTION 09-00134-00-DR	COUNTY MONTGOMERY	TOTAL SHEETS 32	SHEET NO. 9
FED. ROAD DIST. NO. 6 ILLINOIS FED. AID PROJECT			CONTRACT NO. 93537	