

STATE OF ILLINOIS  
DEPARTMENT OF TRANSPORTATION  
PLANS FOR PROPOSED  
FEDERAL AID SECONDARY PROJECT  
FAS ROUTE 2797 - CH 6 (STR FUNDS)  
SECTION 07-00081-00-RS  
PROJECT NO. RS-2797(106)  
C-97-071-10  
CLAY COUNTY

ROUTE	SECTION	COUNTY	SHEET NO.	TOTAL SHEETS
FAS 2797	07-00081-00-RS	CLAY	1	8
FEDERAL ROAD DISTRICT 7	ILLINOIS	FEDERAL AID PROJ.		
CONTRACT NO. 95625				

INDEX OF SHEETS

SHEET NO.	TITLE
1	COVER SHEET
2	SUMMARY OF QUANTITIES
3	TYPICAL SECTIONS
4	PCC PAVEMENT DETAILS
5	INTERSECTION DETAILS
6	ENTRANCE DETAILS
7	TRAFFIC CONTROL PLAN
8	TRAFFIC CONTROL PLAN

STANDARDS

442201-03	CLASS C AND D PATCHES
701006-03	TRAFFIC CONTROL
701011-02	TRAFFIC CONTROL
701301-03	TRAFFIC CONTROL
701311-03	TRAFFIC CONTROL
701901-01	TRAFFIC CONTROL DEVICES
780001-02	PAVEMENT MARKINGS
BLR21-8	TRAFFIC CONTROL
BLR22-6	TRAFFIC CONTROL

DESIGN CLASS: RURAL MAJOR COLLECTOR  
ADT : 700  
DESIGN SPEED = 40 MPH  
J.U.L.I.E. 1-800-892-0123



*Eric T. Seibring*  
ERIC T. SEIBRING  
ILLINOIS LICENSED PROFESSIONAL ENGINEER  
NO. 062-055824

LICENSE EXPIRES 11-30-11

CLAY COUNTY HIGHWAY DEPARTMENT  
14464 HIGHWAY 45 SOUTH  
LOUISVILLE, IL 62858

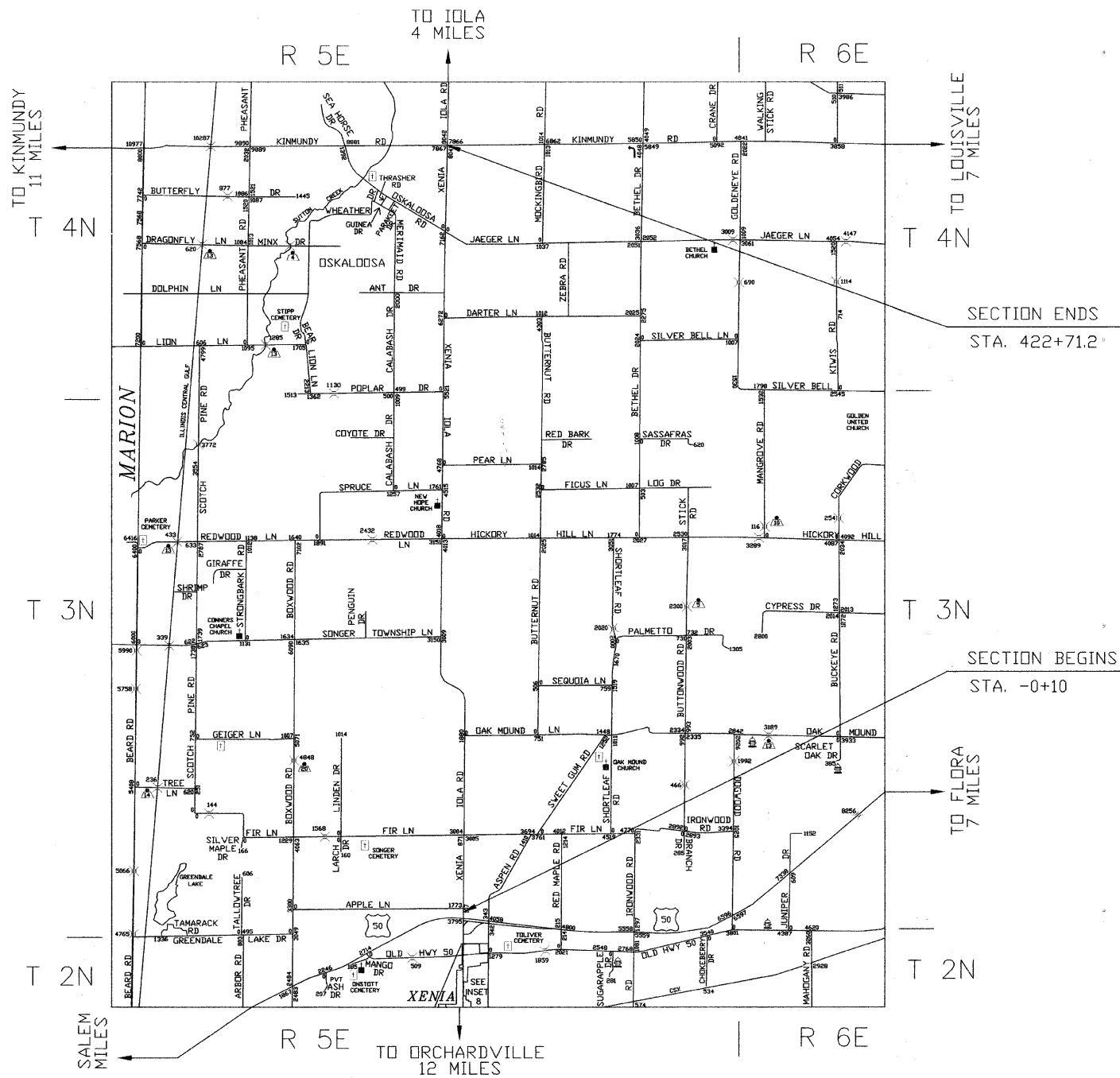

SECTION 07-00081-00-RS  
TOTAL LENGTH = 42,281.2 FT OR 8.0 MI

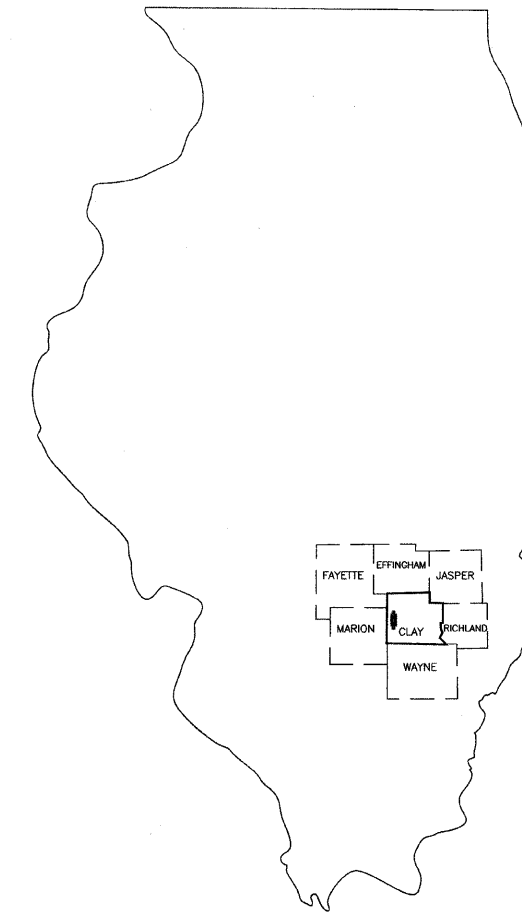

LOCATION OF PROJECT INDICATED THUS:

APPROVED	<u>APRIL 5</u> , 2010 <i>[Signature]</i> CLAY COUNTY ENGINEER
PASSED	<u>April 8</u> , 2010 <i>[Signature]</i> DISTRICT SEVEN ENGINEER OF LOCAL ROADS & STREETS
RELEASING FOR BID BASED ON LIMITED REVIEW	<u>4/8</u> , 2010 <i>[Signature]</i> DEPUTY DIRECTOR OF HIGHWAYS, REGION FOUR ENGINEER
STATE OF ILLINOIS DEPARTMENT OF TRANSPORTATION	

ROUTE	SECTION	COUNTY	SHEET NO.	TOTAL SHEETS
FAS 2797	07-00081-00-RS	CLAY	2	8
FEDERAL ROAD DISTRICT 7		ILLINOIS	FEDERAL AID PROJ.	
CONTRACT NO. 95625				

### GENERAL NOTES

- 1) THIS SECTION SHALL BE CONSTRUCTED IN ACCORDANCE WITH THE PLANS, SPECIAL PROVISIONS AND THE "STANDARD SPECIFICATIONS FOR ROAD AND BRIDGE CONSTRUCTION" ADOPTED JANUARY 1, 2007.
- 2) AT LEAST 48 HOURS BEFORE ANY EXCAVATING, CALL J.U.L.I.E. 1-800-892-0123 FOR UTILITY LOCATION INFORMATION.
- 3) TRANSVERSE CONSTRUCTION JOINTS SHALL REQUIRE #5 SMOOTH BARS 18" LONG AT 12" CENTERS. IT IS ANTICIPATED THAT TRANSVERSE CONSTRUCTION JOINTS WILL BE REQUIRED AT THE END OF EACH DAYS POUR AND AT BLOCKOUTS FOR ACCESS TO DRIVEWAYS AND SIDEROADS.
- 4) THE CONTRACTOR SHALL OBTAIN APPROVAL FROM THE ENGINEER AS TO THE LOCATION OF CONSTRUCTION JOINTS.
- 5) #5 DEFORMED REBAR 30" LONG AT 30" CENTERS SHALL BE INSTALLED AT ALL LONGITUDINAL CONSTRUCTION JOINTS, EXCEPT THE CENTERLINE JOINT WHERE NO TIE BARS WILL BE REQUIRED.

### UTILITIES

(FOR INFORMATION ONLY)

FRONTIER COMMUNICATIONS  
801 WEST JACKSON ST.  
ALTA MONT, IL. 62411  
618-483-6391

WABASH TELEPHONE COOP.  
210 S. CHURCH ST.  
LOUISVILLE, IL 62858  
618-665-3311

PIPELINK MAINTENANCE (BP OIL)  
PO BOX 99  
BROOKLYN, IN. 46111  
765-342-7444

NORTHEAST MARION COUNTY WATER  
5329 KINMUNDY RD  
SALEM, IL. 62881  
618-547-9887

MARATHON ASHLAND PIPELINE  
8762 U.S. HWY. 51  
VERNON, IL. 62892  
618-432-7223

CLAY ELECTRIC COOP  
7784 OLD HWY 50  
FLORA, IL. 62839  
618-662-2171

CLASS C PATCHES, 8 INCH (PCC)					
STATION TO STATION	LT / RT	WIDTH	TYPE II	TYPE III	TYPE IV
			SQ. YDS.	SQ. YDS.	SQ. YDS.
166+88 TO 168+14	RT	5.5			77.0
186+00 TO 186+31	RT	5.5		18.9	
187+37 TO 188+79	RT	11.0			173.6
189+56 TO 190+49	RT	11.0			113.7
193+00 TO 193+54	RT	11.0			66.0
198+34 TO 198+94	RT	5.5			36.7
207+43 TO 207+98	RT	11.0			67.2
389+79 TO 390+61	RT	11.0			100.2
397+55 TO 398+26	RT	11.0			86.8
399+15 TO 399+32	LT	5.5	10.4		
404+87 TO 406+26	RT	11.0			169.9
408+02 TO 408+21	LT	5.5	11.6		
414+82 TO 415+22	RT	5.5		24.4	
418+53 TO 419+33	RT	5.5			48.9
TOTALS			22.0	43.3	940.0

### NOTES

- 1) THE ACTUAL SIZE AND LOCATION OF PATCHES WILL BE DETERMINED IN THE FIELD BY THE ENGINEER AFTER COMPLETION OF THE MILLING PROCESS.
- 2) ALL PATCHES SHALL BE LAYED OUT AS EITHER 1/2 LANE WIDTH (5.5') OR FULL LANE WIDTH (11.0') SO THAT LONGITUDINAL CONSTRUCTION JOINTS CLOSELY MATCH WITH LONGITUDINAL CONTRACTION / CONSTRUCTION JOINTS OF THE PCC PAVEMENT ABOVE.

### SUMMARY OF QUANTITIES

CODE NO.	PAY ITEM	UNIT	QUANTITY
X4020900	AGGREGATE SURFACE COURSE, TYPE B (SPECIAL)	SQ YD	1,613.3
44201329	CLASS C PATCHES, TYPE II, 8 INCH	SQ YD	22.0
44201333	CLASS C PATCHES, TYPE III, 8 INCH	SQ YD	43.3
44201335	CLASS C PATCHES, TYPE IV, 8 INCH	SQ YD	940.0
67100100	MOBILIZATION	L SUM	1
* 70103700	TRAFFIC CONTROL COMPLETE	L SUM	1
Δ * 78001110	PAINT PAVEMENT MARKING - LINE 4"	FOOT	19,120
* 78300100	PAVEMENT MARKING REMOVAL	SQ FT	12.4
* X4400157	HMA SURFACE REMOVAL 2", (SPECIAL)	SQ YD	103,674
* XX005348	AGGREGATE SHOULDERS (SPECIAL)	FOOT	83,778
Z0055300	RUMBLE STRIP	EACH	6
* XX007371	PORTLAND CEMENT CONCRETE PAVEMENT, FURNISHED	CU YD	14,539
* XX007372	PORTLAND CEMENT CONCRETE PAVEMENT, 5" PLACEMENT	SQ YD	103,232
* XX007374	PORTLAND CEMENT CONCRETE PAVEMENT, 7" PLACEMENT	SQ YD	872.3

\* SEE SPECIAL PROVISIONS

Δ SPECIALTY ITEMS

### PAINT PAVEMENT MARKING LINE - 4"

CENTERLINE (DASHED)		NORTHBOUND NO PASSING		SOUTHBOUND NO PASSING	
STA. TO STA.	QUANTITY	STA. TO STA.	QUANTITY	STA. TO STA.	QUANTITY
-0+10 TO 117+29	2,940 FT	69+17 TO 75+17	600 FT	80+24 TO 86+24	600 FT
135+11 TO 422+71	7,190 FT	106+17 TO 135+11	2,894 FT	117+29 TO 146+11	2,882 FT
		324+82 TO 334+22	940 FT	336+11 TO 346+85	1,074 FT
TOTAL 10,130 FT		TOTAL 4,434 FT		TOTAL 4,556 FT	

ROUTE	SECTION	COUNTY	SHEET NO.	TOTAL SHEETS
FAS 2797	07-00081-00-RS	CLAY	3	8
FEDERAL ROAD DISTRICT 7	ILLINOIS	FEDERAL AID PROJ.		
CONTRACT NO. 95625				

## TYPICAL EXISTING CROSS SECTIONS

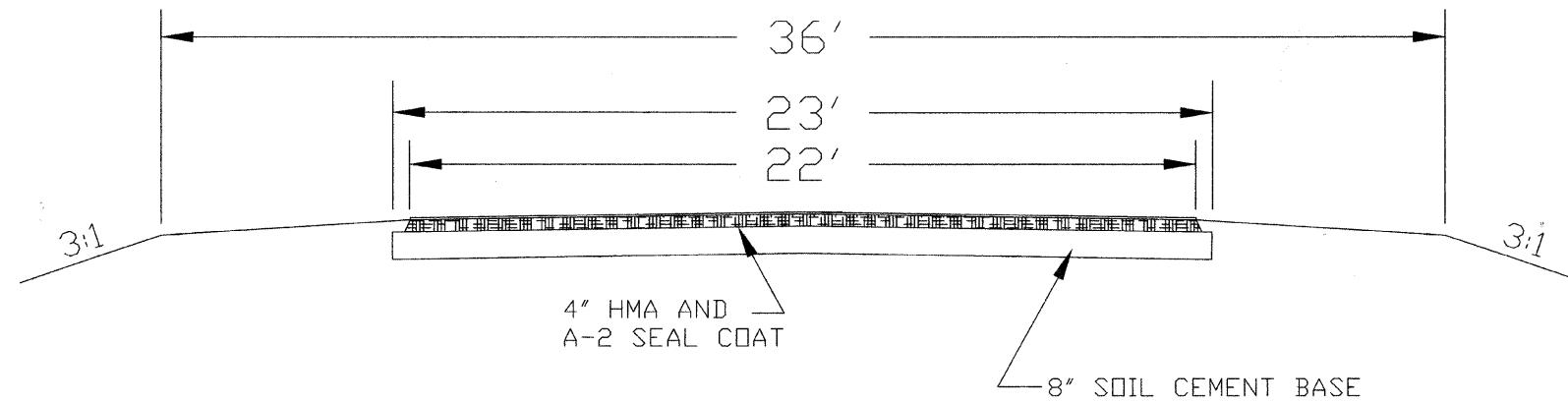

## TYPICAL PROPOSED CROSS SECTIONS

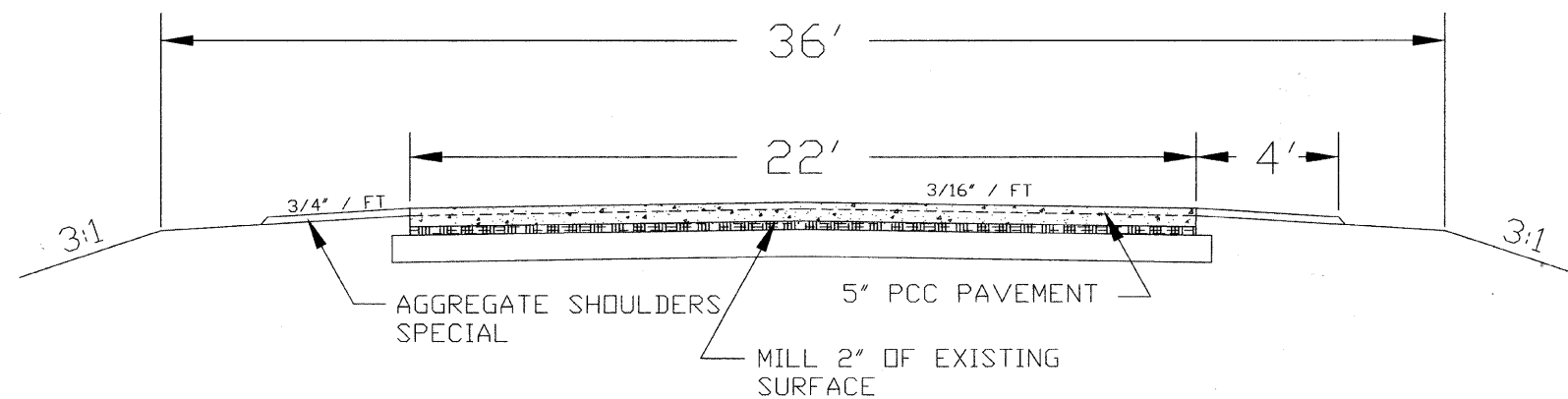

## DETAIL OF TRANSITION FROM EXISTING 8" PCC PAVEMENT TO PROPOSED 5" PCC PAVEMENT

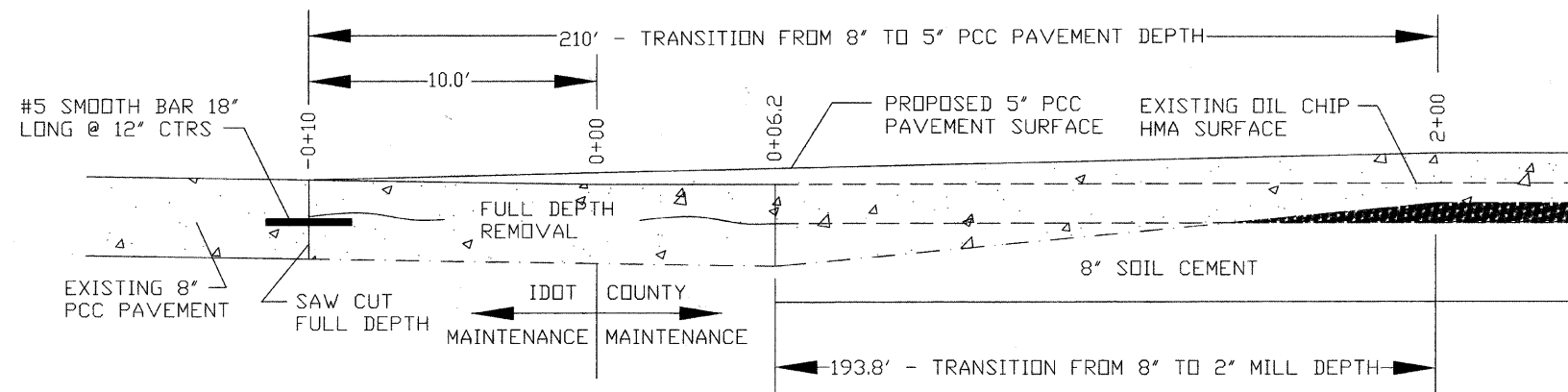

### NOTES

- 1) STATION 0+00 IS LOCATED AT A FAILED AREA OF THE EXISTING PCC PAVEMENT THAT HAS BEEN FILLED WITH BITUMINOUS COLD PATCH, THEREFORE THE BEGINNING OF IMPROVEMENTS HAVE BEEN EXTENDED ONTO THE IDOT MAINTENANCE SECTION A DISTANCE OF 10' WHICH WILL REPLACE THE FAILED AREA OF PAVEMENT AND PROVIDE A SMOOTH TRANSITION FROM THE EXISTING TO THE IMPROVED PAVEMENTS.
- 2) FULL DEPTH PCC PAVEMENT REMOVAL FROM STA -0+10 TO 0+06.2 SHALL BE MEASURED BY THE SQ. YD. AND SHALL BE INCLUDED IN AND PAID FOR AT THE CONTRACT UNIT PRICE FOR SURFACE REMOVAL 2", SPECIAL
- 3) THE TRANSITION PAVEMENT FROM 8" THICK TO 5" THICK AT STA. -0+10 TO STA 2+00 SHALL BE INCLUDED IN AND PAID FOR AT THE CONTRACT UNIT PRICE FOR PCC PAVEMENT, FURNISHED (CU. YD.) AND PCC PAVEMENT 5", PLACEMENT (SQ. YD.)

## CONTRACTION / CONSTRUCTION JOINTS

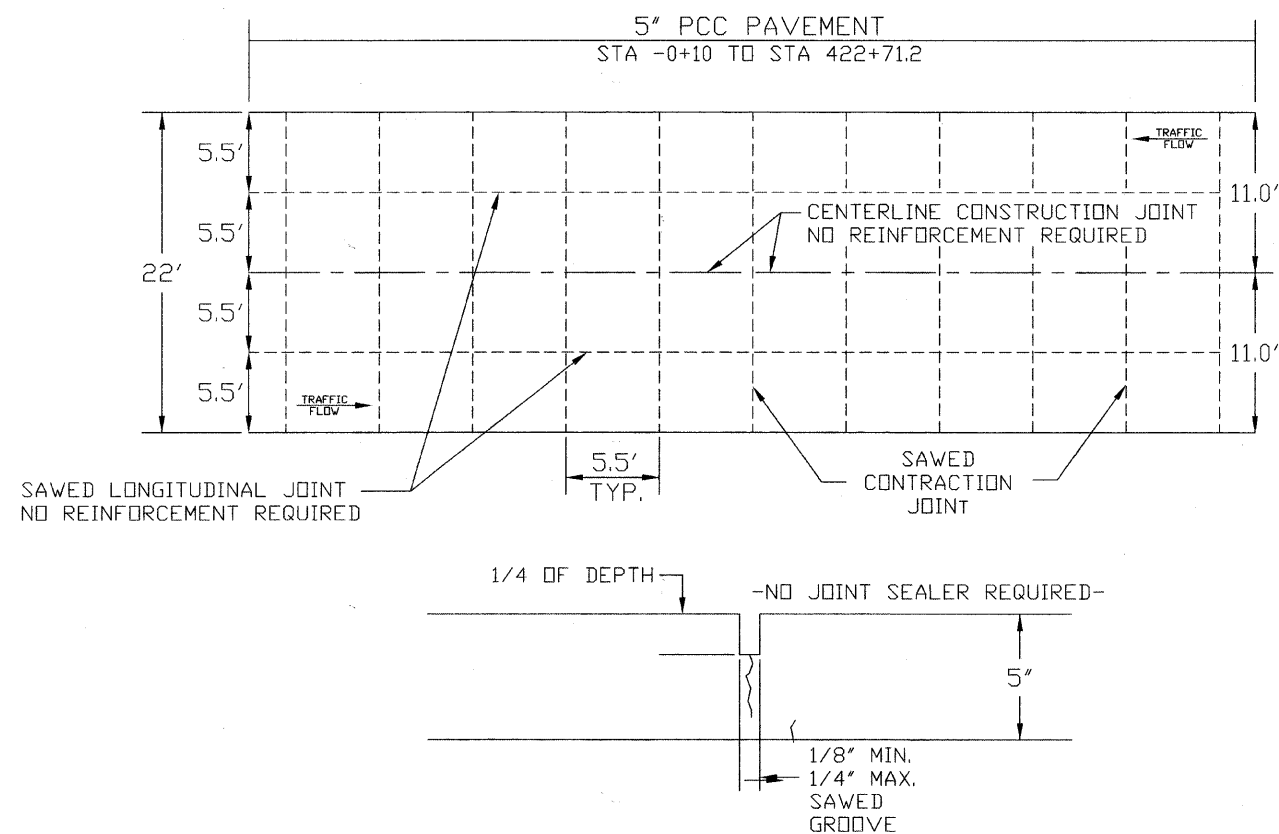

## RUMBLE STRIP DETAILS

ROUTE	SECTION	COUNTY	SHEET NO.	TOTAL SHEETS
FAS 2797	07-00081-00-RS	CLAY	4	8
FEDERAL ROAD DISTRICT 7		ILLINOIS	FEDERAL AID PROJ.	
CONTRACT NO. 95625				

### LOCATIONS

- 3 EACH @ KINMUNDY RD (F.A.S. 2703)
- 3 EACH @ U.S. RT 50 (F.A. RT. 13)

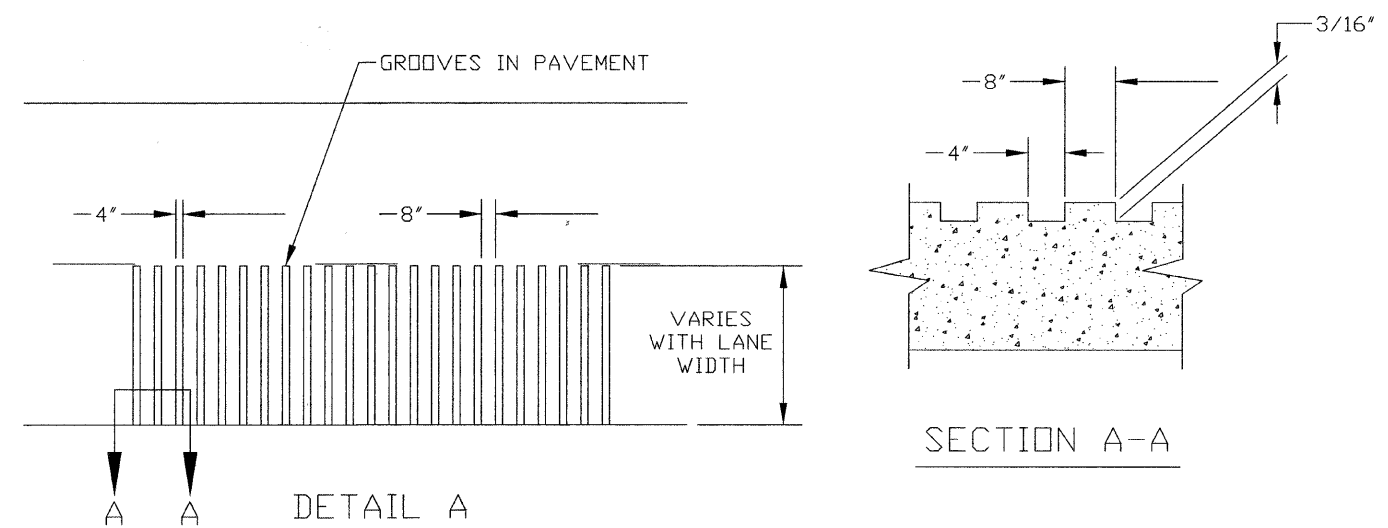
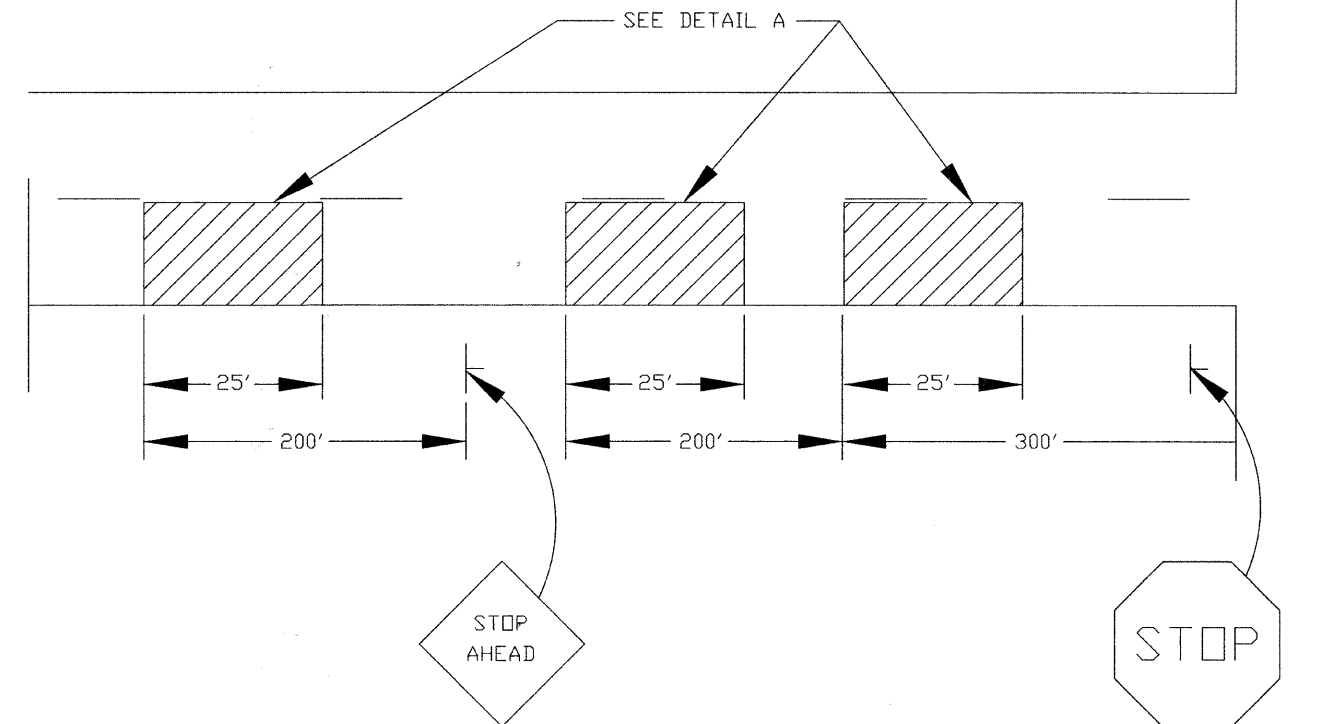

### NOTES

- 1) ALL GROOVES SHALL BE CONSTRUCTED USING A 4" MILLING HEAD OR SERIES OF 4" MILLING HEADS CAPABLE OF CUTTING TO THE SPECIFIED DEPTH OR ANY VARIABLE DEPTH.
- 2) THIS WORK WILL BE MEASURED FOR PAYMENT PER EACH 25' INDIVIDUAL RUMBLE STRIP AND PAID FOR AT THE CONTRACT UNIT PRICE EACH FOR RUMBLE STRIP, WHICH PRICE SHALL INCLUDE ALL EQUIPMENT, MATERIAL, LABOR AND OTHER ITEMS REQUIRED TO INSTALL EACH INDIVIDUAL RUMBLE STRIP.

7" PCC PAVEMENT - INTERSECTION APPROACHES			QUANTITY	
STATION	"W"	DESCRIPTION	SQ. YD.	CU. YD.
2+39.10 LT	78'	APPLE LN - TR 351	34.7	6.7
42+82.82 LT	78'	FIR LN - TR 333	34.7	6.7
42+82.82 RT	78'	FIR LN - TR 333	34.7	6.7
96+26.69 RT	78'	OAK MOUND LN - TR 331	34.7	6.7
156+14.32 LT	*	SONGER TOWNSHIP LN - CH 18	198.3	38.6
209+35.71 LT	78'	REDWOOD LN - TR 293	34.7	6.7
209+52.27 RT	110'	HICKORY HILL LN - CH 20	48.9	9.5
236+05.15 LT	78'	SPRUCE LN - TR 285	34.7	6.7
249+39.03 RT	78'	PEAR LN - TR 287	34.7	6.7
289+29.68 LT	78'	POPLAR DR. - TR 261	34.7	6.7
329+29.93 RT	78'	DARTER LN - TR 233	34.7	6.7
376+48.99 RT	78'	JAEGER LN - TR 221	34.7	6.7
376+48.99 LT	78'	OSKALOOSA RD - TR 46C	34.7	6.7
422+71.2	*	KINMUNDY RD - F.A.S. 2703	243.4	47.3
* - SEE DETAIL FOR DIMENSION			TOTAL	
			872.3	169.1

DETAIL OF INTERSECTION  
OF CH 6 & CH 18

ROUTE	SECTION	COUNTY	SHEET NO.	TOTAL SHEETS
FAS 2797	07-00081-00-RS	CLAY	5	8
FEDERAL ROAD DISTRICT 7	ILLINOIS	FEDERAL AID PROJ.		
CONTRACT NO. 95625				

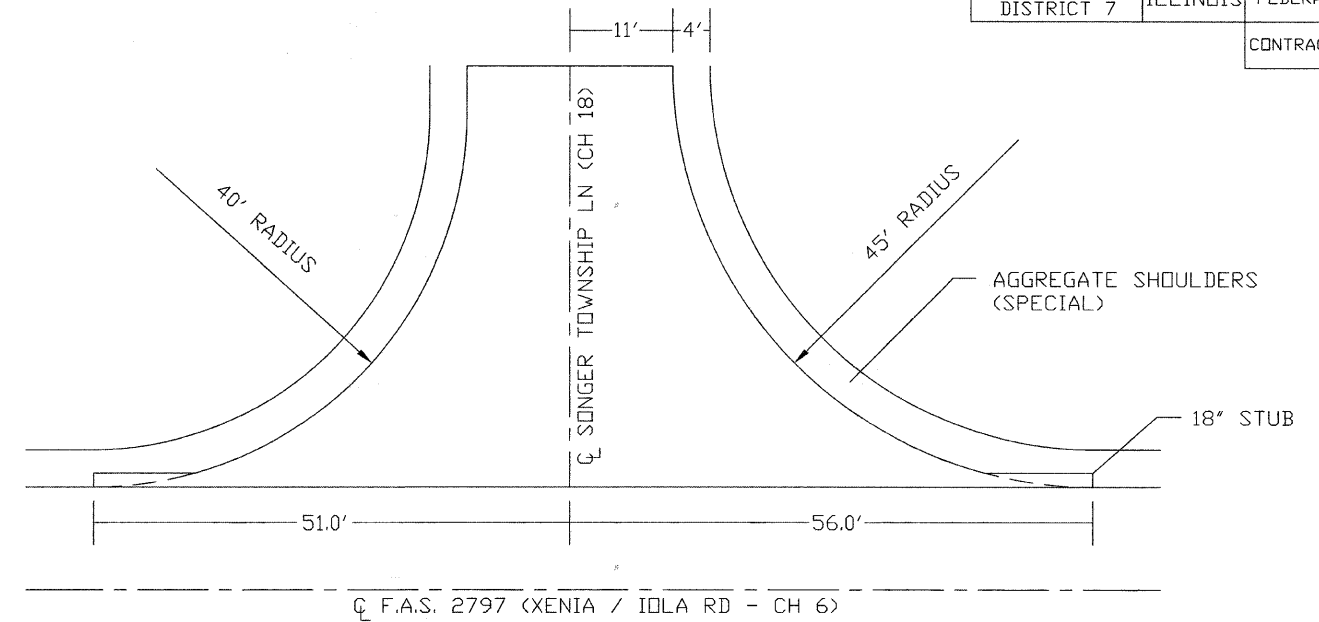

APPROACH DETAILS FOR ALL TOWNSHIP  
ROAD AND COUNTY HIGHWAY 20  
INTERSECTIONS

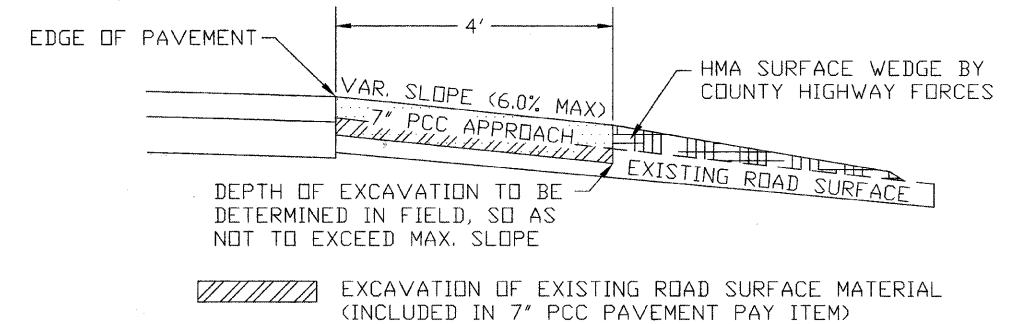
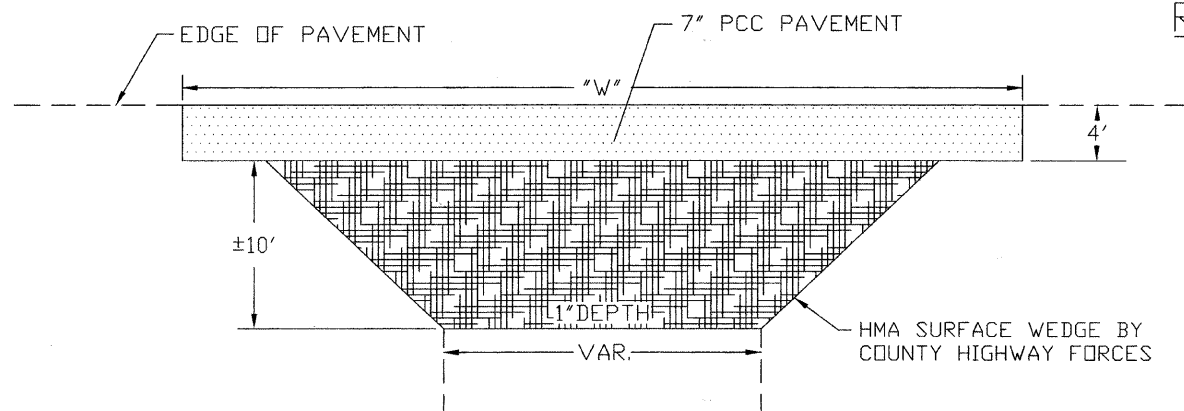

APPROACH DETAILS INTERSECTION  
OF CH 6 & F.A.S. ROUTE 2703

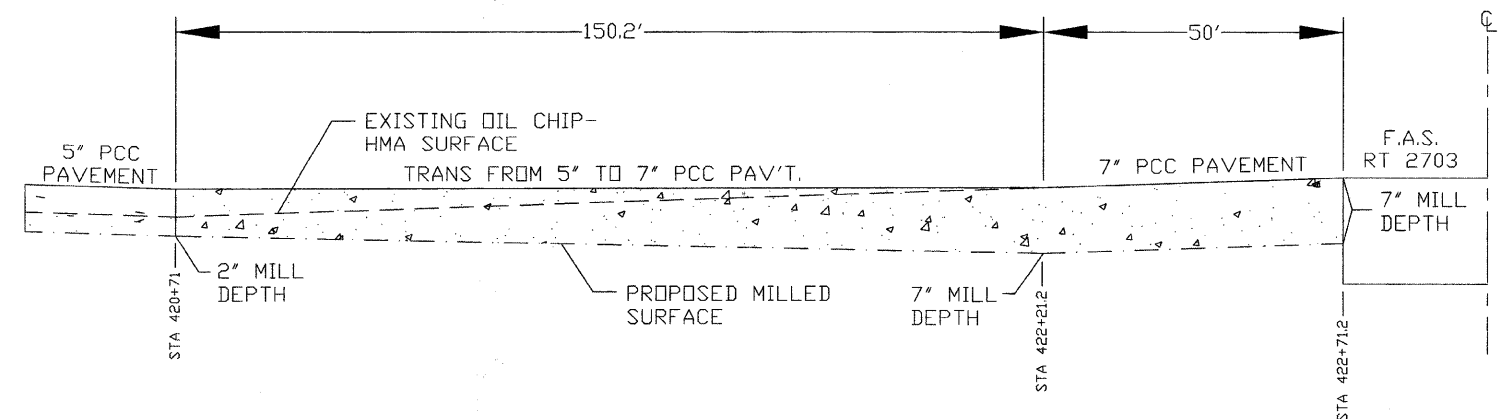
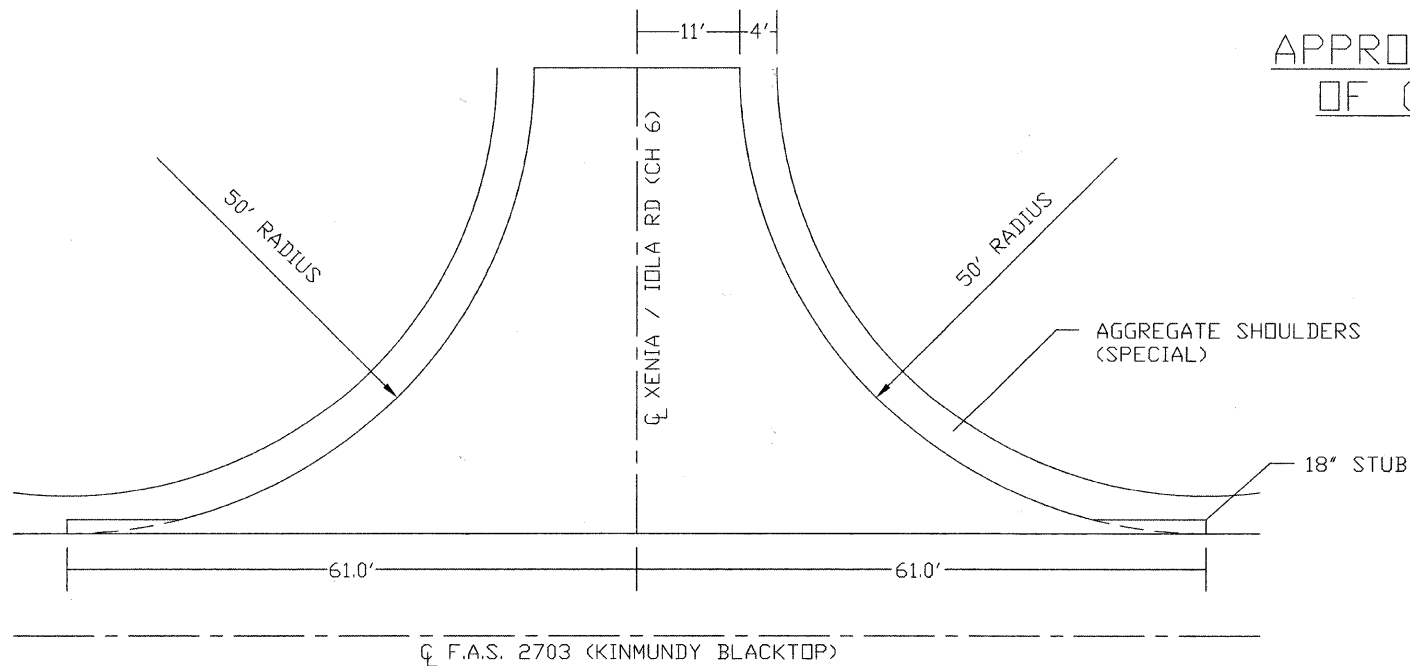

ROUTE	SECTION	COUNTY	SHEET NO.	TOTAL SHEETS
FAS 2797	07-00081-00-RS	CLAY	6	8
FEDERAL ROAD DISTRICT 7		ILLINOIS	FEDERAL AID PROJ.	
CONTRACT NO. 95625				

### AGGREGATE ENTRANCE DETAIL

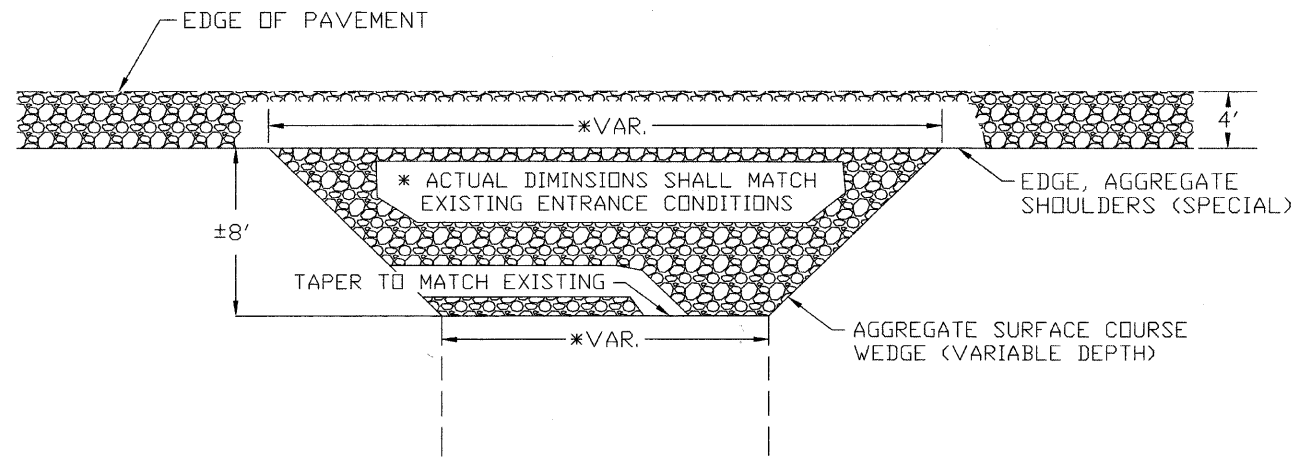

PE - PRIVATE ENTRANCE; CE - COMMERCIAL ENTRANCE; FE - FIELD ENTRANCE  
 PR - PRIVATE ROAD; LR - LEASE ROAD; LMTR - LOW MAINTENANCE TOWNSHIP ROAD

### ENTRANCE SCHEDULE

STATION	TYPE	SQ. YD.	STATION	TYPE	SQ. YD.	STATION	TYPE	SQ. YD.	
11+15 RT	PE	22.2	122+63 RT	CE	31.1	254+85 LT	FE	16.0	
13+49 LT	FE	16.0	133+33 RT	FE	16.0	255+92 RT	FE	16.0	
13+72 RT	FE	16.0	134+62 LT	PR	19.6	262+85 RT	PE	17.8	
16+35 RT	PE	17.8	140+80 LT	PE	22.2	262+92 LT	FE	16.0	
17+91 RT	PE	17.8	141+54 RT	PE	16.0	276+31 RT	FE	16.0	
23+50 LT	FE	16.0	155+70 RT	PR	21.3	280+60 LT	LR	18.7	
42+18 LT	FE	16.0	156+16 RT	PE	17.8	287+94 RT	PE	15.1	
42+18 RT	FE	16.0	156+86 LT	CE	21.3	293+65 RT	FE	16.0	
52+70 RT	PE	31.1	167+70 LT	FE	16.0	298+27 RT	FE	16.0	
56+32 LT	FE	16.0	173+95 LT	FE	16.0	298+38 LT	PE	22.2	
56+42 RT	FE	16.0	177+76 RT	FE	16.0	301+37 LT	PE	18.7	
69+71 LT	FE	16.0	178+87 RT	PR	19.6	302+34 LT	PE	14.2	
77+36 RT	FE	16.0	182+76 LT	FE	16.0	302+67 LT	PE	21.3	
77+39 LT	PE	18.7	184+51 LT	FE	16.0	302+91 RT	FE	16.0	
91+27 LT	FE	16.0	195+92 RT	FE	16.0	315+74 LT	FE	16.0	
91+90 RT	FE	16.0	196+30 LT	FE	16.0	315+74 RT	FE	16.0	
92+03 LT	FE	16.0	200+73 RT	FE	16.0	321+20 LT	PE	28.4	
94+52 LT	FE	16.0	201+08 LT	FE	16.0	323+72 RT	PE	17.8	
95+53 RT	FE	16.0	203+02 RT	FE	16.0	331+49 RT	PE	23.1	
96+28 LT	PR	26.7	214+15 RT	FE	16.0	333+21 RT	FE	16.0	
102+84 LT	FE	16.0	216+85 LT	PE	14.2	342+78 LT	LMTR	19.6	
105+51 RT	PE	17.8	220+85 LT	PE	22.2	356+00 LT	PR	16.0	
107+60 RT	FE	16.0	221+41 LT	FE	16.0	356+30 RT	FE	16.0	
109+48 RT	FE	16.0	222+47 RT	FE	16.0	373+06 LT	PE	10.7	
109+65 LT	PE	22.2	224+94 LT	CE	28.4	375+38 LT	PE	13.3	
112+48 RT	FE	16.0	234+99 LT	PE	17.8	391+50 LT	FE	16.0	
112+80 LT	FE	16.0	235+82 RT	FE	16.0	393+18 RT	FE	16.0	
113+73 LT	PE	16.0	247+18 LT	FE	16.0	396+22 RT	FE	16.0	
116+56 RT	PR	21.3	247+48 RT	PE	17.8	410+79 LT	FE	16.0	
118+12 RT	CE	31.1	253+85 RT	PE	28.4	416+81 RT	FE	16.0	
								TOTAL	1613.3

SQ. YD. QUANTITIES ARE ESTIMATED.

### AGGREGATE ENTRANCE CROSS-SECTION

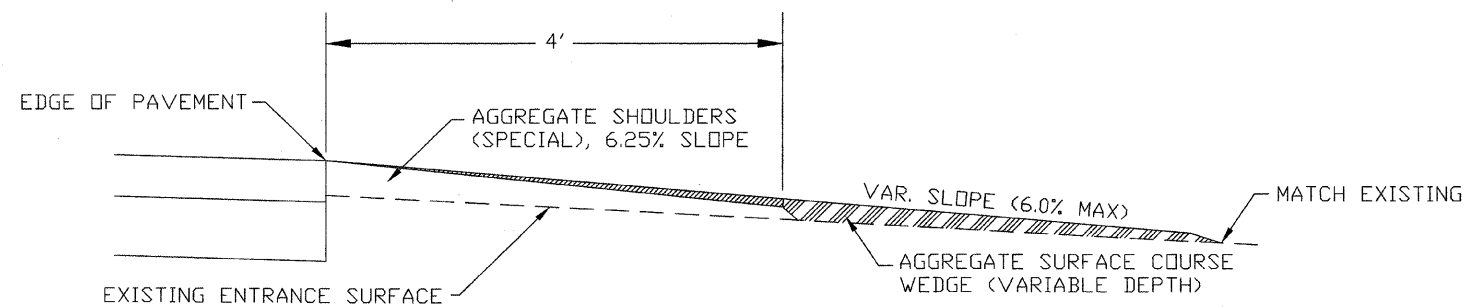

- PAY ITEM AGGREGATE SURFACE COURSE (SPECIAL)
- INCLUDED IN COST OF AGGREGATE SHOULDERS (SPECIAL).

ROUTE	SECTION	COUNTY	SHEET NO.	TOTAL SHEETS
FAS 2797	07-00081-00-RS	CLAY	7	8
FEDERAL ROAD DISTRICT 7	ILLINOIS	FEDERAL AID PROJ.		
CONTRACT NO. 95625				

# TRAFFIC CONTROL PLAN - U.S. RT 50 TO C.H. #20 (HICKORY HILL LN)

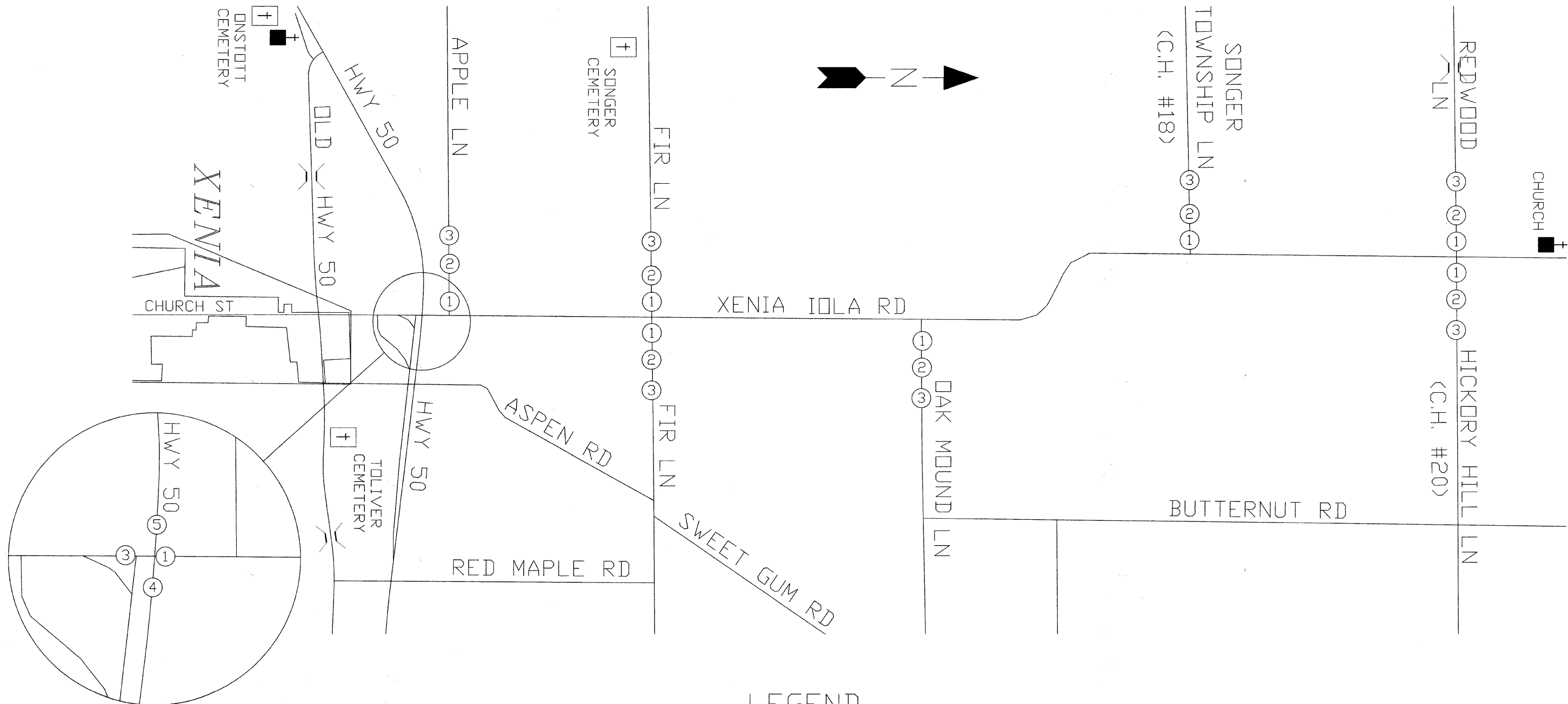

### LEGEND

- ① 2 - TYPE III BARICADES WITH ROAD CLOSED TO THRU TRAFFIC
- ② ROAD CLOSED 500 FEET
- ③ ROAD CLOSED AHEAD
- ④ ROAD CLOSED AHEAD WITH ARROW RIGHT (M5-1R(0)-2115)
- ⑤ ROAD CLOSED AHEAD WITH ARROW LEFT (M5-1L(0)-2115)

ROUTE	SECTION	COUNTY	SHEET NO.	TOTAL SHEETS
FAS 2797	07-00081-00-RS	CLAY	8	8
FEDERAL ROAD DISTRICT 7		ILLINOIS	FEDERAL AID PROJ.	
CONTRACT NO. 95625				

# TRAFFIC CONTROL PLAN - C.H. #20 (HICKORY HILL LN) TO LOUISVILLE / KINMUNDY BLACKTOP

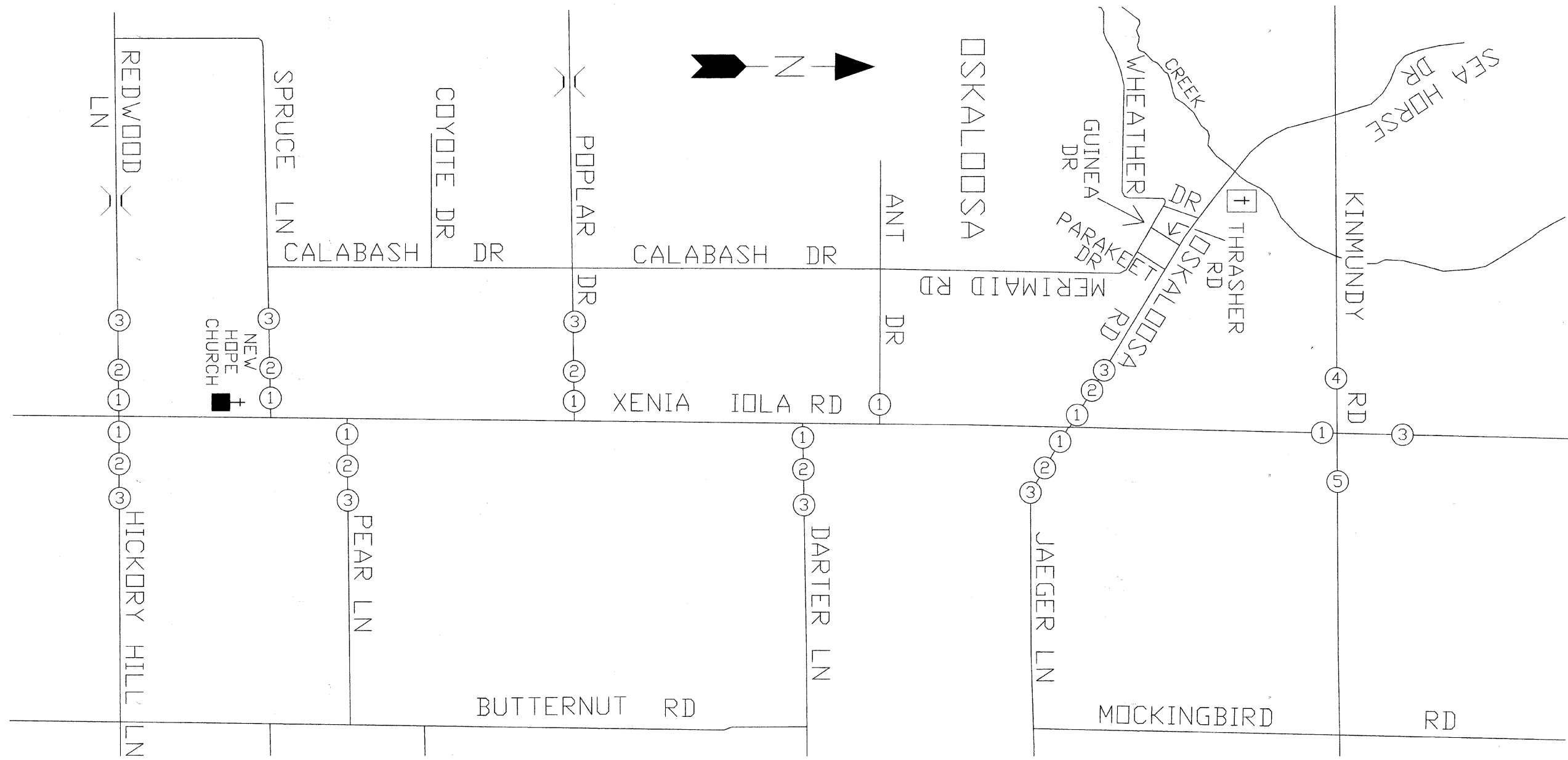

## LEGEND

- ① 2 - TYPE III BARICADES WITH ROAD CLOSED TO THRU TRAFFIC
- ② ROAD CLOSED 500 FEET
- ③ ROAD CLOSED AHEAD
- ④ ROAD CLOSED AHEAD WITH ARROW RIGHT (M5-1R(0)-2115)
- ⑤ ROAD CLOSED AHEAD WITH ARROW LEFT (M5-1L(0)-2115)