

ROUTE	SECTION	COUNTY	TOTAL SHEETS	SHEET NO.
F.A.S. 706	05-00106-01-FP	RICHLAND	9	4
CONTRACT NO. 95627		ILLINOIS		

SCALE 1" = 20'

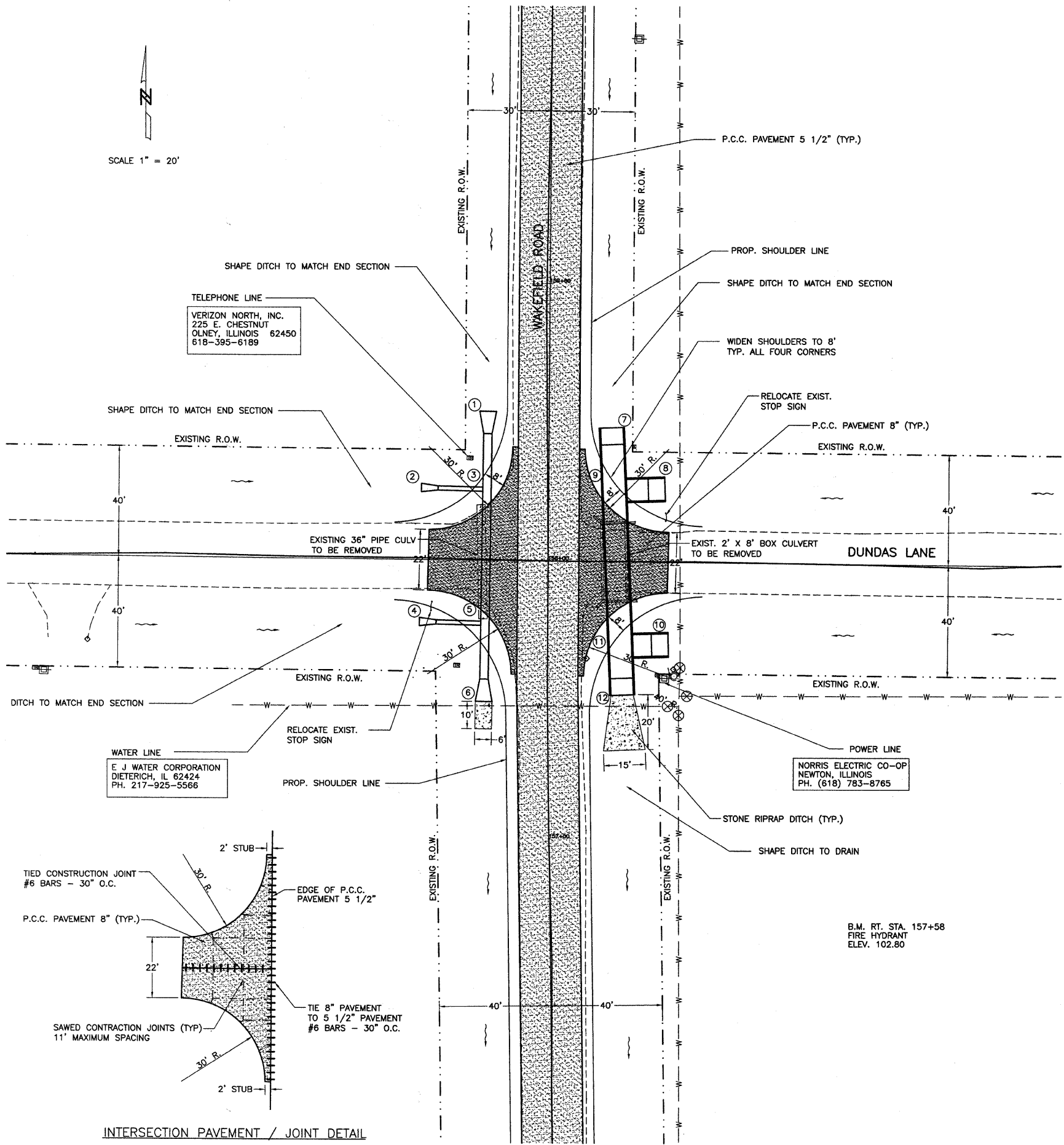

NO.	DIST.	STA.	ITEM	INV.
1	22' LT.	158+54	P.R.C.F.E.S., E.R.S. 36" W/GRATING	104.80
2	46' LT.	158+26	P.R.C.F.E.S. 18"	105.50
3	22' LT.	158+26	R.C. ELL. PIPE TEE, S45, R29 18" RISER	104.55
4	46' LT.	157+77	P.R.C.F.E.S. 15"	105.10
5	23' LT.	157+77	R.C. ELL. PIPE TEE, S45, R29 15" RISER	104.45
6	23' LT.	157+50	P.R.C.F.E.S., E.R.S. 36" W/GRATING	104.40
7	22' RT.	158+48	P.B.C. END SECT. 2' X 8' W/GRATING	104.00
8	42' RT.	158+26	P.B.C. END SECT. 2' X 8' W/GRATING	104.00
9	23' RT.	158+26	P.B.C. TEE 2' X 8'	103.90
10	43' RT.	157+70	P.B.C. END SECT. 2' X 8' W/GRATING	104.00
11	26' RT.	157+70	P.B.C. TEE 2' X 8'	103.80
12	27' RT.	157+52	P.B.C. END SECT. 2' X 8' W/GRATING	103.70

LOCATION	R.C.C.P.			P.B.C. 2' X 8'	TR.B'FILL	C.L.S.M.
	TY-1,15"	TY-1,18"	TY-1,36" E.R.S.			
1 TO 3			16		3.0	
2 TO 3		16			2.2	
3 TO 5			40		4.4	8
4 TO 5	16				3.4	
5 TO 6			16		6.2	
7 TO 9				16	8	
8 TO 9				56	8	56
9 TO 11				8		
10 TO 11				16		
11 TO 12						
TOTALS	16	16	72	104	19.2	64

ITEM	UNIT	QUANTITY	C.L.S.M. CU.YD.
PIPE CULVERT REMOVAL	FOOT	42	11
STONE RIPRAP DITCH	TON	15	
RELOCATE EXISTING SIGNS	EACH	2	
BOX CULVERT REMOVAL	L SUM	1	
SEEDING CLASS 2 (SPL.)	ACRE	0.25	
P.C.C. PAVEMENT 8"	SQ. YD.	270	

B.M. RT. STA. 157+58
FIRE HYDRANT
ELEV. 102.80

INTERSECTION PAVEMENT / JOINT DETAIL