

FINAL SURVEY	DATE
NO. BY	
NOTE BOOK	
AREAS CHECKED	
NO.	

ORIGINAL SURVEY	DATE
NO. BY	
NOTE BOOK	
AREAS CHECKED	
NO.	

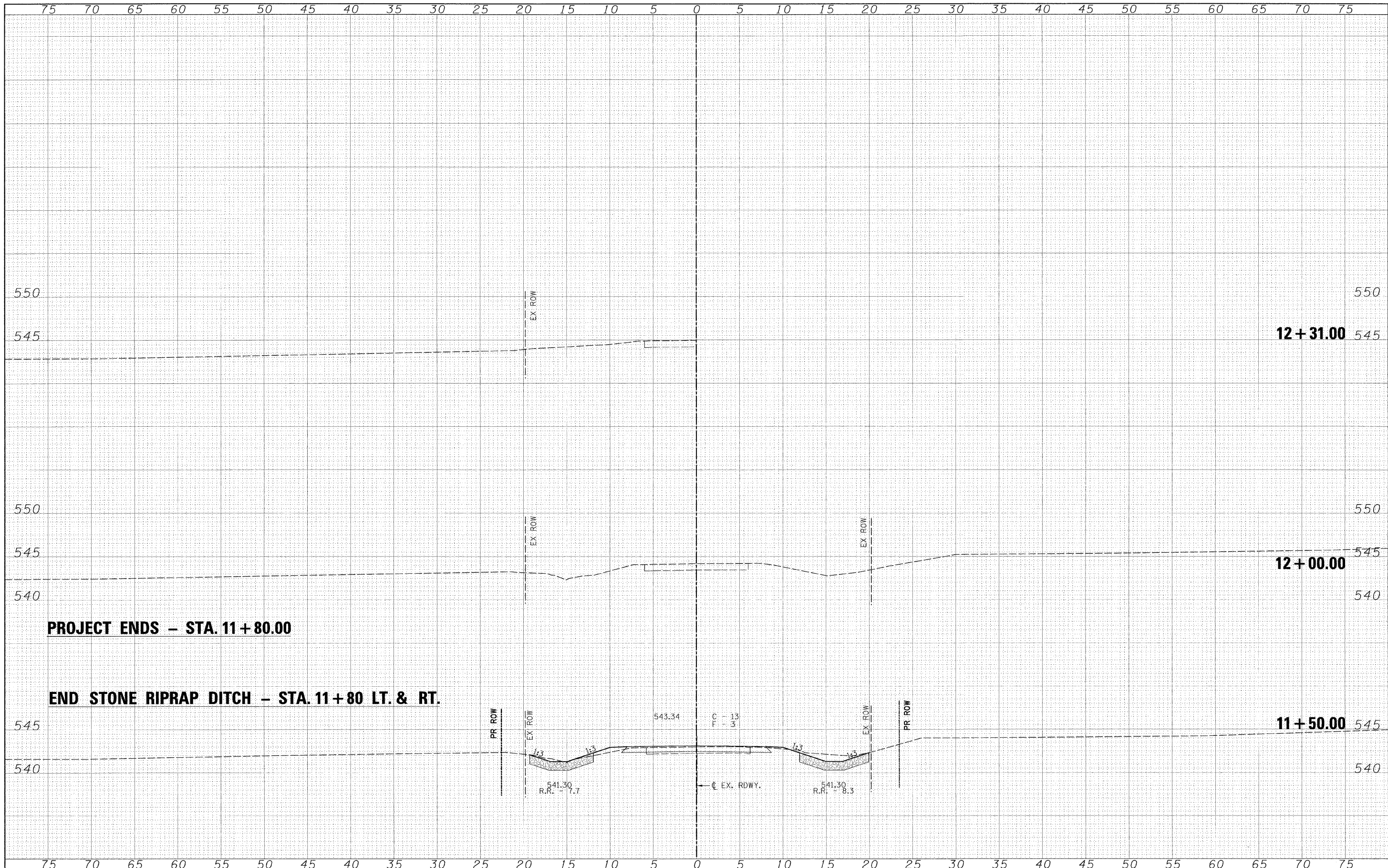

FILE NAME -  
#FILE#

USER NAME - #USER#  
DESIGNED -  
DRAWN -  
CHECKED -  
DATE -

DESIGNED -  
DRAWN -  
CHECKED -  
DATE -

REVISED -  
REVISED -  
REVISED -  
REVISED -



**Allen Henderson & Associates, Inc.**  
Civil and Structural Engineers Springfield, IL.  
62703 Phone: (217)544-8033 IL Design Firm  
No. 184-001907

**CROSS SECTIONS**  
SCALE: 1" = 5'  
SHEET NO. 21 OF 21 SHEETS  
STA. 12+00.00 TO STA. 12+50.00

I.R. RTE.	SECTION	COUNTY	TOTAL SHEETS	SHEET NO.
140	09-05118-00-BR	SHELBY	21	21
STR. NO. 087-3571		CONTRACT NO. 95428		
FED. ROAD DIST. NO. [ILLINOIS] FED. AID PROJECT				