

SECTION	COUNTY	TOTAL SHEETS	SHEET NO.
08-00119-00-FP	WAYNE	23	3
PAPERTOWN ROAD			
CONTRACT # 95632			
PLAN SHEET			

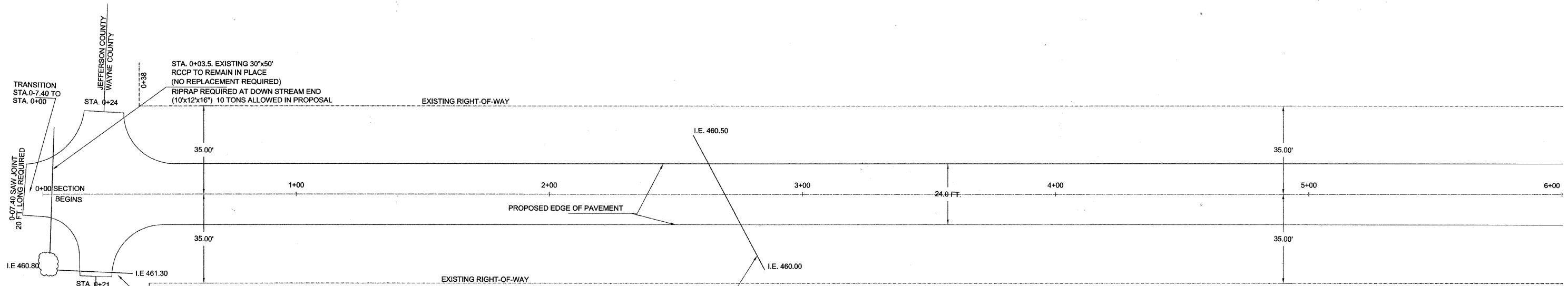

TRANSITION STA. 0+7.40 TO STA. 0+00

0-07.40 SAW JOINT 20 FT. LONG REQUIRED

JEFFERSON COUNTY WAYNE COUNTY

STA. 0+24

0+38

STA. 0+03.5. EXISTING 30"x50' RCCP TO REMAIN IN PLACE (NO REPLACEMENT REQUIRED) RIPRAP REQUIRED AT DOWN STREAM END (10"x12"x16") 10 TONS ALLOWED IN PROPOSAL

EXISTING RIGHT-OF-WAY

35.00'

0+00 SECTION BEGINS

1+00

2+00

3+00

4+00

5+00

6+00

PROPOSED EDGE OF PAVEMENT

24.0 FT.

I.E. 460.80

STA. 0+21

I.E. 461.30

JEFFERSON COUNTY WAYNE COUNTY

0+42

STA. 0+21.55 RT. EXISTING 30"x30' CMP TO BE REMOVED (NO SALVAGE REQUIRED) 30" EQ. CLASS A, TYPE 1 32' LONG, REQUIRED 9 C.Y. "CLSM" REQUIRED

STA. 2+69 EXISTING 30"x60' CMP TO BE REMOVED (NO SALVAGE REQUIRED) 30" EQ. CLASS A, TYPE 1 48' LONG, WITH PRECAST CONCRETE FLARED END SECTIONS REQUIRED SKEW 28° RT. FORWARD 16 C.Y. "CLSM" REQUIRED

I.E. 460.50

I.E. 460.00

DITCH TO THE SOUTH DOES NOT DRAIN. CLEANING OF EXISTING DITCH BY OTHERS.

**STA. 0+22.5
PROCESSING SOIL CEMENT QUANTITIES**

