

SECTION	COUNTY	TOTAL SHEETS	SHEET NO.
08-00119-00-FP	WAYNE	23	4
PAPERTOWN ROAD			
CONTRACT # 95632			
PLAN SHEET			

P.I. STA. 13+14.9

$\Delta = 1^{\circ}20' \text{ LT.}$
 $D = 0^{\circ}08'$
 $T = 500.25'$
 $L = 1000.00'$
 $R = 42,971.84'$
 $E = 3.00'$
 $SE = \text{NONE}$

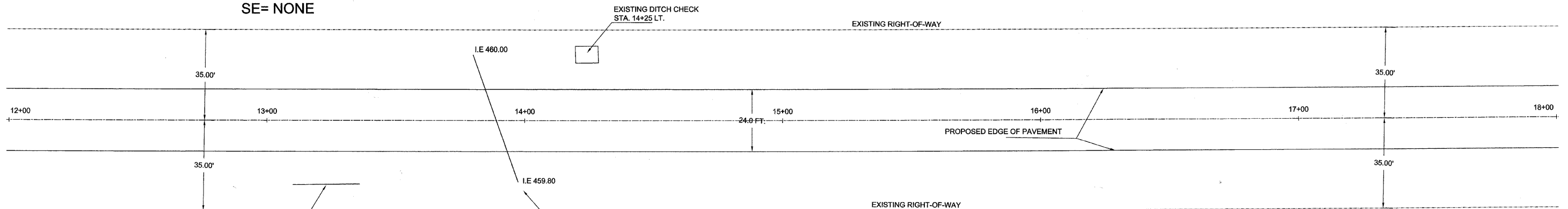

FIELD ENTRANCE STA. 13+23 RT. EXISTING
 12"x26" CMP TO BE REMOVED
 (NO SALVAGE REQUIRED)
 15"x30" PIPE CULVERTS, CLASS D,
 TYPE 1 REQUIRED
 (FLOWLINE TO MATCH SLOPE OF EXISTING
 DITCH)

STA. 13+89 EXISTING 18"x52"
 CMP TO BE REMOVED
 (NO SALVAGE REQUIRED)

18" EQ. CLASS A, TYPE 1
 40' LONG, WITH PRECAST
 CONCRETE FLARED END
 SECTIONS REQUIRED
 20° SKEW RT. FORWARD
 4 C.Y. "CLSM" REQUIRED

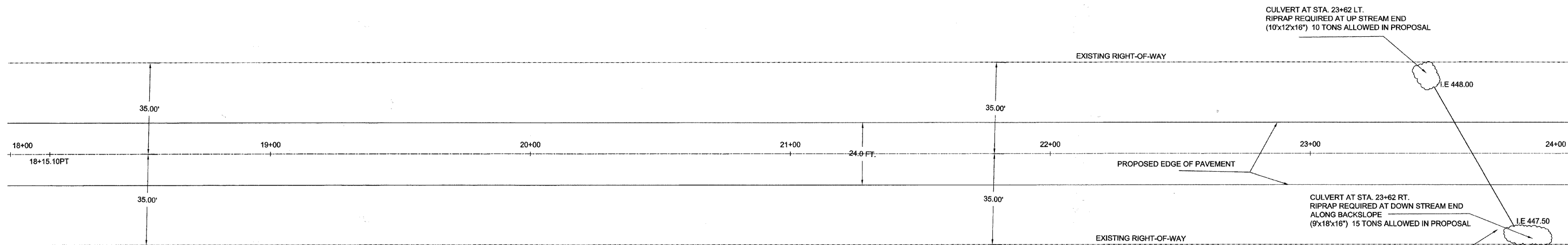

CULVERT AT STA. 23+62 LT.
 RIPRAP REQUIRED AT UP STREAM END
 (10x12x16") 10 TONS ALLOWED IN PROPOSAL

CULVERT AT STA. 23+62 RT.
 RIPRAP REQUIRED AT DOWN STREAM END
 ALONG BACKSLOPE
 (9x18x16") 15 TONS ALLOWED IN PROPOSAL

STA. 23+62 EXISTING 36"x60"
 CMP TO BE REMOVED
 (NO SALVAGE REQUIRED)

36" EQ. CLASS A, TYPE 1
 48' LONG, WITH PRECAST
 CONCRETE FLARED END
 SECTIONS REQUIRED
 30° SHEW RT. FORWARD
 9 C.Y. "CLSM" REQUIRED

