

SECTION	COUNTY	TOTAL SHEETS	SHEET NO.
08-00119-00-FP	WAYNE	23	17
PAPERTOWN ROAD			
CONTRACT # 95632			
PLAN SHEET			

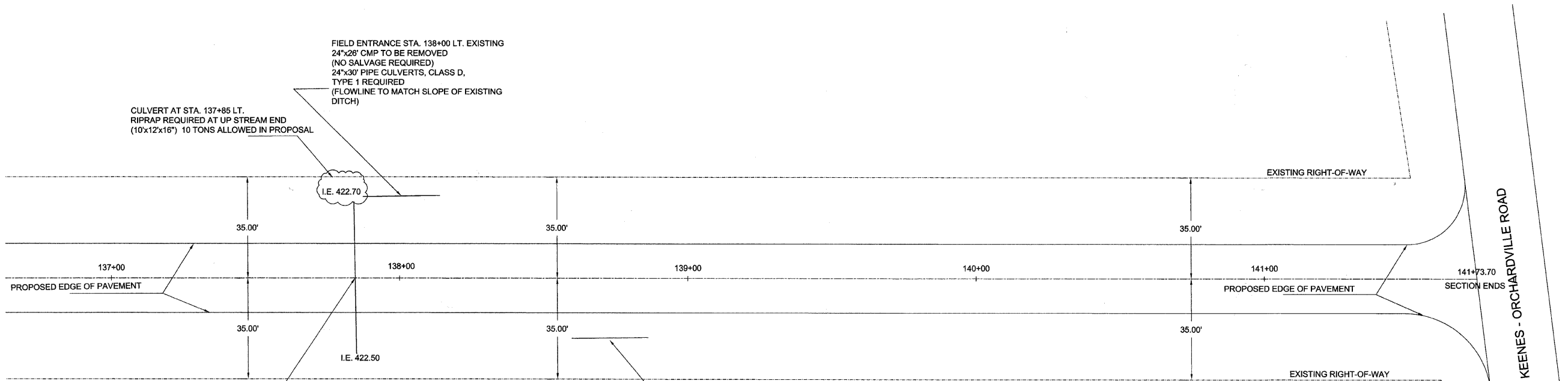

CULVERT AT STA. 137+85 LT.
RIPRAP REQUIRED AT UP STREAM END
(10x12x16") 10 TONS ALLOWED IN PROPOSAL

FIELD ENTRANCE STA. 138+00 LT. EXISTING
24"x26" CMP TO BE REMOVED
(NO SALVAGE REQUIRED)
24"x30" PIPE CULVERTS, CLASS D,
TYPE 1 REQUIRED
(FLOWLINE TO MATCH SLOPE OF EXISTING
DITCH)

STA. 137+85 EXISTING 30"x52"
CMP TO BE REMOVED
(NO SALVAGE REQUIRED)
30" EQ. CLASS A, TYPE 1
40' LONG, WITH PRECAST
CONCRETE FLARED END
SECTIONS REQUIRED
10 C.Y. "CLSM" REQUIRED

FIELD ENTRANCE STA. 138+72 RT. EXISTING
15"x30" CMP TO BE REMOVED
(NO SALVAGE REQUIRED)
15"x30" PIPE CULVERTS, CLASS D,
TYPE 1 REQUIRED
(FLOWLINE TO MATCH SLOPE OF EXISTING
DITCH)

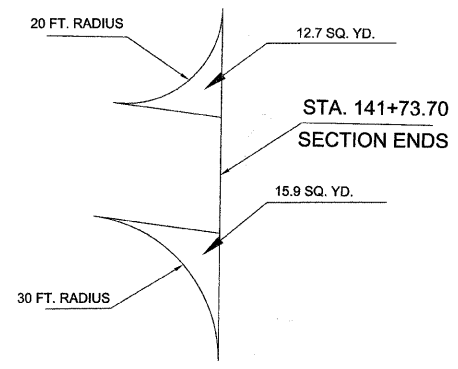

STA. 141+73.70
PROCESSING SOIL CEMENT QUANTITIES