

01.COPY\_5208.DGN MAR. 16, 2010

# BRIDGE REPLACEMENT AND REHABILITATION PROGRAM

## DETAIL PLANS FOR T.R. 165 (SOUTH GRAND RD.) OVER WILLIAMS CREEK SECTION 96-14115-00-BR PLUM HILL ROAD DISTRICT WASHINGTON COUNTY PROJECT NO. BROS-0189(050) JOB NO. C-98-390-09

T.R. RTE.	SECTION	COUNTY	TOTAL SHEETS	SHEET NO.
165	96-14115-00-BR	WASHINGTON	#15	1
S.N. 095-3251		CONTRACT NO. 97435		
ILLINOIS		FEDERAL AID PROJECT		

### INDEX OF SHEETS

- COVER SHEET
- SUMMARY OF QUANTITIES & TYPICAL ROADWAY CROSS SECTIONS
- EROSION CONTROL PLAN
- PLAN & PROFILE EXISTING & PROPOSED ROADWAY
- GENERAL PLAN & ELEVATION
- SUPERSTRUCTURE
- 27" x 36" P.P.C. DECK BEAM
- 27" x 36" P.P.C. DECK BEAM DETAILS
- PILE BENT ABUTMENT
- STEEL RAILING, TYPE S-1
- HP PILE DETAILS
- SOIL BORING LOGS
- CROSS SECTIONS EXISTING & PROPOSED ROADWAY
- CROSS SECTIONS EXISTING & PROPOSED ROADWAY
- CROSS SECTIONS EXISTING & PROPOSED ROADWAY

### HIGHWAY STANDARDS

- 280001-05 TEMPORARY EROSION CONTROL SYSTEMS
- 515001-03 NAME PLATE FOR BRIDGES
- 701901-01 TRAFFIC CONTROL DEVICES
- BLR 21-8 TYPICAL APPLICATION OF TRAFFIC CONTROL DEVICES FOR CONSTRUCTION ON RURAL LOCAL HIGHWAYS
- BLR 22-6 TYPICAL APPLICATION OF TRAFFIC CONTROL DEVICES FOR CONSTRUCTION ON RURAL LOCAL HIGHWAYS (TWO-LANE TWO WAY RURAL TRAFFIC) (ROAD CLOSED TO THRU TRAFFIC)

### DESIGN CLASSIFICATION

LOCAL ROAD (NON-URBAN) A.D.T. = 0-250  
CURRENT A.D.T. = 25 (2009)  
DESIGN A.D.T. = 25 (2009)  
DESIGN SPEED = 30 M.P.H.

### UTILITIES:

CALL J.U.L.I.E. BEFORE YOU DIG  
1-800-892-0123

### TELEPHONE:

FRONTIER COMMUNICATIONS  
ALTAMONT, IL. 62411  
(618) 483-6205

### SCALES:

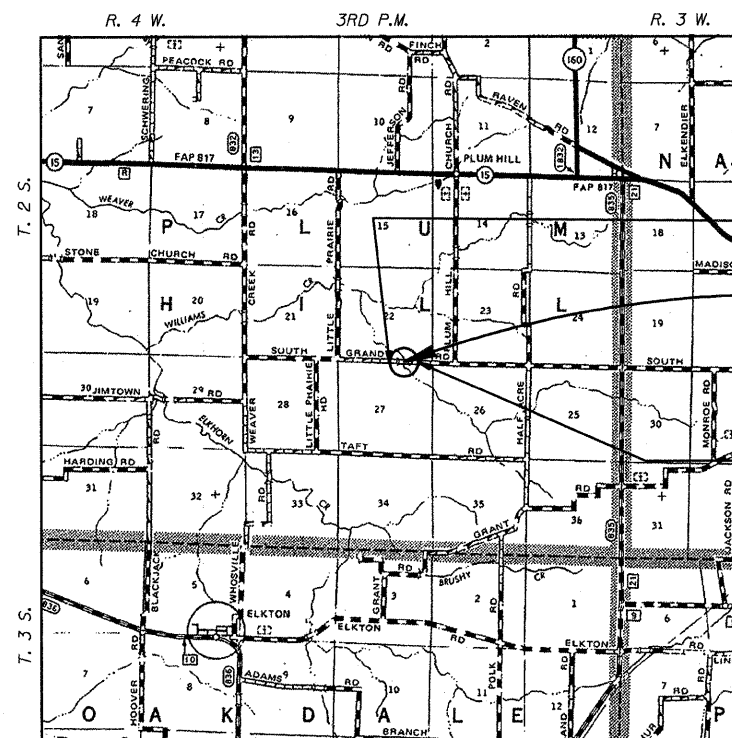
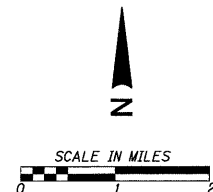
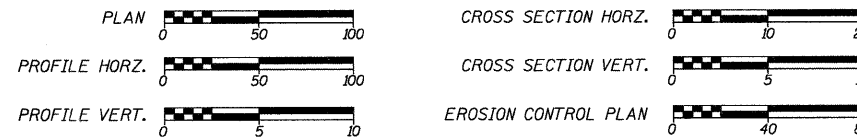

SECTION 96-14115-00-BR  
BEGINS STA. 84+00

### PROJECT LOCATION

PROPOSED STRUCTURE NO. 095-3251 STATION 88+23  
SIMPLE SPAN PRECAST PRESTRESSED CONCRETE  
DECK BEAMS (27" DEPTH) ON SPILL THRU PILE BENT  
ABUTMENTS MEASURING 70'-0" BACK TO BACK OF THE  
ABUTMENTS WITH A 24'-0" CLEAR ROADWAY WIDTH.

SECTION 96-14115-00-BR  
ENDS STA. 91+00

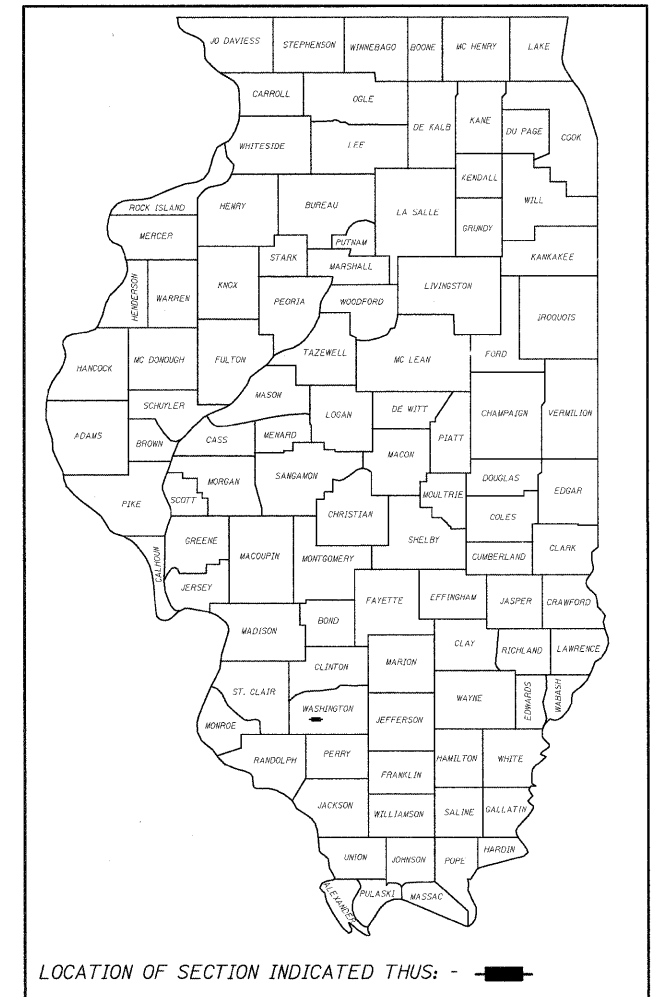

ILLINOIS DEPARTMENT OF TRANSPORTATION			
APPROVED	<u>March 11</u>	20	<u>10</u>
	<u>Martin Stuebgen</u>		ROAD COMMISSIONER
APPROVED	<u>March 11</u>	20	<u>10</u>
	<u>[Signature]</u>		COUNTY ENGINEER
PASSED	<u>April 16</u>	20	<u>10</u>
	<u>[Signature]</u>		DISTRICT 8 ENGINEER OF LOCAL ROADS AND STREETS
RELEASING FOR BID BASED UPON LIMITED REVIEW	<u>April 16</u>	20	<u>10</u>
	<u>[Signature]</u>		MARY C. LAMIE, P.E. DEPUTY DIRECTOR OF HIGHWAYS REGION FIVE ENGINEER
			STATE OF ILLINOIS DEPARTMENT OF TRANSPORTATION

### LOCATION MAP

NET LENGTH OF PROJECT = 700 FEET OR 0.133 MILES.



Larry D. Gowler, Jr. DATE 3/16/10  
LARRY D. GOWLER, JR.  
REGISTERED PROFESSIONAL  
ENGINEER IN ILLINOIS, NO. 52900



EXPIRES: NOVEMBER 30, 2011

F.M.G. NO. 5208