

ROUTE	COUNTY	SECTION	SHEET/OF
FAS 1834	RANDOLPH	06-00075-00-RS	17/101

CONTRACT NO. 97445

348+00 349+00 350+00 351+00 352+00 353+00 354+00 355+00 356+00 357+00

BAIRD TRACT

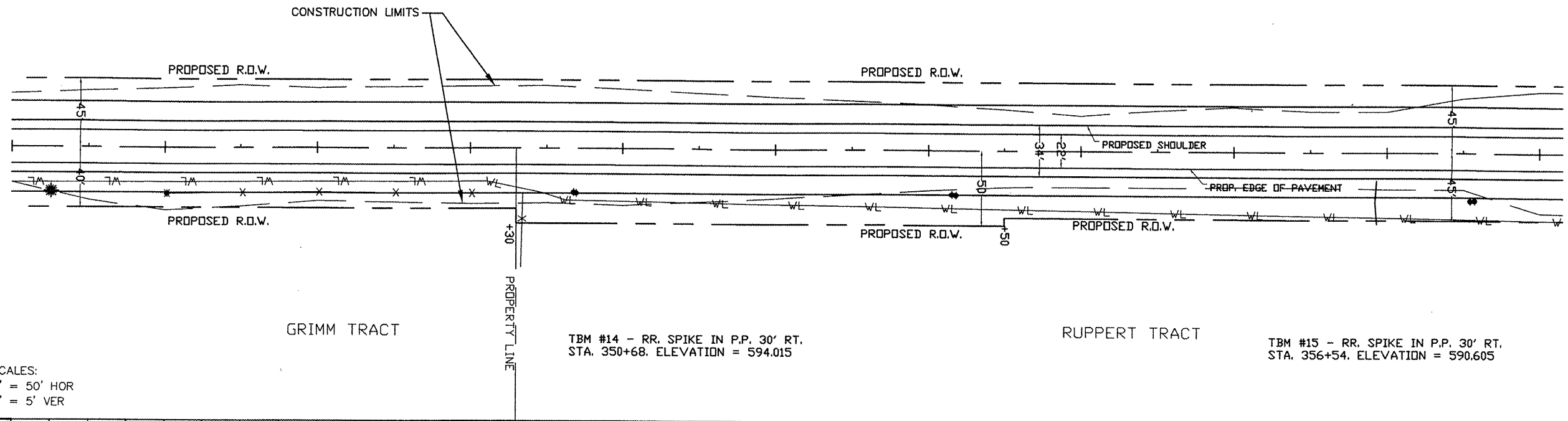

GRIMM TRACT

TBM #14 - RR. SPIKE IN P.P. 30' RT.
STA. 350+68. ELEVATION = 594.015

RUPPERT TRACT

TBM #15 - RR. SPIKE IN P.P. 30' RT.
STA. 356+54. ELEVATION = 590.605

SCALES:
1" = 50' HOR
1" = 5' VER

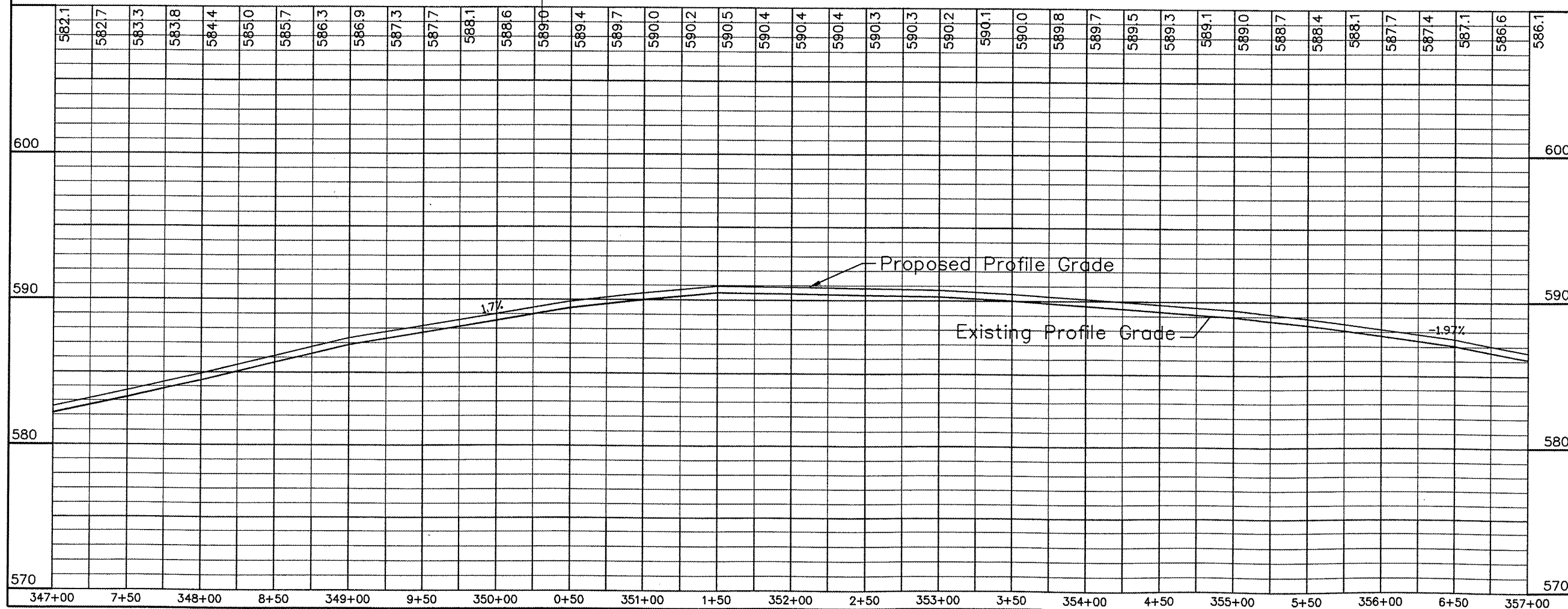

Plan and Profile Sta 347+00 to Sta 357+00