

FAS ROUTE 1834 (COUNTY HIGHWAY 11)  
 SECTION NO. 06-00075-00-RS  
 INTERSECTION DETAIL AT ILLINOIS  
 ROUTE 154

ROUTE	COUNTY	SECTION	SHEET/OF
FAS 1834	RANDOLPH	06-00075-00-RS	23/101
CONTRACT NO. 97445			

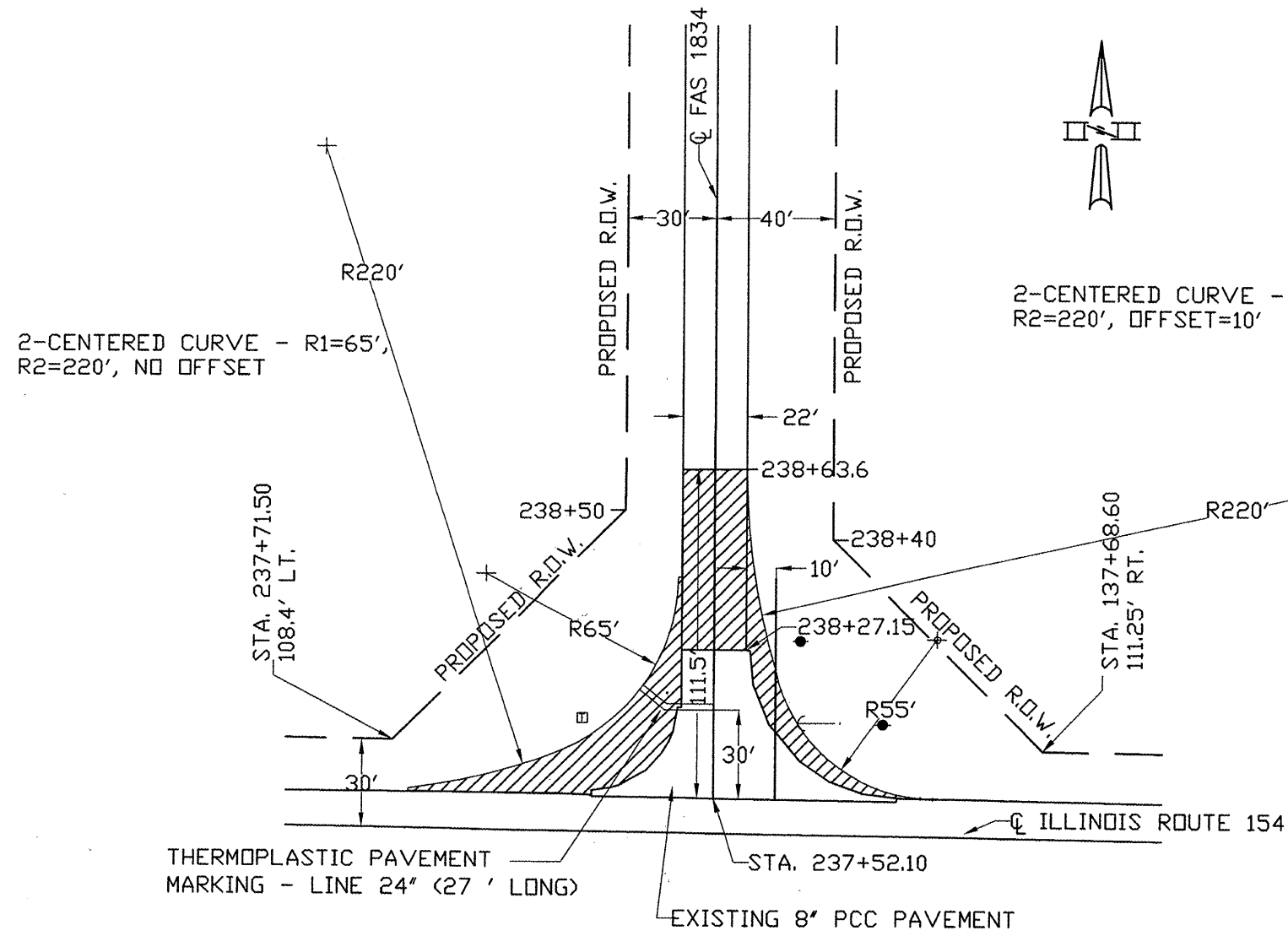

MAILBOX TURNOUTS, SIDEROADS  
 AND PRIVATE ENTRANCES

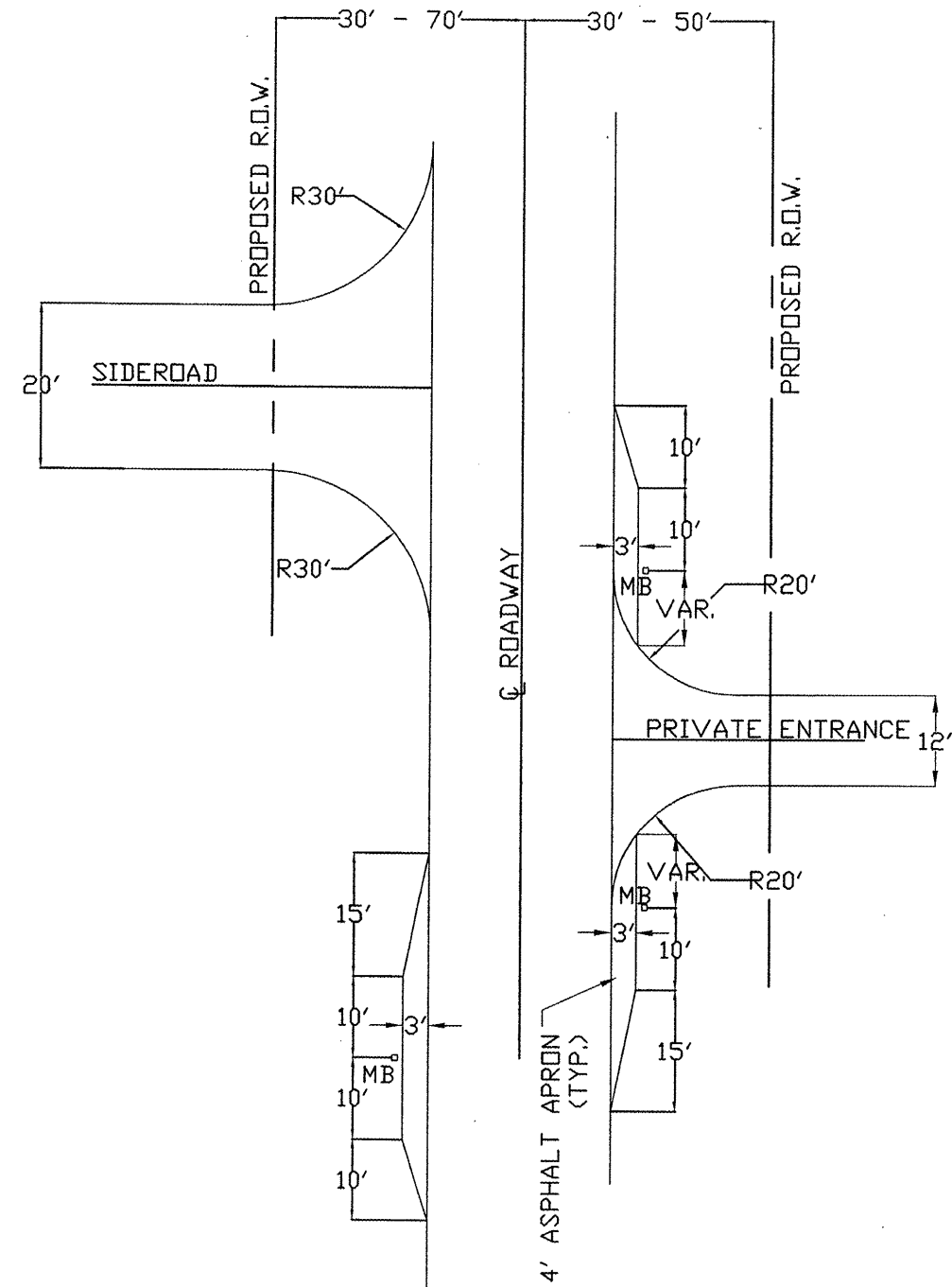

HOT-MIX ASPHALT TO BE EXTENDED TO R.O.W. ON ALL SIDEROAD AND PRIVATE ENTRANCES.  
 MAILBOX TURNOUTS SEE STD. BLR-24-2

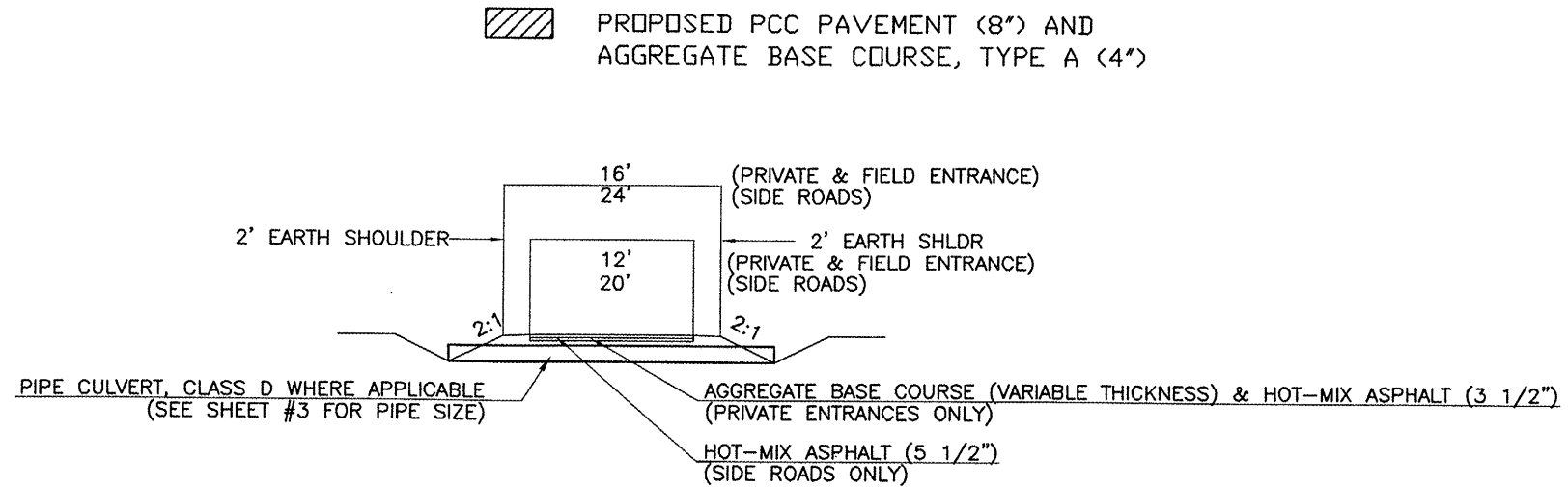

TYPICAL ENTRANCE & SIDE ROAD DETAILS