

**GENERAL NOTES:**

1. CONTRACTOR SHALL CONSULT JOB SPECIFICATIONS FOR MORE INFORMATION.
2. LAYOUT OF EROSION CONTROL MEASURES MAY BE ADJUSTED IN FIELD BY ENGINEER FOR VARYING GROUND CONDITIONS.
3. TEMPORARY DITCH CHECKS SHALL BE URETHANE FOAM/GEOTEXTILE DITCH CHECKS PER STD. 280001.
4. HAY OR STRAW BALES SHALL NOT BE USED FOR DITCH CHECKS.
5. CONTRACTOR SHALL PROVIDE STABILIZED CONSTRUCTION ENTRANCES AS NECESSARY TO MINIMIZE OFF SITE VEHICLE TRACKING OF SOIL AND DEBRIS. SEE SPECS.
6. ALL DISTURBED AREAS SHALL RECEIVE TEMPORARY EROSION CONTROL SEEDING AS DESCRIBED IN SPECS. UNTIL PERMANENT STABILIZATION CAN BE PERFORMED.
7. THE COUNTY WILL ASSUME RESPONSIBILITY FOR MAINTAINING EROSION CONTROL MEASURES THROUGH FINAL STABILIZATION AFTER I.D.O.T. ACCEPTANCE OF WORK BY CONTRACTOR.

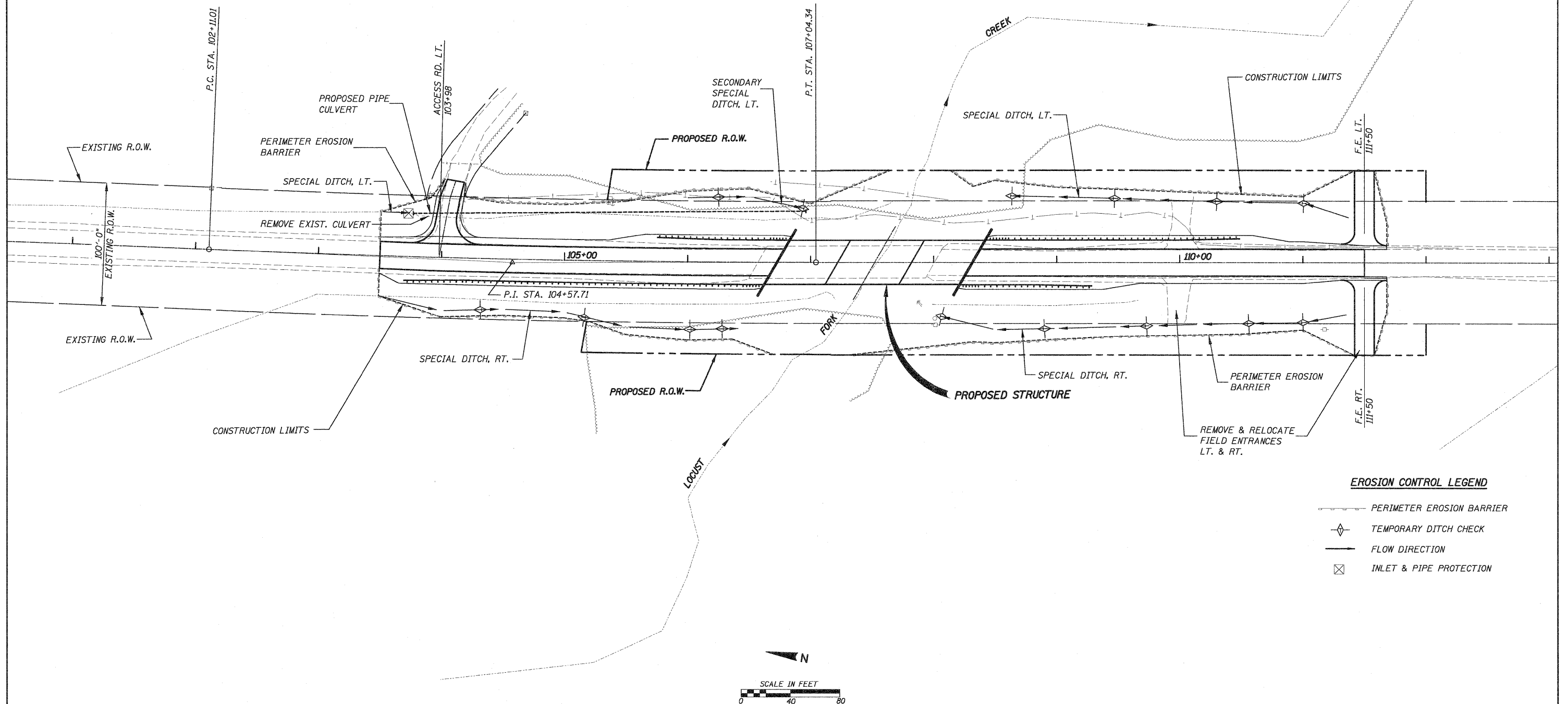

**EROSION CONTROL LEGEND**

- PERIMETER EROSION BARRIER
- ◇ TEMPORARY DITCH CHECK
- FLOW DIRECTION
- ⊠ INLET & PIPE PROTECTION

△ REVISED 5-21-10

FILE NAME * h:\25290\07_eros_5250.dgn	USER NAME * _USERDESCR_	DESIGNED - K.M.M.	REVISED - MAY 7, 2010
		DRAWN - K.H.L.	REVISED -
		CHECKED - L.D.G.	REVISED -
		DATE -	REVISED -
	PLOT SCALE = 40,0000' / 1IN.		
	PLOT DATE = 5/7/2010		

STATE OF ILLINOIS  
DEPARTMENT OF TRANSPORTATION

EROSION CONTROL PLAN

F.A.S. RTE. 783	SECTION 02-00074-00-BR	COUNTY BOND	TOTAL SHEETS 25	SHEET NO. 7
S.N. 003-3050		CONTRACT NO. 97446		
ILLINOIS FED. AID PROJECT				

H.M.G. INC. 5250