

F.A. RTE.	SECTION	COUNTY	TOTAL SHEETS	SHEET NO.
*	**	***	304	1
* FAU 9481, FAS 2887 (IL 37)				
** (12,12X),RS-3;12B-1,12B1-1				
*** FRANKLIN AND WILLIAMSON				

**STATE OF ILLINOIS  
DEPARTMENT OF TRANSPORTATION  
DIVISION OF HIGHWAYS**

**PROPOSED  
HIGHWAY PLANS**

**ROUTE: FAU 9481 AND FAS 2887 (IL 37)  
SECTION: (12,12X),RS-3;12B-1,12B1-1**

**PROJECT: ACM-ACRS-BRM-000S (692)  
COUNTY: FRANKLIN AND WILLIAMSON  
C-99-074-03**

**FOR INDEX OF SHEETS, SEE SHEET NO. 2  
FOR SUMMARY OF QUANTITIES, SEE SHEET NOS. 5-9**

**STATION EQUATIONS:**

PT STA. 94+19.21 BK = STA. 366+03.65 AH  
PT STA. 382+93.50 BK = STA. 382+98.60 AH  
PT STA. 477+33.40 BK = STA. 477+36.79 AH

**OMISSIONS:**  
NONE

**TRAFFIC DATA:**

2005 ADT FOR IL 37  
JOHNSON CITY TO WILLIAMSON/ FRANKLIN CO. LINE 6600 WITH 8.8% TRUCKS  
WILLIAMSON/ FRANKLIN CO. LINE TO WEST FRANKFORT 8000 WITH 3.9% TRUCKS

**TOWNSHIPS:**

HERRIN (WILLIAMSON CO.)  
DENNING (FRANKLIN CO.)

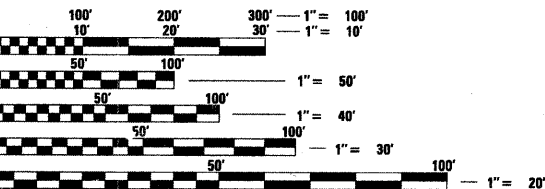

**FULL SIZE PLANS HAVE BEEN PREPARED USING STANDARD ENGINEERING SCALES. REDUCED SIZED PLANS WILL NOT CONFORM TO STANDARD SCALES. IN MAKING MEASUREMENTS ON REDUCED PLANS, THE ABOVE SCALES MAY BE USED.**

**J.U.I.E.  
JOINT UTILITY LOCATION INFORMATION FOR EXCAVATION  
1-800-892-0123 or www.julie1call.com**

**CONTRACT NO. 98823**

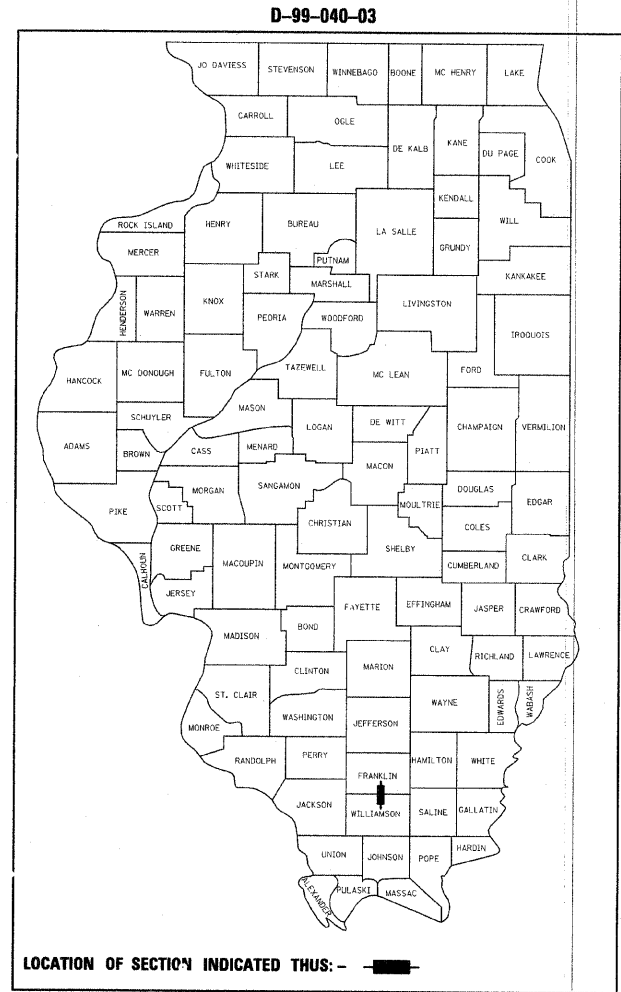
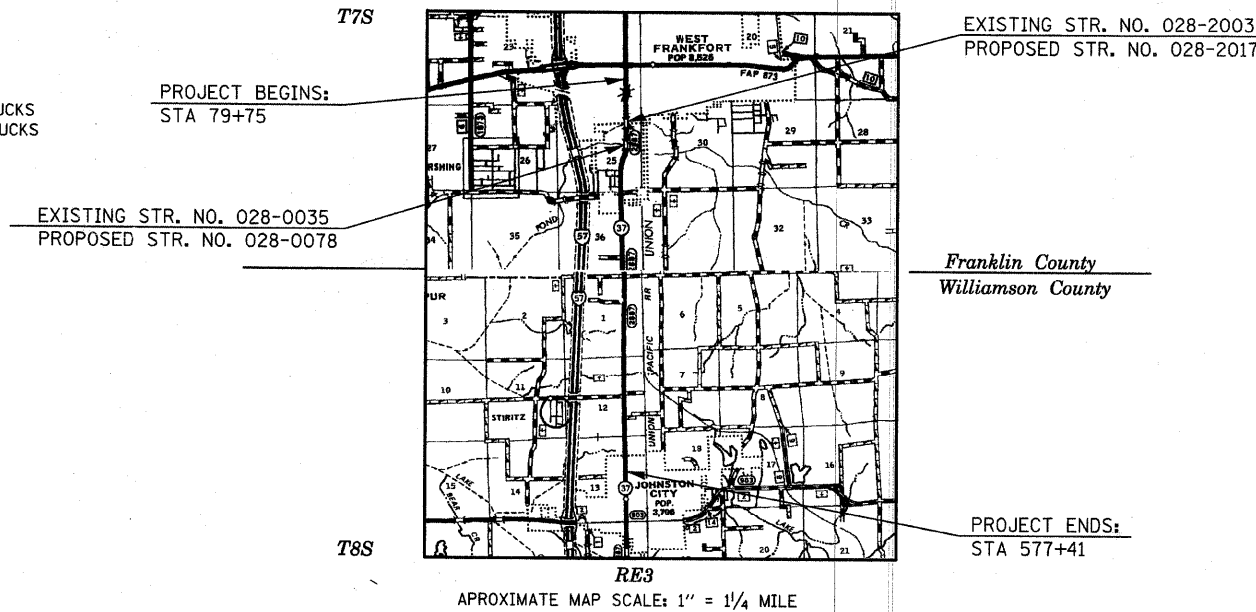

LOCATION OF SECTION INDICATED THUS: - [black rectangle] -

**STATE OF ILLINOIS  
DEPARTMENT OF TRANSPORTATION  
DIVISION OF HIGHWAYS**

SUBMITTED Oct 13 2009

Mary C. Lams  
DEPUTY DIRECTOR OF HIGHWAYS, REGION ENGINEER

May 7 2010  
Scott E. Stitt P.E. /e  
acting ENGINEER OF DESIGN AND ENVIRONMENT

May 7 2010  
Christina M. Reed /e  
DIRECTOR OF HIGHWAYS, CHIEF ENGINEER

**GROSS LENGTH OF PROJECT = 22,573.07 = 4.28 MILES  
NET LENGTH OF PROJECT = 22,573.07 = 4.28 MILES**

**PRINTED BY THE AUTHORITY  
OF THE STATE OF ILLINOIS**

PLOT DATE = 8/4/2009  
 FILE NAME = c:\pwworkspace\hendon\user\43659\d984083p.dgn  
 PLOT SCALE = 50.0000 / IN.  
 USER NAME = hendon  
 PROJECT ENGINEER: (618) 549-2171  
 SQUAD LEADER: RICHARD BRASEL  
 CENTREX 782-4554