

F.A. RTE.	SECTION	COUNTY	TOTAL SHEETS	SHEET NO.
*	**	***	304	103

STA.	TO STA.
FED. ROAD DIST. NO.	ILLINOIS FED. AID PROJECT

* FAU 9481, FAS 2887 (IL 37)
 ** (12.12X)RS-3;12B-1;12B1-1
 *** FRANKLIN AND WILLIAMSON

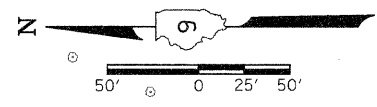

- NOTES:
- FOR PLAN PROFILE OF THE TEMPORARY DETOUR #2, SEE STAGE 1 PLAN SHEET.
 - FOR PLAN OF IL 37 PAVEMENT REMOVAL, SEE DETOUR RD #2, STAGE 2 PLAN SHEET.
 - FOR PLAN OF TEMPORARY DETOUR #2 PAVEMENT REMOVAL SEE DETOUR RD #2, STAGE 3 PLAN SHEET.

EXIST. CURVE 11
 P.I. STA. = 11+24.17
 $\Delta = 8^\circ 20' 10''$ (RT)
 $D = 3^\circ 40' 28''$
 $R = 1,559.35'$
 $L = 113.64'$
 $E = 226.87'$
 $F = 4.14'$
 P.C. STA. = 10+10.53
 P.T. STA. = 12+37.40

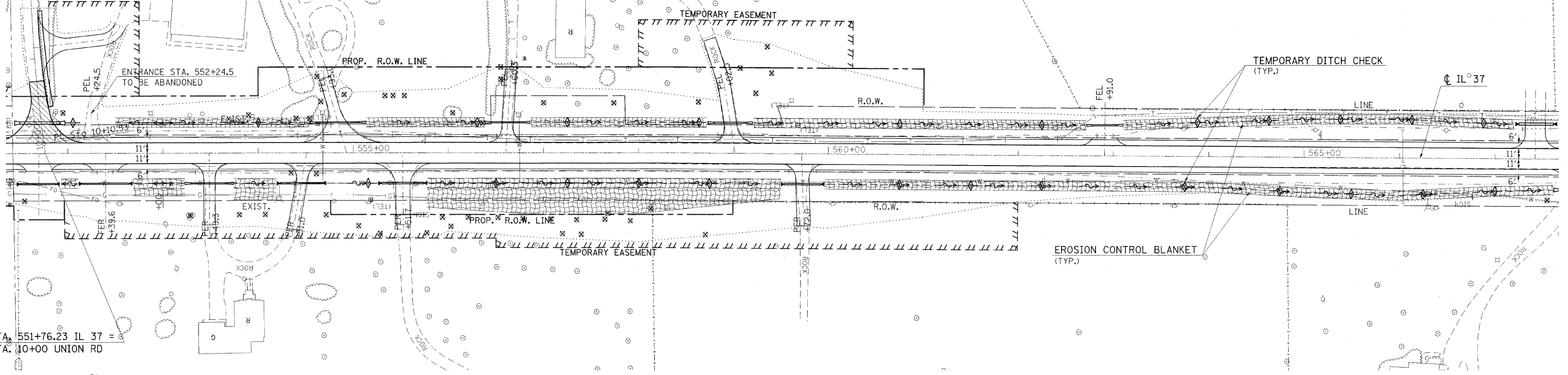

STA. 551+76.23 IL 37 =
 STA. 10+00 UNION RD

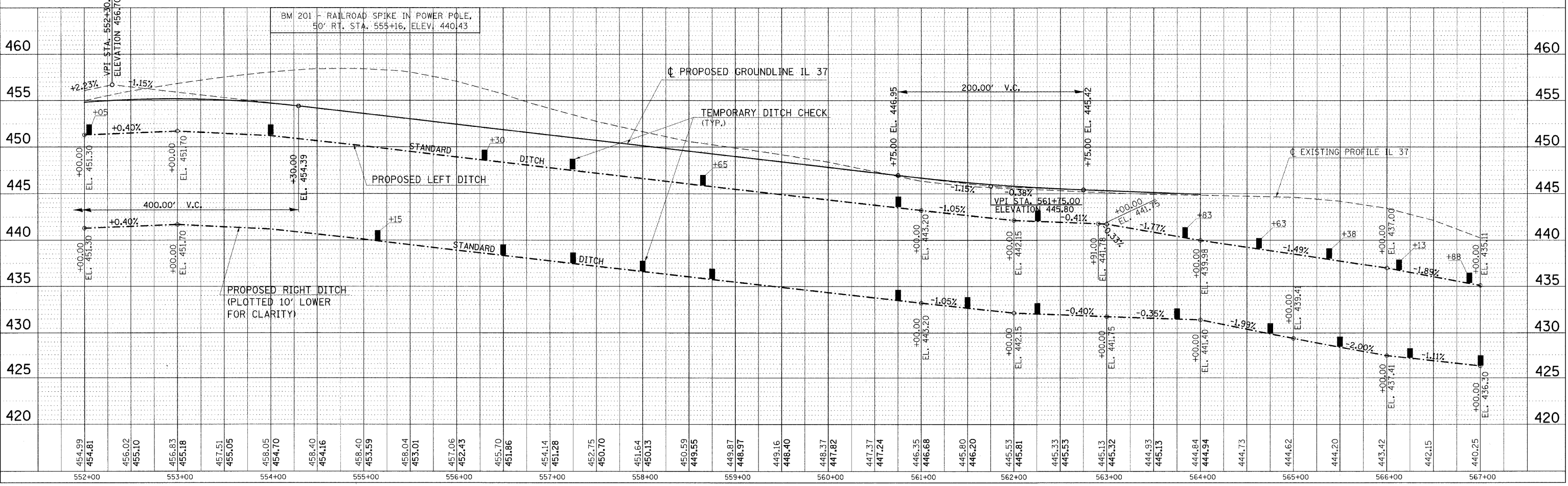

EROSION CONTROL STA. 552+00 TO STA. 567+00

NO.	DATE	BY

379016.dgn
 379016 USER NAME = hessan
 379016 FILE NAME = hessan
 12/7/2009 PLOT DATE = 12/7/2009
 379016 USER NAME = hessan