

F.A. RTE.	SECTION	COUNTY	TOTAL SHEETS	SHEET NO.
*	**	***	304	117
STA.		TO STA.		
FED. ROAD DIST. NO.		ILLINOIS FED. AID PROJECT		
* FAU 9481, FAS 2887 (IL 37)				
** (12X)RS-3;12B-1,12B1-1				
*** FRANKLIN AND WILLIAMSON				

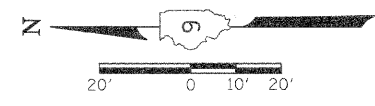

ENTRANCE RT. STA. 400+00 (TIPPS ROAD)

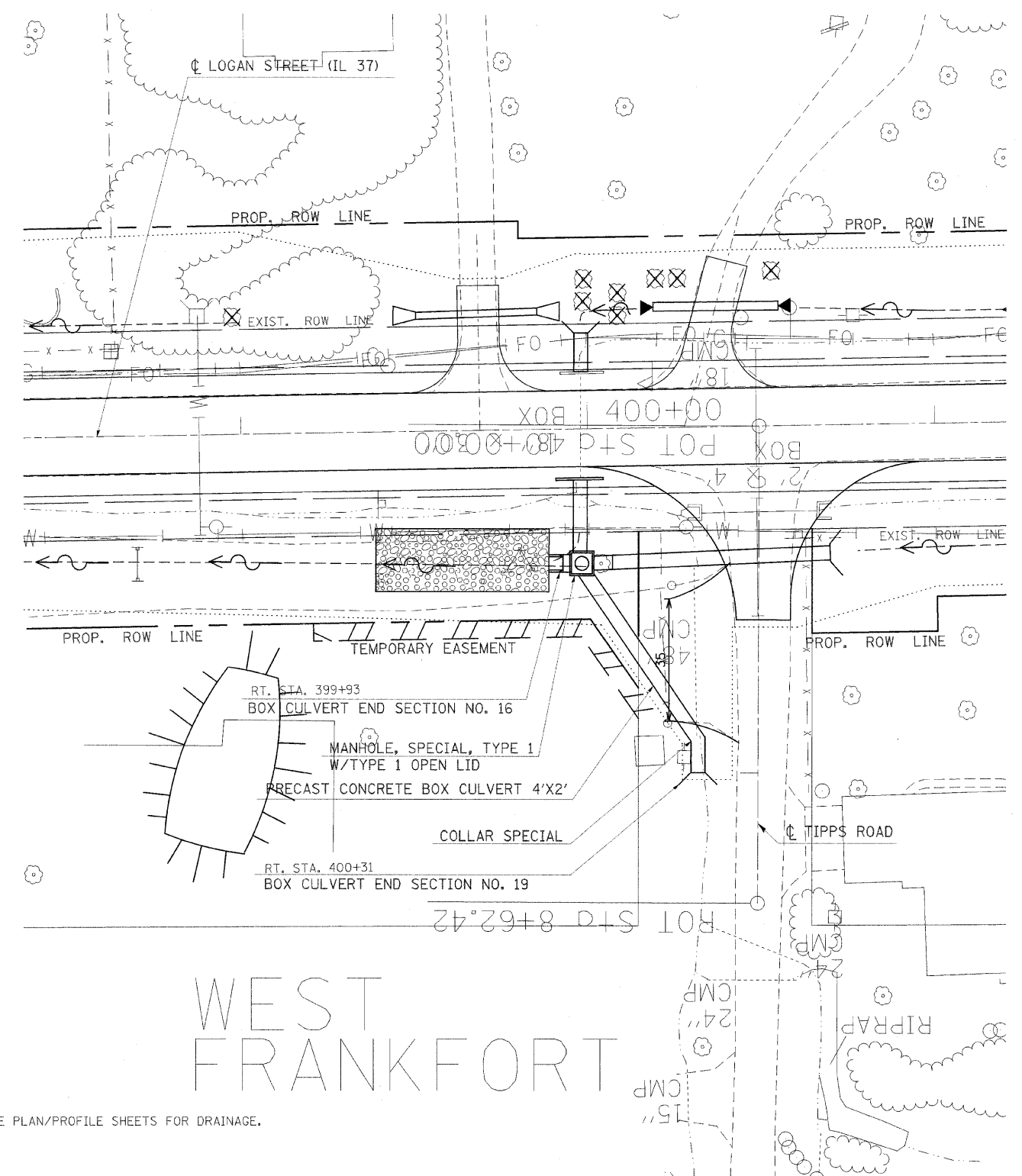

SEE PLAN/PROFILE SHEETS FOR DRAINAGE.

PLOT DATE = 01/17/2019
 FILE NAME = C:\Users\barneing\OneDrive\Documents\98823\98823.dgn
 PLOT SCALE = 20.00000 / IN.
 USER NAME = barneing

ENTRANCES LT. STA. 380+88 AND STA. 381+76

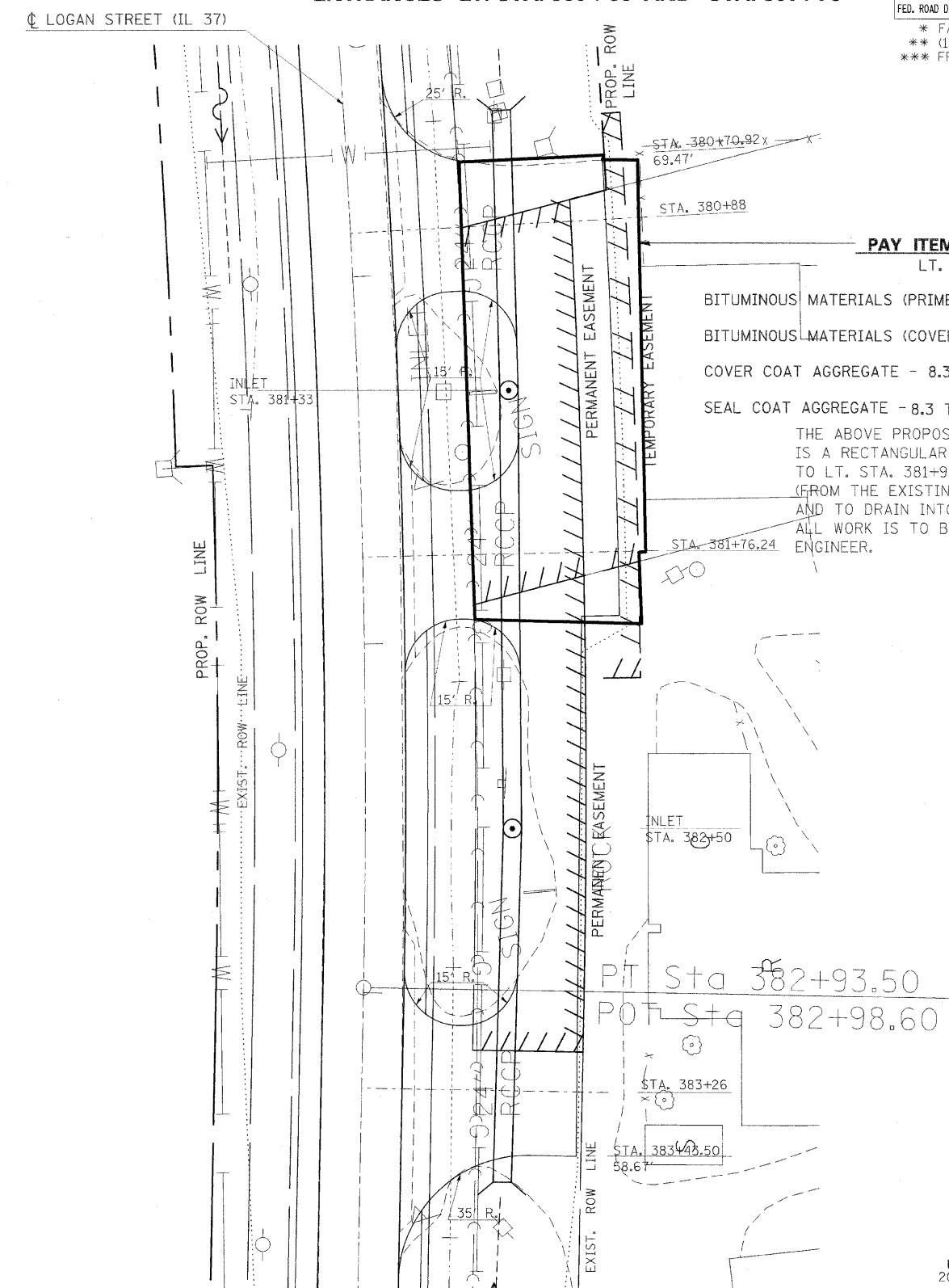

PAY ITEMS FOR THIS AREA

- LT. STA. 380+88
- BITUMINOUS MATERIALS (PRIME COAT) - 213 GALLONS
 - BITUMINOUS MATERIALS (COVER AND SEAL COATS) - 426 GALLONS
 - COVER COAT AGGREGATE - 8.3 TONS
 - SEAL COAT AGGREGATE - 8.3 TONS
- THE ABOVE PROPOSED SURFACE TREATMENT IS A RECTANGULAR AREA LT. STA. 380+70 TO LT. STA. 381+94, APPROXIMATELY 48' WIDE (FROM THE EXISTING R.O.W. TO THE BUILDING, AND TO DRAIN INTO THE PROPOSED INLET. ALL WORK IS TO BE AS DIRECTED BY THE ENGINEER.

SEE PLAN/PROFILE SHEETS FOR DRAINAGE.

REVISIONS	
NAME	DATE

ILLINOIS DEPARTMENT OF TRANSPORTATION

DETAILS:

ENTRANCES

SCALE: VERT. 20 SCALE
 HORIZ. DATE
 DRAWN BY
 CHECKED BY

