

GENERAL NOTES:

THIS SECTION SHALL BE CONSTRUCTED IN ACCORDANCE WITH THE PLANS, SPECIAL PROVISIONS AND "STANDARD SPECIFICATIONS FOR ROAD AND BRIDGE CONSTRUCTION", ADOPTED JANUARY 1, 2007.

THE WORK INVOLVED ON THIS SECTION CONSISTS OF THE REMOVAL OF THE EXISTING STRUCTURE, THE CONSTRUCTION OF A 45 FOOT LONG SINGLE SPAN PRECAST, PRESTRESSED CONCRETE DECK BEAM BRIDGE, EARTH APPROACHES, AGGREGATE SURFACE COURSE AND OTHER MISCELLANEOUS ITEMS NECESSARY TO COMPLETE THIS SECTION.

ALL ELEVATIONS ARE BASED ON U.S.G.S. MEAN SEA LEVEL DATUM.

IT SHALL BE THE CONTRACTOR'S RESPONSIBILITY TO CONTACT ALL THE UTILITIES, AFFECTING THE PROJECT, PRIOR TO CONSTRUCTION.

TYPICAL CROSS SECTION PROPOSED

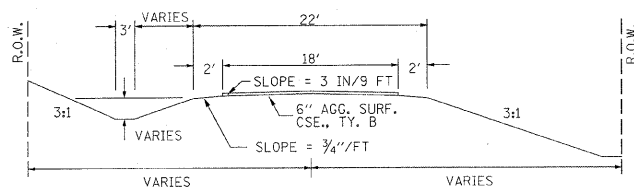

TYPICAL CROSS SECTION EXISTING

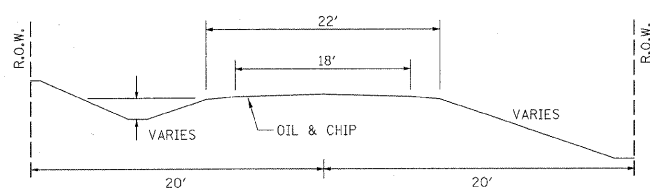

FIELD ENTRANCE DETAIL

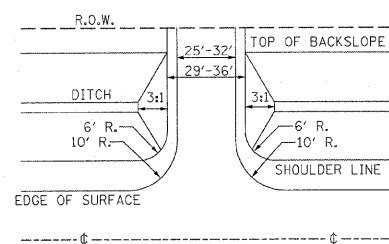

NOTE: CONSTRUCT SPECIAL DITCH

STA 4+00 TO STA 4+81 LT
STA 5+14 TO STA 6+50 LT
STA 5+15 TO STA 6+50 RT

NOTE: CONSTRUCT STONE RIPRAP DITCH

STA 4+50 TO STA 4+81 LT (0.62 TON/LIN FT)
STA 5+15 TO STA 5+55 RT (0.62 TON/LIN FT)
44 TON STONE RIPRAP DITCH ALLOWED IN PROPOSAL.

SEE STONE RIPRAP DITCH DETAIL.

STONE RIPRAP DITCH DESIGN

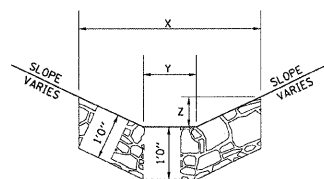
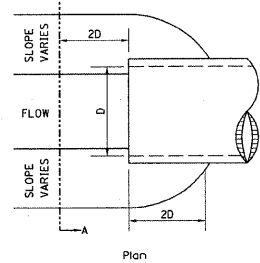

NOTE:

BOTTOM OF DITCH	SLOPE		
	1 1/2:1	2:1	3:1
2 FT	X = 5 FT	6 FT	8 FT
	Y = 2 FT	2 FT	2 FT
	Z = 1 FT	1 FT	1 FT
	0.40	0.48	0.62 TON/LIN. FT

NOTE: FOR PLACEMENT, QUALITY GRADATION AND OTHER MISCELLANEOUS REQUIREMENTS FOR STONE RIPRAP DITCH-SEE SPECIAL PROVISIONS.

NOTE: CONSTRUCTION TRANSITION
STA. 3+50 TO STA 4+00
STA 6+00 TO STA 6+50
ALL QUANTITIES ARE INCLUDED IN THE PROPOSAL

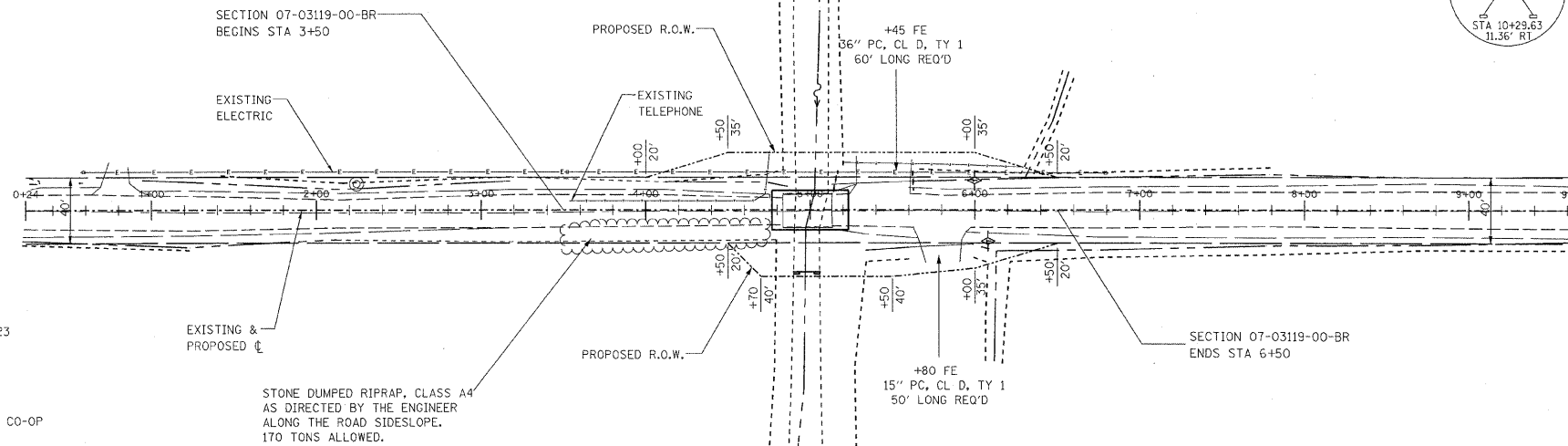
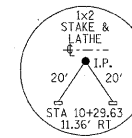

UTILITIES:
J.U.L.I.E. 1-800-892-0123
VERIZON
1-618-997-0707
WAYNE-WHITE ELECTRIC CO-OP
1-618-842-2196

STONE DUMPED RIPRAP, CLASS A4 AS DIRECTED BY THE ENGINEER ALONG THE ROAD SIDESLOPE. 170 TONS ALLOWED.

EXISTING BRIDGE STA 4+98.3; STRUCTURE NUMBER: 097-3106 AN OIL & CHIP COVERED 30' LONG SINGLE SPAN CONCRETE DECK BEAM BRIDGE WITH 9" CONCRETE CURBS ON CONCRETE CAP AND WOODEN PILING.

ONE (1) EACH-REMOVAL OF EXISTING STRUCTURES ALLOWED IN THIS PROPOSAL.

NOTE: FILL NEXT TO BRIDGE TO BE AGGREGATE SURFACE COURSE

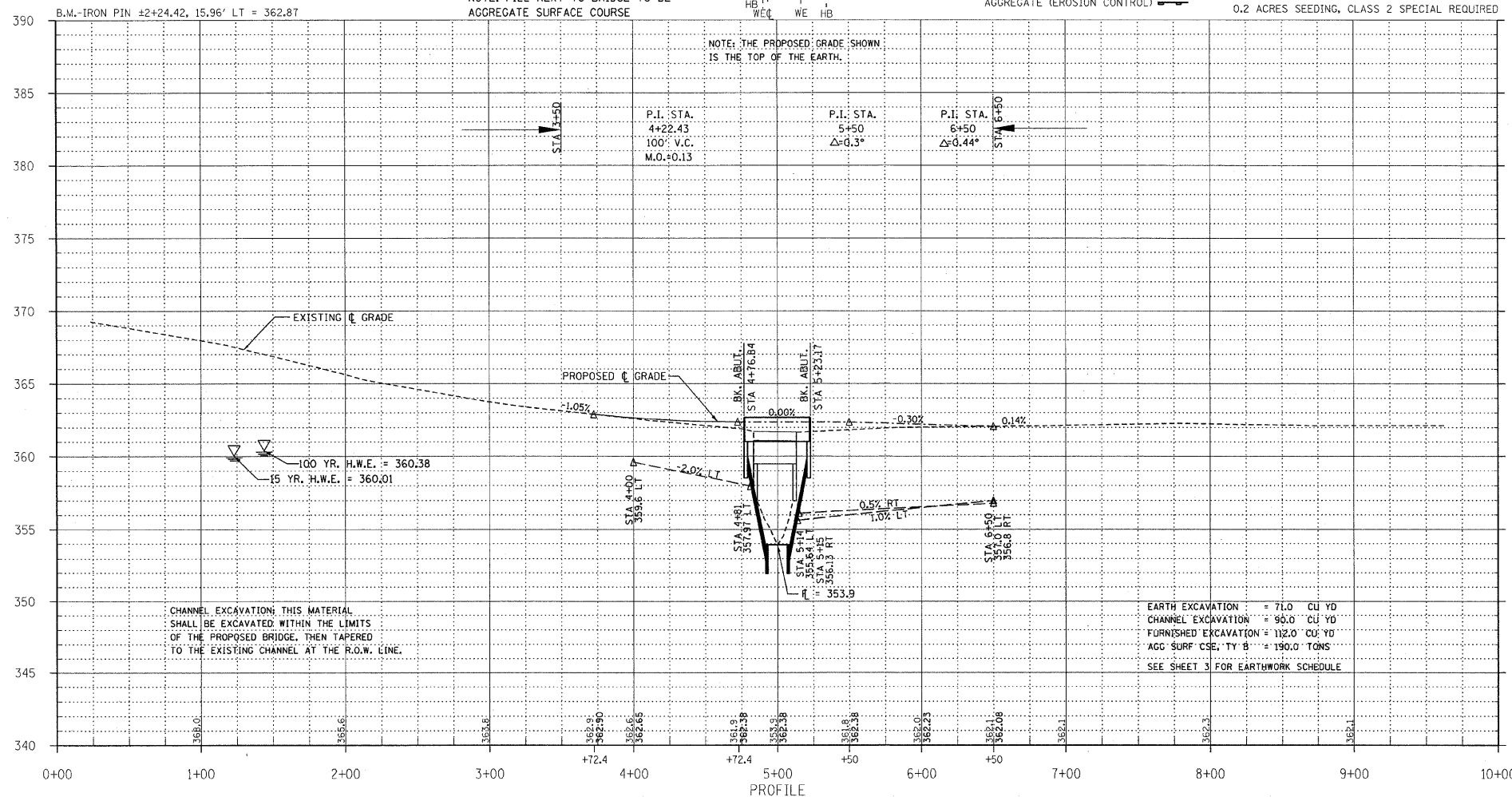

CHANNEL EXCAVATION; THIS MATERIAL SHALL BE EXCAVATED WITHIN THE LIMITS OF THE PROPOSED BRIDGE, THEN TAPERED TO THE EXISTING CHANNEL AT THE R.O.W. LINE.

EARTH EXCAVATION = 71.0 CU YD
CHANNEL EXCAVATION = 90.0 CU YD
FURNISHED EXCAVATION = 112.0 CU YD
AGG SURF CSE, TY B = 190.0 TONS
SEE SHEET 3 FOR EARTHWORK SCHEDULE

PROPOSED STRUCTURE: NO. 097-3265, STA 5+00, A 45' LONG SINGLE SPAN P.P.C.D.B. BRIDGE WITH 17" DEPTH BEAMS, SPILL THROUGH TYPE ABUTMENTS, 24" WIDTH, 0° SKEW.

SEE SHEETS 4-12 FOR THE DESIGN AND BILL OF MATERIALS.

12.0 UNITS-TREE REMOVAL (6 TO 15 UNITS DIAMETER)
12.0 FOOT TEMPORARY DITCH CHECKS
18.0 TON AGGREGATE (EROSION CONTROL)
0.2 ACRES SEEDING, CLASS 2 SPECIAL REQUIRED

TR	SECTION	COUNTY	TOTAL SHEETS	SHEET NO.
269	07-03119-00-BR	WHITE	12	2

323 W. 3RD ST.
P.O. BOX 160
MT. CARMEL, IL 62863
PHONE: (618)-262-8661
FAX: (618)-263-3327

405 W. STATE ST.
SUITE 1
PRINCETON, IN 47670
PHONE: (812)-386-7611
FAX: (812)-385-2812

PROFESSIONAL DESIGN FIRM
LAND SURVEY & PROFESSIONAL ENGINEERING CORPORATION
184-000887
(62-032435)(35-002769)

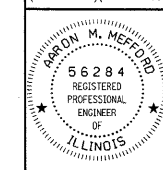

AARON M. MEFFORD
NAME
SIGNATURE
DATE: 2-4-10
11-30-11 EXPIRES

TOWNSHIP ROUTE 269
OVER WABASH LEVEE DITCH
WHITE COUNTY, ILLINOIS

SHEET TITLE:	
PLAN & PROFILE	
SCALE:	VARIES
BY:	AMM
DATE:	12/9/09
REV:	
2	OF 12 SHEETS
SHEET NO. 2	