

DATE	
BY	
PLAN	
NO.	
NO.	
NO.	

DATE	
BY	
PROFILE	
NO.	
NO.	
NO.	

MODEL: Default
 FILE NAME: p:\workroom\dm\illinois.gov\p\10101\Documents\DOT - Offices\District 4\Projects\214_gBE\3D\CAD\Drawings\CrossOver\3D\CrossOver-3D\CrossOver-3D.dwg

LEGEND

- MILL AND OVERLAY
- HMA CROSSOVERS
- GRADING AND SHAPING DITCHES

CURVE INFORMATION

PROP. CURVE XOVER1_1	PROP. CURVE XOVER1_4
PI STA. = 1+04.83	PI STA. = 4+00.94
Δ = 11° 25' 26" (LT)	Δ = 11° 18' 36" (RT)
D = 5° 28' 02"	D = 5° 28' 02"
R = 1,048.00'	R = 1,048.00'
T = 104.83'	T = 103.77'
L = 208.96'	L = 206.87'
E = 5.23'	E = 5.13'
e =	e =
T.R. =	T.R. =
S.E. RUN =	S.E. RUN =
P.C. STA. = 0+00.00	P.C. STA. = 2+97.17
P.T. STA. = 2+08.96	P.T. STA. = 5+04.04

WB RT. STA. 171+50.0 TO STA 177+26.1
 HMA SURF. REM. 1 3/4" = 460.9 SQ. YD.
 HMA SHOULDERS = 72.3 TONS

WB LT. STA. 170+25.0 TO STA. 177+32.2
 HMA SURF. REM. 1 3/4" = 785.8 SQ. YD.
 HMA SHOULDERS = 77.0 TONS

SEE TRAFFIC CONTROL SHEETS FOR QUANTITIES

Temp. Traffic Barrier Terminal Type 1 shall be a Type 1 Special Tangent

WB RT. STA. 175+36.5 TO STA 177+24.0
 (LENGTH OF NEED = STA. 175+54)
 TEMP. TRAFFIC BARRIER TERMINAL TYPE 1 = 1.0 EACH
 TEMP. STEEL PLATE BEAM GUARDRAIL, TY A = 100.0 FT.
 TEMP. TRAFFIC BARRIER TERMINAL, TYPE 6A = 1.0 EACH
 GUARDRAIL AGG. EROSION CONTROL = 30.0 TONS

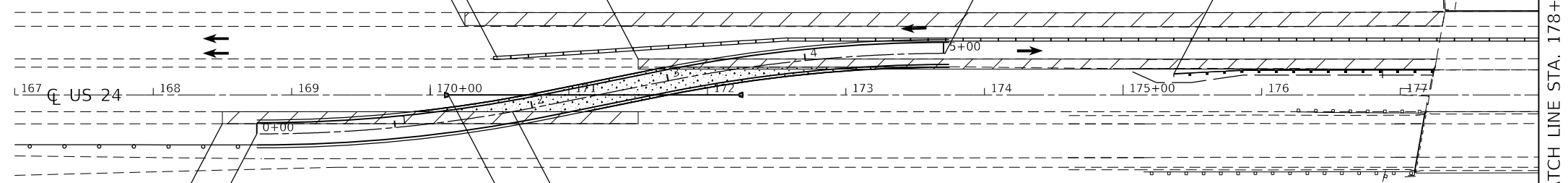

EB LT. STA. 168+50.0 TO STA 171+50.0
 HMA SURF. REM. 1 3/4" = 290.0 SQ. YD.
 HMA SHOULDERS = 42.2 TONS

CROSSOVER 1 ALIGNMENT BEGINS
 US 24 STA. 168+74.8, 28'RT = XOVER 1 @ STA. 0+00

PROPOSED CROSSOVER (US 25 STA. 169+88 TO 173+74)
 SUBBASE GRANULAR MATERIAL, TYPE A 4" = 409.0 SQ. YD.
 TEMPORARY PAVEMENT = 409.0 SQ. YD.

STA. 170+13.0 TO STA 172+23.0
 PIPE CULVERT (TEMPORARY) 15" = 210.0 FT.
 END SECTIONS = 2.0 EACH
 PIPE CULVERT REMOVAL = 210.0 FT.
 USFL = 469.99, DSFL = 468.56

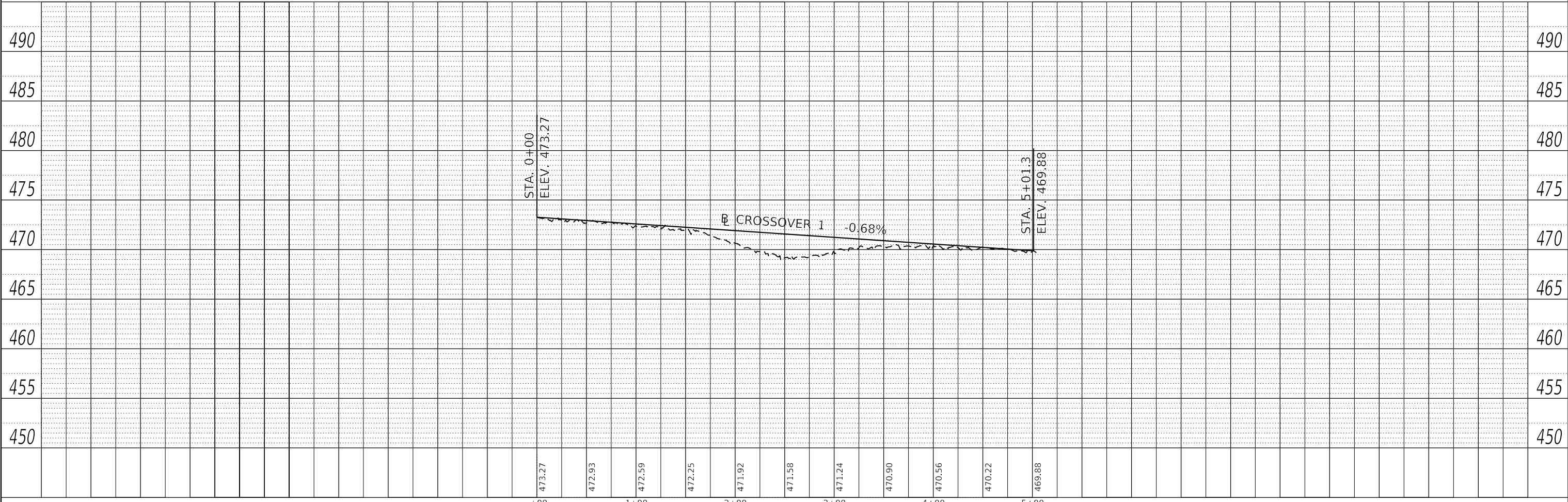

USER NAME = sUSERS	DESIGNED -	REVISED -
PLOT SCALE = 1:100	DRAWN -	REVISED -
PLOT DATE = 3/18/2021	CHECKED -	REVISED -
	DATE -	REVISED -

**STATE OF ILLINOIS
 DEPARTMENT OF TRANSPORTATION**

**CROSSOVER 1
 PLAN & PROFILE**

SCALE: SHEET 2 OF 3 SHEETS STA. TO STA.

F.A.P. RTE.	SECTION	COUNTY	TOTAL SHEETS	SHEET NO.
317	45(RB)BR	PEORIA	86	23
CONTRACT NO. 68E48			ILLINOIS FED. AID PROJECT	