

STATE OF ILLINOIS  
DEPARTMENT OF TRANSPORTATION

F.A.I. RTE.	SECTION	COUNTY	TOTAL SHEETS	SHEET NO.
74	D5 HM LIGHTING	MCLEAN	8	1
		ILLINOIS	CONTRACT NO. 70F03	

FOR INDEX OF SHEETS, SEE SHEET NO. 2  
FOR SUMMARY OF QUANTITIES SHEETS, SEE SHEET NO. 3-4

# PROPOSED HIGHWAY PLANS

FAI Route 74 (I-74)  
SECTION D5 HM LIGHTING  
PROJECT  
INTERCHANGE LIGHTING IMPROVEMENTS  
MCLEAN COUNTY

C-95-105-20

D-95-035-20

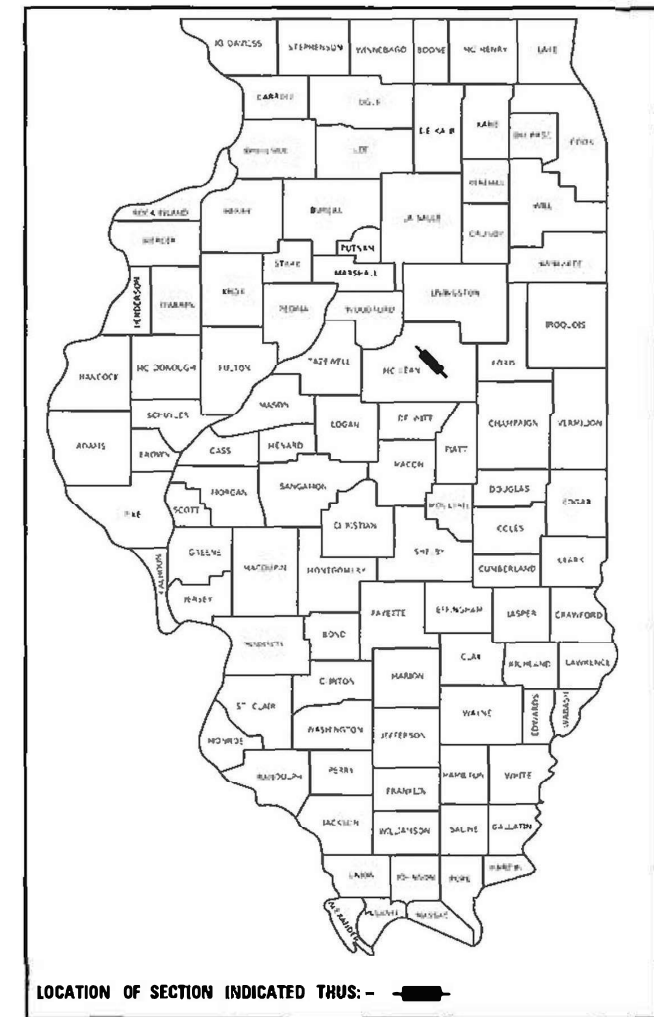

I-74 AT FAS 1478 (CHESTNUT ST.)

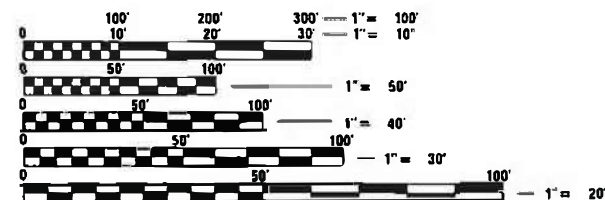
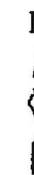
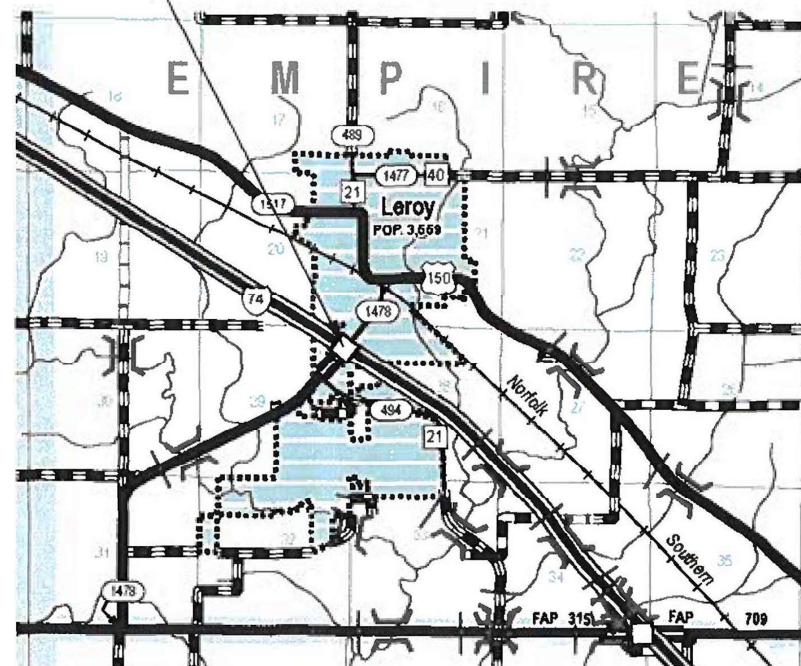

FULL SIZE PLANS HAVE BEEN PREPARED USING STANDARD ENGINEERING SCALES. REDUCED SIZED PLANS WILL NOT CONFORM TO STANDARD SCALES. IN MAKING MEASUREMENTS ON REDUCED PLANS, THE ABOVE SCALES MAY BE USED.

J.U.L.I.E.  
JOINT UTILITY LOCATION INFORMATION FOR EXCAVATORS  
1-800-892-0123  
OR 811

PROJECT ENGINEER: JEFF ALLEN  
TELEPHONE: (217)465-4181

CONTRACT NO. 70F03



STATE OF ILLINOIS  
DEPARTMENT OF TRANSPORTATION

SUBMITTED January 29, 2021

[Signature]  
REGIONAL ENGINEER

May 7, 2021  
[Signature]  
ENGINEER OF DESIGN AND ENVIRONMENT

May 7, 2021  
[Signature]  
DIRECTOR OF HIGHWAYS PROJECT IMPLEMENTATION

PRINTED BY THE AUTHORITY  
OF THE STATE OF ILLINOIS

## GENERAL NOTES

- G.N.-100 ENGLISH UNITS OF MEASUREMENT SHALL GOVERN OVER AND SUPERSEDE ANY METRIC UNITS SHOWN IN THIS CONTRACT. WHERE INCLUDED, METRIC UNITS ARE FOR INFORMATION ONLY.
- G.N.-100A ELECTRONIC FILES AND/OR ELECTRONIC SURVEY INFORMATION INCLUDING CADD FILES WILL NOT BE AVAILABLE TO THE CONTRACTOR.
- G.N.-105.07C EXISTING STATE-OWNED AND MAINTAINED UNDERGROUND UTILITY FACILITIES EXIST WITHIN THE ROW. THE DEPARTMENT IS NOT A MEMBER OF JULIE AND DOES NOT LOCATE IT'S OWN FACILITIES. THE CONTRACTOR SHALL BE RESPONSIBLE AT THEIR OWN EXPENSE FOR SECURING AN APPROVED LOCATING FIRM TO LOCATE ALL EXISTING IDOT UNDERGROUND FACILITIES PRIOR TO COMMENCING ANY EXCAVATION, PER THE REQUIREMENTS OF ARTICLE 803 OF THE STANDARD SPECIFICATIONS. UTILITY LOCATES MAY ALSO BE REQUIRED OUTSIDE THE PROJECT LIMITS, SUCH AS FOR TRAFFIC CONTROL SIGNING AND OTHER ITEMS. THE CONTRACTOR MAY OBTAIN, ON REQUEST, PLANS OF EXISTING ELECTRICAL FACILITIES FROM THE DEPARTMENT. FOR FURTHER INFORMATION, THE CONTRACTOR MAY CONTACT THE DISTRICT TRAFFIC OPERATIONS ENGINEER, GARY SIMS, AT 217-251-4859.
- THE CONTRACTOR SHALL ALSO BE RESPONSIBLE FOR LOCATION AND PROVIDING PROTECTION FOR FACILITIES DURING ALL PHASES OF CONSTRUCTION. IF, AT ANY TIME, THE FACILITIES ARE DAMAGED, THE CONTRACTOR SHALL IMMEDIATELY NOTIFY THE DEPARTMENT AND MAKE ALL NECESSARY ARRANGEMENTS FOR REPAIR TO THE SATISFACTION OF THE ENGINEER. THIS WORK SHALL BE INCLUDED IN THE CONTRACT BID PRICE AND NO ADDITIONAL COMPENSATION WILL BE ALLOWED.
- G.N.-202 SPL GRADING SHALL BE DONE BY HAND AROUND LIGHT TOWERS & POLES OR OTHER OBJECTS WHERE SHALLOW FILLS OR CUTS ARE ADJACENT TO THE ITEMS. IT IS THE INTENT TO PRESERVE THE AREA IN THE ORIGINAL STATE AS MUCH AS POSSIBLE. THE DECISION AS TO WHAT ITEMS TO REMAIN IN PLACE SHALL BE AS DIRECTED BY THE ENGINEER.
- THIS WORK WILL NOT BE PAID FOR SEPARATELY, BUT SHALL BE CONSIDERED INCLUDED IN THE CONTRACT UNIT PRICE EACH FOR LIGHT POLE, UNIT DUCT OR REMOVAL ITEMS AND NO ADDITIONAL COMPENSATION WILL BE ALLOWED.

## INDEX OF SHEETS

SHEET NO.	DESCRIPTION
1.	COVER SHEET
2.	GENERAL NOTES, INDEX OF SHEETS AND LIST OF STANDARDS
3. - 4.	SUMMARY OF QUANTITIES
5.	LIGHTING REMOVAL PLAN
6.	PROPOSED LIGHTING PLAN I-74 & FAS 1478 (CHESTNUT ST.)
7.	WIRING DIAGRAMS FOR CONTROLLER 141
7.	LIGHTING GENERAL NOTES AND LEGEND
8.	NIGHT TIME INSPECTION OF LIGHTING

## LIST OF STANDARDS

STANDARD NO.	NAME OF STANDARD
701101-05	OFF-ROAD OPERATIONS, MULTILANE, 15' (4.5 M) TO 24" (600 mm) FROM PAVEMENT EDGE
701106-02	OFF-ROAD OPERATIONS, MULTILANE, MORE THAN 15' (4.5 M) AWAY
701400-10	APPROACH TO LANE CLOSURE, FREEWAY/EXPRESSWAY
701406-12	LANE CLOSURE, FREEWAY/EXPRESSWAY, DAY OPERATIONS ONLY
701456-05	PARTIAL EXIT RAMP CLOSURE, FREEWAY/EXPRESSWAY
701901-08	TRAFFIC CONTROL DEVICES
821101-02	LUMINAIRE WIRING IN POLE
825011-04	LIGHTING CONTROLLER PEDASTAL MOUNTED, 240V
830021-03	LIGHT POLE STEEL TENON TOP
836001-04	LIGHT POLE FOUNDATION
838001-01	BREAKAWAY DEVICES
000001-08	STANDARD SYMBOLS, ABBREVIATIONS AND PATTERNS
001006	DECIMAL OF AN INCH AND OF A FOOT

**STATE OF ILLINOIS  
DEPARTMENT OF TRANSPORTATION**

**GENERAL NOTES, LIST OF STANDARDS  
& INDEX OF SHEETS**

SCALE: NONE SHEET 1 OF 1 SHEETS STA. TO STA.

F.A.I. RTE.	SECTION	COUNTY	TOTAL SHEETS	SHEET NO.
74	D5 HM Lighting	MCLEAN	8	2
			CONTRACT NO. 70F03	
ILLINOIS FED. AID PROJECT				

USER NAME = plersonbr	DESIGNED -	REVISED -
	DRAWN -	REVISED -
PLOT SCALE = 40,0000 * / in.	CHECKED -	REVISED -
PLOT DATE = 9/24/2020	DATE -	REVISED -

## SUMMARY OF QUANTITIES

LOCATION            FAI 74  
                           RURAL  
                           LIGHTING  
                           MCLEAN COUNTY  
                           FUNDING        100% STATE

CONSTRUCTION        0021  
                           CODE

CODE NO.	ITEM	UNIT	TOTAL QUANTITY
67100100	MOBILIZATION	L SUM	1.0
70100700	TRAFFIC CONTROL AND PROTECTION, STANDARD 701406	L SUM	1.0
70100825	TRAFFIC CONTROL AND PROTECTION, STANDARD 701456	L SUM	1.0
80400100	ELECTRIC SERVICE INSTALLATION	EACH	1.0
81028750	UNDERGROUND CONDUIT, COILABLE NONMETALLIC CONDUIT, 2" DIA.	FOOT	510.0
81603020	UNIT DUCT, 600V, 3-1C NO.10, 1/C NO.10 GROUND, (XLP-TYPE USE), 3/4" DIA. POLYETHELENE	FOOT	5,750.0
82110008	LUMINAIRE, LED, ROADWAY, OUTPUT DESIGNATION H	EACH	12.0
82500330	LIGHTING CONTROLLER, PEDESTAL MOUNTED, 240VOLT, 60AMP	EACH	1.0
83060830	LIGHT POLE, GALVANIZED STEEL, 45 FT. M.H., TENON MOUNT	EACH	12.0
83600350	LIGHT POLE FOUNDATION, METAL, 11" BOLT CIRCLE, 8" X 6'	EACH	12.0

MODEL: \\MODEL\MAME  
 FILE NAME: \\p14m\com\m.dct\illinc\gov\PIWDOT\Documents\IDOT\_Offices\District 5\Projects\0570\03\CADD\B1\CAD\Faces\0570\03-ph-500.dgn

USER NAME = plersonbr	DESIGNED -	REVISED -
	DRAWN -	REVISED -
PLOT SCALE = 40,0000 * / in.	CHECKED -	REVISED -
PLOT DATE = 9/24/2020	DATE -	REVISED -

**STATE OF ILLINOIS  
 DEPARTMENT OF TRANSPORTATION**

**SUMMARY OF QUANTITIES**

SCALE: NONE      SHEET 1 OF 2 SHEETS      STA.      TO STA.

F.A.I. RTE.	SECTION	COUNTY	TOTAL SHEETS	SHEET NO.
74	D5 HM Lighting	MCLEAN	8	3
CONTRACT NO. 70F03				
ILLINOIS FED. AID PROJECT				

## SUMMARY OF QUANTITIES

LOCATION            FAI 74  
                               RURAL  
                               LIGHTING  
                               MCLEAN COUNTY  
                               FUNDING            100% STATE

CONSTRUCTION        0021  
                               CODE

CODE NO.	ITEM	UNIT	TOTAL QUANTITY
83800650	BREAKAWAY DEVICE, COUPLING WITH STAINLESS STEEL SCREEN	EACH	48.0
84500110	REMOVAL OF LIGHTING CONTROLLER	EACH	1.0
84500120	REMOVAL OF ELECTRIC SERVICE INSTALLATION	EACH	1.0
84500130	REMOVAL OF LIGHTING CONTROLLER FOUNDATION	EACH	1.0
89502300	REMOVE ELECTRIC CABLE FROM CONDUIT	FOOT	7060.0
X0323710	REMOVE CONDUIT ATTACHED TO STRUCTURE	FOOT	225.0
X1400273	REMOVAL OF EXISTING TOWER LUMINAIRE, NO SALVAGE	EACH	16.0
X8420502	REMOVAL OF LIGHT TOWER, NO SALVAGE	EACH	4.0
X8420510	REMOVAL OF TOWER FOUNDATION	EACH	4.0

MODEL: \\MODEL\MRFE  
 FILE NAME: \\p1416mcom\m.dwt\Illinois.gov\PIWIDOT\Documents\DOT\_Offices\District 5\Projects\0570\03\CADD\03\CAD\Faces\0570\03-PL-S00.dgn

USER NAME = plersonbr	DESIGNED -	REVISED -
	DRAWN -	REVISED -
PLOT SCALE = 40,0000 * / in.	CHECKED -	REVISED -
PLOT DATE = 9/24/2020	DATE -	REVISED -

**STATE OF ILLINOIS  
 DEPARTMENT OF TRANSPORTATION**





**SUMMARY OF QUANTITIES**

SCALE: NONE    SHEET 2    OF 2    SHEETS    STA.            TO STA.

F.A.I. RTE.	SECTION	COUNTY	TOTAL SHEETS	SHEET NO.
74	D5 HM Lighting	MCLEAN	8	4
CONTRACT NO. 70F03				
ILLINOIS FED. AID PROJECT				

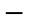

**LEGEND**

-  LIGHT POLE STEEL 45' M.H., 240V HORIZONTAL TENON MOUNT LED H LUMINAIRE, TYPE III, WITH 15" B.C. WITH BREAKAWAY COUPLINGS WITH S.S. SCREEN ON 8" X 8" METAL FOUNDATION
-  LIGHTING CONTROLLER, PEDESTAL MOUNTED, 240 VOLT, 60 AMP
-  UNIT DUCT, SIZE AS INDICATED ON PLANS
-  UNDERGROUND CONDUIT, COILABLE NONMETALLIC CONDUIT, 2" DIA., SCHEDULE 80 (LENGTH AND CIRCUIT NOTED ON PLANS)

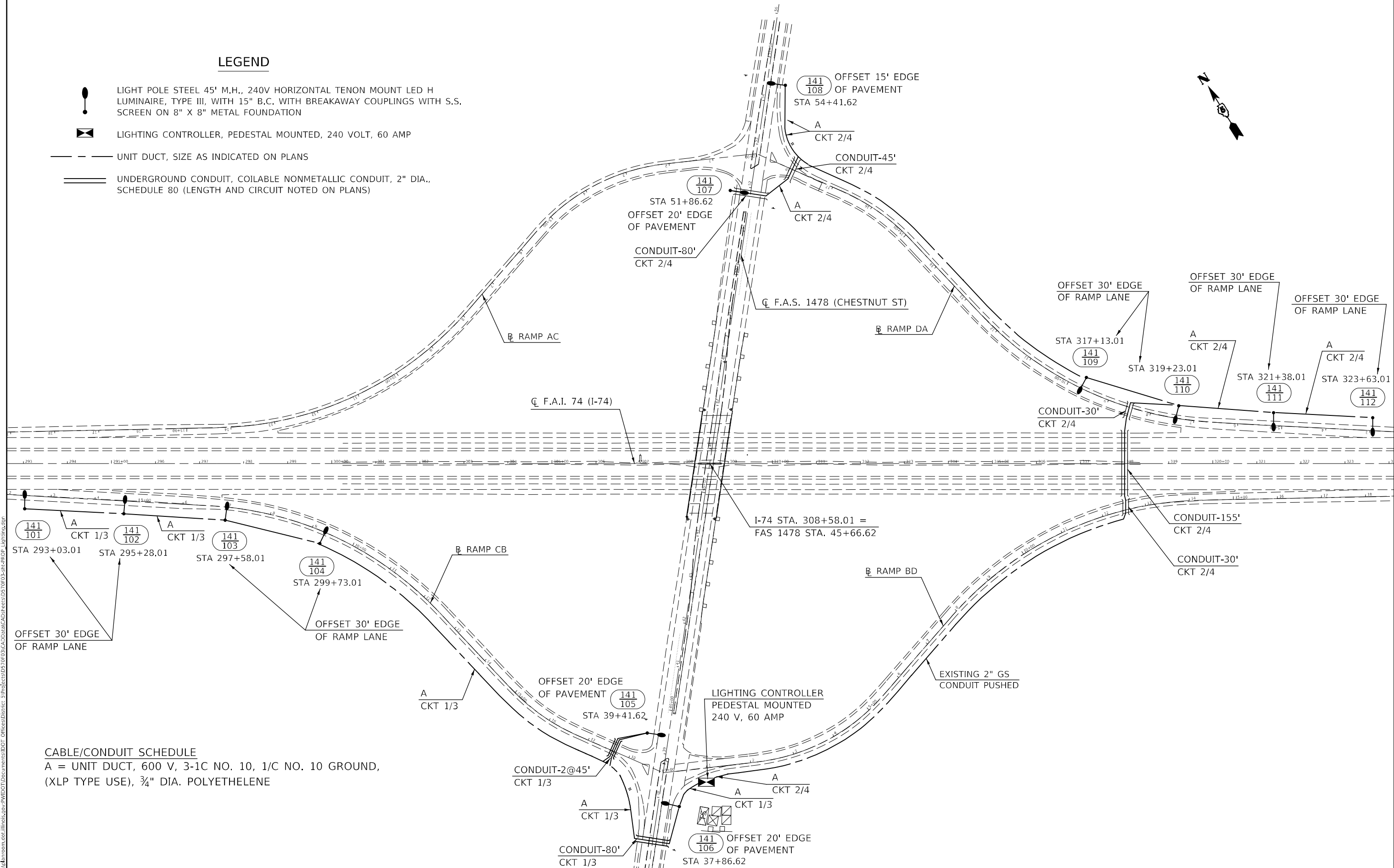

MODEL: \\MODEL\NAME  
 FILE NAME: \\P\PROJECTS\70F03\I-74\DOT\Documents\DOT - Office\Drawings\70F03-PL-PROP Lighting.dwg  
 PROJECT: I-74 & FAS 1478 (CHESTNUT STREET) LIGHTING PLAN

USER NAME = plersonbr	DESIGNED -	REVISED -
	DRAWN -	REVISED -
PLOT SCALE = 200,0000' / in.	CHECKED -	REVISED -
PLOT DATE = 9/24/2020	DATE -	REVISED -

**STATE OF ILLINOIS  
 DEPARTMENT OF TRANSPORTATION**

**I-74 & FAS 1478 (CHESTNUT STREET)  
 PROPOSED LIGHTING PLAN**

SCALE: 1" = 100' SHEET 1 OF 1 SHEETS STA. 293+00.00 TO STA. 324+00.00

F.A.I. RTE.	SECTION	COUNTY	TOTAL SHEETS	SHEET NO.
74	D5 HM LIGHTING	MCLEAN	8	6
CONTRACT NO. 70F03				
ILLINOIS FED. AID PROJECT				

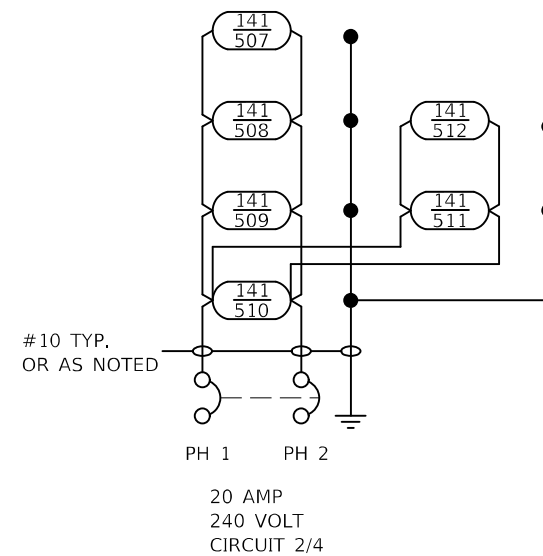
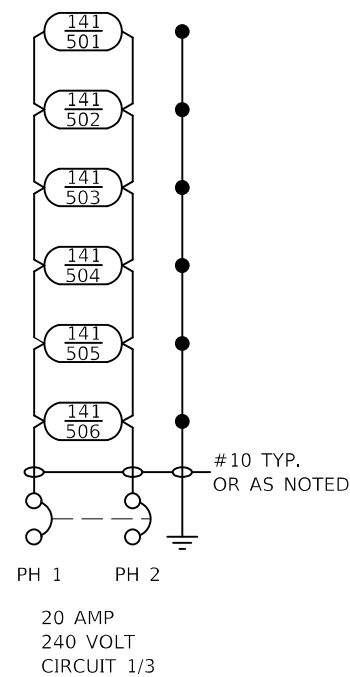

**LIGHTING CONTROLLER 141 AT I-74**

**141**  
**501** PROPOSED LUMINAIRE, LED, ROADWAY, OUTPUT DESIGNATION H,  
NUMBER INSIDE POLYGON INDICATES CIRCUIT NUMBER OVER POLE NUMBER

**GENERAL LIGHTING NOTES**

1. ALL NECESSARY REVISIONS TO THE WIRING SHOWN ON THIS SHEET SHALL BE MADE AT NO ADDITIONAL COST TO THE DEPARTMENT AND SHALL BE MADE TO THE SATISFACTION OF THE ENGINEER.
2. BREAKAWAY DEVICES SHALL NOT BE USED FOR POLES LOCATED BEHIND GUARDRAILS OR IN AREAS OF HIGH PEDESTRIAN ACTIVITY.
3. NEW FIXTURES SHALL BECOME COMPLETELY OPERATIONAL THE SAME DAY AS EXISTING TOWERS ARE REMOVED WITHOUT INTERRUPTION TO INTERCHANGE LIGHTING.

**LEGEND**

- HIGH MAST LIGHT TOWER, LUMINAIRE AND FOUNDATION TO BE REMOVED
- LIGHTING CONTROLLER TO BE REMOVED
- CABLE TO BE REMOVED
- LIGHT POLE STEEL 45' M.H., 240V HORIZONTAL TENON MOUNT LED H LUMINAIRE, TYPE III, WITH 11" B.C. WITH BREAKAWAY COUPLINGS WITH S.S. SCREEN ON 8" X 6" METAL FOUNDATION
- LIGHTING CONTROLLER, PEDESTAL MOUNTED, 240 VOLT, 60 AMP
- UNIT DUCT, SIZE AS INDICATED ON PLANS
- UNDERGROUND CONDUIT, COILABLE NONMETALLIC CONDUIT, 2" DIA., SCHEDULE 80

MODEL: \\MODEL\NAME  
 FILE NAME: \\p141\m1000\m1000\dot\Documents\IBDOT\Office\Bartlett\3\Projects\057003\CADD\Bartlett\CAD\Process\057003-ph-Leroy.dwg

USER NAME = plersonbr	DESIGNED -	REVISED -
	DRAWN -	REVISED -
PLOT SCALE = 40,0000 * / in.	CHECKED -	REVISED -
PLOT DATE = 9/24/2020	DATE -	REVISED -

**STATE OF ILLINOIS  
DEPARTMENT OF TRANSPORTATION**

**WIRING DIAGRAM  
CONTROLLER 141 - LEROY**

SCALE: SHEET OF SHEETS STA. TO STA.

F.A.I. RTE.	SECTION	COUNTY	TOTAL SHEETS	SHEET NO.
74	D5 HM LIGHTING	MCLEAN	8	7
			CONTRACT NO. 70F03	
		ILLINOIS	FED. AID PROJECT	

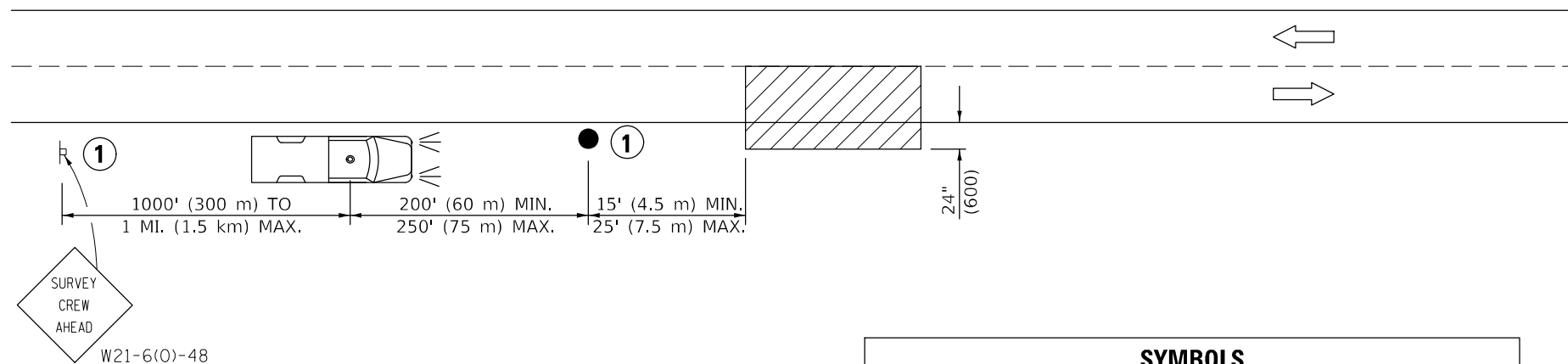

**TYPICAL APPLICATIONS**  
UTILITY OPERATIONS

SYMBOLS	
	WORK AREA
	SIGN ON PORTABLE OR PERMANENT SUPPORT
	TRUCK WITH FLASHING AMBER LIGHT AND DUAL EMERGENCY FLASHERS
	FLAGGER WITH TRAFFIC CONTROL SIGN

**1** NOT REQUIRED FOR WORK ACTIVITIES IN OR WITHIN 2' OF TRAVELED LANE IN ONE LOCATION FOR LESS THAN 15 MINUTES (BRIEF ENCROACHMENT).

Note: All dimensions are in INCHES (millimeters) unless otherwise shown.

MODEL: I:\MODEL\NAMES  
FILE NAME: P:\pub\mcom\m.dwt\illinc\gov\PIWDOT\Documents\IDOT\_Offices\District 5\Projects\0570103\CADD\03\03\03-RT-Details.dgn

USER NAME = plersonbr	DESIGNED -	REVISED -
	DRAWN -	REVISED -
PLOT SCALE = 40,0000 * / in.	CHECKED -	REVISED -
PLOT DATE = 9/24/2020	DATE -	REVISED -

**STATE OF ILLINOIS  
DEPARTMENT OF TRANSPORTATION**

**NIGHT TIME INSPECTION OF  
ROADWAY LIGHTING**

SCALE: SHEET OF SHEETS STA. TO STA.

DISTRICT 5 DETAIL NO. 70100000				
F.A.I. RTE.	SECTION	COUNTY	TOTAL SHEETS	SHEET NO.
74	D5 HM LIGHTING	MCLEAN	8	8
			CONTRACT NO. 70F03	
ILLINOIS FED. AID PROJECT				