

STATE OF ILLINOIS
DEPARTMENT OF TRANSPORTATION

F.A.U. RTE.	SECTION	COUNTY	TOTAL SHEETS	SHEET NO.
1581	2020 131-1	COOK	20	1
		ILLINOIS	CONTRACT NO. 62M09	

FOR INDEX OF SHEETS, SEE SHEET NO. 2

THIS IMPROVEMENT IS LOCATED IN VILLAGE OF OAK LAWN AND CITY OF CHICAGO

PROPOSED
HIGHWAY PLANS

FAU ROUTE 1581: 111th STREET
CENTRAL AVE TO PULASKI RD
PROJECT: STP-KMFC-(286)
SECTION: 2020-131-1
CRACK AND JOINT SEALING
COOK COUNTY

C-91-329-20

TRAFFIC DATA:

111th STREET

2014 ADT = 24,500

SPEED LIMIT = 40 MPH

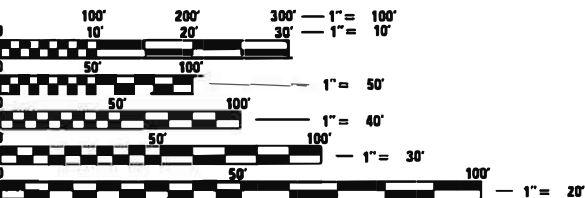

FULL SIZE PLANS HAVE BEEN PREPARED USING STANDARD ENGINEERING SCALES. REDUCED SIZED PLANS WILL NOT CONFORM TO STANDARD SCALES. IN MAKING MEASUREMENTS ON REDUCED PLANS, THE ABOVE SCALES MAY BE USED.

C.U.A.N.
CHICAGO UTILITY ALERT NETWORK
312-744-7000
J.U.L.I.E.
JOINT UTILITY LOCATION INFORMATION FOR EXCAVATORS
1-800-892-0123
OR 811

PROJECT ENGINEER VESELIN VELICHKOV (847)705-4432
PROJECT MANAGER FAWAD AQUEEL (847)705-4247

CONTRACT NO. 62M09

IMPROV. BEGINS
STA. 14 + 04.6

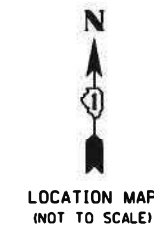
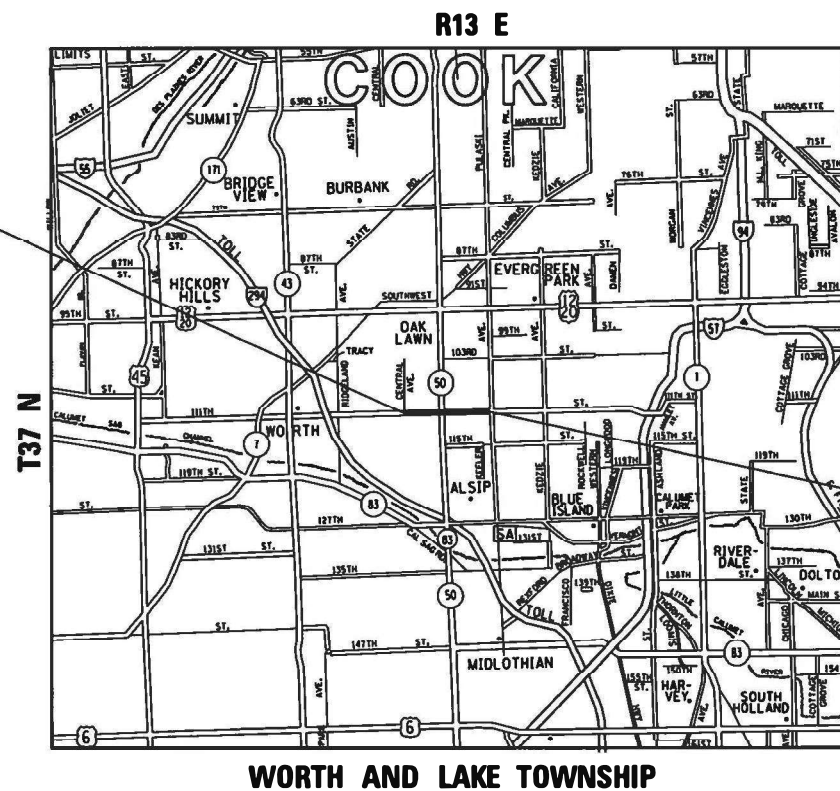

IMPROV. ENDS
STA. 118 + 74.3

GROSS AND NET LENGTH = 10,470 FT = 1.983 MILES

D-91-531-20

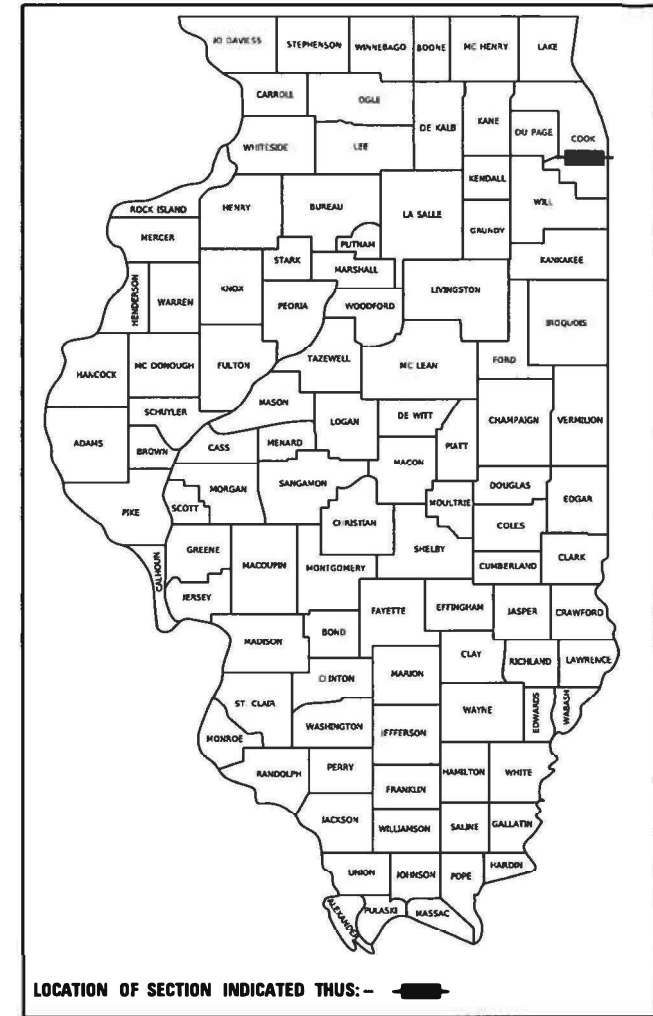

LOCATION OF SECTION INDICATED THIS: - [black rectangle]

STATE OF ILLINOIS
DEPARTMENT OF TRANSPORTATION

SUBMITTED March 9 2021
Jose Pina REGIONAL ENGINEER

May 7, 2021 [Signature]
ENGINEER OF DESIGN AND ENVIRONMENT

May 7, 2021 [Signature]
DIRECTOR OF HIGHWAYS PROJECT IMPLEMENTATION

PRINTED BY THE AUTHORITY
OF THE STATE OF ILLINOIS

GENERAL NOTES

INDEX OF SHEETS

<u>SHEET NO.</u>	<u>DESCRIPTION</u>
1	COVER SHEET
2	INDEX OF SHEETS, STATE STANDARDS AND GENERAL NOTES
3	SUMMARY OF QUANTITIES
4-7	PROPOSED ROADWAY AND PAVEMENT MARKING PLANS
8-12	DETECTOR LOOP REPLACEMENT PLANS
13	CRACK AND JOINT SEALING DETAIL (PD-11)
14	TRAFFIC CONTROL AND PROTECTION FOR SIDE ROADS, INTERSECTIONS, AND DRIVEWAYS (TC-10)
15	DISTRICT ONE TYPICAL PAVEMENT MARKINGS (TC-13)
16	TRAFFIC CONTROL AND PROTECTION AT TURN BAYS (TO REMAIN OPEN TO TRAFFIC) (TC-14)
17	ARTERIAL ROAD INFORMATION SIGNING (TC-22)
18-20	CITY OF CHICAGO TYPICAL PAVEMENT MARKINGS (TC-24)

STATE STANDARDS

000001-08	STANDARD SYMBOLS, ABBREVIATIONS AND PATTERNS
701101-05	OFF-ROAD OPERATIONS, MULTILANE, 15' TO 24" FROM PAVEMENT EDGE
701427-05	LANE CLOSURE, MULTILANE, INTERMITTENT OR MOVING OPERATION, FOR SPEEDS ≤ 40 MPH
701601-09	MULTILANE, 1W OR 2W WITH NONTRAVERSABLE MEDIAN
701602-10	URBAN LANE CLOSURE, MULTILANE, 2W WITH BIDIRECTIONAL LEFT TURN LANE
701606-10	URBAN SINGLE LANE CLOSUR, MULTILANE, 2W WITH MOUNTABLE MEDIAN
701701-10	URBAN LANE CLOSURE, MULTILANE INTERSECTION
701801-06	SIDEWALK, CORNER OR CROSSWALK CLOSURE
701901-08	TRAFFIC CONTROL DEVICES

- BEFORE STARTING ANY EXCAVATION, THE CONTRACTOR SHALL CALL "J.U.L.I.E". AT (800) 892-0123 OR 811 FOR FIELD LOCATIONS OF BURIED ELECTRIC, TELEPHONE AND GAS UTILITIES. 48 HOUR NOTIFICATION IS REQUIRED.
- THE CONTRACTOR SHALL COORDINATE CONSTRUCTION ACTIVITIES WITH UTILITY COMPANIES OF THE VILLAGES OF OAK LAWN AND CITY OF CHICAGO.
- ALL DAMAGE TO EXISTING PAVEMENT MARKINGS OR RAISED REFLECTIVE PAVEMENT MARKERS OUTSIDE THE REMOVAL LINE SHOWN ON THE PLANS SHALL BE REPLACED AT NO ADDITIONAL COST TO THE DEPARTMENT.
- THE CONTRACTOR WILL NOT BE ALLOWED TO SET UP A YARD OR FIELD OFFICE ON STATE PROPERTY WITHOUT WRITTEN PERMISSION FROM THE DEPARTMENT.
- IT SHALL BE THE CONTRACTOR'S RESPONSIBILITY TO VERIFY ALL DIMENSIONS AND CONDITIONS EXISTING IN THE FIELD PRIOR TO CONSTRUCTION AND ORDERING OF MATERIALS.
- THE CONTRACTOR SHALL CONTACT THE DISTRICT ONE TRAFFIC CONTROL SUPERVISOR AT KALPANA.KANNAN-HOSADURGA@ILLINOIS.GOV A MINIMUM OF 72 HOURS IN ADVANCE OF BEGINNING WORK.
- THE ENGINEER SHALL CONTACT ERIC CAMPOS AREA TRAFFIC FIELD ENGINEER AT ERIC.CAMPOS@ILLINOIS.GOV A MINIMUM OF TWO (2) WEEKS PRIOR TO THE PLACEMENT OF PERMANENT PAVEMENT MARKINGS.
- ALL CRACK ROUTING & CRACK SEALING LOCATIONS WILL BE DETERMINED IN THE FIELD BY THE ENGINEER. CRACK ROUTING SHALL BE OMITTED WHERE VEHICLE DETECTOR LOOPS & RAISED REFLECTIVE PAVEMENT MARKERS ARE PRESENT IN THE PAVEMENT.
- MATERIALS RESULTING FROM THE ROUTING OF CRACKS IN THE EXISTING PAVEMENT MAY BE PLACED, SHAPED AND COMPACTED TO THE SATISFACTION OF THE ENGINEER ALONG EXISTING AGGREGATE SHOULDERS ADJACENT TO THE PAVEMENT. ALL MATERIALS RESULTING FROM THE ROUTING OF CRACKS IN PAVEMENTS WITHOUT AGGREGATE SHOULDERS AND SURPLUS MATERIALS RESULTING FROM THE ROUTING OF CRACKS IN PAVEMENTS WITH AGGREGATE SHOULDERS, WHERE ALL MATERIALS ARE NOT PLACED ALONG EXISTING AGGREGATE SHOULDERS, SHALL BE DISPOSED OF AS SPECIFIED IN ARTICLE 202.03 OF THE STANDARD SPECIFICATIONS.
- MODIFIED URETHANE PAVEMENT MARKING SHALL BE PLACED IMMEDIATELY AFTER C & J SEALER TEMPERATURE HAS COOLED DOWN AND DOES NOT AFFECT THE APPLICATION OF THE MODIFIED URETHANE PAVEMENT MARKING.
- DURING CONSTRUCTION OPERATIONS, IF ANY LOOSE MATERIAL IS DEPOSITED IN THE FLOW LINE OF DRAINAGE STRUCTURES SUCH THAT THE NATURAL FLOW OF WATER IS OBSTRUCTED, THE MATERIAL SHALL BE REMOVED AT THE CLOSE OF EACH WORKING DAY. AT THE CONCLUSION OF CONSTRUCTION OPERATION, ALL UTILITY STRUCTURES SHALL BE FREE FROM DUST AND DEBRIS. THE WORK SPECIFIED ABOVE WILL NOT BE PAID FOR SEPARATELY BUT SHALL BE INCLUDED IN THE COST OF THE CONTRACT.
- DO NOT SCALE PLANS FOR CONSTRUCTION DIMENSIONS.
- BEFORE BEGINNING ANY WORK, THE CONTRACTOR SHALL RETAIN AND RECORD FOR FUTURE REFERENCE, ALL EXISTING PAVEMENT MARKING LINES (AND RAISED REFLECTIVE PAVEMENT MARKERS) IN ORDER THAT THESE LOCATIONS CAN BE RE-ESTABLISHED FOR STRIPING. EXACT LOCATIONS OF ALL PAVEMENT MARKINGS SHALL BE AS DIRECTED BY THE ENGINEER.
- THE DETECTOR LOOP REPLACEMENT PLANS ARE PROVIDED FOR INFORMATION ONLY.

MODEL: Default
 FILE NAME: \\pulsar\rooms\dot\illinois.gov\PIWDOT\Documents\DOT_Offices\District 1\Projects\153120\CADD\Drawings\153120-sh-agenenc.dgn

USER NAME = elknatibaj	DESIGNED -	REVISED -
	DRAWN -	REVISED -
PLOT SCALE = 100,0000 ' / in.	CHECKED -	REVISED -
PLOT DATE = 3/25/2021	DATE -	REVISED -

**STATE OF ILLINOIS
DEPARTMENT OF TRANSPORTATION**

**111TH ST CENTRAL AVE TO SACRAMENTO AVE
INDEX OF SHEETS, STATE STANDARDS & GENERAL NOTES**

SCALE: SHEET OF SHEETS STA. TO STA.

F.A.U. RTE.	SECTION	COUNTY	TOTAL SHEETS	SHEET NO.
1581	2020-131-I	COOK	20	2
				CONTRACT NO. 62M09
ILLINOIS FED. AID PROJECT				

SUMMARY OF QUANTITIES				CONSTRUCTION TYPE CODE					SUMMARY OF QUANTITIES				CONSTRUCTION TYPE CODE				
CODE NO	ITEM	UNIT	TOTAL QUANTITIES URBAN	0005 80% FED 20% STATE					CODE NO	ITEM	UNIT	TOTAL QUANTITIES URBAN	0005 80% FED 20% STATE				
45100100	CRACK ROUTING (PAVEMENT)	FOOT	2561	2561					* 78009004	MODIFIED URETHANE PAVEMENT MARKING - LINE 4"	FOOT	34587	34587				
45100200	CRACK FILLING	POUND	732	732					* 78009006	MODIFIED URETHANE PAVEMENT MARKING - LINE 6"	FOOT	4961	4961				
45200100	JOINT OR CRACK ROUTING (PC CONCRETE PAVEMENT AND SHOULDER)	FOOT	75570	75570					* 78009008	MODIFIED URETHANE PAVEMENT MARKING - LINE 8"	FOOT	257	257				
45200300	JOINT OR CRACK FILLING	POUND	21590	21590					* 78009012	MODIFIED URETHANE PAVEMENT MARKING - LINE 12"	FOOT	978	978				
67000400	ENGINEER'S FIELD OFFICE, TYPE A	CAL MO	6	6					* 78009024	MODIFIED URETHANE PAVEMENT MARKING - LINE 24"	FOOT	591	591				
67100100	MOBILIZATION	L SUM	1	1					Z0030850	TEMPORARY INFORMATION SIGNING	SO FT	102.8	102.8				
70102625	TRAFFIC CONTROL AND PROTECTION, STANDARD 701606	L SUM	1	1													
70102630	TRAFFIC CONTROL AND PROTECTION, STANDARD 701601	L SUM	1	1													
70102632	TRAFFIC CONTROL AND PROTECTION, STANDARD 701602	L SUM	1	1													
70102635	TRAFFIC CONTROL AND PROTECTION, STANDARD 701701	L SUM	1	1													
70102640	TRAFFIC CONTROL AND PROTECTION, STANDARD 701801	L SUM	1	1													
* 78009000	MODIFIED URETHANE PAVEMENT MARKING - LETTERS AND SYMBOLS	SO FT	837	837													

REV-SEP

* = SPECIALTY ITEMS

FILE NAME =	USER NAME = alkhofbej	DESIGNED -	REVISED -
dw:\planroom\dot\111\mof.gov\PW001\Documents\VDOT\Offices\Dist\ct\Projects\DI5\3120\CADD\Draw\Design\DI5\3120.s		DRAWN -	REVISED -
		CHECKED -	REVISED -
		DATE -	REVISED -

**STATE OF ILLINOIS
DEPARTMENT OF TRANSPORTATION**

**111TH ST (CENTRAL AVE TO PULASKI RD)
SUMMARY OF QUANTITIES**

F.A.U. RTE.	SECTION	COUNTY	TOTAL SHEETS	SHEET NO.
1581	2020-131-1	COOK	20	3
CONTRACT NO. 62M09			FED. ROAD DIST. NO. 1 ILLINOIS FED. AID PROJECT	

SCALE: SHEET NO. OF SHEETS STA. TO STA.

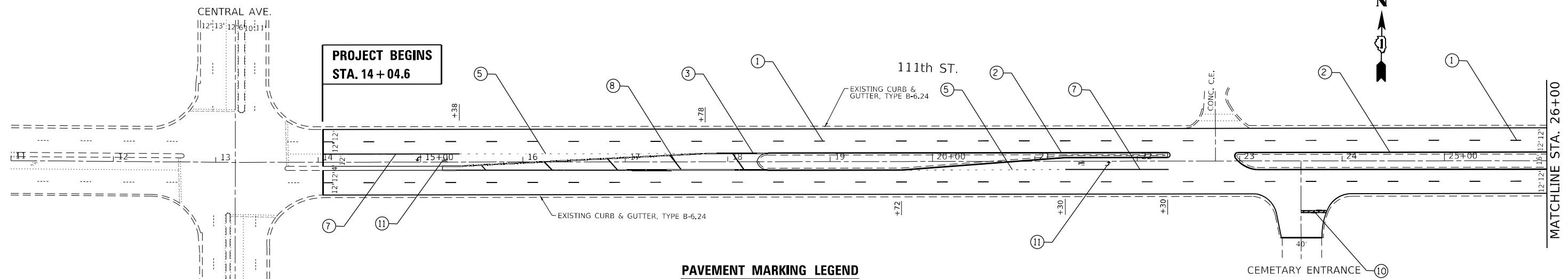

**PROJECT BEGINS
STA. 14 + 04.6**

PAVEMENT MARKING LEGEND

- ① PROP. MODIFIED URETHANE PAVEMENT MARKING LINE, 4" SKIP DASH, WHITE LANE LINE @ 30' SKIP & 10' DASH (TYP.)
- ② PROP. MODIFIED URETHANE PAVEMENT MARKING LINE, 4" SOLID, YELLOW LINE (TYP.)
- ③ PROP. MODIFIED URETHANE PAVEMENT MARKING LINE, 4" DOUBLE SOLID, YELLOW LINE, 2 @ 11" C-C (TYP.)
- ④ PROP. MODIFIED URETHANE PAVEMENT MARKING LINE, 4" SOLID & SKIP DASH, YELLOW LINE, 5 1/2" C-C (SEE DISTRICT DETAIL TC-13 FOR SPACING) (TYP.)
- ⑤ PROP. MODIFIED URETHANE PAVEMENT MARKING LINE, 6" SKIP DASH, WHITE TURN LANE @ 6' SKIP & 2' DASH (TYP.)
- ⑥ PROP. MODIFIED URETHANE PAVEMENT MARKING LINE, 6" SOLID, WHITE CROSSWALK LINE, 2 @ 6' C-C (TYP.)
- ⑦ PROP. MODIFIED URETHANE PAVEMENT MARKING LINE, 6" SOLID, WHITE TURN LANE (TYP.)
- ⑧ PROP. MODIFIED URETHANE PAVEMENT MARKING LINE, 12" SOLID, YELLOW, DIAGONAL LINE @ 75' SPACING OR 5 MIN (TYP.)
- ⑨ PROP. MODIFIED URETHANE PAVEMENT MARKING LINE, 12" SOLID, WHITE, LONGITUDINAL BAR @ 90 DEG. (6' LINE - 2' SPACE) (TYP.) (SEE DISTRICT DETAIL TC-13 FOR SPACING).
- ⑩ PROP. MODIFIED URETHANE PAVEMENT MARKING LINE, 24" SOLID, WHITE STOP BAR (TYP.)
- ⑪ PROP. MODIFIED URETHANE PAVEMENT MARKING LETTERS & SYMBOLS, SOLID, WHITE (TYP.)

ALL FINAL PAVEMENT MARKINGS SHALL BE PLACED IN ACCORDANCE WITH TC-13 "DISTRICT ONE TYPICAL PAVEMENT MARKINGS" STANDARD DETAIL

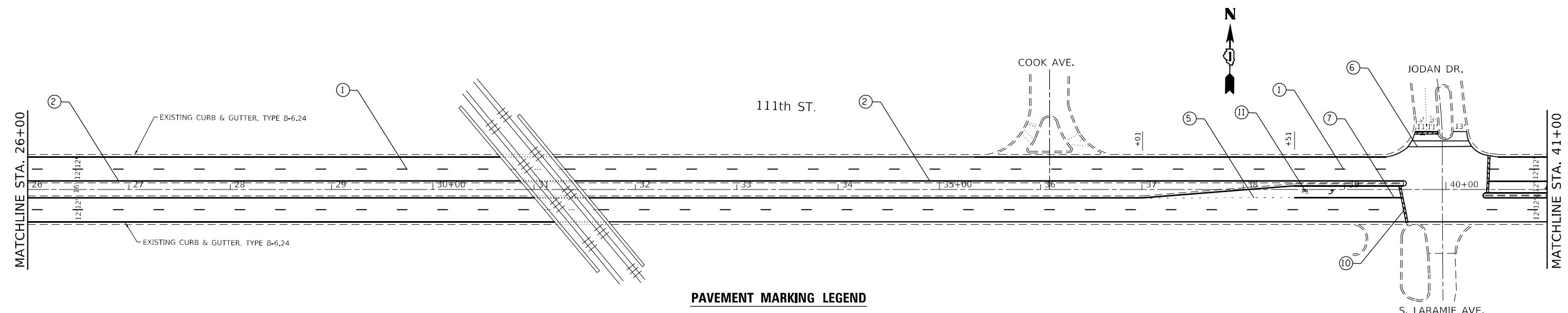

PAVEMENT MARKING LEGEND

- ① PROP. MODIFIED URETHANE PAVEMENT MARKING LINE, 4" SKIP DASH, WHITE LANE LINE @ 30' SKIP & 10' DASH (TYP.)
- ② PROP. MODIFIED URETHANE PAVEMENT MARKING LINE, 4" SOLID, YELLOW LINE (TYP.)
- ③ PROP. MODIFIED URETHANE PAVEMENT MARKING LINE, 4" DOUBLE SOLID, YELLOW LINE, 2 @ 11" C-C (TYP.)
- ④ PROP. MODIFIED URETHANE PAVEMENT MARKING LINE, 4" SOLID & SKIP DASH, YELLOW LINE, 5 1/2" C-C (SEE DISTRICT DETAIL TC-13 FOR SPACING) (TYP.)
- ⑤ PROP. MODIFIED URETHANE PAVEMENT MARKING LINE, 6" SKIP DASH, WHITE TURN LANE @ 6' SKIP & 2' DASH (TYP.)
- ⑥ PROP. MODIFIED URETHANE PAVEMENT MARKING LINE, 6" SOLID, WHITE CROSSWALK LINE, 2 @ 6' C-C (TYP.)
- ⑦ PROP. MODIFIED URETHANE PAVEMENT MARKING LINE, 6" SOLID, WHITE TURN LANE (TYP.)
- ⑧ PROP. MODIFIED URETHANE PAVEMENT MARKING LINE, 12" SOLID, YELLOW, DIAGONAL LINE @ 75' SPACING OR 5 MIN (TYP.)
- ⑨ PROP. MODIFIED URETHANE PAVEMENT MARKING LINE, 12" SOLID, WHITE, LONGITUDINAL BAR @ 90 DEG. (6' LINE - 2' SPACE) (TYP.) (SEE DISTRICT DETAIL TC-13 FOR SPACING).
- ⑩ PROP. MODIFIED URETHANE PAVEMENT MARKING LINE, 24" SOLID, WHITE STOP BAR (TYP.)
- ⑪ PROP. MODIFIED URETHANE PAVEMENT MARKING LETTERS & SYMBOLS, SOLID, WHITE (TYP.)

ALL FINAL PAVEMENT MARKINGS SHALL BE PLACED IN ACCORDANCE WITH TC-13 "DISTRICT ONE TYPICAL PAVEMENT MARKINGS" STANDARD DETAIL

MODEL: Default
 FILE NAME: pulaski_rdm09.ctb
 PROJECT: 1581-131-1
 PROJECT DATE: 3/25/2021
 USER: elkhaj
 PLOT SCALE: 1"=50'
 PLOT DATE: 3/25/2021

USER NAME = elkhaj	DESIGNED -	REVISED -
	DRAWN -	REVISED -
PLOT SCALE = 100,0000' / in.	CHECKED -	REVISED -
PLOT DATE = 3/25/2021	DATE -	REVISED -

**STATE OF ILLINOIS
DEPARTMENT OF TRANSPORTATION**

**111TH ST (CENTRAL AVE TO PULASKI RD)
PROPOSED ROADWAY AND PAVEMENT MARKING PLANS**

SCALE: 1"=50' SHEET OF SHEETS STA. 14+04.6 TO STA. 41+00

F.A.U. RTE.	SECTION	COUNTY	TOTAL SHEETS	SHEET NO.
1581	2020-131-1	COOK	20	4
CONTRACT NO. 62M09				
ILLINOIS FED. AID PROJECT				

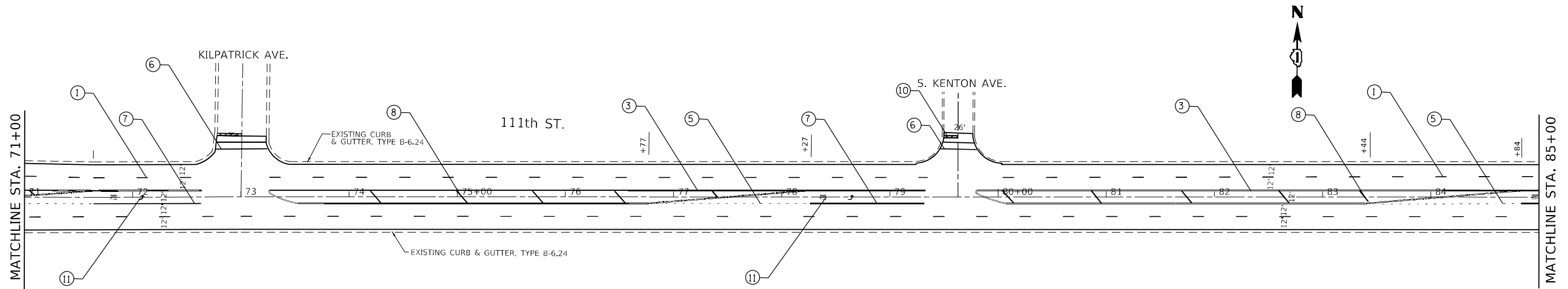

PAVEMENT MARKING LEGEND

- | | | |
|--|---|--|
| <ul style="list-style-type: none"> ① PROP. MODIFIED URETHANE PAVEMENT MARKING LINE, 4" SKIP DASH, WHITE LANE LINE @ 30' SKIP & 10' DASH (TYP.) ② PROP. MODIFIED URETHANE PAVEMENT MARKING LINE, 4" SOLID, YELLOW LINE (TYP.) ③ PROP. MODIFIED URETHANE PAVEMENT MARKING LINE, 4" DOUBLE SOLID, YELLOW LINE, 2 @ 11" C-C (TYP.) ④ PROP. MODIFIED URETHANE PAVEMENT MARKING LINE, 4" SOLID & SKIP DASH, YELLOW LINE, 5 1/2" C-C (SEE DISTRICT DETAIL TC-13 FOR SPACING) (TYP.) | <ul style="list-style-type: none"> ⑤ PROP. MODIFIED URETHANE PAVEMENT MARKING LINE, 6" SKIP DASH, WHITE TURN LANE @ 6' SKIP & 2' DASH (TYP.) ⑥ PROP. MODIFIED URETHANE PAVEMENT MARKING LINE, 6" SOLID, WHITE CROSSWALK LINE, 2 @ 6' C-C (TYP.) ⑦ PROP. MODIFIED URETHANE PAVEMENT MARKING LINE, 6" SOLID, WHITE TURN LANE (TYP.) ⑧ PROP. MODIFIED URETHANE PAVEMENT MARKING LINE, 12" SOLID, YELLOW, DIAGONAL LINE @ 75' SPACING OR 5 MIN (TYP.) | <ul style="list-style-type: none"> ⑨ PROP. MODIFIED URETHANE PAVEMENT MARKING LINE, 12" SOLID, WHITE, LONGITUDINAL BAR @ 90 DEG. (6' LINE - 2' SPACE) (TYP.) (SEE DISTRICT DETAIL TC-13 FOR SPACING). ⑩ PROP. MODIFIED URETHANE PAVEMENT MARKING LINE, 24" SOLID, WHITE STOP BAR (TYP.) ⑪ PROP. MODIFIED URETHANE PAVEMENT MARKING LETTERS & SYMBOLS, SOLID, WHITE (TYP.) |
|--|---|--|

ALL FINAL PAVEMENT MARKINGS SHALL BE PLACED IN ACCORDANCE WITH TC-13 "DISTRICT ONE TYPICAL PAVEMENT MARKINGS" STANDARD DETAIL

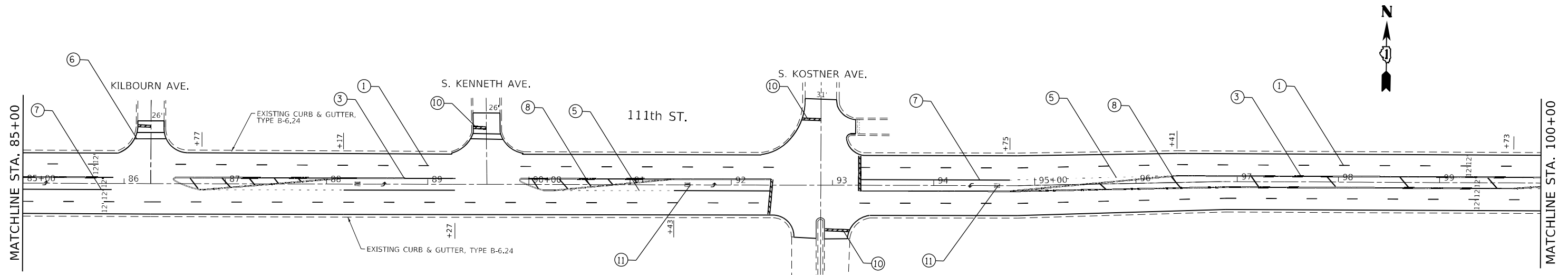

PAVEMENT MARKING LEGEND

- | | | |
|--|---|--|
| <ul style="list-style-type: none"> ① PROP. MODIFIED URETHANE PAVEMENT MARKING LINE, 4" SKIP DASH, WHITE LANE LINE @ 30' SKIP & 10' DASH (TYP.) ② PROP. MODIFIED URETHANE PAVEMENT MARKING LINE, 4" SOLID, YELLOW LINE (TYP.) ③ PROP. MODIFIED URETHANE PAVEMENT MARKING LINE, 4" DOUBLE SOLID, YELLOW LINE, 2 @ 11" C-C (TYP.) ④ PROP. MODIFIED URETHANE PAVEMENT MARKING LINE, 4" SOLID & SKIP DASH, YELLOW LINE, 5 1/2" C-C (SEE DISTRICT DETAIL TC-13 FOR SPACING) (TYP.) | <ul style="list-style-type: none"> ⑤ PROP. MODIFIED URETHANE PAVEMENT MARKING LINE, 6" SKIP DASH, WHITE TURN LANE @ 6' SKIP & 2' DASH (TYP.) ⑥ PROP. MODIFIED URETHANE PAVEMENT MARKING LINE, 6" SOLID, WHITE CROSSWALK LINE, 2 @ 6' C-C (TYP.) ⑦ PROP. MODIFIED URETHANE PAVEMENT MARKING LINE, 6" SOLID, WHITE TURN LANE (TYP.) ⑧ PROP. MODIFIED URETHANE PAVEMENT MARKING LINE, 12" SOLID, YELLOW, DIAGONAL LINE @ 75' SPACING OR 5 MIN (TYP.) | <ul style="list-style-type: none"> ⑨ PROP. MODIFIED URETHANE PAVEMENT MARKING LINE, 12" SOLID, WHITE, LONGITUDINAL BAR @ 90 DEG. (6' LINE - 2' SPACE) (TYP.) (SEE DISTRICT DETAIL TC-13 FOR SPACING). ⑩ PROP. MODIFIED URETHANE PAVEMENT MARKING LINE, 24" SOLID, WHITE STOP BAR (TYP.) ⑪ PROP. MODIFIED URETHANE PAVEMENT MARKING LETTERS & SYMBOLS, SOLID, WHITE (TYP.) |
|--|---|--|

ALL FINAL PAVEMENT MARKINGS SHALL BE PLACED IN ACCORDANCE WITH TC-13 "DISTRICT ONE TYPICAL PAVEMENT MARKINGS" STANDARD DETAIL

MODEL: Default
 FILE NAME: p:\mxd\mxdroom.dwg
 PROJECT: 1581-131-1
 PROJECT DATE: 3/25/2021
 PROJECT TITLE: 111th St (Central Ave to Pulaski Rd)
 PROJECT LOCATION: Cook County, Illinois
 PROJECT NUMBER: 1581-131-1
 PROJECT SHEET: 6 of 20

USER NAME = elkhatbaj	DESIGNED -	REVISED -
PLOT SCALE = 100,0000' / in.	DRAWN -	REVISED -
PLOT DATE = 3/25/2021	CHECKED -	REVISED -
	DATE -	REVISED -

**STATE OF ILLINOIS
DEPARTMENT OF TRANSPORTATION**

**111TH ST (CENTRAL AVE TO PULASKI RD)
PROPOSED ROADWAY AND PAVEMENT MARKING PLANS**

SCALE: 1"=50' SHEET OF SHEETS STA. 71+00 TO STA. 100+00

F.A.U. RTE.	SECTION	COUNTY	TOTAL SHEETS	SHEET NO.
1581	2020-131-1	COOK	20	6
CONTRACT NO. 62M09				
ILLINOIS FED. AID PROJECT				

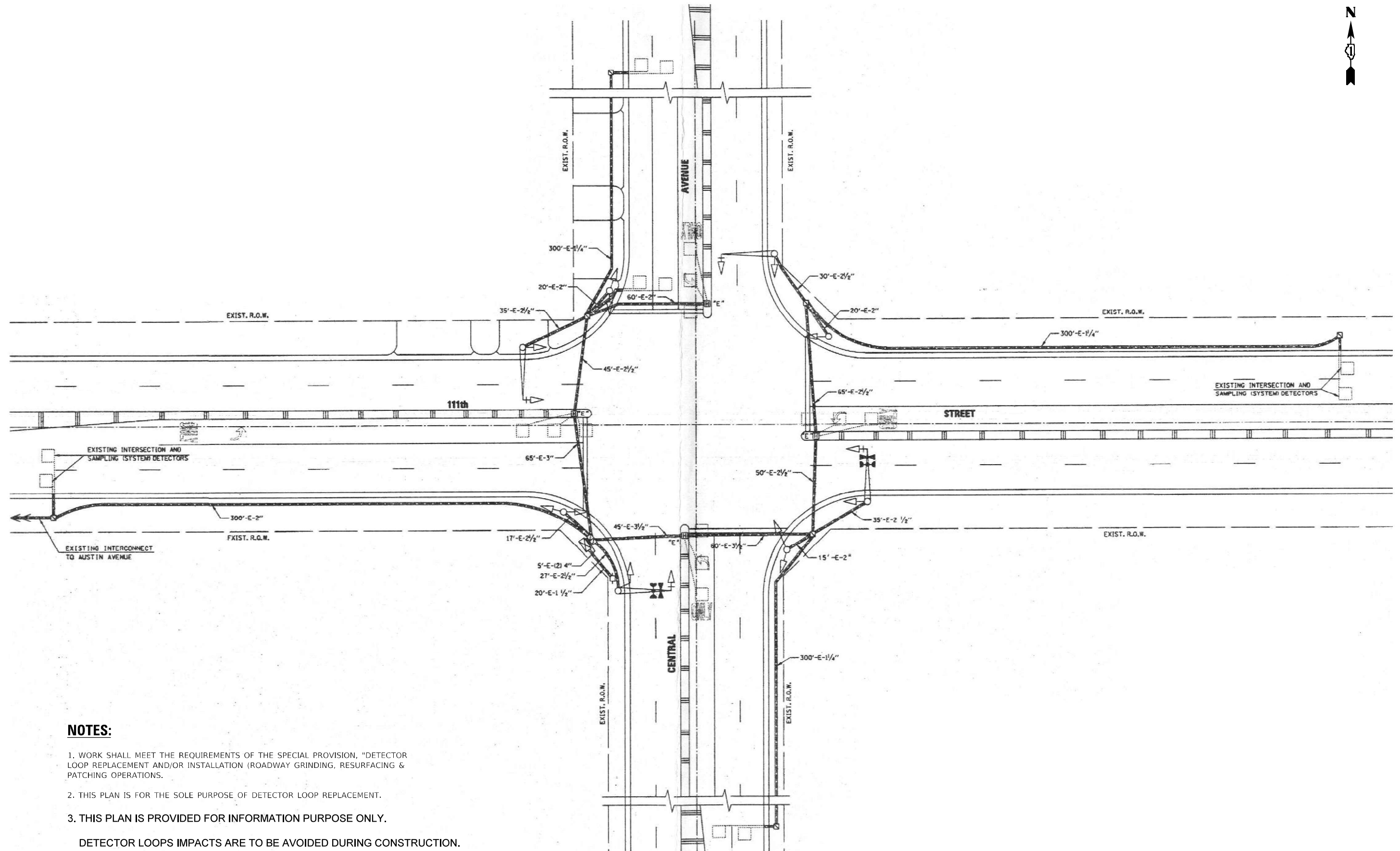

NOTES:

1. WORK SHALL MEET THE REQUIREMENTS OF THE SPECIAL PROVISION, "DETECTOR LOOP REPLACEMENT AND/OR INSTALLATION (ROADWAY GRINDING, RESURFACING & PATCHING OPERATIONS).
 2. THIS PLAN IS FOR THE SOLE PURPOSE OF DETECTOR LOOP REPLACEMENT.
 3. THIS PLAN IS PROVIDED FOR INFORMATION PURPOSE ONLY.
- DETECTOR LOOPS IMPACTS ARE TO BE AVOIDED DURING CONSTRUCTION.

MODEL: D:\p\p\111th St @ Central.dgn
 FILE NAME: SW\p\p\111th St @ Central.dgn

USER NAME = jlangc	DESIGNED - CJ	REVISED -
	DRAWN - CJ	REVISED -
PLOT SCALE = 40,0000 * / in.	CHECKED - LP	REVISED -
PLOT DATE = 11/13/2020	DATE - 11/13/2020	REVISED -

**STATE OF ILLINOIS
 DEPARTMENT OF TRANSPORTATION**

**DETECTOR LOOP REPLACEMENT PLAN
 111th ST AT CENTRAL AVE.**

SCALE: 1"=20' SHEET OF SHEETS STA. TO STA.

F.A.U. RTE. 1581	SECTION 2020-131-I	COUNTY COOK	TOTAL SHEETS 20	SHEET NO. 8
CONTRACT NO. 62M09				
ILLINOIS FED. AID PROJECT				

TS 3945

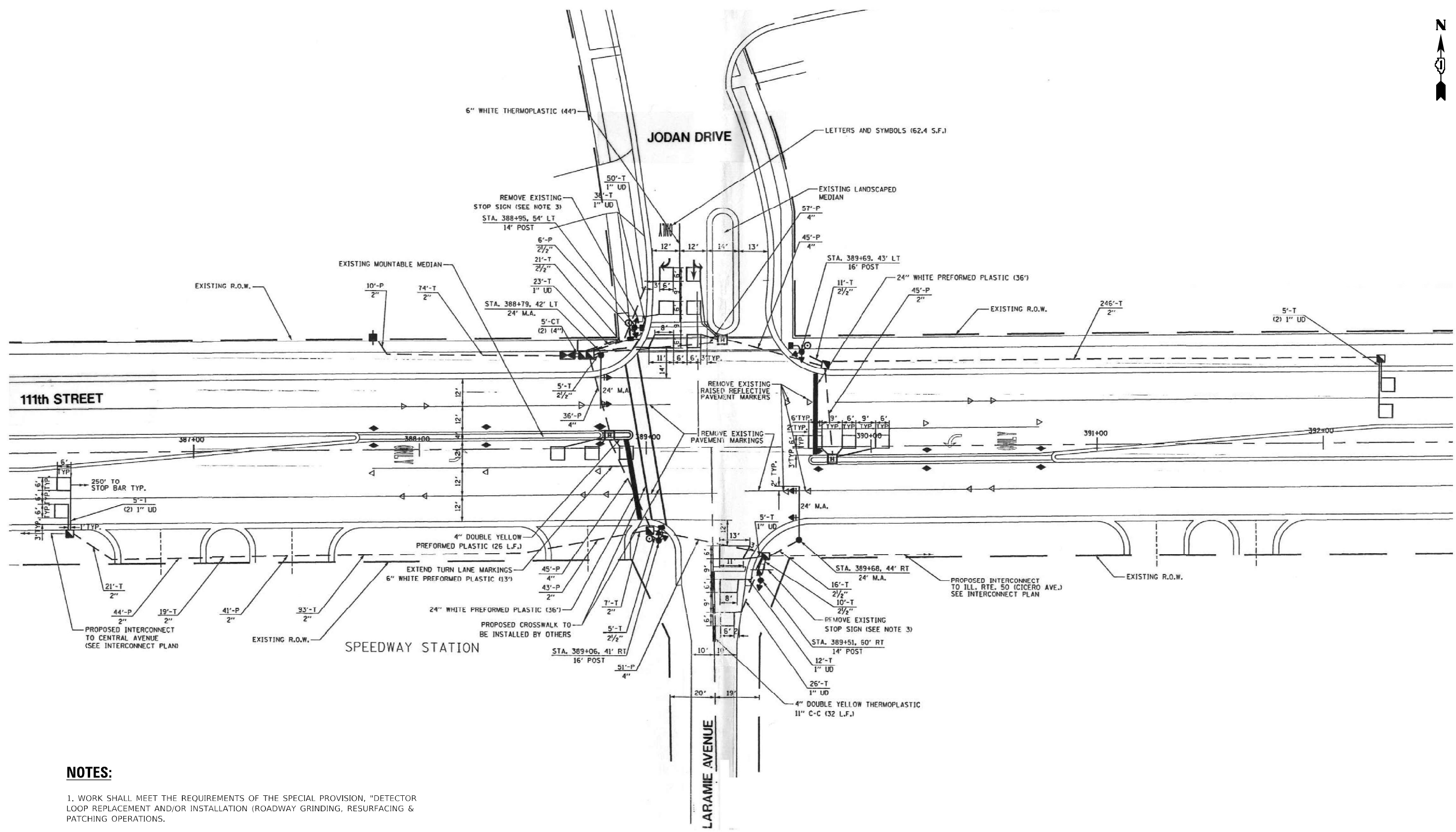

NOTES:

1. WORK SHALL MEET THE REQUIREMENTS OF THE SPECIAL PROVISION, "DETECTOR LOOP REPLACEMENT AND/OR INSTALLATION (ROADWAY GRINDING, RESURFACING & PATCHING OPERATIONS).
 2. THIS PLAN IS FOR THE SOLE PURPOSE OF DETECTOR LOOP REPLACEMENT.
 3. THIS PLAN IS PROVIDED FOR INFORMATION PURPOSE ONLY.
- DETECTOR LOOPS IMPACTS ARE TO BE AVOIDED DURING CONSTRUCTION.

MODEL: D:\cadd\11th\11th\11th_11th.st @ Jodan Dr.dgn
 FILE NAME: S:\projects\6210015_2512_11th St @ Jodan Dr.dgn

USER NAME = jlangc	DESIGNED - CJ	REVISED -
	DRAWN - CJ	REVISED -
PLOT SCALE = 40,0000 */ in.	CHECKED - LP	REVISED -
PLOT DATE = 11/13/2020	DATE - 11/13/2020	REVISED -

**STATE OF ILLINOIS
DEPARTMENT OF TRANSPORTATION**

**DETECTOR LOOP REPLACEMENT PLAN
11th ST AT JODAN DR.**

SCALE: 1"=20' SHEET OF SHEETS STA. TO STA.

F.A.J. RTE. 1581	SECTION 2020-131-I	COUNTY COOK	TOTAL SHEETS 20	SHEET NO. 9
ILLINOIS			FED. AID PROJECT	

TS 2512

CONTRACT NO. 62M09

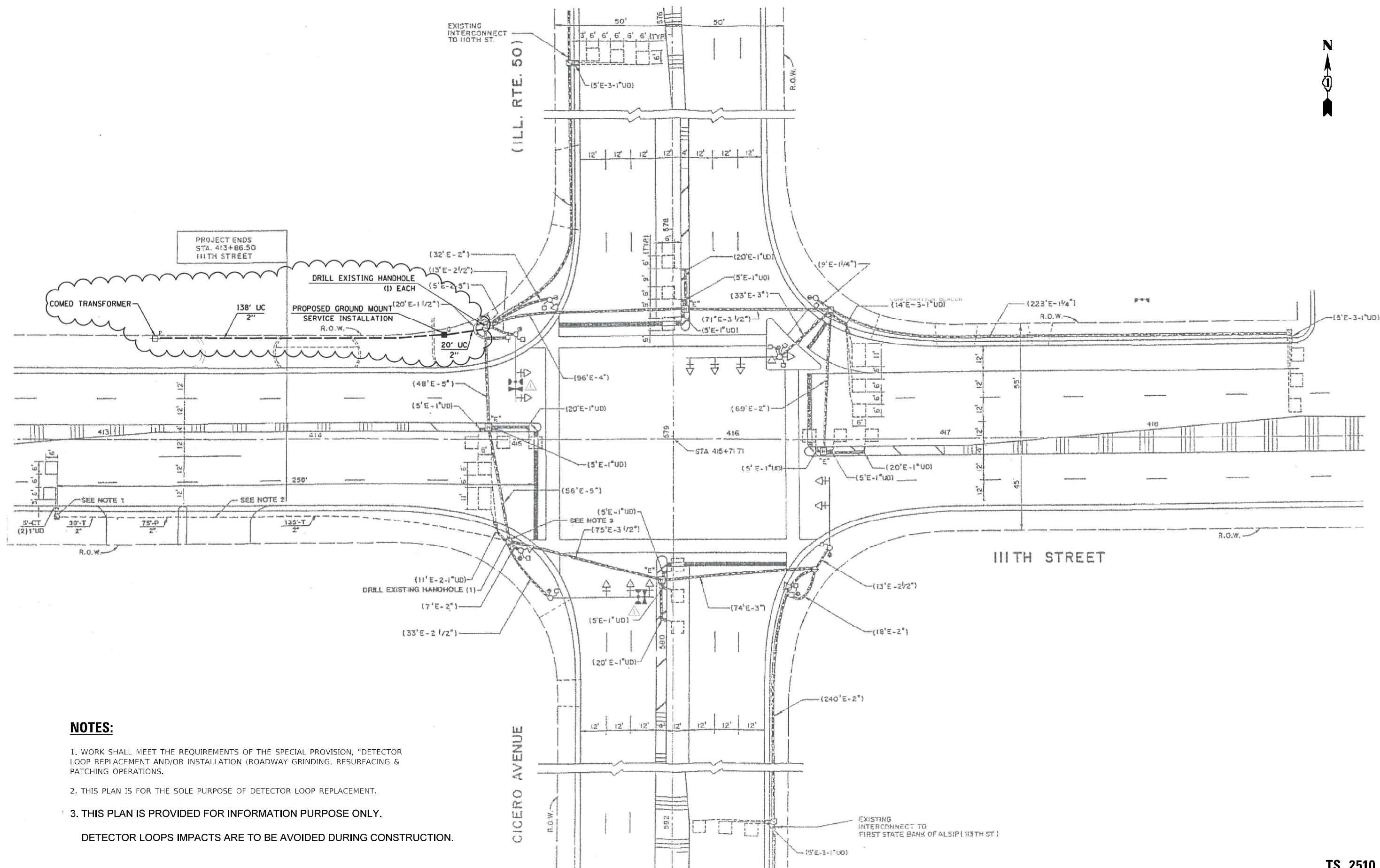

NOTES:

1. WORK SHALL MEET THE REQUIREMENTS OF THE SPECIAL PROVISION, "DETECTOR LOOP REPLACEMENT AND/OR INSTALLATION (ROADWAY GRINDING, RESURFACING & PATCHING OPERATIONS).
 2. THIS PLAN IS FOR THE SOLE PURPOSE OF DETECTOR LOOP REPLACEMENT.
 3. THIS PLAN IS PROVIDED FOR INFORMATION PURPOSE ONLY.
- DETECTOR LOOPS IMPACTS ARE TO BE AVOIDED DURING CONSTRUCTION.

MODEL: D:\cadd\111th\111th_50_Cicero_Ave.dwg
 FILE NAME: SW\111th\111th_50_Cicero_Ave.dwg @ 111th_50.dgn

USER NAME = jiangc	DESIGNED - CJ	REVISED -
	DRAWN - CJ	REVISED -
PLOT SCALE = 40,0000' / in.	CHECKED - LP	REVISED -
PLOT DATE = 11/13/2020	DATE - 11/13/2020	REVISED -

**STATE OF ILLINOIS
 DEPARTMENT OF TRANSPORTATION**

**DETECTOR LOOP REPLACEMENT PLAN
 111th ST AT IL 50 (CICERO AVE.)**

SCALE: 1"=20' SHEET OF SHEETS STA. TO STA.

F.A.U. RTE. 1581	SECTION 2020-131-I	COUNTY COOK	TOTAL SHEETS 20	SHEET NO. 10
CONTRACT NO. 62M09				
ILLINOIS FED. AID PROJECT				

TS 2510

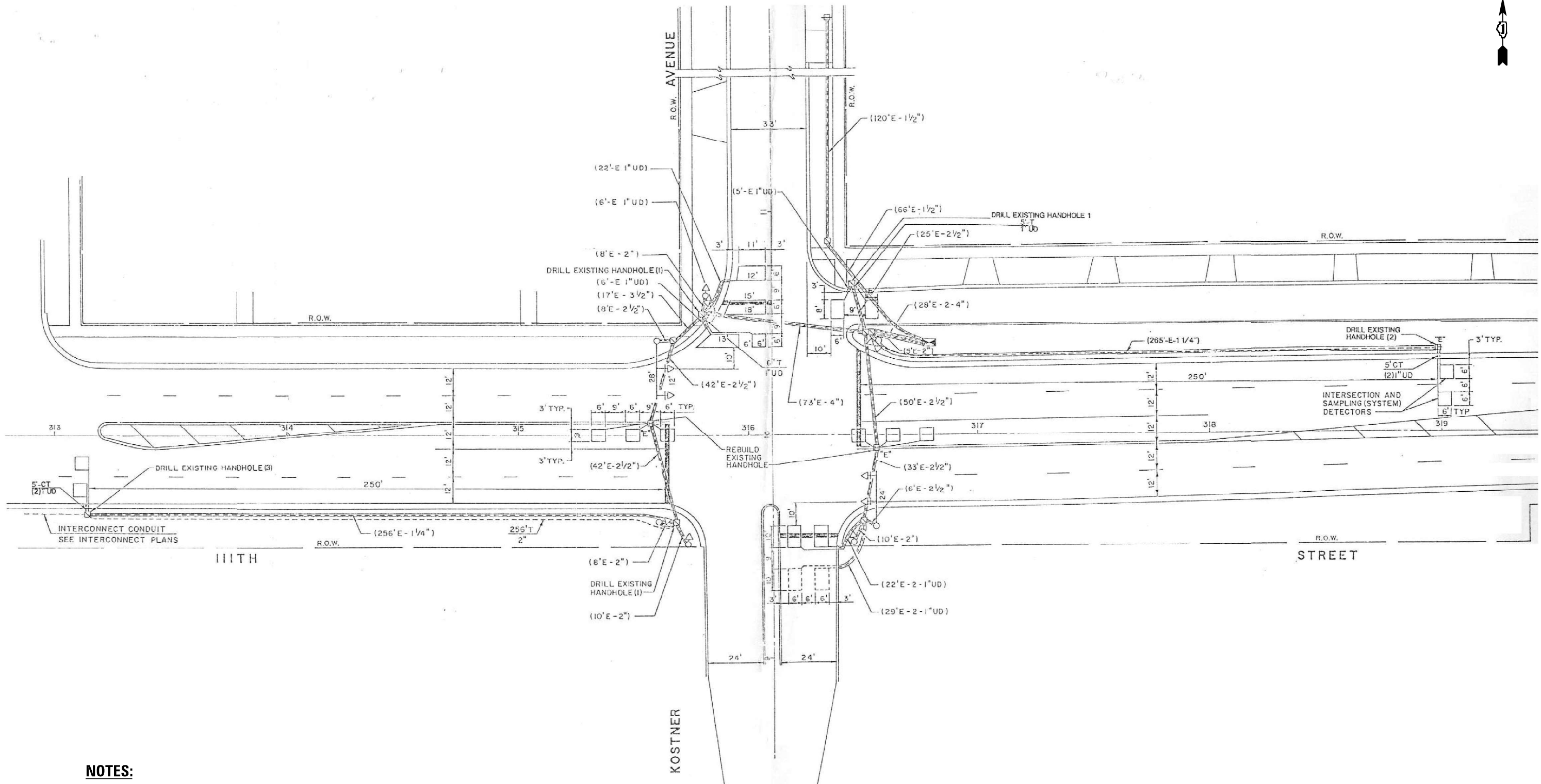

NOTES:

1. WORK SHALL MEET THE REQUIREMENTS OF THE SPECIAL PROVISION, "DETECTOR LOOP REPLACEMENT AND/OR INSTALLATION (ROADWAY GRINDING, RESURFACING & PATCHING OPERATIONS).
 2. THIS PLAN IS FOR THE SOLE PURPOSE OF DETECTOR LOOP REPLACEMENT.
 3. THIS PLAN IS PROVIDED FOR INFORMATION PURPOSE ONLY.
- DETECTOR LOOPS IMPACTS ARE TO BE AVOIDED DURING CONSTRUCTION.

MODEL: D:\p\h\p\111th St @ Kostner.dgn
 FILE NAME: S:\P\111th St @ Kostner.dgn
 111th St @ Kostner.dgn

USER NAME = jlangc	DESIGNED - CJ	REVISED -
	DRAWN - CJ	REVISED -
PLOT SCALE = 40,0000 * / in.	CHECKED - LP	REVISED -
PLOT DATE = 11/13/2020	DATE - 11/13/2020	REVISED -

**STATE OF ILLINOIS
DEPARTMENT OF TRANSPORTATION**

DETECTOR LOOP REPLACEMENT PLAN			
111th ST AT KOSTNER AVE.			
SCALE: 1"=20'	SHEET	OF SHEETS	STA. TO STA.

F.A.U. RTE. 1581	SECTION 2020-131-I	COUNTY COOK	TOTAL SHEETS 20	SHEET NO. 11
CONTRACT NO. 62M09				
ILLINOIS FED. AID PROJECT				

TS 12135

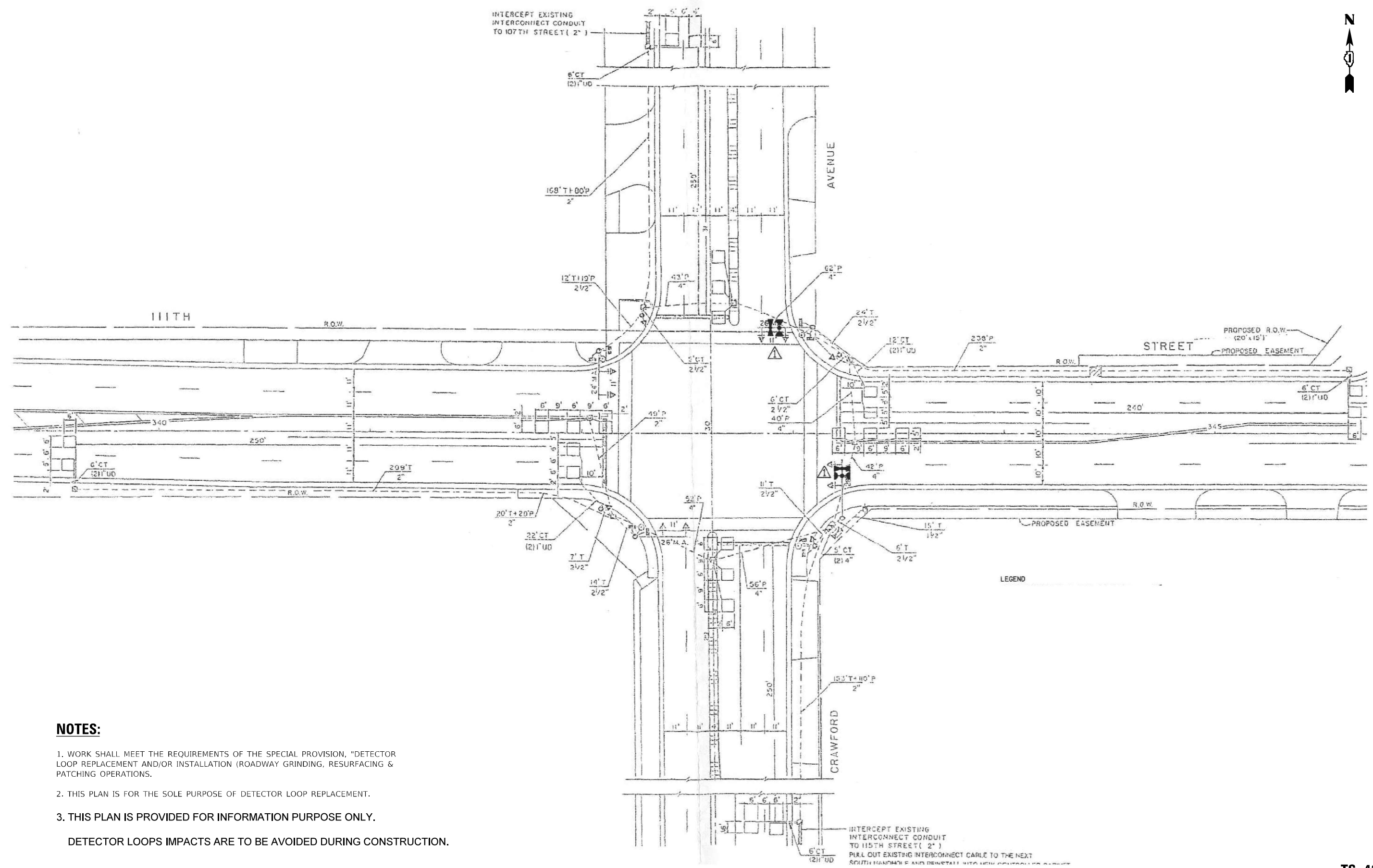

NOTES:

1. WORK SHALL MEET THE REQUIREMENTS OF THE SPECIAL PROVISION, "DETECTOR LOOP REPLACEMENT AND/OR INSTALLATION (ROADWAY GRINDING, RESURFACING & PATCHING OPERATIONS).
 2. THIS PLAN IS FOR THE SOLE PURPOSE OF DETECTOR LOOP REPLACEMENT.
 3. THIS PLAN IS PROVIDED FOR INFORMATION PURPOSE ONLY.
- DETECTOR LOOPS IMPACTS ARE TO BE AVOIDED DURING CONSTRUCTION.

MODEL: D:\p\111th St @ Crawford Ave-Pulaski Rd.dwg
 FILE NAME: S:\P\111th St @ Crawford Ave-Pulaski Rd.dwg

TS 4270

USER NAME = jlangc	DESIGNED - CJ	REVISED -
	DRAWN - CJ	REVISED -
PLOT SCALE = 40,0000 * / in.	CHECKED - LP	REVISED -
PLOT DATE = 11/13/2020	DATE - 11/13/2020	REVISED -

STATE OF ILLINOIS
DEPARTMENT OF TRANSPORTATION

DETECTOR LOOP REPLACEMENT PLAN			
111th ST AT PULASKI RD.			
SCALE: 1"=20'	SHEET	OF SHEETS	STA. TO STA.

F.A.U. RTE.	SECTION	COUNTY	TOTAL SHEETS	SHEET NO.
1581	2020-131-I	COOK	20	12
CONTRACT NO. 62M09				
ILLINOIS FED. AID PROJECT				

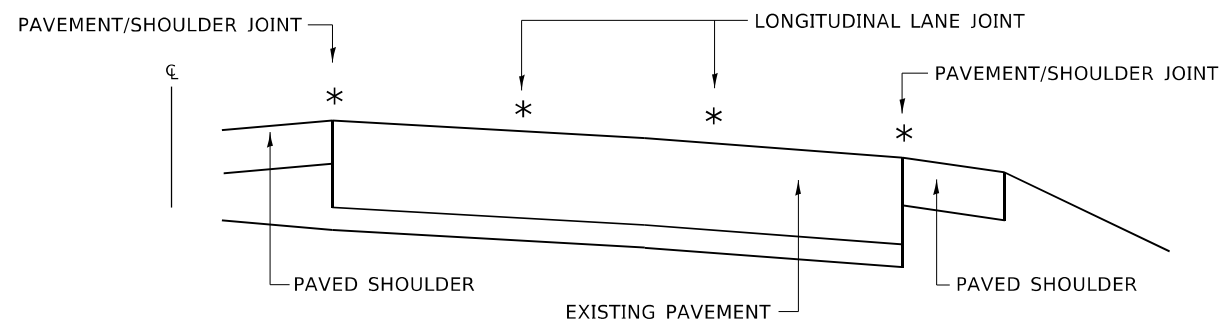

MULTI-LANE DIVIDED PAVEMENT

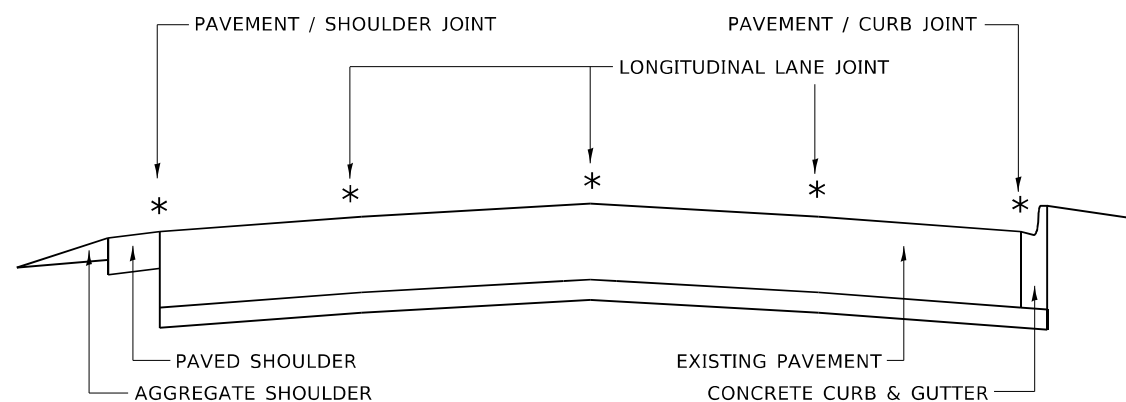

MULTI-LANE UNDIVIDED PAVEMENT

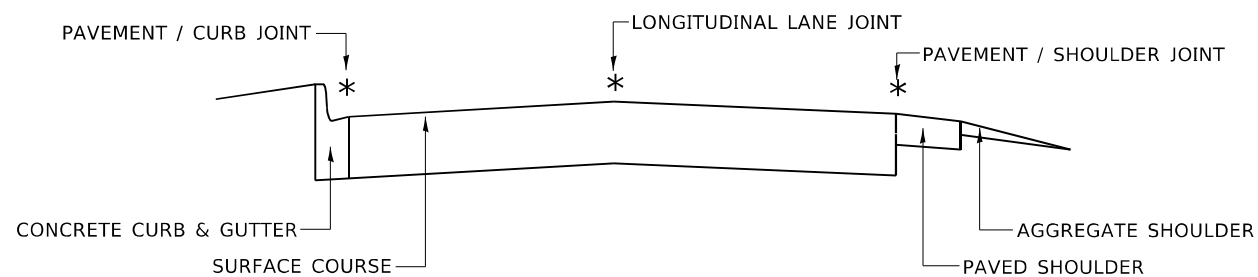

TWO-LANE PAVEMENT

* PROPOSED LONGITUDINAL CRACK ROUTING (PAVEMENT) & CRACK FILLING LOCATIONS

**GENERAL EXISTING TYPICAL SECTIONS
(APPLIES TO HMA AND PCC PAVEMENTS)**

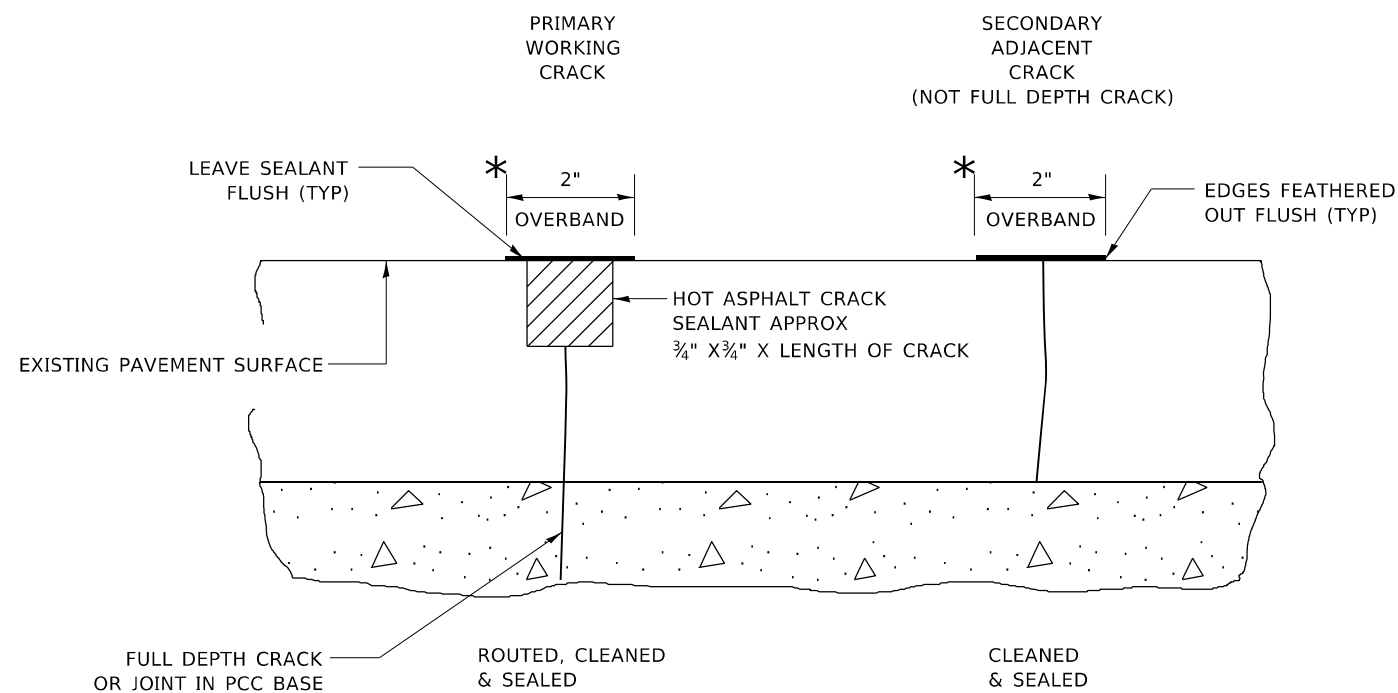

* IN ALL LOCATIONS WHERE THE LONGITUDINAL CRACK CONFLICTS WITH EXISTING PAVEMENT MARKINGS (EITHER EDGE LINE OR LANE LINE) THE CRACK SHALL BE ROUTED & THE RESULTING RESERVOIR FILLED WITH SEALANT. ALL DAMAGES TO EXISTING RAISED REFLECTIVE PAVEMENT MARKERS SHALL BE REPLACED AT THE EXPENSE OF THE CONTRACTOR. ALL EXISTING PAVEMENT MARKINGS WITHIN THE PROJECT LIMITS SHALL BE RESTORED WITH MODIFIED URETHANE PAVEMENT MARKINGS.

LONGITUDINAL JOINT

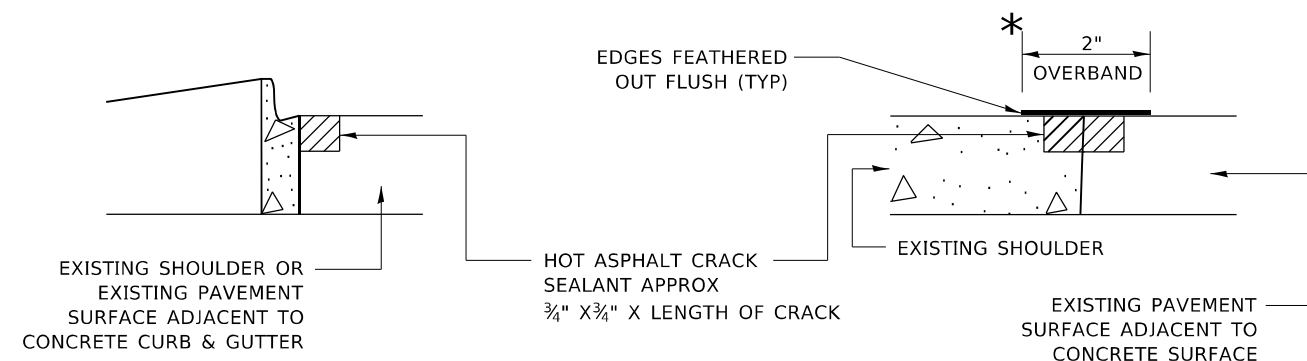

CRACK & JOINT SEALING DETAIL

MODEL: Default
FILE NAME: p:\pub\amaronn.dwt\illinois.gov\PIWDOT\Documents\DOT_Offices\Distrefc_1\Projects\153120\CaddData\Design\153120-sh-schedule.dgn

USER NAME = husselraa	DESIGNED - F. Aqueel / A. Midy	REVISED -
PLOT SCALE = 100,0000' / in.	CHECKED -	REVISED -
PLOT DATE = 12/15/2020	DATE - 10/08/2020	REVISED -

**STATE OF ILLINOIS
DEPARTMENT OF TRANSPORTATION**

CRACK & JOINT SEALING DETAIL (PD-11)

SCALE: SHEET OF SHEETS STA. TO STA.

F.A.U. RTE.	SECTION	COUNTY	TOTAL SHEETS	SHEET NO.
1581	2020-131-I	COOK	20	13
CONTRACT NO. 62M09				
ILLINOIS FED. AID PROJECT				

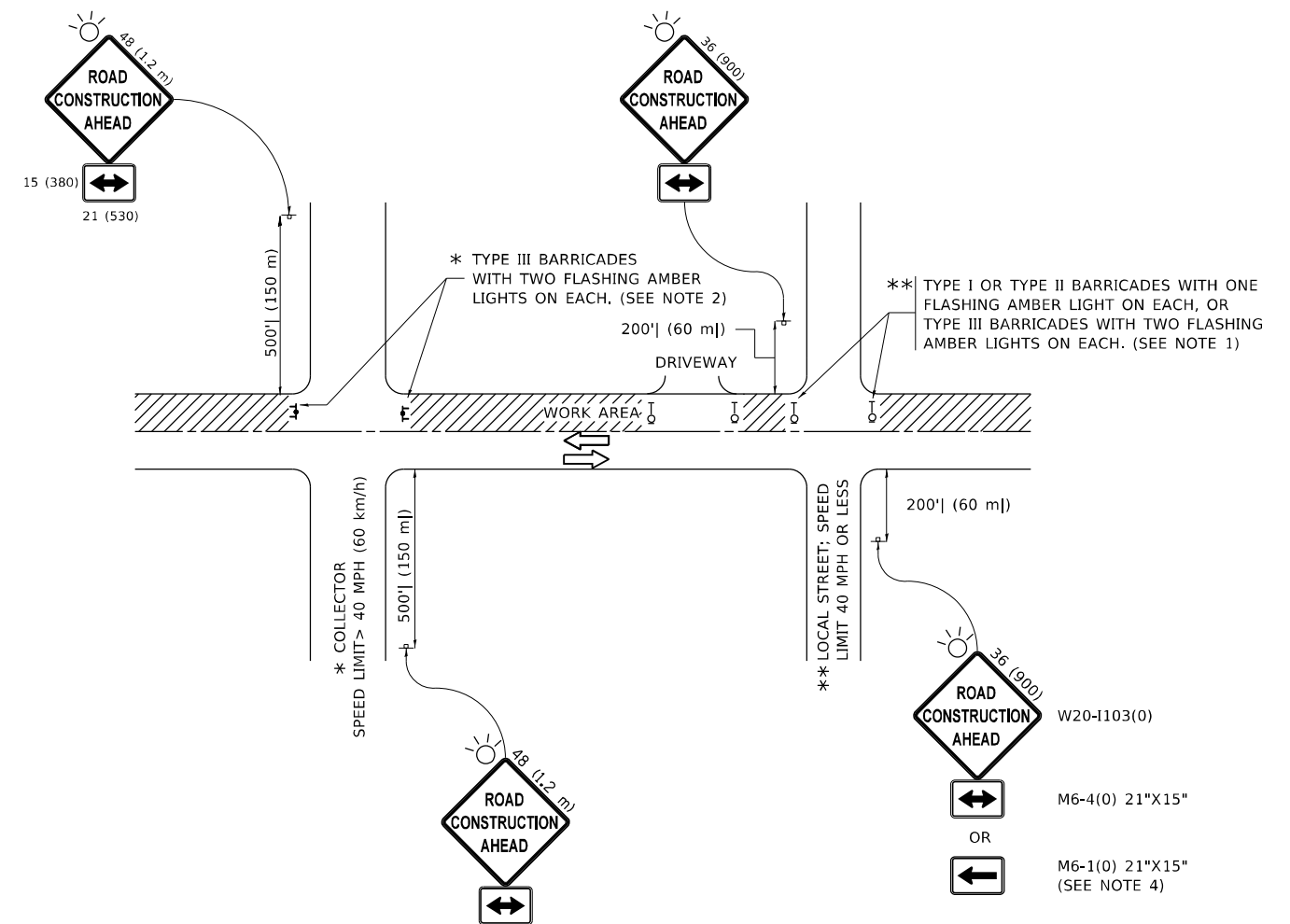

NOTES:

1. SIDE ROAD WITH A SPEED LIMIT OF 40 MPH (60 km/h) OR LESS AS SHOWN ON THE DRAWING AND AS DIRECTED BY THE ENGINEER:
 - a) ONE "ROAD CONSTRUCTION AHEAD" SIGN 36 x 36 (900x900) WITH A FLASHER MOUNTED ON IT APPROXIMATELY 200' (60 m) IN ADVANCE OF THE MAIN ROUTE.
 - b) THE CLOSED PORTION OF THE MAIN ROUTE SHALL BE PROTECTED BY BLOCKING WITH TYPE I, TYPE II OR TYPE III BARRICADES, 1/3 OF THE CROSS SECTION OF THE CLOSED PORTION.
2. SIDE ROAD WITH A SPEED LIMIT GREATER THAN 40 MPH (60 km/h) AS SHOWN ON THE DRAWING AND AS DIRECTED BY THE ENGINEER:
 - a) ONE "ROAD CONSTRUCTION AHEAD" SIGN 48 x 48 (1.2 m x 1.2 m) WITH A FLASHER MOUNTED ON IT APPROXIMATELY 500' (150 m) IN ADVANCE OF THE MAIN ROUTE.
 - b) BLOCKING WITH TYPE III BARRICADES, 1/2 OF THE CROSS SECTION OF THE CLOSED PORTION.
3. CONES MAY BE SUBSTITUTED FOR BARRICADES OR DRUMS AT HALF THE SPACING DURING DAY OPERATIONS. CONES SHALL BE A MINIMUM OF 28 (710) IN HEIGHT.
4. SIGNING AND THE WORK ZONE, A SINGLE HEADED ARROW (M6-1) SHALL BE USED IN LIEU OF THE DOUBLE HEADED ARROW (M6-4).
5. WHEN WORK IS BEING PERFORMED ON A SIDE ROAD OR DRIVEWAY, FOLLOW THE APPLICABLE STANDARD(S). THE DIRECTIONAL ARROW (M6-1 OR M6-4) SHALL BE COVERED OR REMOVED WHEN NO LONGER CONSISTENT WITH THE TRAFFIC CONTROL SET-UP.
6. ADVANCE WARNING SIGNS ARE TO BE OMITTED ON DRIVEWAYS UNLESS OTHERWISE SPECIFIED IN THE PLANS OR BY THE ENGINEER.
7. THE TRAFFIC CONTROL AND PROTECTION FOR SIDE ROADS, INTERSECTIONS, AND DRIVEWAYS SHALL BE INCLUDED IN THE COST OF SPECIFIED TRAFFIC CONTROL STANDARDS OR ITEMS.

All dimensions are in inches (millimeters) unless otherwise shown.

MODEL: Default
 FILE NAME: p:\m\m\room.dwt\illinois.gov\PIWIDOT\Documents\IBDOT_Offices\Bartec_1\Projects\ID153120\CADDData\Design\Dis5td.dgn

USER NAME = elknatibaj	DESIGNED - L.H.A.	REVISED - A. HOUSEH 10-15-96
PLOT SCALE = 100,0000' / in.	CHECKED -	REVISED - T. RAMMACHER 01-06-00
PLOT DATE = 3/25/2021	DATE - 06-89	REVISED - A. SCHUETZE 07-01-13
		REVISED - A. SCHUETZE 09-15-16

**STATE OF ILLINOIS
DEPARTMENT OF TRANSPORTATION**

**TRAFFIC CONTROL AND PROTECTION FOR
SIDE ROADS, INTERSECTIONS, AND DRIVEWAYS**

SCALE: NONE SHEET 1 OF 1 SHEETS STA. TO STA.

F.A.U. RTE.	SECTION	COUNTY	TOTAL SHEETS	SHEET NO.
1581	2020-131-I	COOK	20	14
TC-10			CONTRACT NO. 62M09	
ILLINOIS FED. AID PROJECT				

TURN BAY ENTRANCE AT START OF LANE CLOSURE TAPER

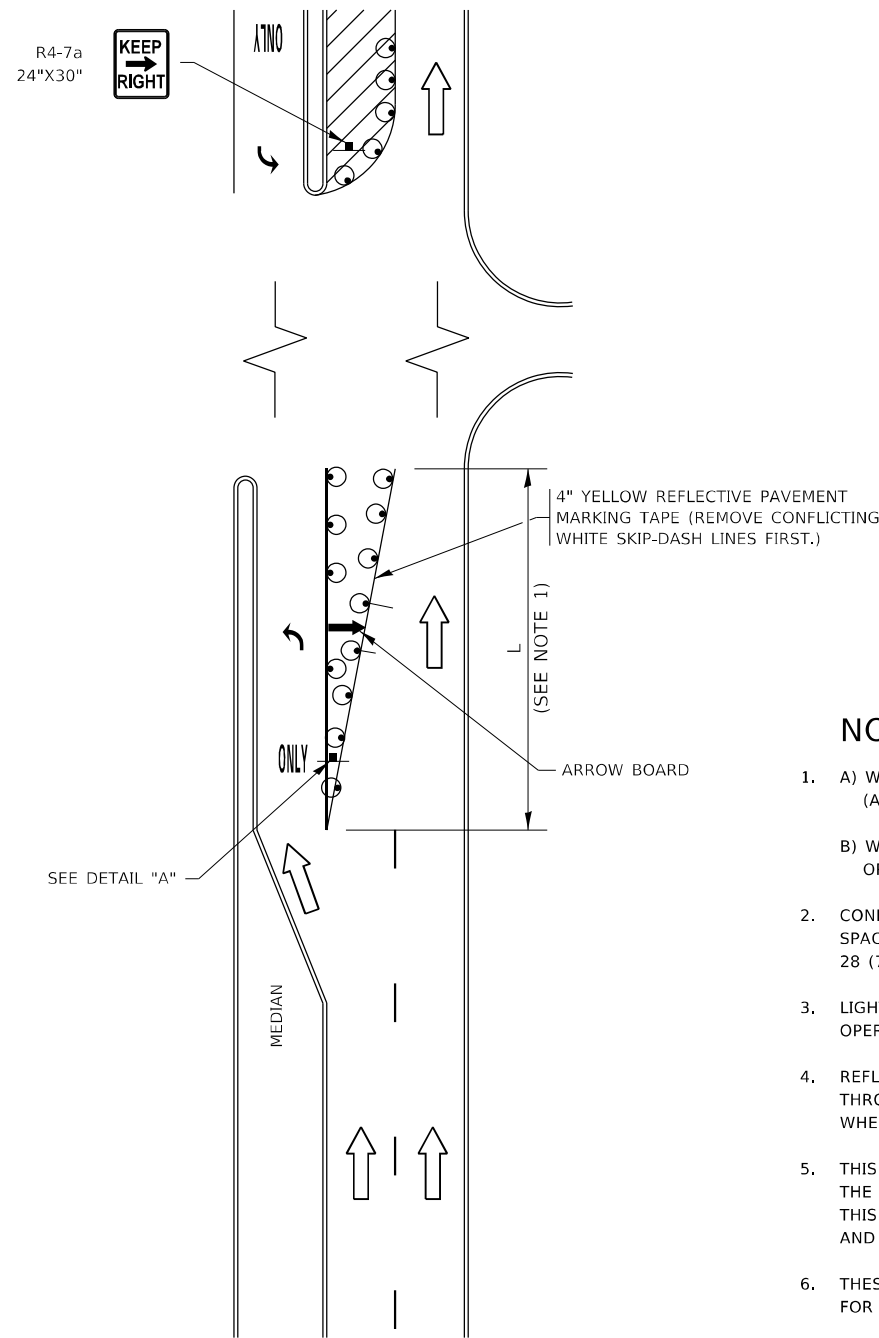

FIGURE 1

TURN BAY ENTRANCE WITHIN A LANE CLOSURE

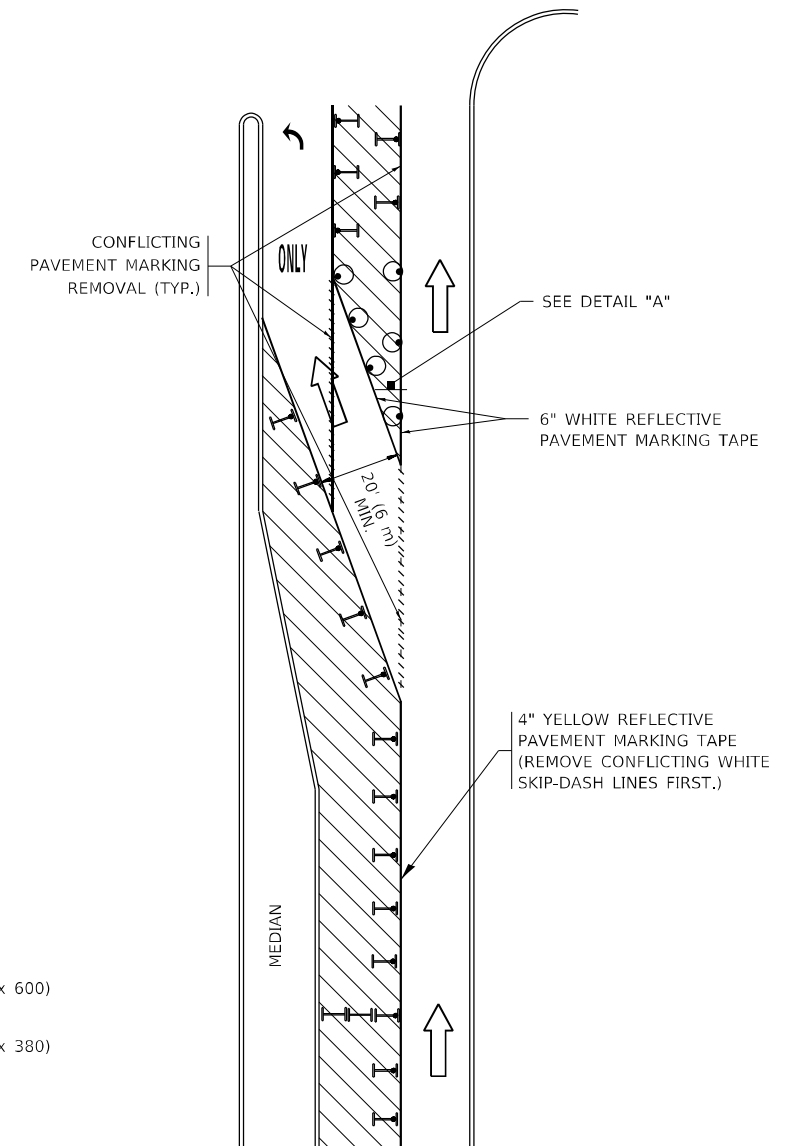

FIGURE 2

LEGEND

- WORK AREA
- LANE OPEN TO TRAFFIC
- ARROW BOARD
- TYPE I OR II BARRICADE OR DRUM WITH STEADY BURN LIGHT
- DRUM WITH STEADY BURN LIGHT
- SIGN ASSEMBLY
- TYPE I OR II CHECK BARRICADE WITH FLASHING LIGHT

NOTES:

1. A) WHEN "L" IS \leq THE STORAGE LENGTH OF THE TURN LANE (AS SHOWN IN FIG. 1), USE FIGURE 1.
B) WHEN "L" IS $>$ THE STORAGE LENGTH OF THE TURN LANE OR THE TURN LANE IS WITHIN THE LANE CLOSURE, USE FIGURE 2.
2. CONES MAY BE SUBSTITUTED FOR BARRICADES OR DRUMS AT HALF THE SPACING DURING DAY OPERATIONS. CONES SHALL BE A MINIMUM OF 28 (710) IN HEIGHT.
3. LIGHTS WILL NOT BE REQUIRED ON BARRICADES OR DRUMS FOR DAY OPERATIONS. ALL LIGHTS SHALL BE MONODIRECTIONAL.
4. REFLECTIVE TEMPORARY PAVEMENT MARKINGS SHALL BE PLACED THROUGHOUT THE BARRICADED AREAS OF EACH TURN BAY AS SHOWN WHERE THE CLOSURE TIME IS GREATER THAN FOURTEEN (14) DAYS.
5. THIS APPLICATION ALSO APPLIES WHEN WORK IS BEING PERFORMED IN THE RIGHT LANE(S) AND THE RIGHT TURN BAY IS TO REMAIN OPEN. UNDER THIS CONDITION, "RIGHT TURN LANE" R3-1100R 24 x 24 (600 x 600) AND M6-2R 21 x 15 (530 x 380) SHALL BE USED.
6. THESE CONTROLS SHALL SUPPLEMENT MAINLINE TRAFFIC CONTROL FOR LANE CLOSURES.
7. THE SIGNS SHALL BE MOUNTED ABOVE THE BARRICADES/DRUMS ON SEPARATE SIGN SUPPORTS THAT MEET NCHRP 350 OR MASH REQUIREMENTS.
8. TRAFFIC CONTROL AND PROTECTION AT TURN BAYS (TO REMAIN OPEN TO TRAFFIC) SHALL BE INCLUDED IN THE COST OF SPECIFIED TRAFFIC CONTROL STANDARDS OR ITEMS.

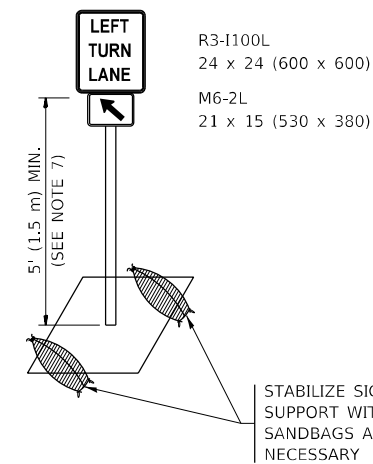

DETAIL A

All dimensions are in inches (millimeters) unless otherwise shown.

MODEL: Default
FILE NAME: p:\pub\mcrroom.dwg
PROJECT: I:\Projects\1581\20\CADData\Design\DES.dwg

USER NAME = elkhatibaj	DESIGNED - T. RAMMACHER 09-08-94	REVISED - R. BORO 09-14-09
	DRAWN - A. HOUSEH 11-07-95	REVISED - A. SCHUETZE 07-01-13
PLOT SCALE = 100,0000' / in.	CHECKED - A. HOUSEH 10-12-96	REVISED - A. SCHUETZE 09-15-16
PLOT DATE = 3/25/2021	DATE - T. RAMMACHER 01-06-00	REVISED -

**STATE OF ILLINOIS
DEPARTMENT OF TRANSPORTATION**

**TRAFFIC CONTROL AND PROTECTION AT TURN BAYS
(TO REMAIN OPEN TO TRAFFIC)**

SCALE: NONE SHEET 1 OF 1 SHEETS STA. TO STA.

F.A.U. RTE.	SECTION	COUNTY	TOTAL SHEETS	SHEET NO.
1581	2020-131-I	COOK	20	16
TC-14		CONTRACT NO. 62M09		
ILLINOIS FED. AID PROJECT				

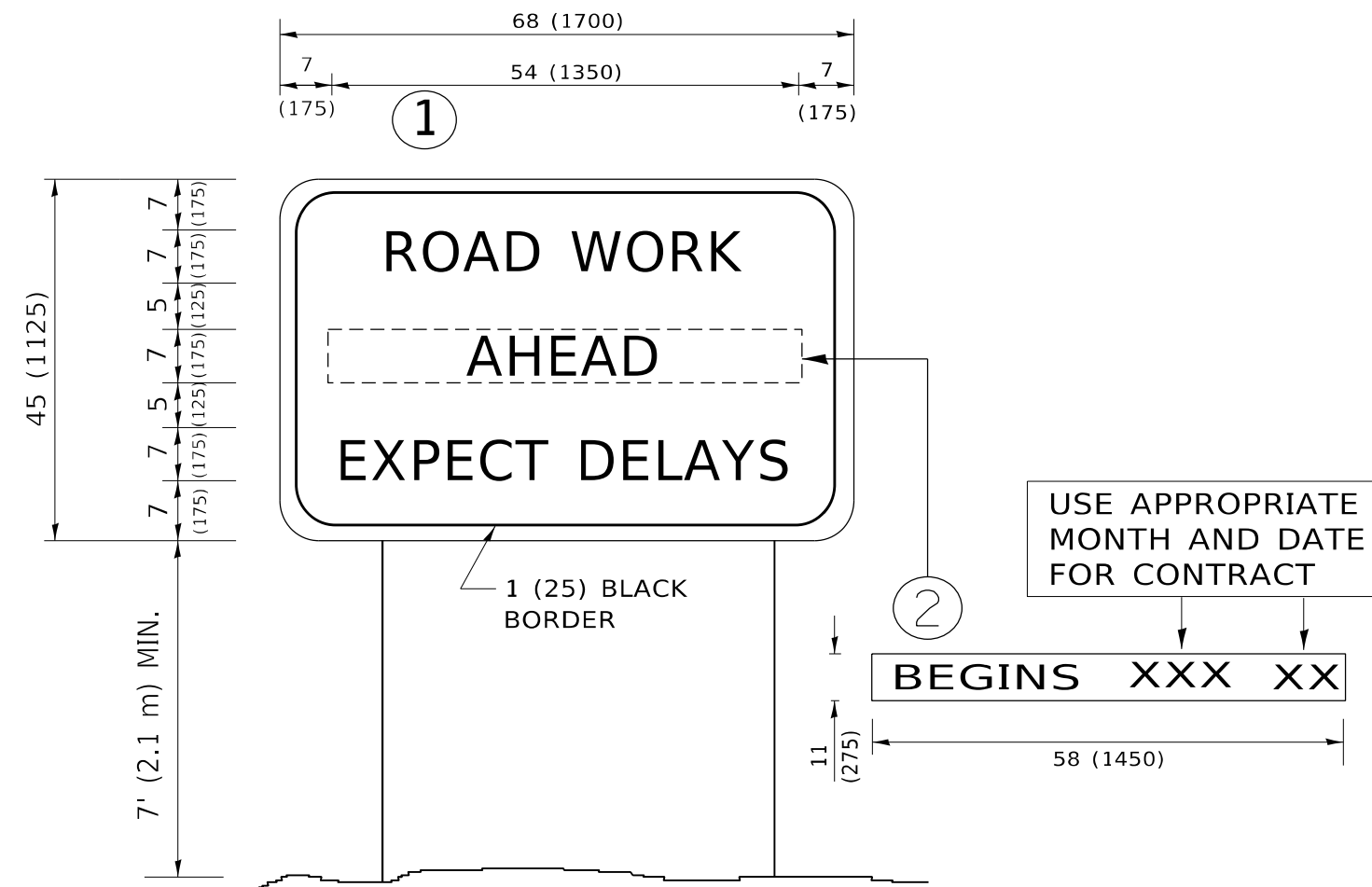

NOTES:

1. USE BLACK LETTERING ON ORANGE BACKGROUND.
2. ERECT SIGNS IN ADVANCE OF THE LOCATION FOR THE "ROAD CONSTRUCTION AHEAD" SIGN AT LOCATIONS AS DIRECTED BY THE ENGINEER.
3. ERECT SIGN ① WITH INSTALLED PANEL ② ONE WEEK PRIOR TO THE START OF CONSTRUCTION.
4. REMOVE PANEL ② SOON AFTER THE START OF CONSTRUCTION.
5. SEE SPECIAL PROVISION FOR "TEMPORARY INFORMATION SIGNING" FOR ADDITIONAL INFORMATION.
6. ONE SIGN ASSEMBLY EQUALS 25.70 SQ. FT. (2.3 SQ. M.)
7. SHALL BE PAID FOR AS TEMPORARY INFORMATION SIGNING.

ALL DIMENSIONS ARE IN INCHES (MILLIMETERS) UNLESS OTHERWISE SHOWN.

MODEL: Default
 FILE NAME: p:\pub\mroom\dot\illinois\gov\pww\dot\Documents\DOT_Offices\Distric_1\Project\ID153120\CaddData\Design\Dist5.dgn

USER NAME = elkhatibaj	DESIGNED -	REVISED - R. MIRS 09-15-97
	DRAWN -	REVISED - R. MIRS 12-11-97
PLOT SCALE = 100,0000 ' / in.	CHECKED -	REVISED - T. RAMMACHER 02-02-99
PLOT DATE = 3/25/2021	DATE -	REVISED - C. JUCIUS 01-31-07

**STATE OF ILLINOIS
DEPARTMENT OF TRANSPORTATION**

**ARTERIAL ROAD
INFORMATION SIGN**

SCALE: NONE SHEET 1 OF 1 SHEETS STA. TO STA.

F.A.U. RTE.	SECTION	COUNTY	TOTAL SHEETS	SHEET NO.
1581	2020-131-I	COOK	20	17
TC-22			CONTRACT NO. 62M09	
ILLINOIS FED. AID PROJECT				

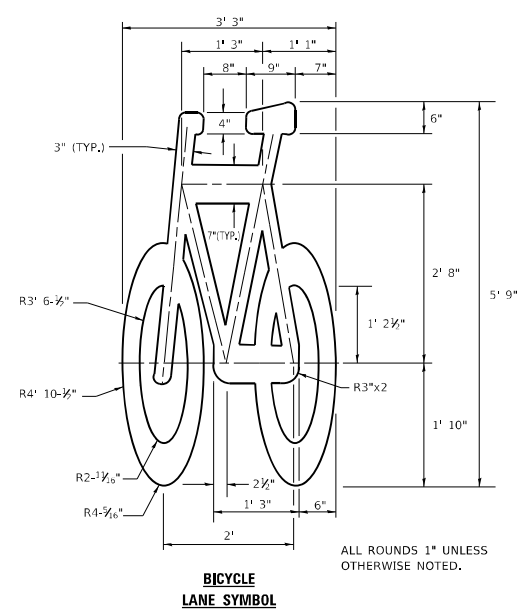
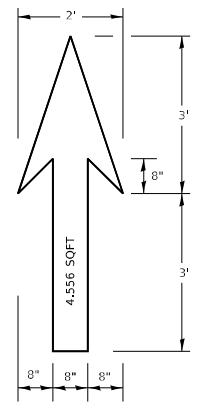

- NOTE:
- FOR BIKE LANE SYMBOLS ONLY, USE PRE-FORMED THERMOPLASTIC WITH A MINIMUM THICKNESS OF 90 MILS, MINIMUM SKID RESISTANCE VALUE OF 60 BPN, & A MINIMUM INDEX OF REFRACTION OF 1.50.
 - THE RESIDENT ENGINEER SHALL CONTACT MR. BEN GOMBERG AT 312-744-8093 AT LEAST ONE CALENDAR WEEK PRIOR TO INSTALLING BIKE LANE SYMBOLS.

TYPICAL BIKE LANE SYMBOLS
DRAWING #28

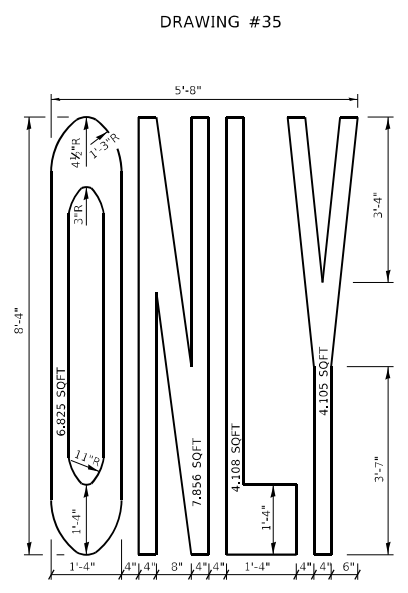
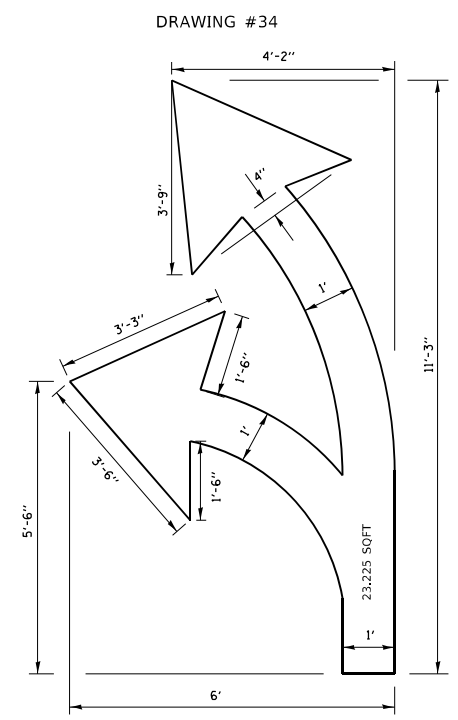
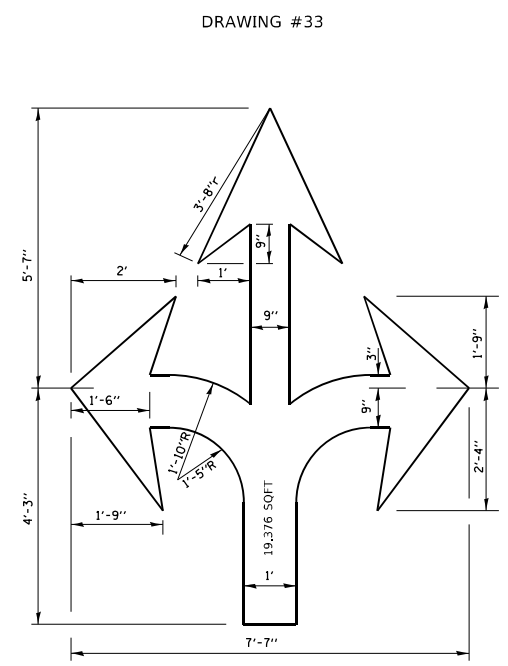
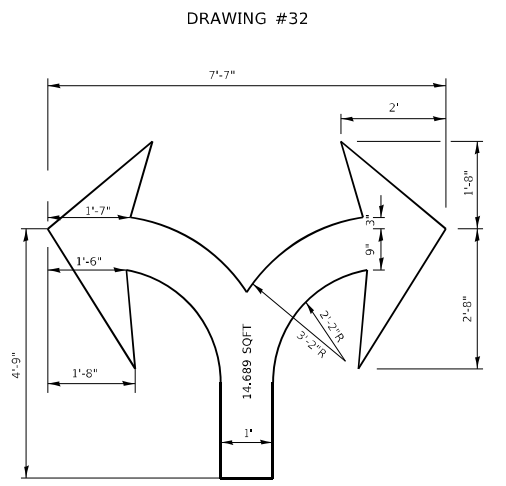
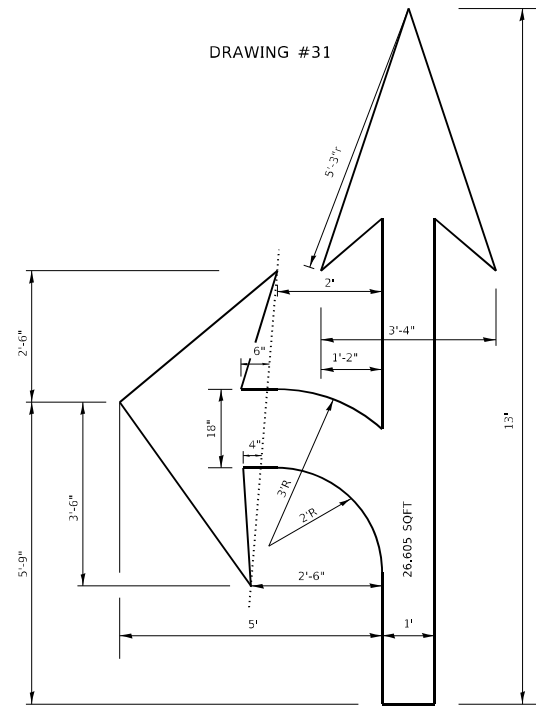
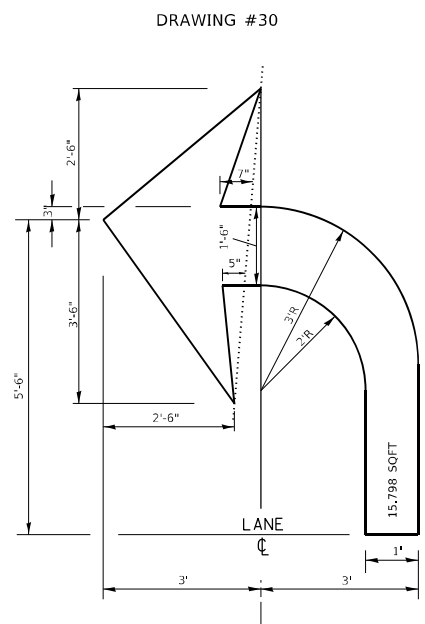
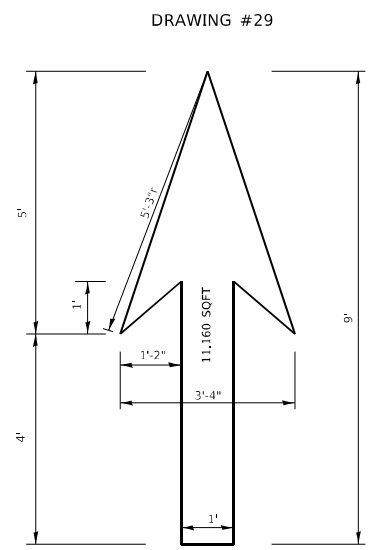

NOTE:
ALL MARKINGS SHALL BE SOLID WHITE UNLESS OTHERWISE NOTED IN THE PLANS

MODEL: Default
FILE NAME: p:\planningroom\dot\illinois\dot\Documents\DOT_Office\Drawings\1\Projects\153120\CaddData\Design\DS153120.dgn

USER NAME = elkhatibaj	DESIGNED -	REVISED - T. RAMMACHER 12-07-00
PLOT SCALE = 100,0000' / in.	DRAWN -	REVISED -
PLOT DATE = 3/25/2021	CHECKED -	REVISED -
	DATE -	REVISED -

STATE OF ILLINOIS
DEPARTMENT OF TRANSPORTATION

CITY OF CHICAGO TYPICAL PAVEMENT MARKINGS			
SCALE: NONE	SHEET 2	OF 3 SHEETS	STA. TO STA.

F.A.U. RTE.	SECTION	COUNTY	TOTAL SHEETS	SHEET NO.
1581	2020-131-I	COOK	20	19
TC-24		CONTRACT NO. 62M09		
ILLINOIS FED. AID PROJECT				

MODEL: Default
 FILE NAME: p:\u0026amp;room.dwg
 PROJECT: I:\Projects\153120\CADDData\Design\DIS54.dgn

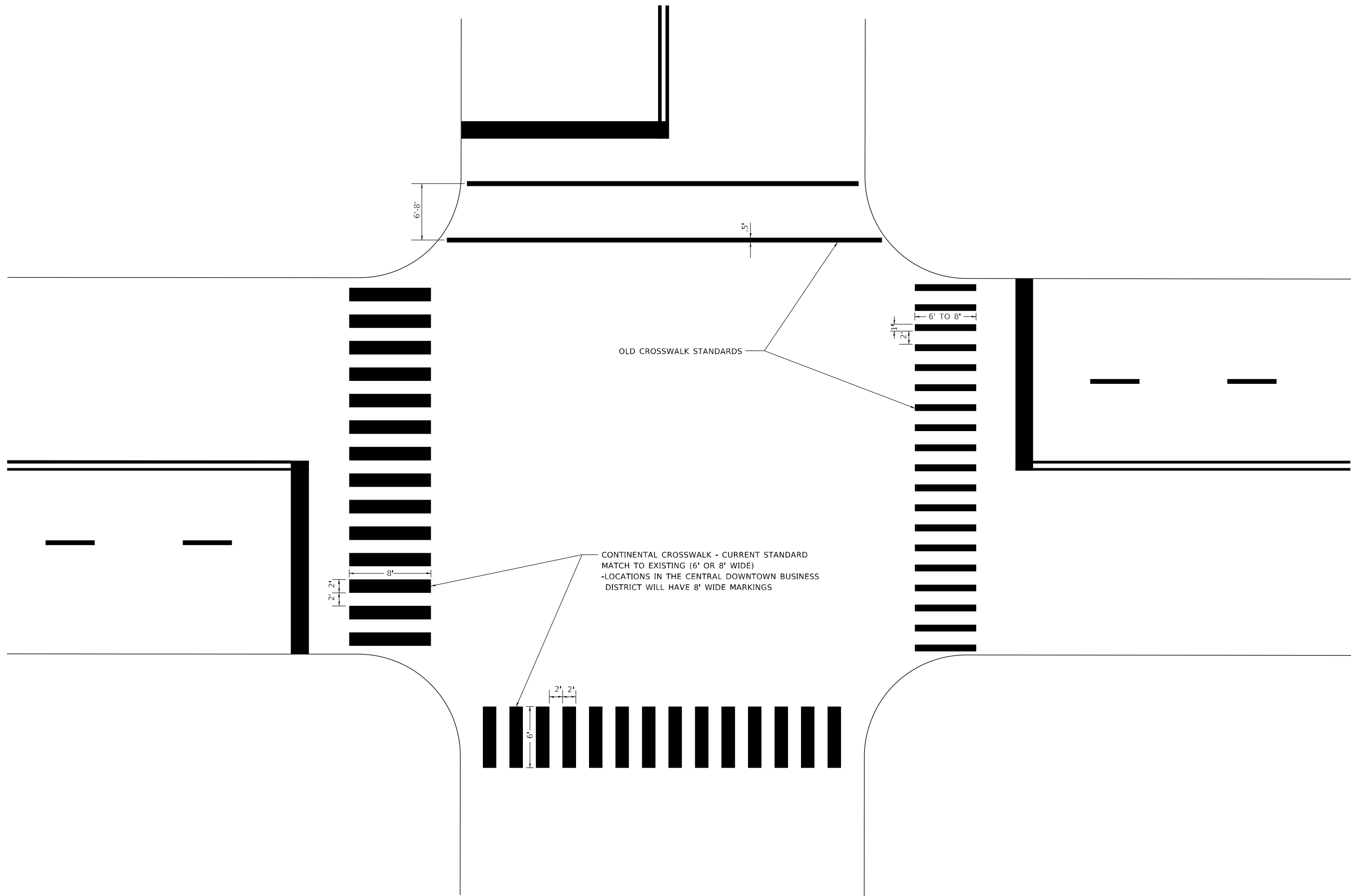

USER NAME = elknatibaj	DESIGNED -	REVISED - T. RAMMACHER 12-07-00
	DRAWN -	REVISED -
PLOT SCALE = 100,0000 ' / in.	CHECKED -	REVISED -
PLOT DATE = 3/25/2021	DATE -	REVISED -

**STATE OF ILLINOIS
 DEPARTMENT OF TRANSPORTATION**

**CITY OF CHICAGO
 TYPICAL PAVEMENT MARKINGS**

SCALE: NONE SHEET 3 OF 3 SHEETS STA. TO STA.

F.A.U. RTE.	SECTION	COUNTY	TOTAL SHEETS	SHEET NO.
1581	2020-131-I	COOK	20	20
TC-24			CONTRACT NO. 62M09	
ILLINOIS FED. AID PROJECT				