

06-11-2021 LETTING ITEM 134

STATE OF ILLINOIS
 DEPARTMENT OF TRANSPORTATION
PLANS FOR PROPOSED SIDEWALK

ALLEN ROAD & ORANGE PRAIRIE ROAD
 CITY OF PEORIA
 SECTION 19-00384-00-SW
 PROJECT NO. APRV(361)
 PEORIA COUNTY, ILLINOIS
 C-94-063-20

F.A. RITE	SECTION	COUNTY	TOTAL SHEETS	SHEET NO.
---	19-00384-00-SW	PEORIA	16	1
ILLINOIS	CONTRACT NO. 89785		NAME: G001	

INDEX OF SHEETS

- 1 COVER SHEET
- 2 SUMMARY OF QUANTITIES & GENERAL NOTES
- 3 SCHEDULE OF QUANTITIES
- 4 TYPICAL SECTIONS
- 5-7 PLAN AND PROFILE SHEETS
- 8-9 ADA DETAIL SHEETS
- 10-16 CROSS SECTION SHEETS

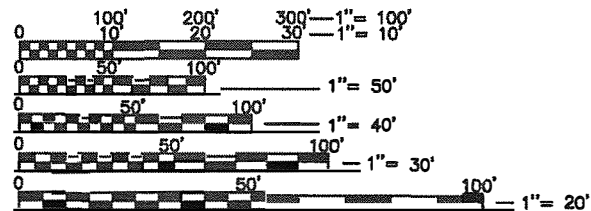
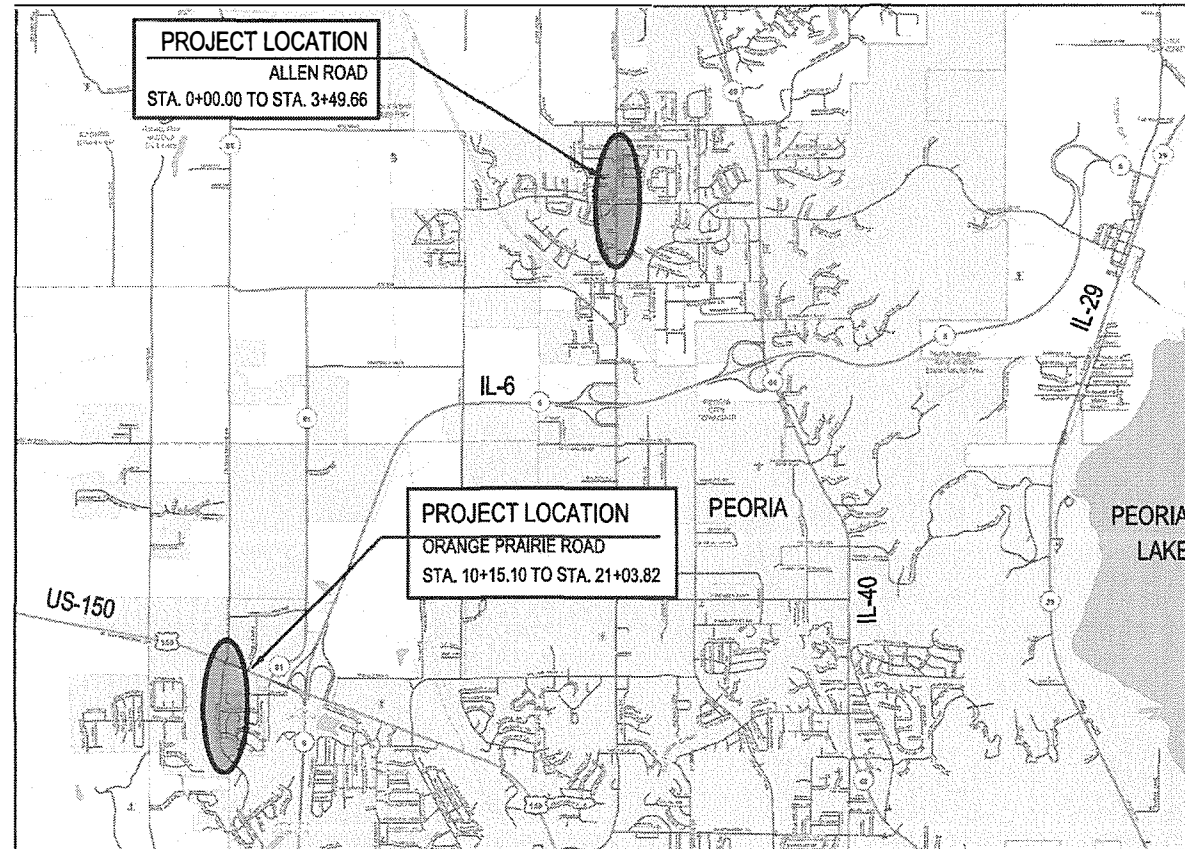
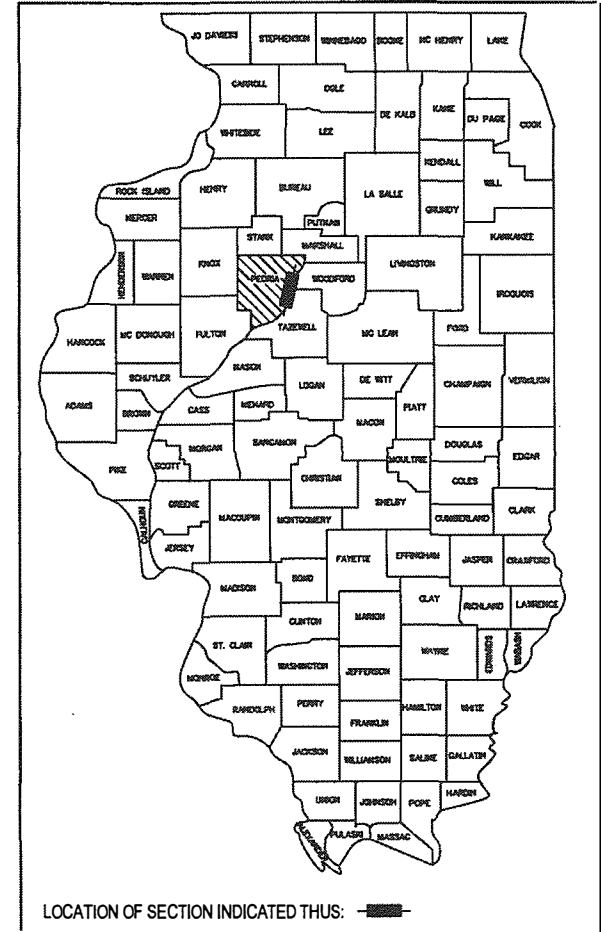

FULL SIZE PLANS HAVE BEEN PREPARED USING STANDARD ENGINEERING SCALES. REDUCED SIZED PLANS WILL NOT CONFORM TO STANDARD SCALES. IN MAKING MEASUREMENTS ON REDUCED PLANS, THE ABOVE SCALES MAY BE USED.

J.U.L.I.E.
 JOINT UTILITY LOCATING INFORMATION FOR EXCAVATION
 1-800-892-0123
 811 OR

LOCATION MAP



GROSS LENGTH = 1438.38 FT. = 0.272 MI.
 NET LENGTH = 1438.38 FT. = 0.272 MI.

CATALOG NO. 036036-00D
 CONTRACT NO. 89785

AGENCY RESPONSIBLE FOR LETTING

APPROVED March 10 20 21
[Signature]
 LOCAL AGENCY, POSITION

PASSED 03.29 20 21
[Signature]
 DISTRICT ENGINEER, LOCAL ROADS & STREETS

RELEASING FOR BID
 BASED ON LIMITED REVIEW March 29 20 21
[Signature]
 REGION 3 ENGINEER

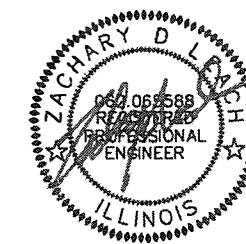

I hereby certify that this Engineering document was prepared by me or under my direct personal supervision and that I am a duly licensed Professional Engineer under the laws of the State of Illinois.

[Signature] 03-08-21
 Signature Date

Zachary D. Leach
 Printed or Typed Name License Number 062-065588

My license renewal date is November 30, 2021

PRINTED BY THE AUTHORITY
 OF THE STATE OF ILLINOIS

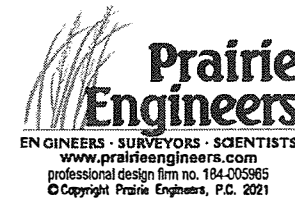

MAY 08, 2021 5:12 PM ZLEACH I:\J065\2018\121.1802\CITY OF PEORIA ENGINEERING RETAINER\WORK ORDER 2\DRAWINGS\SHEETS\ALLEN & ORANGE PRAIRIE\G001_121.1802.02B.DWG

REMOVALS

LOCATION		44000500 COMBINED CURB & GUTTER REMOVAL	44000600 SIDEWALK REMOVAL
STA. FROM	STA. TO	FOOT	SQ FT
ALLEN ROAD			
0+00.00	0+18.00	-	182.2
0+02.74	0+11.90	12.0	
3+44.5	3+50.00		29.5
ORANGE PRAIRIE ROAD			
10+39.68	10+43.16	15.2	
10+98.05	11+01.59	19.8	-
20+81.75	20+84.45	11.0	
TOTAL		58.0	211.7
USE		58	212

PAVING

LOCATION		35101600 AGG. BASE COURSE, TYPE B, 4"	42400200 P.C.C. SIDEWALK, 5"	42400800 DETECTABLE WARNINGS	60605000 COMB. CC&G TB6.24
STA. FROM	STA. TO	SQ YD	SQ FT	SQ FT	FOOT
ALLEN ROAD					
0+00.00	3+49.66	232.2	1846.4	11.0	-
0+02.74	0+12.11	-	-	-	11.7
ORANGE PRAIRIE ROAD					
10+15.10	10+39.68	15.2	117.6	10.0	-
10+39.68	10+43.16	-	-	-	15.2
10+98.05	11+01.59	-	-	-	19.5
11+01.59	20+81.75	617.6	4875.5	20.0	-
20+81.75	20+84.45	-	-	-	11.1
TOTAL		865.0	6839.5	41.0	57.5
USE		865	6840	41	58

EROSION CONTROL

LOCATION		25000100 SEEDING, CLASS 1	25000400 NITROGEN FERTILIZER NUTRIENT	25000500 PHOSPHOROUS FERTILIZER NUTRIENT	25000600 POTASSIUM FERTILIZER NUTRIENT	25100115 MULCH, METHOD 2	28000250 TEMP. EROSION CONTROL SEEDING	28000400 PERIMETER EROSION BARRIER
STA. FROM	STA. TO	ACRE	POUND	POUND	POUND	ACRE	POUND	EACH
+00	3+49.66	0.10	8.6	8.6	8.6	0.10	9.5	349.0
10+15.10	10+39.68	0.01	1.1	1.1	1.1	0.01	1.2	25.0
11+01.59	20+81.75	0.26	23.3	23.3	23.3	0.26	25.8	981.0
TOTAL		0.37	33.0	33.0	33.0	0.37	36.5	1355.0
USE		0.4	35	35	35	0.4	40	1360

PAVEMENT MARKING

LOCATION				78001130 PAINT PAVEMENT MARKING LINE 6" WHITE SOLID	78001180 PAINT PAVEMENT MARKING LINE 24" WHITE SOLID
STA. FROM	O/S	STA. TO	O/S	FOOT	FOOT
ORANGE PRAIRIE ROAD					
10+43.16	0.5 RT.	10+98.05	0.5 RT.	56.0	79.0
10+43.16	5.5 LT.	10+98.05	5.5 LT.	69.0	
20+84.45	0.5 RT.	21+03.82	0.5 RT.	20.0	24.0
20+84.45	5.5 LT.	21+03.82	5.5 LT.	20.0	
TOTAL				165.0	103.0
USE				165.0	103.0

EARTHWORK

LOCATION		CUT	CUT (CY) INCL. 25% SHRINKAGE)	FILL (CY)	FURNISHED EXCAVATION (CY)
STA. FROM - STA. TO	CU YD	CU YD	CU YD	CU YD	CU YD
ALLEN ROAD					
0+00.00	3+50.09	9.4	7.1	4.4	-2.7
ORANGE PRAIRIE ROAD					
10+15.10	10+43.92	0.8	0.6	0.1	-0.5
11+00.47	20+88.02	17.0	12.7	33.2	20.5
TOTAL		27.2	20.4	37.7	17.3
USE		27.0	20.0	38.0	18.0

UTILITY ADJUSTEMENT

LOCATION		60255500 MANHOLES TO BE ADJUSTED	60266600 VALVE BOX TO BE ADJUSTED
STATION	O/S	FOOT	SQ FT
11+17.40	1.6 LT.		1
11+93.64	4.3 LT.	1	
13+39.69	4.2 LT.	1	
TOTAL		2	1

TREE REMOVAL

LOCATION			20100110 TREE REMOVAL (6 TO 15 UNITS DIAMETER)	20100210 TREE REMOVAL (OVER 15 UNITS DIAMETER)
STATION	O/S	UNIT	UNIT	UNIT
TO	FROM			
19+80.00	20+22.00	RT.	48.00	18.00
TOTAL			48.00	18.00

APPLICATION RATES:
 NITROGEN FERTILIZER = 90 LB/ACRE
 PHOSPHOROUS FERTILIZER = 90 LB/ACRE
 POTASSIUM FERTILIZER = 90 LB/ACRE
 MULCH, METHOD 2 = 100 LB/ACRE

APR 08, 2021 11:04 AM ZLEACH
 I:\JOSY\2018\1211802 CITY OF PEORIA ENGINEERING RETAINER\WORK ORDER 2\DRAWINGS\1211802\02B REV.DWG

F.A. RTE.	SECTION	COUNTY	TOTAL SHEETS	SHEET NO.
---	19-00384-00-SW	PEORIA	16	4
ILLINOIS	CONTRACT NO. 89785		NAME: C101	

① TYPICAL SECTION ALLEN RD.
SIDEWALK IMPROVEMENTS

STATION TO STATION
0+00.00 - 0+29.44 (ALLEN RD.)

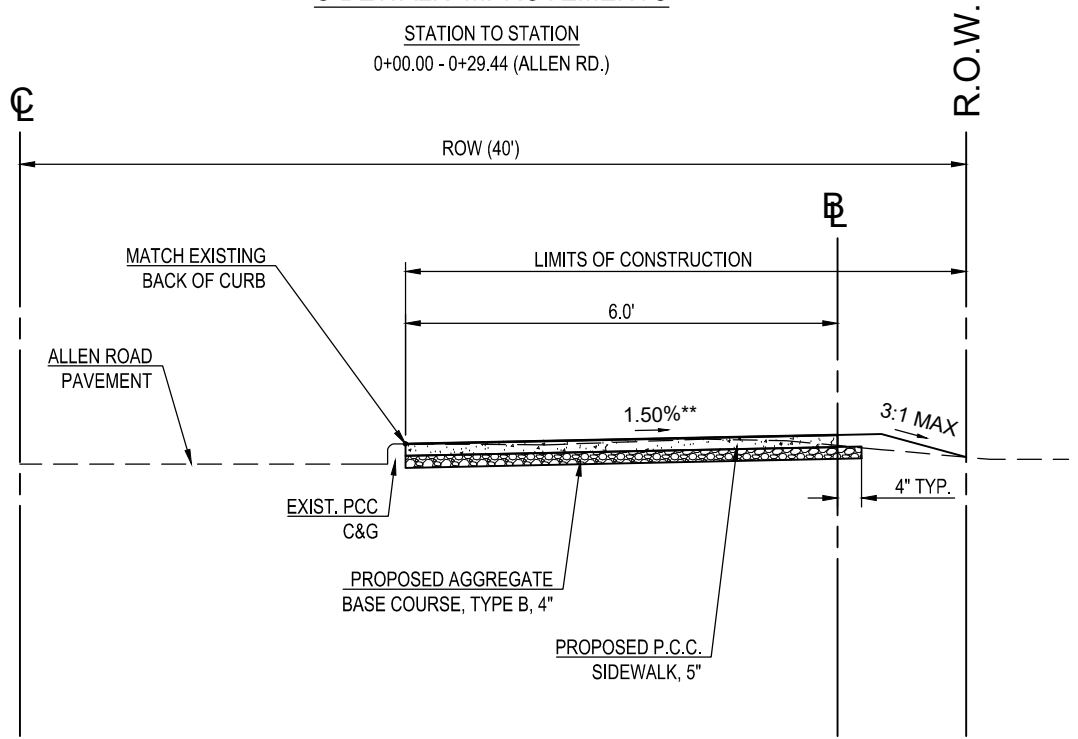

② TYPICAL SECTION ALLEN RD. / ORANGE PRAIRIE RD.
SIDEWALK IMPROVEMENTS

STATION TO STATION
0+29.44 - 3+49.66 (ALLEN RD.)

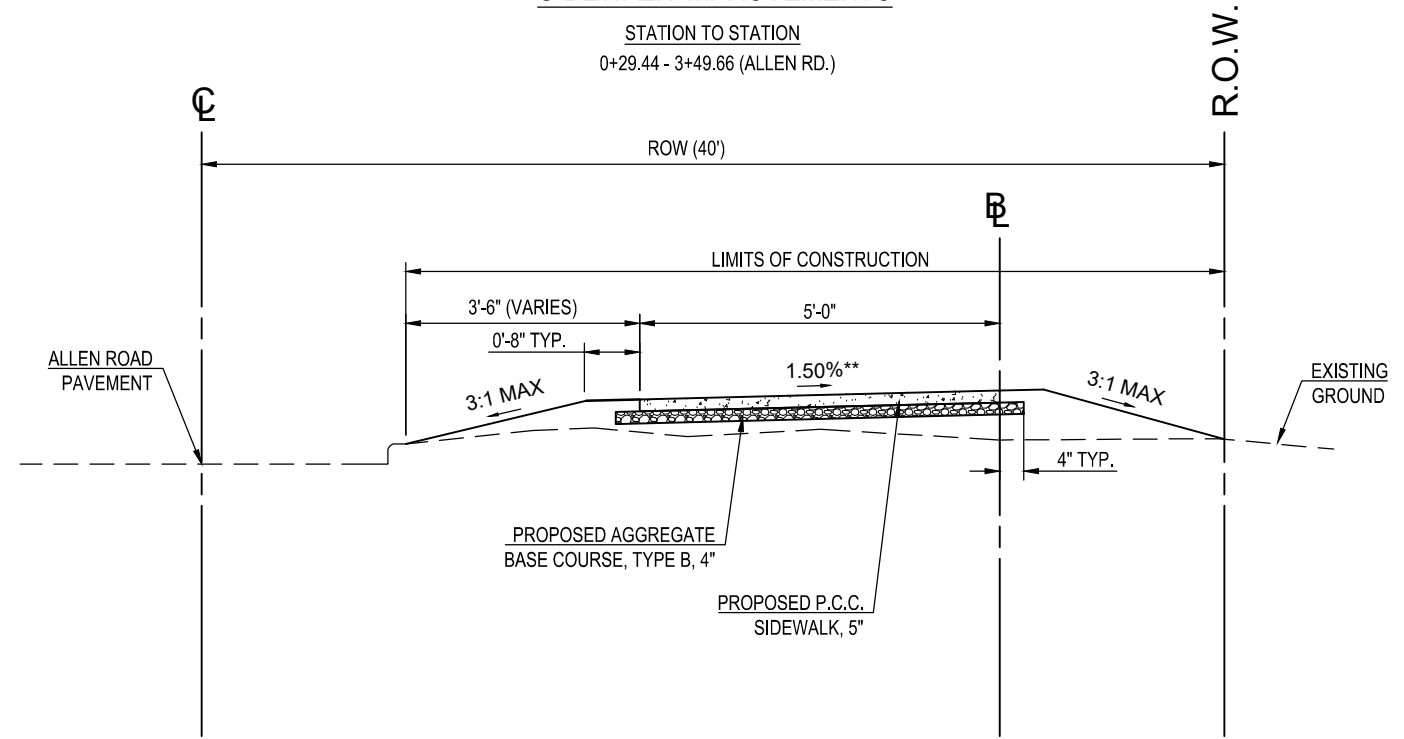

③ TYPICAL SECTION ALLEN RD. / ORANGE PRAIRIE RD.
SIDEWALK IMPROVEMENTS

STATION TO STATION
10+15.10 - 10+39.68 (ORANGE PRAIRIE RD.)*
11+01.59 - 20+81.75 (ORANGE PRAIRIE RD.)

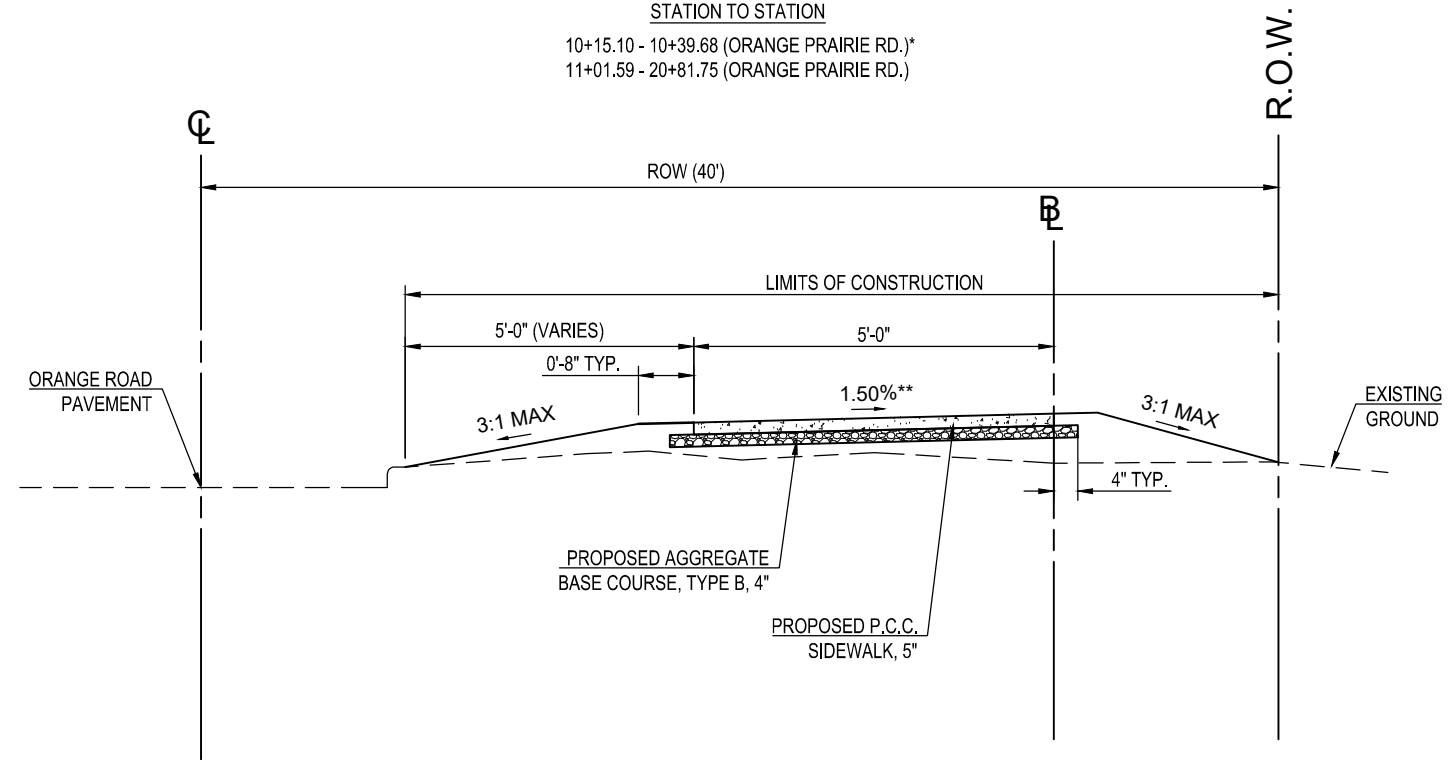

*SIDEWALK OMISSION
STA. 10+39.68 TO STA. 11+01.59
(CROSS WALK AT LANDENS WAY)

**2.0% MAX SIDEWALK CROSS SLOPE

MAR 08, 2021 5:17 PM ZLEACH
I:\JOBS\2018\211802 CITY OF PEORIA ENGINEERING RETAINER\WORK ORDER 2\DRAWINGS\SHEET\B-ALLEN & ORANGE PRAIRIE\C101_121.1802.02B.DWG

F.A. RTE.	SECTION	COUNTY	TOTAL SHEETS	SHEET NO.
ILLINOIS	19-00384-00-SW	PEORIA	16	5
CONTRACT NO. 89785			NAME: C301	

MBR_08_2021_5:19 PM ZLEACH
 I:\JOBS\2018\1211802 CITY OF PEORIA ENGINEERING RETAINER\WORK ORDER 2\DRAWINGS\1211802_PRAIRIE\C301_1211802.02B.DWG

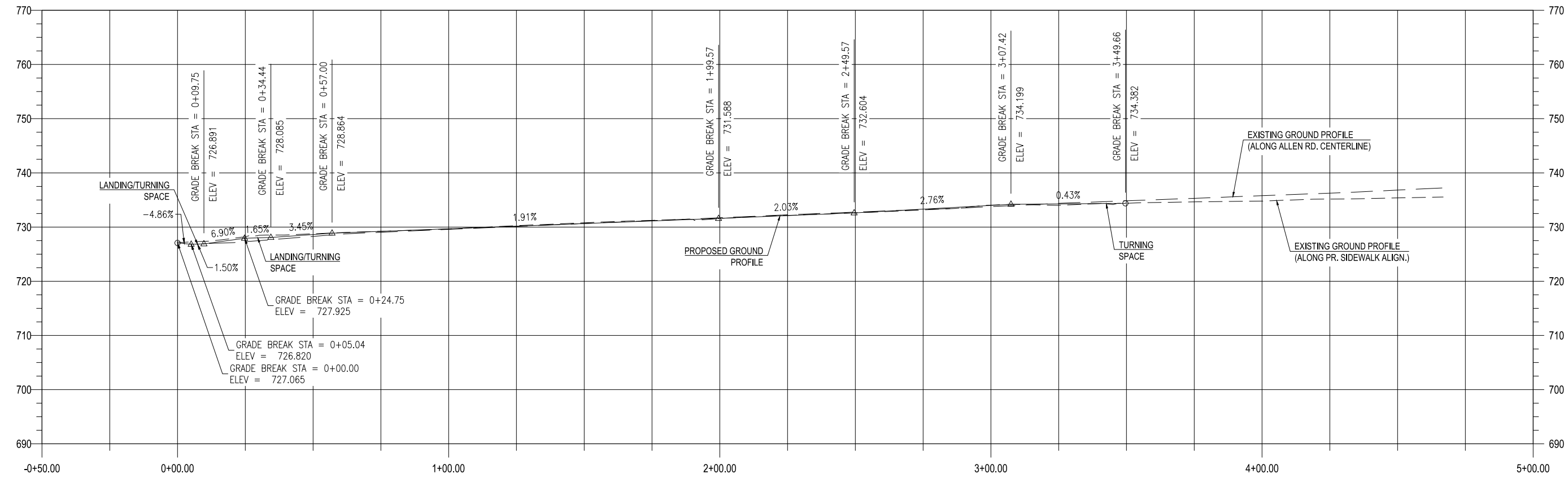
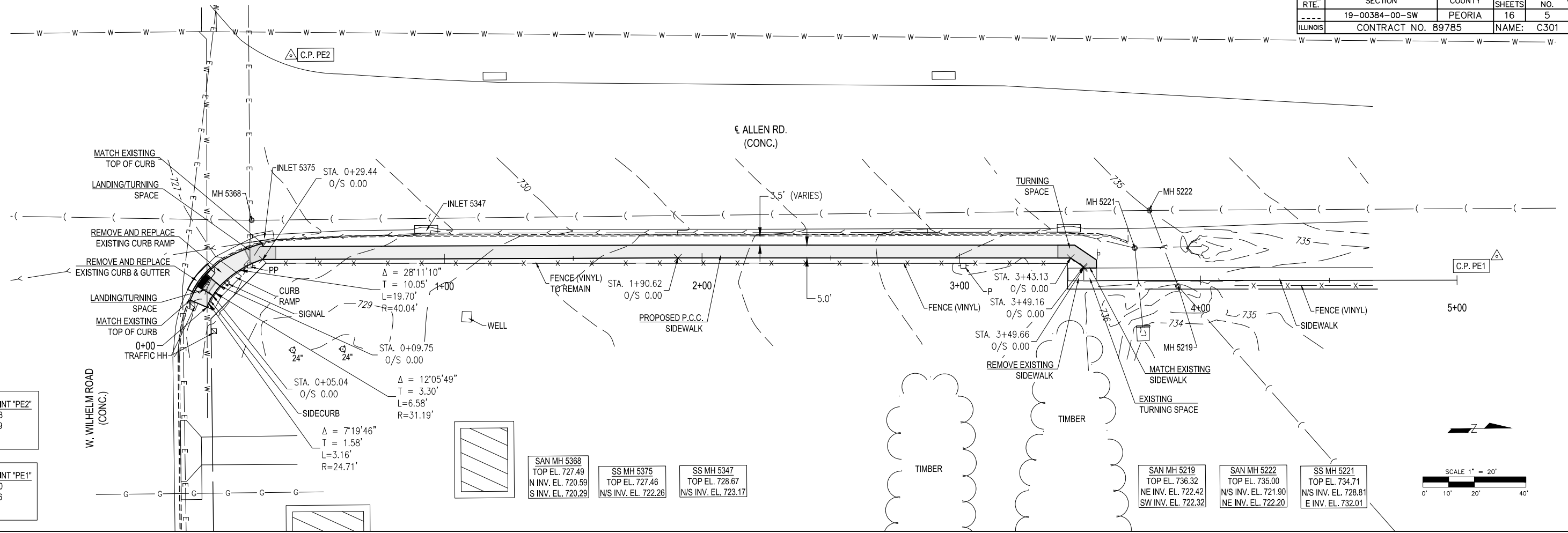

F.A. RTE.	SECTION	COUNTY	TOTAL SHEETS	SHEET NO.
---	19-00384-00-SW	PEORIA	16	6
ILLINOIS	CONTRACT NO. 89785		NAME: C302	

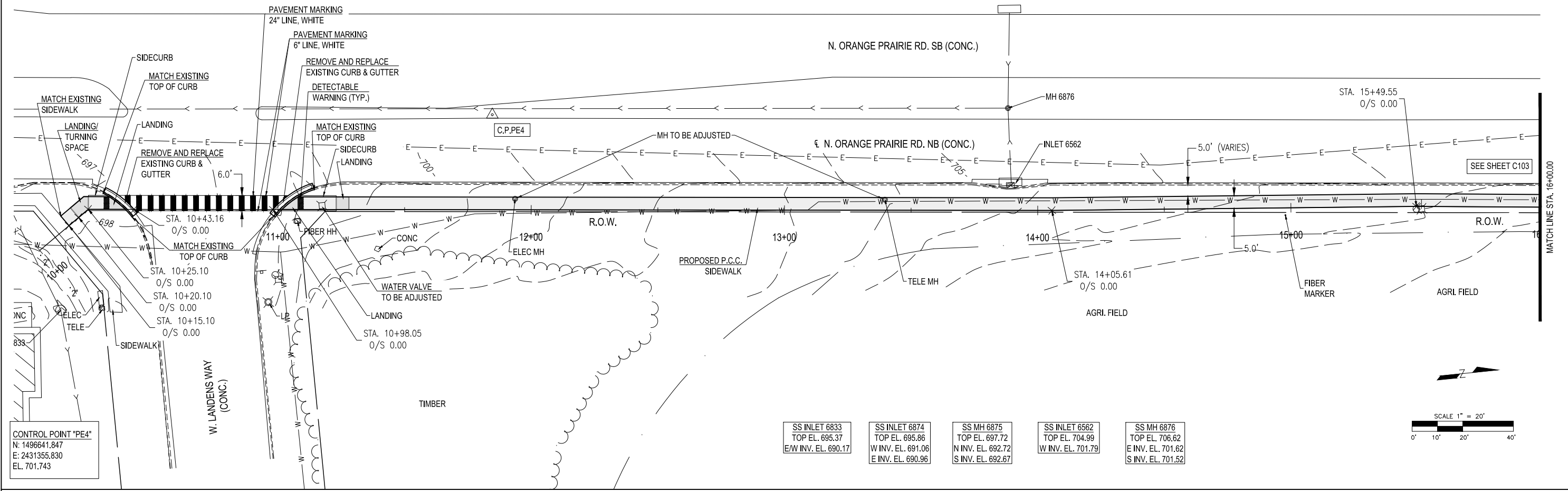

CONTROL POINT "PE4"
 N: 1496641.847
 E: 2431355.830
 EL: 701.743

SS INLET 6833 TOP EL. 695.37 E/W INV. EL. 690.17	SS INLET 6874 TOP EL. 695.86 W INV. EL. 691.06 E INV. EL. 690.96	SS MH 6875 TOP EL. 697.72 N INV. EL. 692.72 S INV. EL. 692.67	SS INLET 6562 TOP EL. 704.99 W INV. EL. 701.79	SS MH 6876 TOP EL. 706.62 E INV. EL. 701.62 S INV. EL. 701.52
--	---	--	--	--

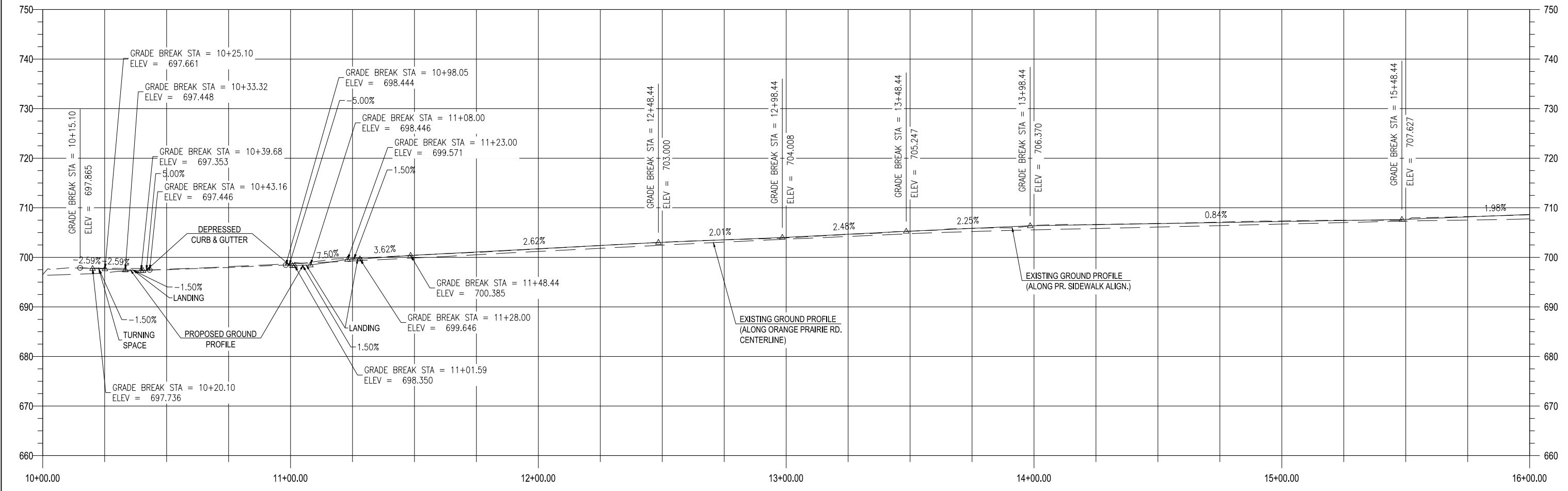
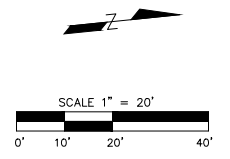

MBR_08_2001_5:19 PM ZLEACH
 I:\PROJECTS\2018\1211802\CITY OF PEORIA ENGINEERING RETAINER\WORK ORDER 2\DRAWINGS\1211802_C301_1211802_02B.DWG

F.A. RTE.	SECTION	COUNTY	TOTAL SHEETS	SHEET NO.
ILLINOIS	19-00384-00-SW	PEORIA	16	7
CONTRACT NO. 89785			NAME: C303	

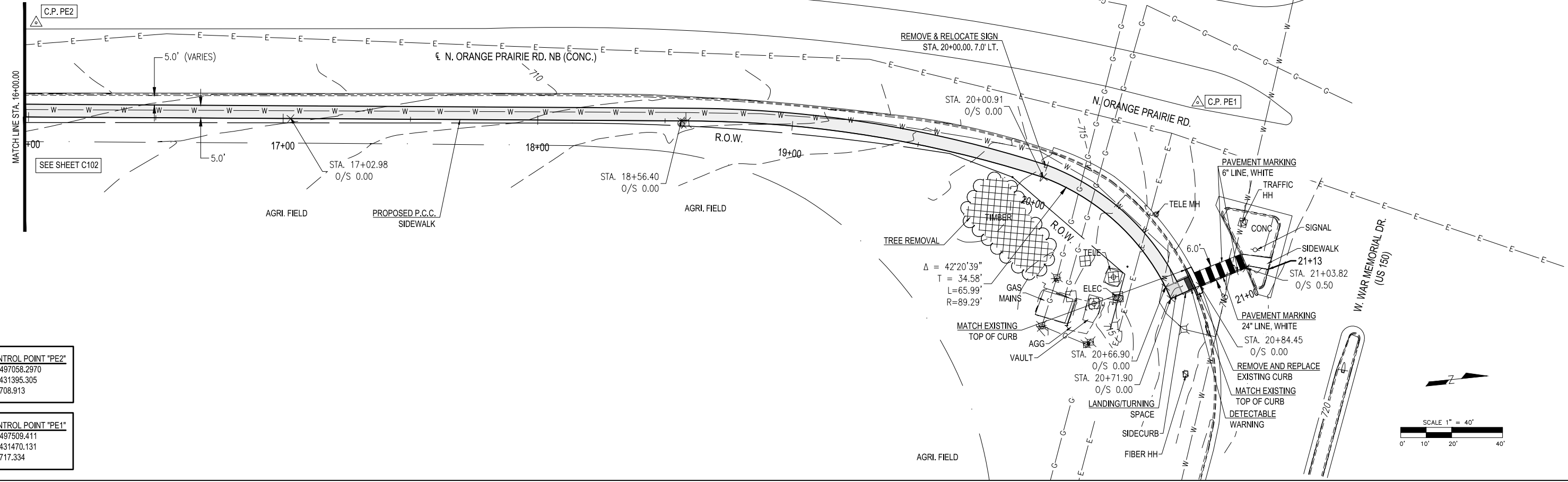

CONTROL POINT "PE2"
 N: 1497058.2970
 E: 2431395.305
 EL. 708.913

CONTROL POINT "PE1"
 N: 1497509.411
 E: 2431470.131
 EL. 717.334

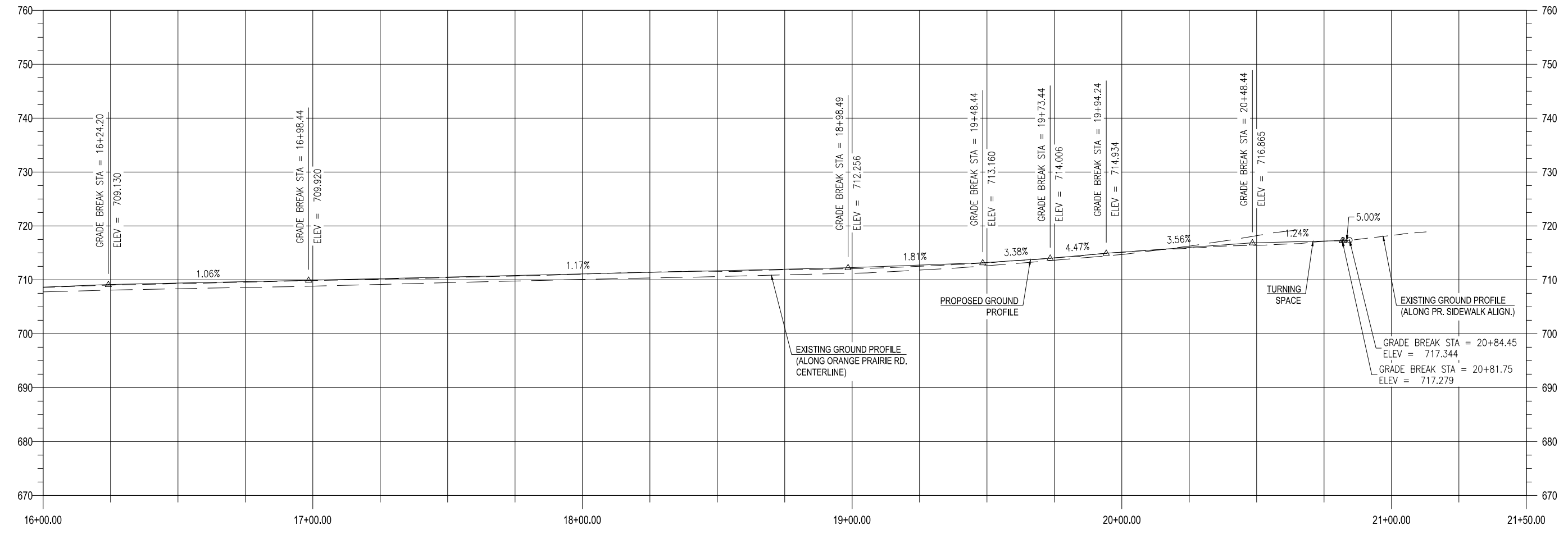
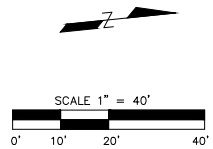

MBR_08_2021_5:19 PM ZLEACH
 I:\VOS\2018\1211802 CITY OF PEORIA ENGINEERING RETAINERS\WORK ORDER 2\DRAWINGS\211802\1211802.02B.DWG

F.A. RTE.	SECTION	COUNTY	TOTAL SHEETS	SHEET NO.
---	19-00384-00-SW	PEORIA	16	8
ILLINOIS	CONTRACT NO. 89785		NAME: C401	

NOTE:
THE SIDEWALK BETWEEN STA. 10+15.10 AND STA. 10+20.10 IS A SIDEWALK TRANSITION, THEREFORE AN MEP IS NOT REQUIRED.

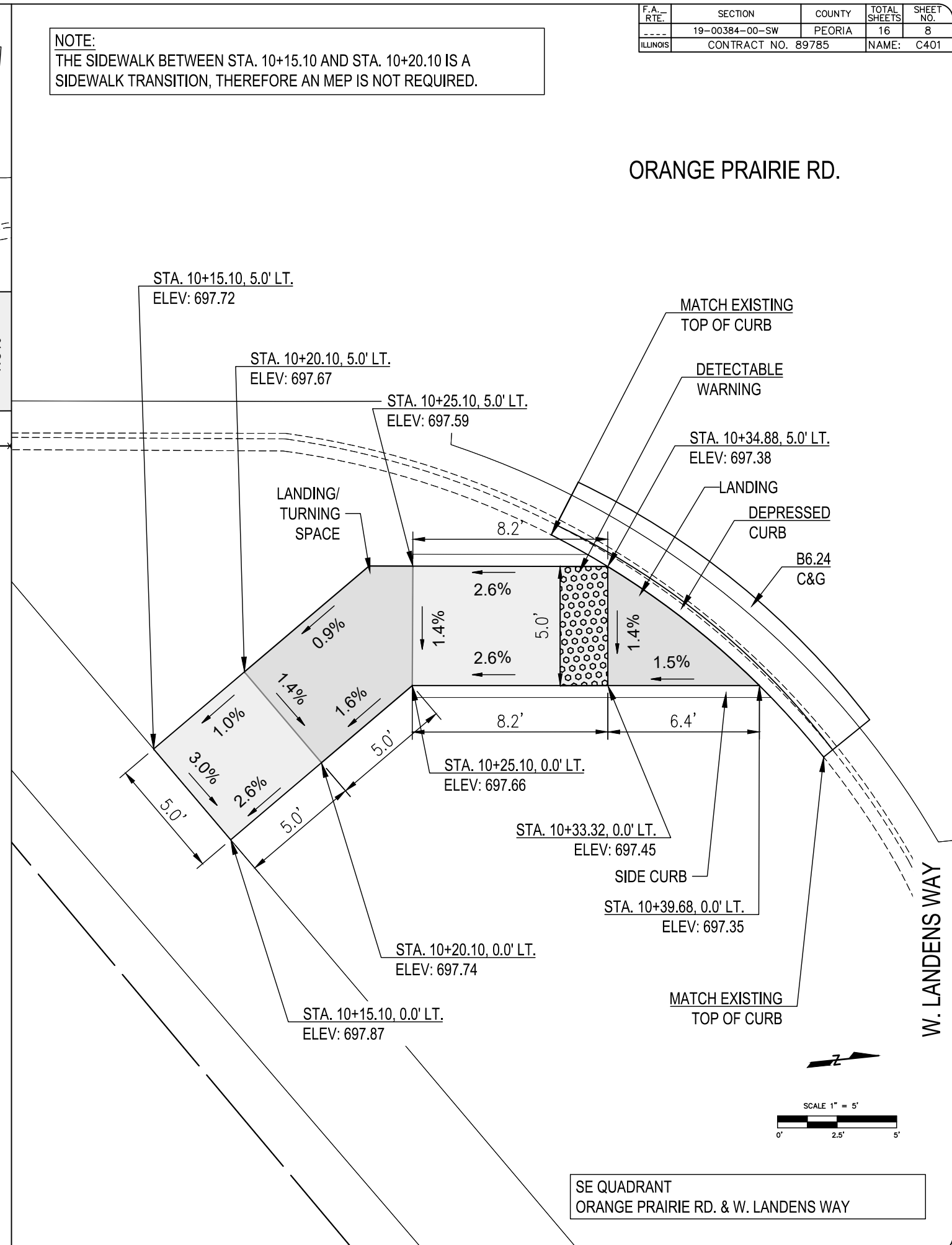
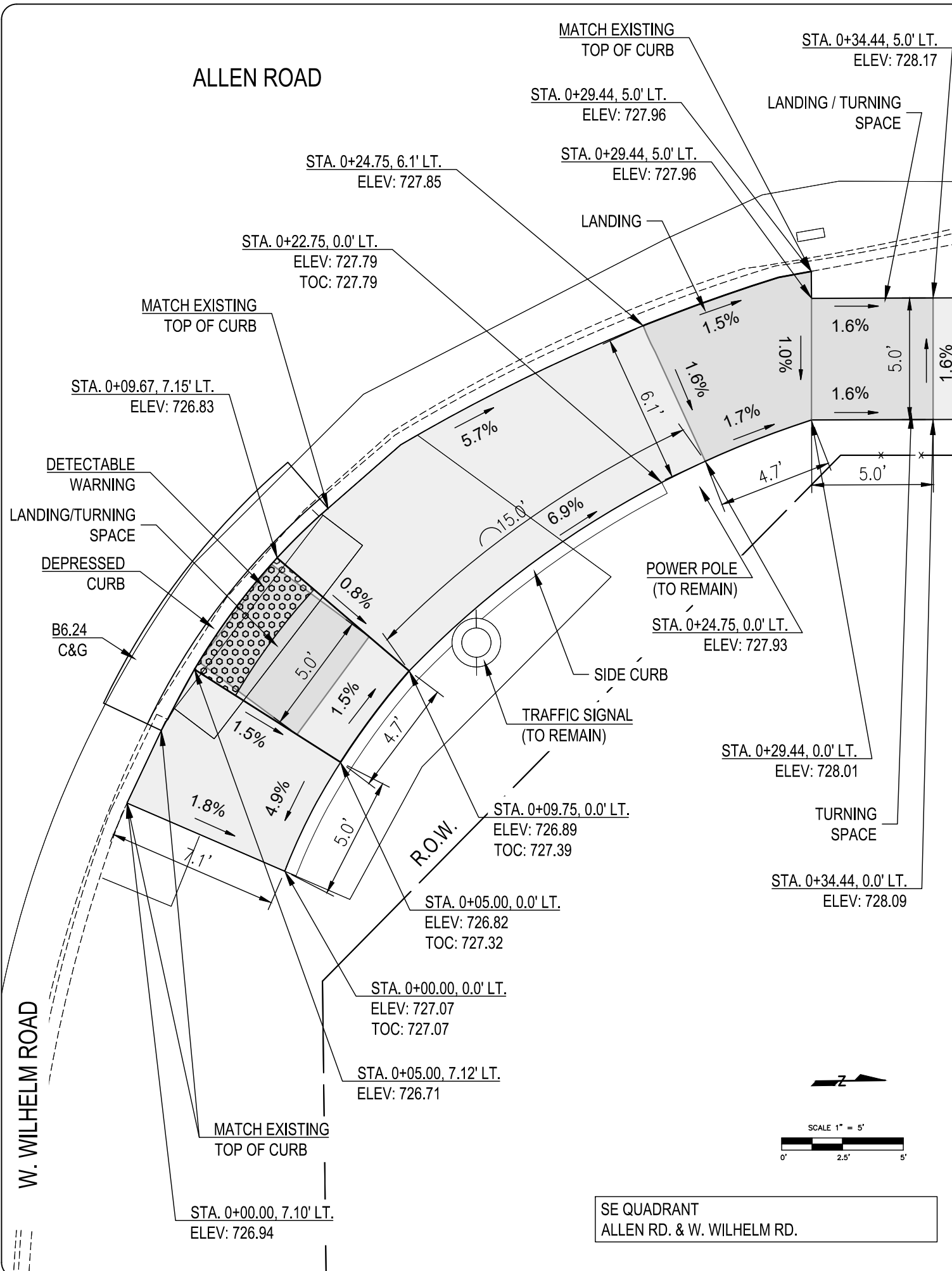

MBR 08 2021 5:20 PM ZLEACH
 I:\PROJECTS\2018\1211802 CITY OF PEORIA ENGINEERING RETAINER\WORK ORDER 2\DRAWINGS\2\SHEET\B-ALLEN & ORANGE PRAIRIE\C401_1211802_02B.DWG

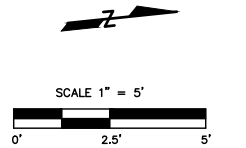
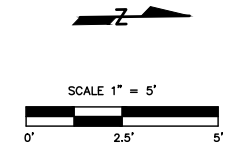

F.A. RTE.	SECTION	COUNTY	TOTAL SHEETS	SHEET NO.
---	19-00384-00-SW	PEORIA	16	9
ILLINOIS	CONTRACT NO. 89785		NAME: C402	

ORANGE PRAIRIE RD.

ORANGE PRAIRIE RD.

MAR 08, 2021 5:21 PM ZLEACH
 I:\JOBS\2018\1211802 CITY OF PEORIA ENGINEERING RETAINER\WORK ORDER 2\DRAWINGS\SHEET\B-ALLEN & ORANGE PRAIRIE\C401_121.1802.02B.DWG

W. LANDENS WAY

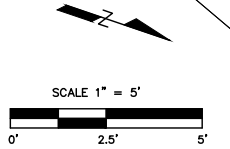
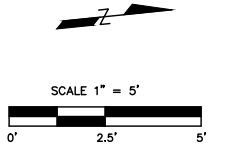
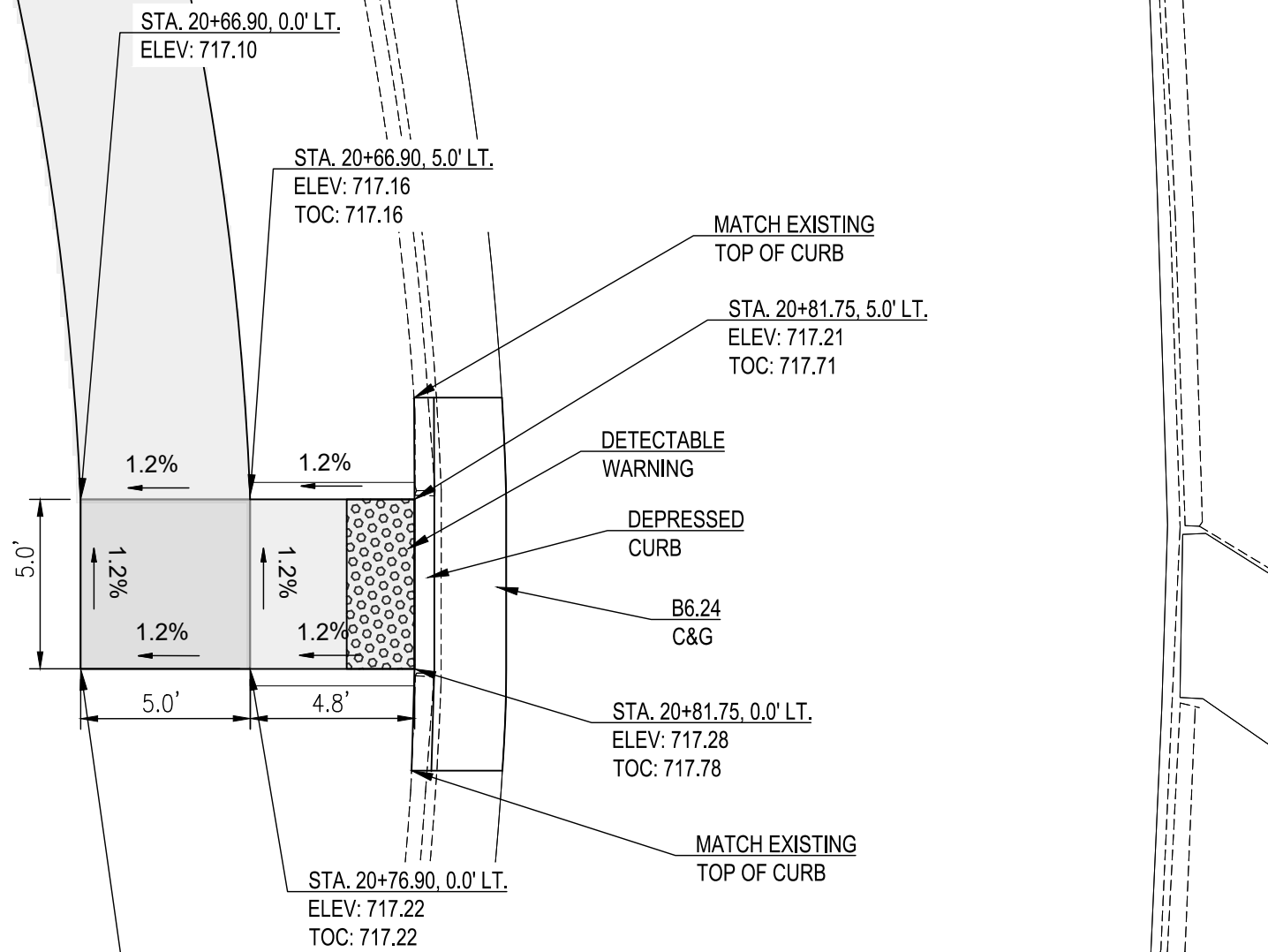
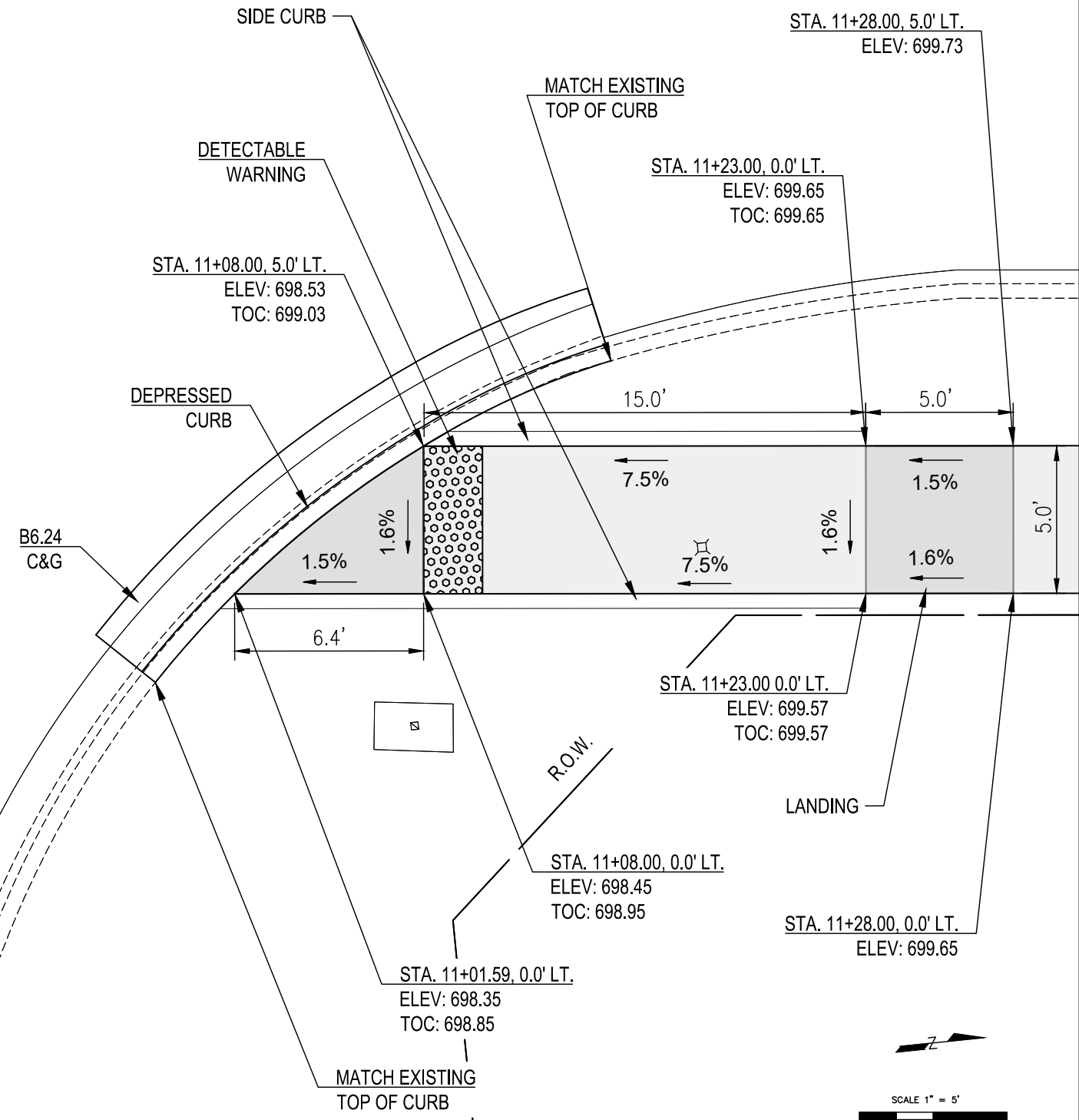

NE QUADRANT
ORANGE PRAIRIE RD. & LANDENS WAY

SE QUADRANT
ORANGE PRAIRIE RD. & US 150 (W. WAR
MEMORIAL DRIVE)

F.A. RTE.	SECTION	COUNTY	TOTAL SHEETS	SHEET NO.
----	19-00384-00-SW	PEORIA	16	10
ILLINOIS			CONTRACT NO. 89785	NAME: C501

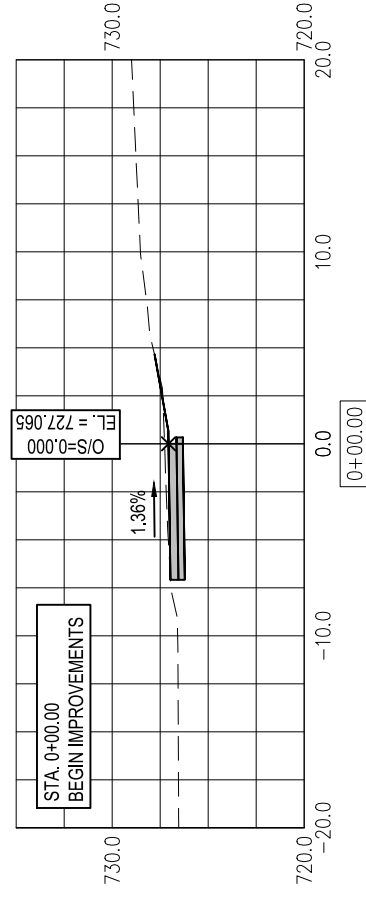
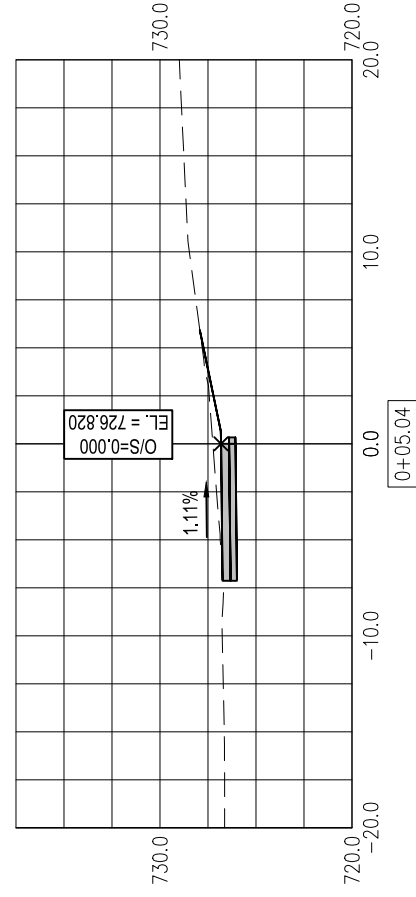
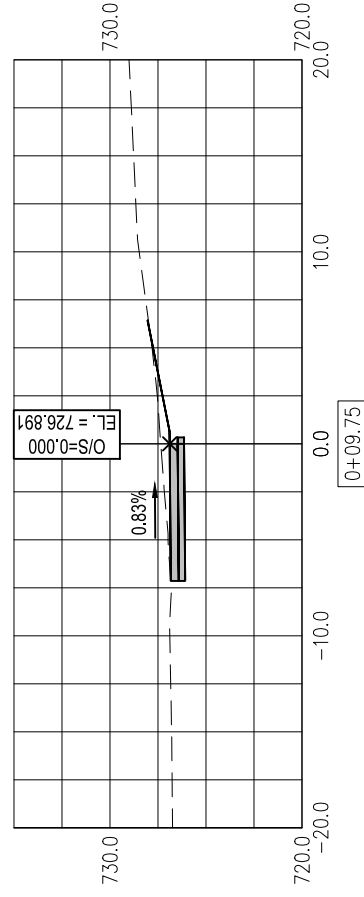
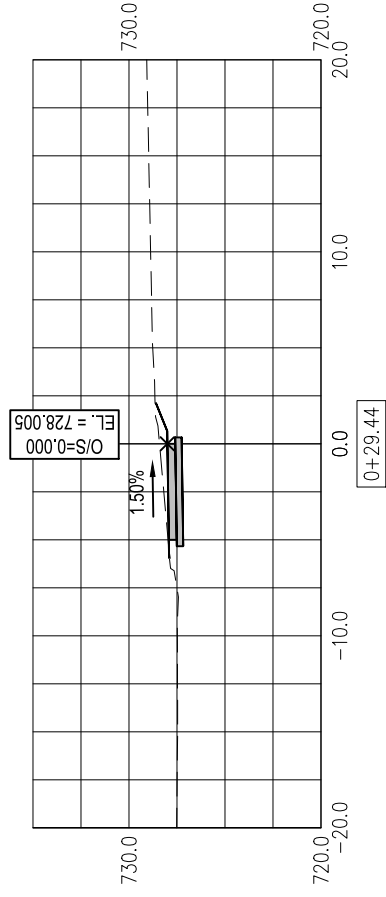
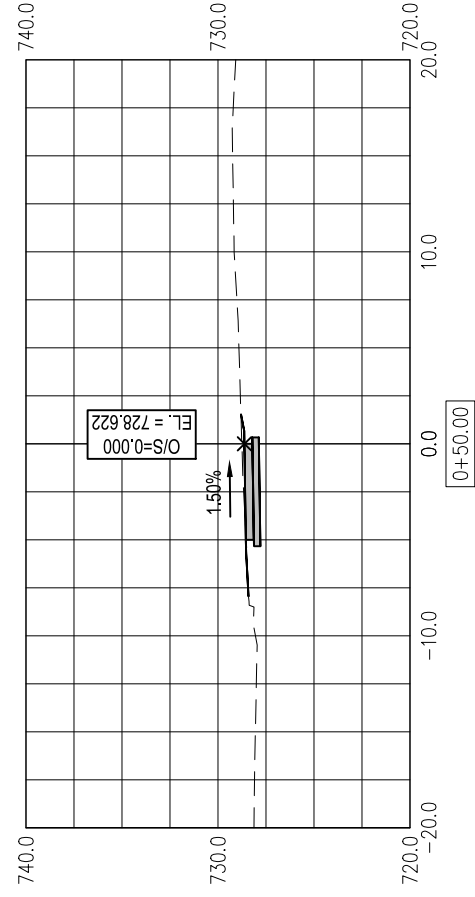
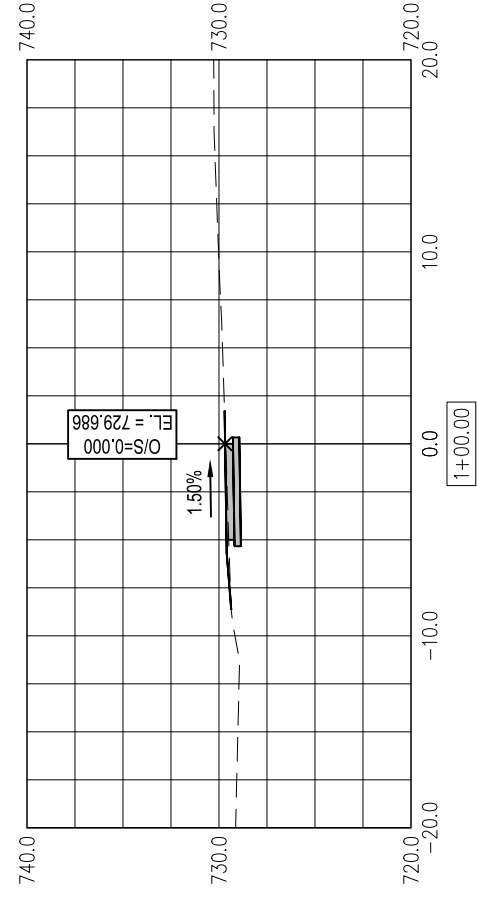

F.A. RTE.	SECTION	COUNTY	TOTAL SHEETS	SHEET NO.
----	19-00384-00-SW	PEORIA	16	11
ILLINOIS			CONTRACT NO. 89785	NAME: C502

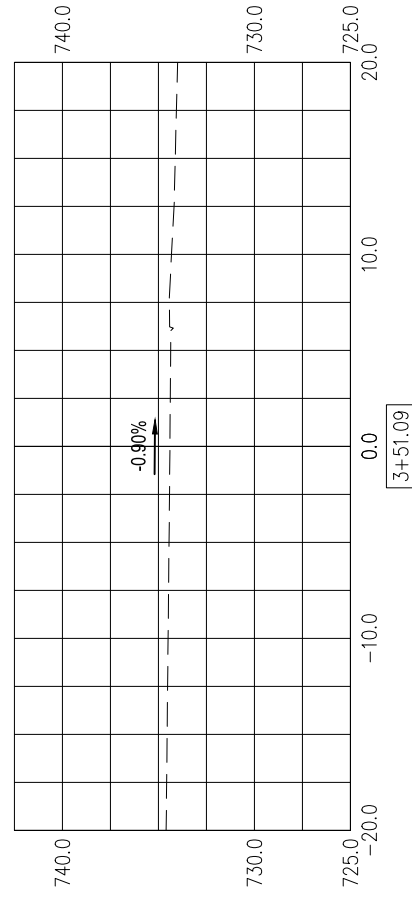

3+51.09

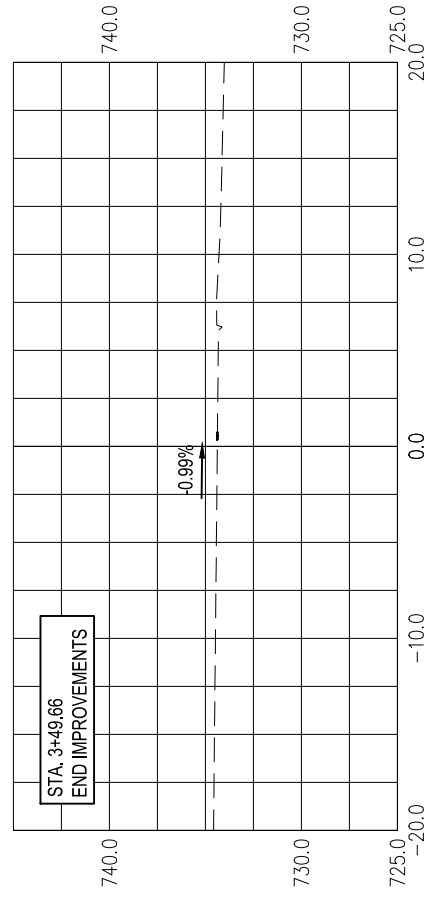

STA. 3+49.66
END IMPROVEMENTS

3+49.66

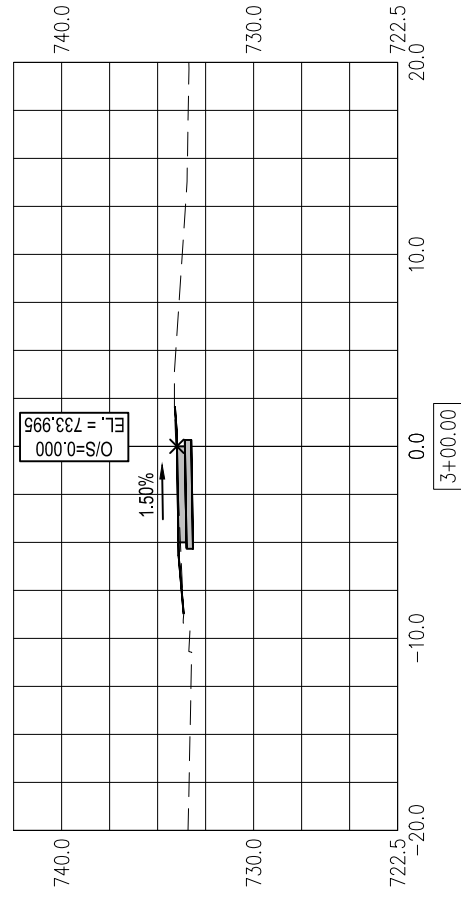

3+00.00

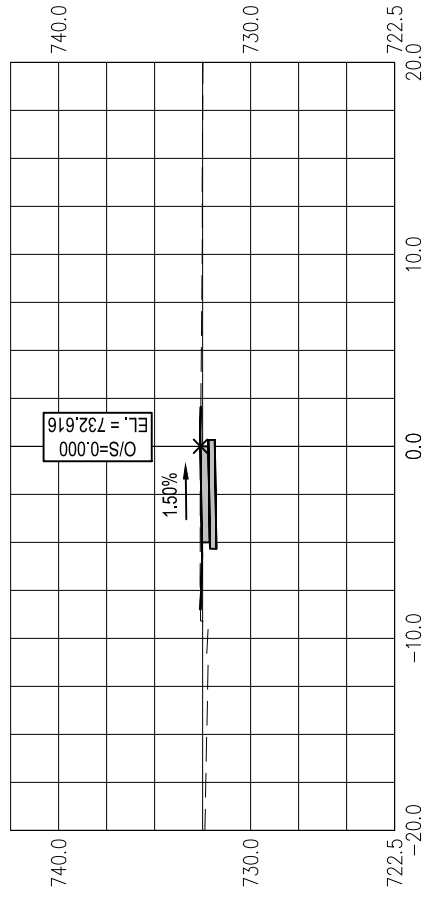

2+50.00

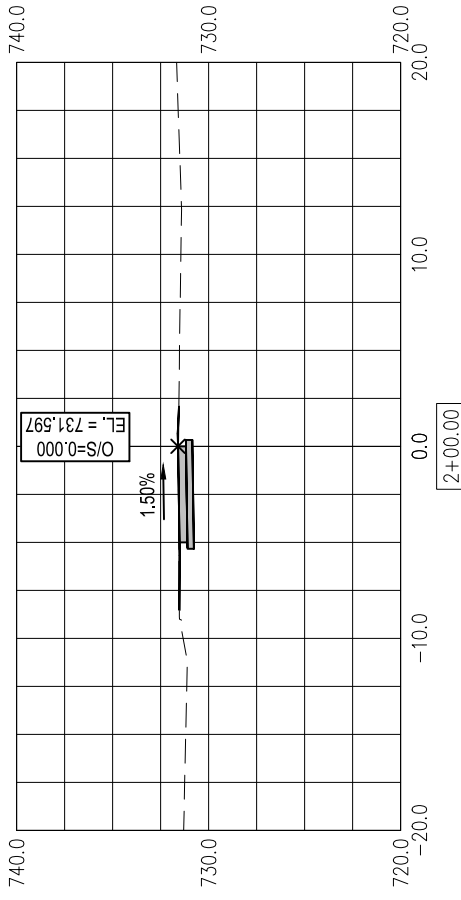

2+00.00

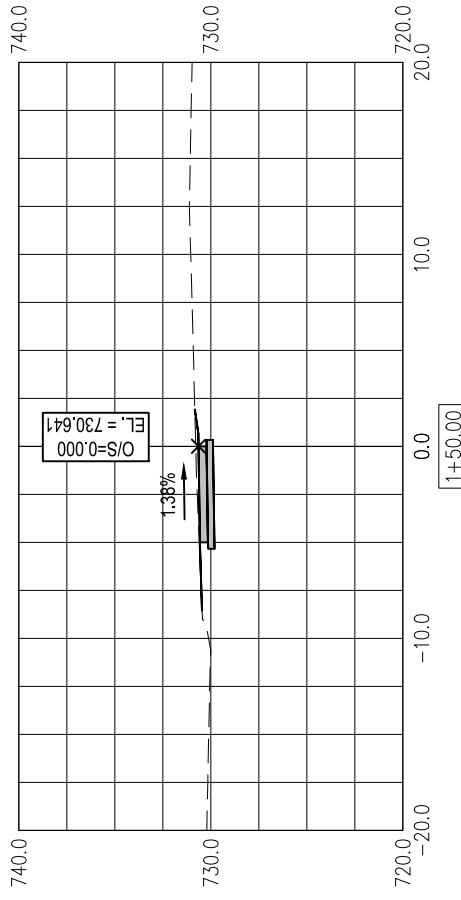

1+50.00

F.A. RTE.	SECTION	COUNTY	TOTAL SHEETS	SHEET NO.
----	19-00384-00-SW	PEORIA	16	12
ILLINOIS	CONTRACT NO. 89785		NAME: C503	

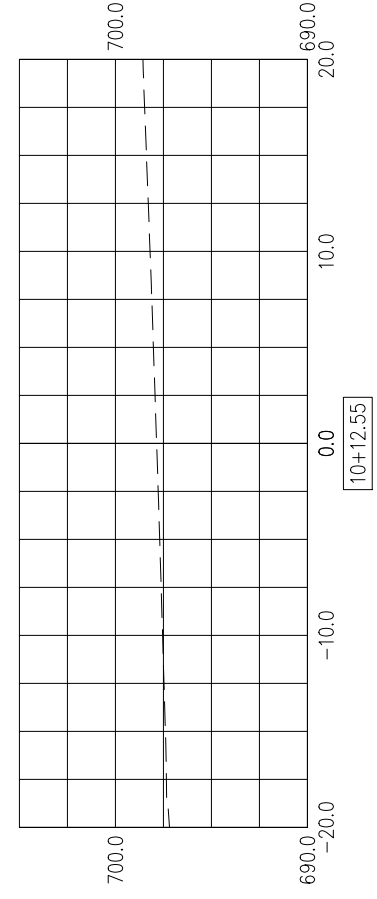
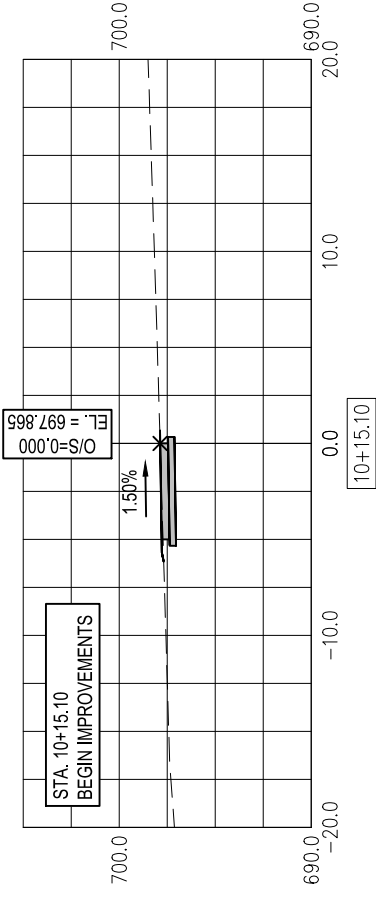
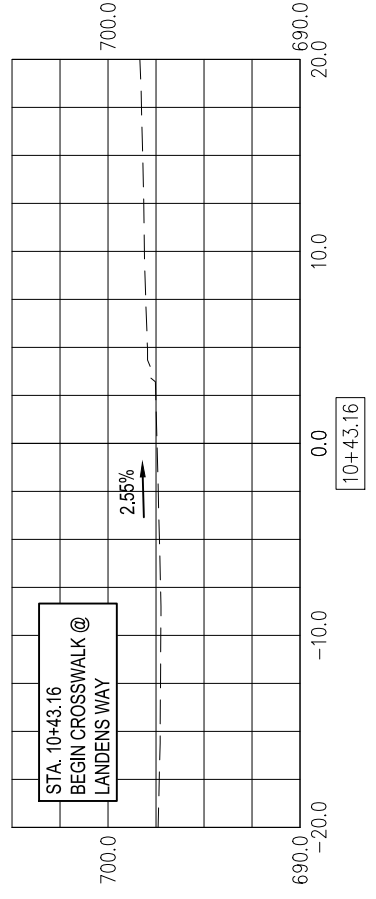
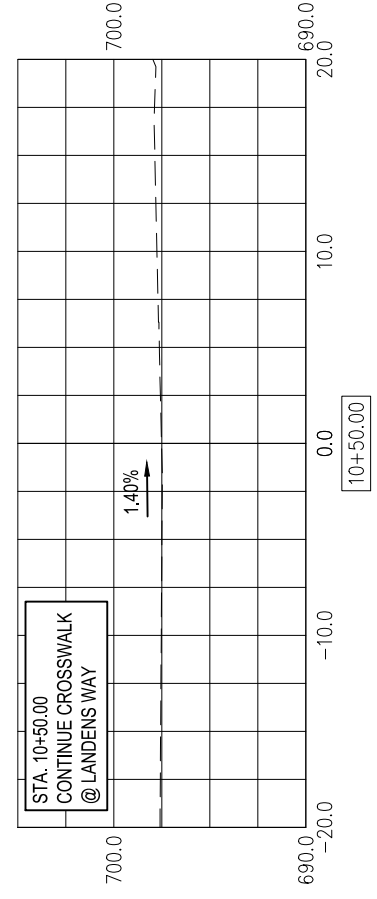
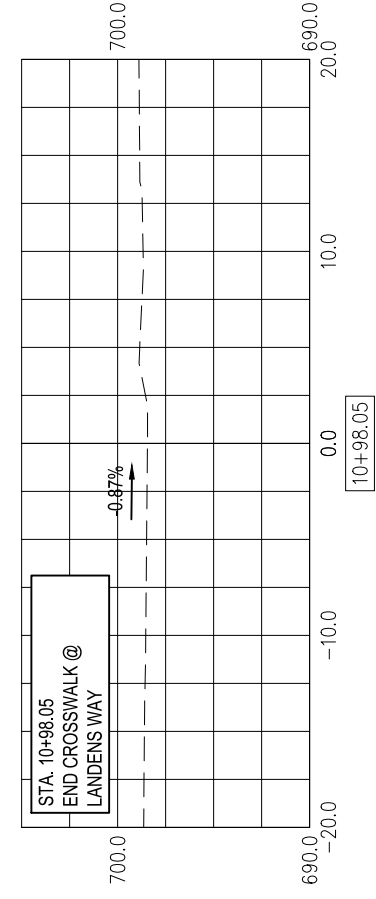
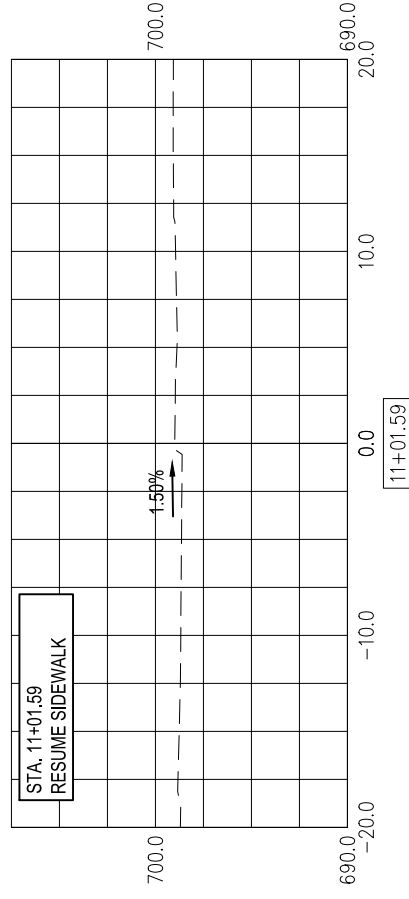

F.A. RTE.	SECTION	COUNTY	TOTAL SHEETS	SHEET NO.
----	19-00384-00-SW	PEORIA	16	13
ILLINOIS	CONTRACT NO. 89785		NAME:	C504

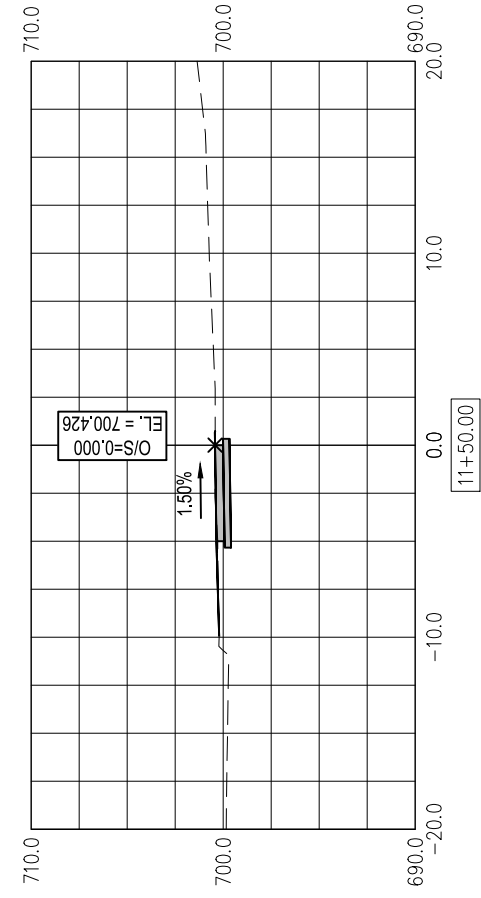
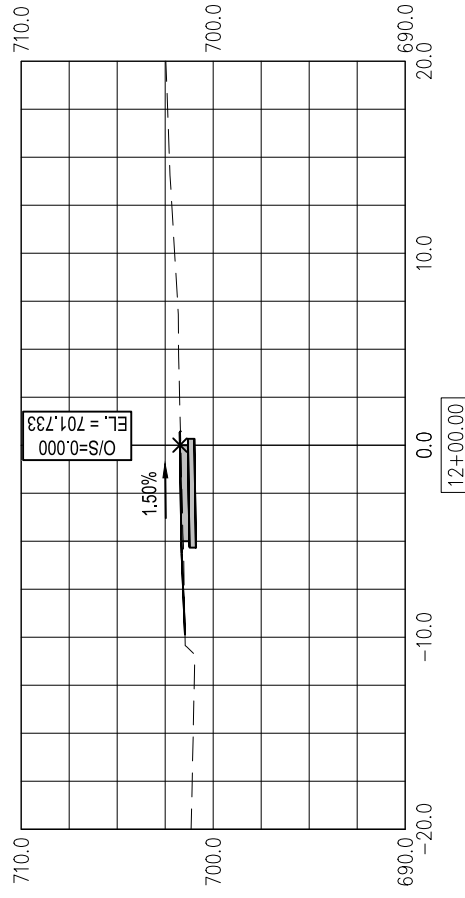
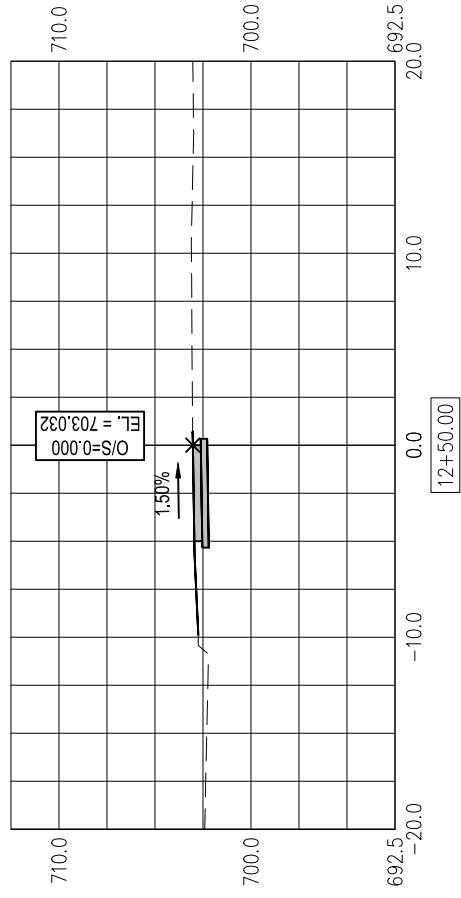
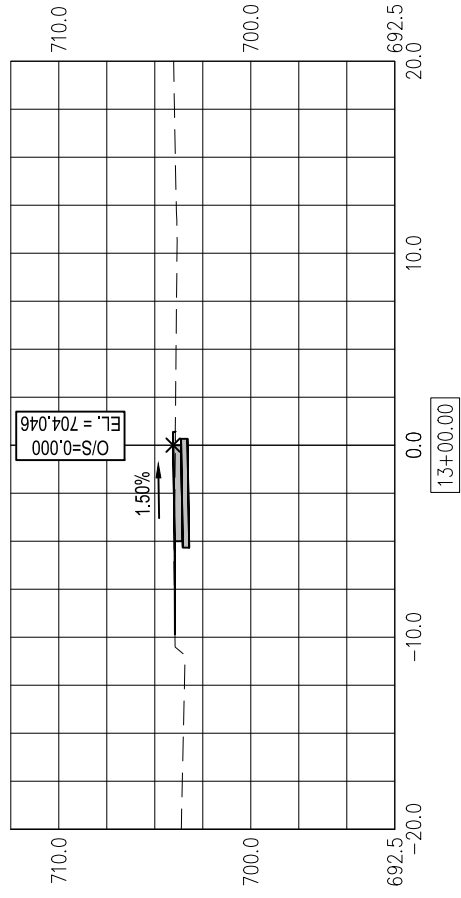
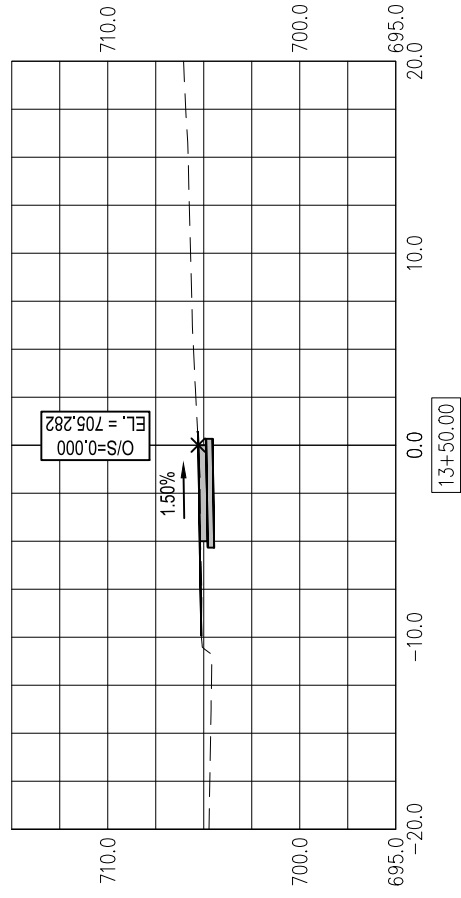
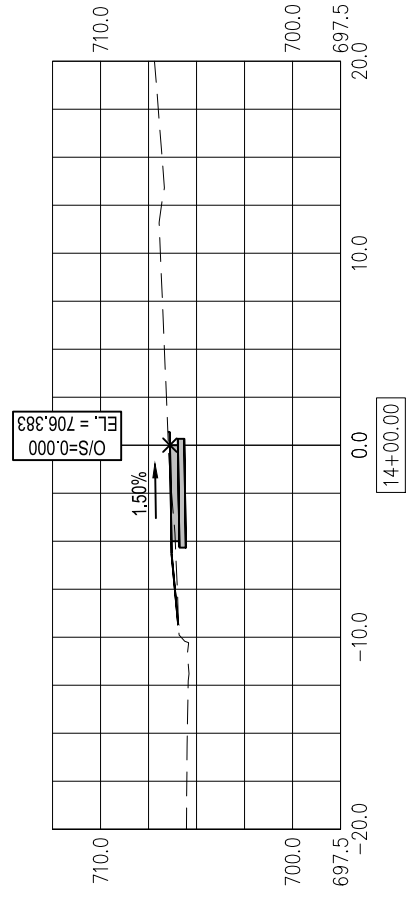

F.A. RTE.	SECTION	COUNTY	TOTAL SHEETS	SHEET NO.
----	19-00384-00-SW	PEORIA	16	14
ILLINOIS	CONTRACT NO. 89785		NAME:	C505

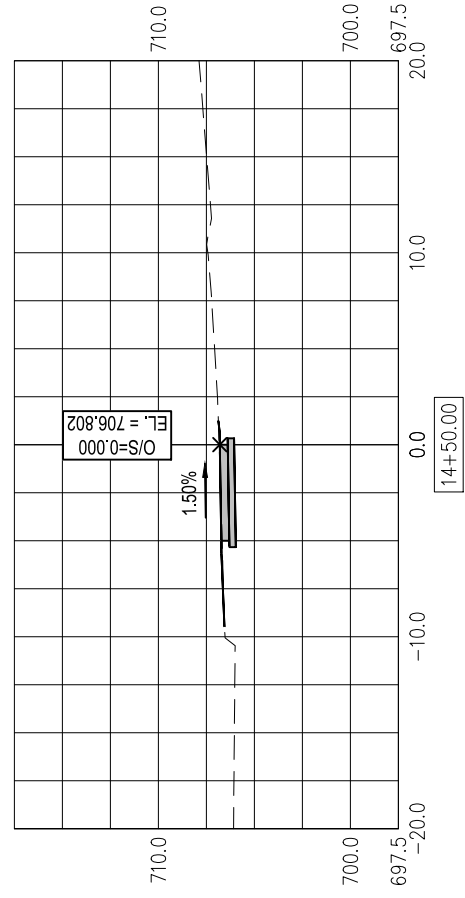
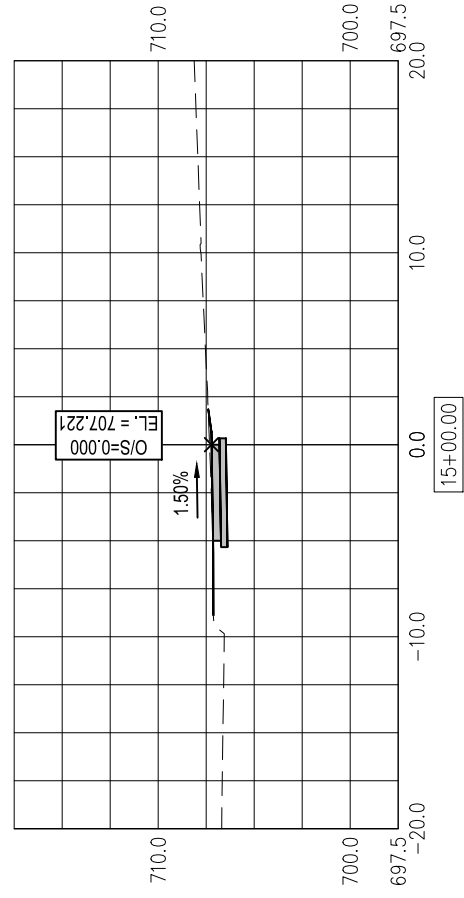
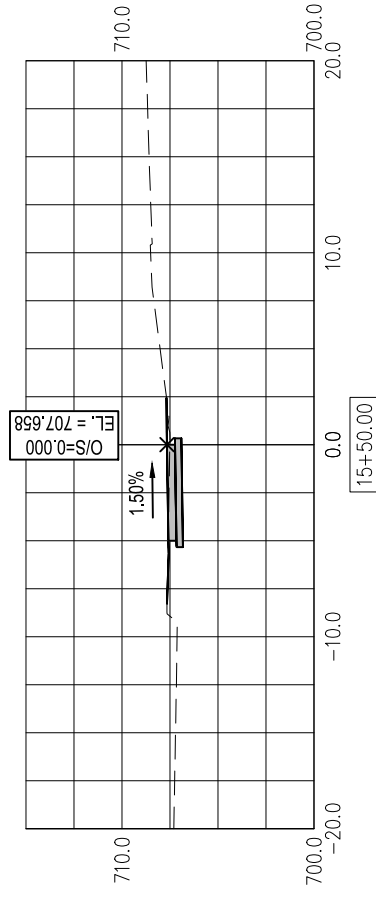
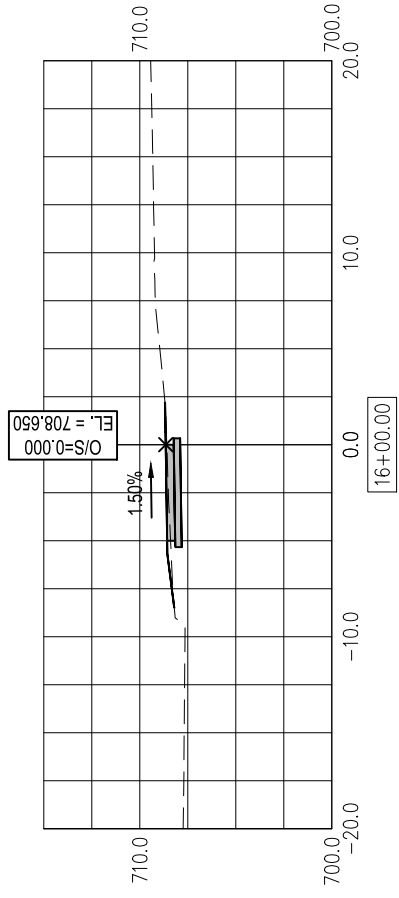
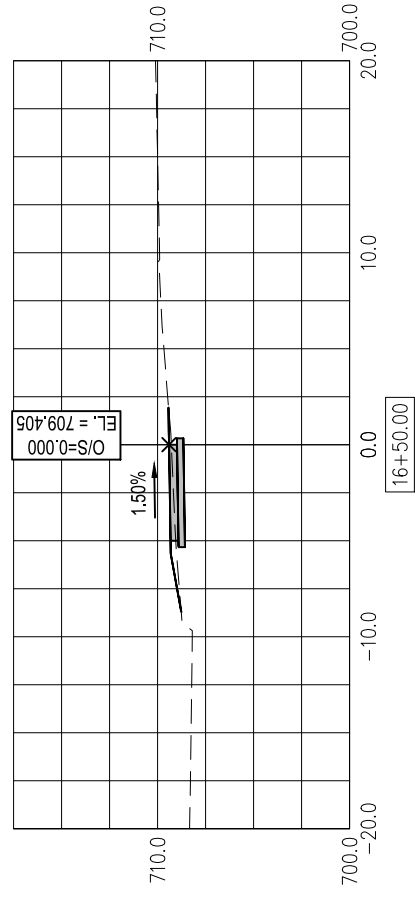
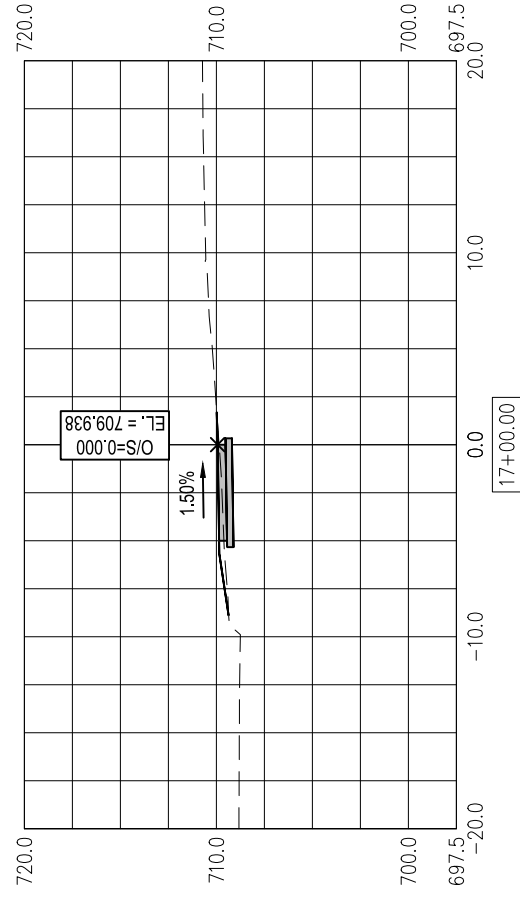

F.A. RTE.	SECTION	COUNTY	TOTAL SHEETS	SHEET NO.
----	19-00384-00-SW	PEORIA	16	15
ILLINOIS	CONTRACT NO. 89785		NAME:	C506

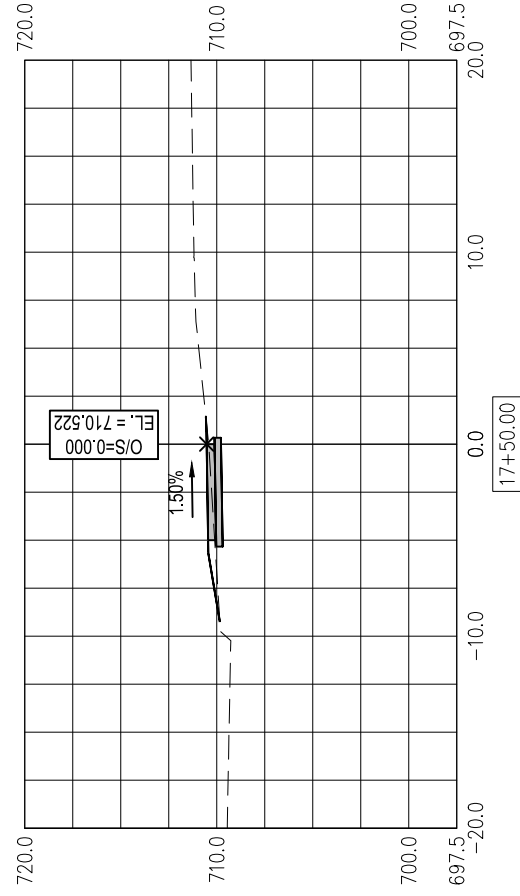
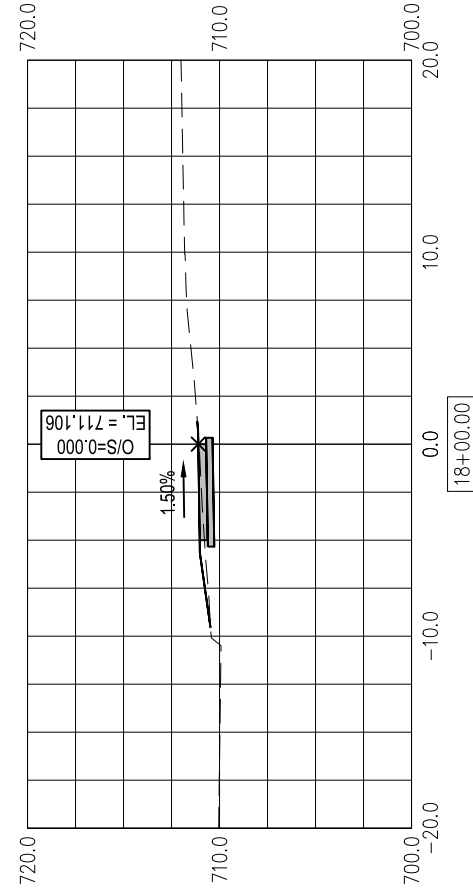
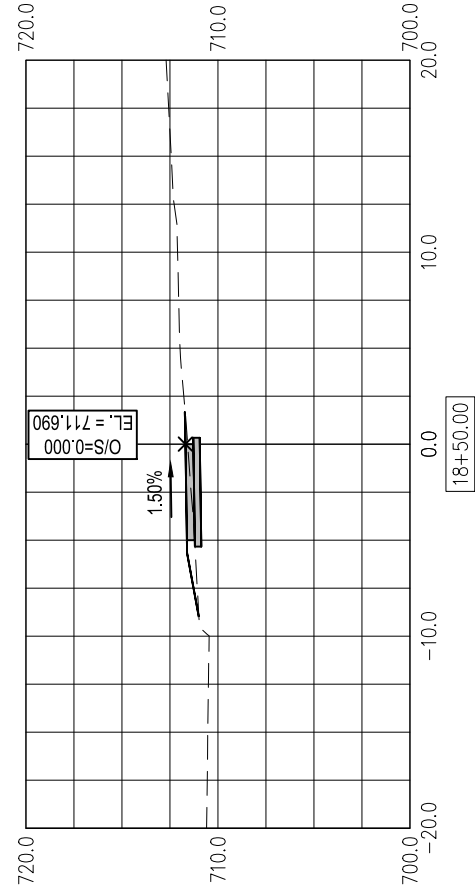
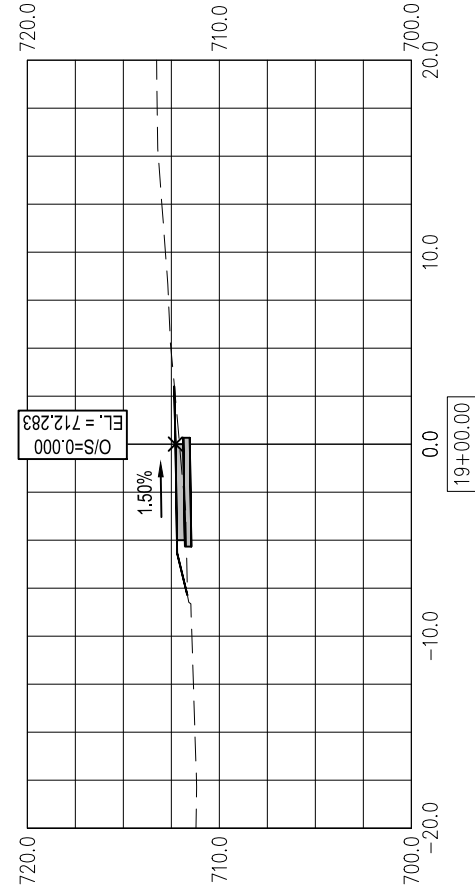
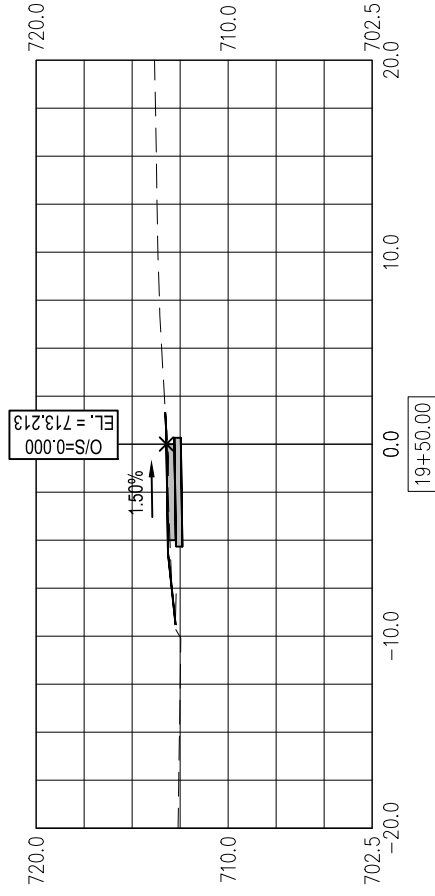

F.A. RTE.	SECTION	COUNTY	TOTAL SHEETS	SHEET NO.
----	19-00384-00-SW	PEORIA	16	16
ILLINOIS	CONTRACT NO. 89785		NAME:	C507

