

STATE OF ILLINOIS
DEPARTMENT OF TRANSPORTATION

F.A.U. RTE.	SECTION	COUNTY	TOTAL SHEETS	SHEET NO.
8534	D7 HMA RESURFACE 2021-1	CLAY	16	1
ILLINOIS		CONTRACT NO. 74A31		

FOR INDEX OF SHEETS, SEE SHEET NO. 2
ADT = 3900 (2016)

STATION EQUATIONS
NO STATION EQUATIONS

BRIDGE OMISSIONS
NO BRIDGE EMISSIONS

PROPOSED HIGHWAY PLANS

VARIOUS
SECTION D7 HMA RESURF 2021-1

RESURFACING
CLAY COUNTY

C-97-115-21

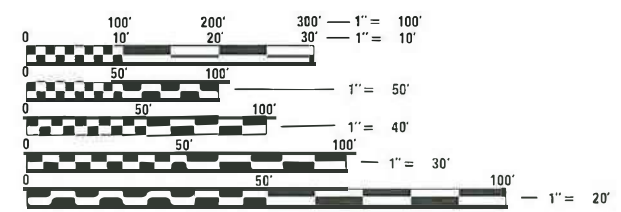

FULL SIZE PLANS HAVE BEEN PREPARED USING STANDARD ENGINEERING SCALES. REDUCED SIZED PLANS WILL NOT CONFORM TO STANDARD SCALES. IN MAKING MEASUREMENTS ON REDUCED PLANS, THE ABOVE SCALES MAY BE USED.

J.U.L.I.E.
JOINT UTILITY LOCATION INFORMATION FOR EXCAVATION
1-800-892-0123
OR 811

PROJECT ENGINEER TOM RONAN
PROJECT MANAGER BRYAN HARRINGTON
PHONE NUMBER (217)-342-8320
CONTRACT NO. 74A31

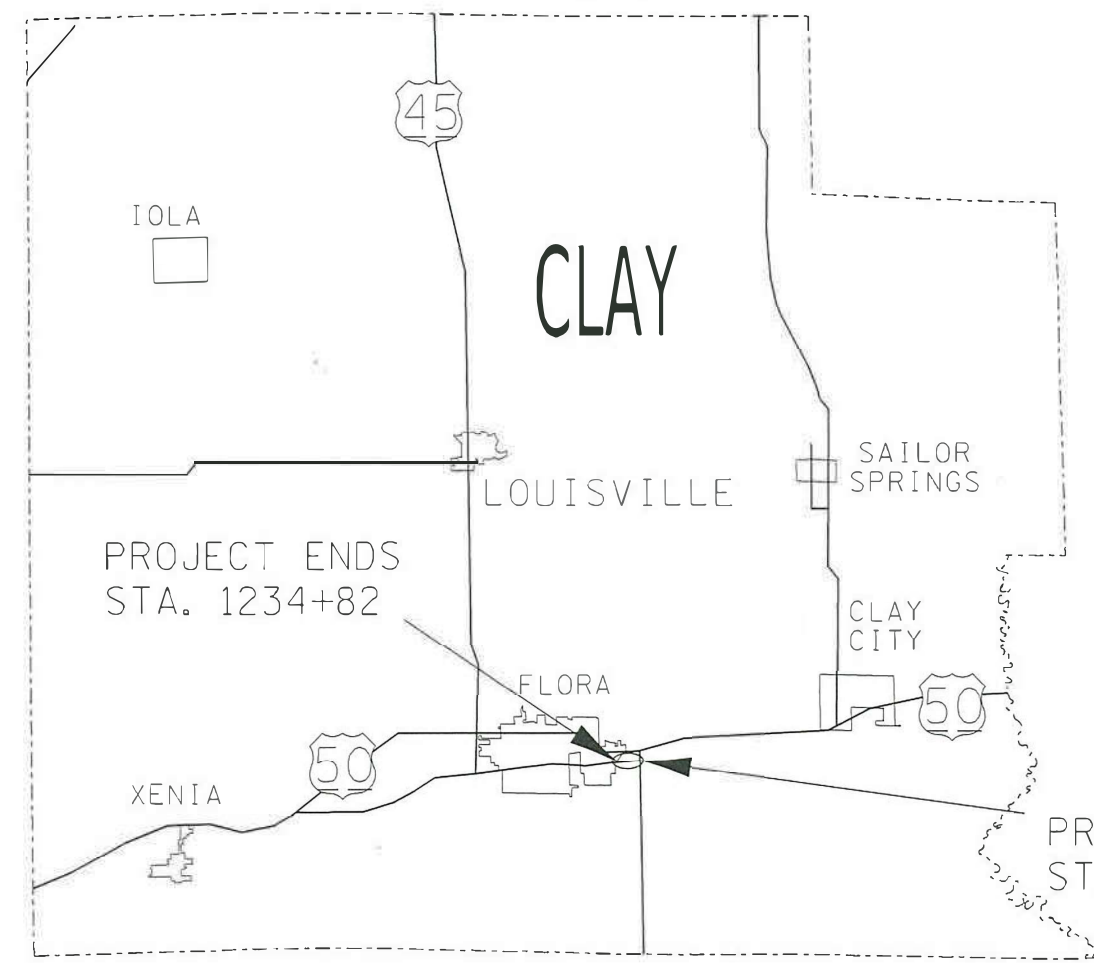

GROSS LENGTH = 6005 FT. = 1.137 MILE
NET LENGTH = 6005 FT. = 1.137 MILE

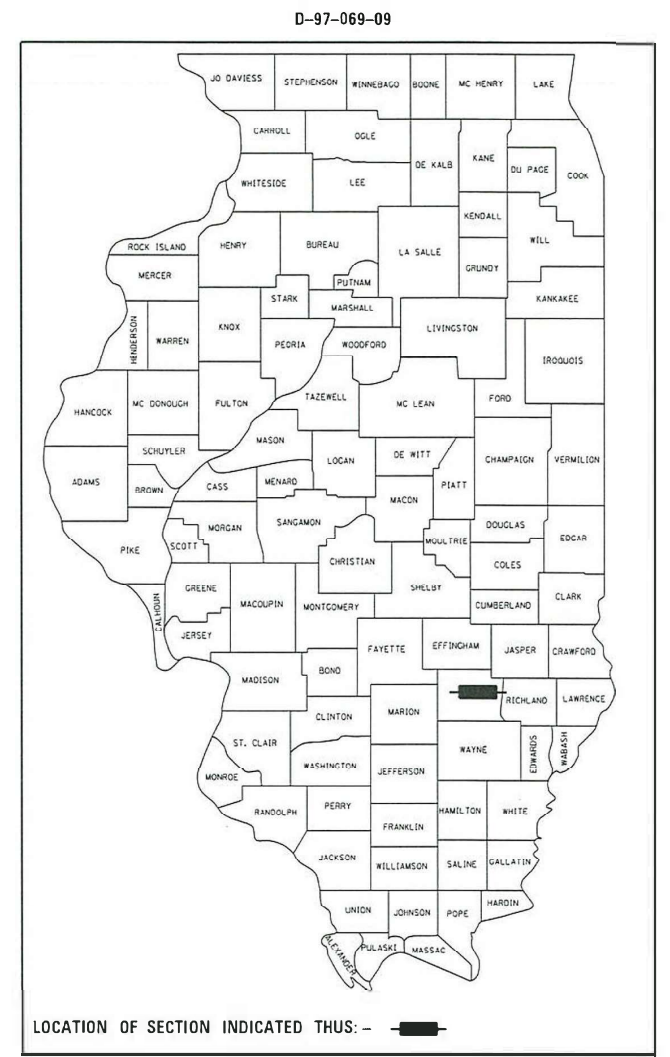

STATE OF ILLINOIS
DEPARTMENT OF TRANSPORTATION

SUBMITTED April 13 2021
Jeffrey P. Myer REGIONAL ENGINEER

May 7, 2021 [Signature]
ENGINEER OF DESIGN AND ENVIRONMENT

May 7, 2021 [Signature]
DIRECTOR OF HIGHWAYS PROJECT IMPLEMENTATION '13

PRINTED BY THE AUTHORITY
OF THE STATE OF ILLINOIS

INDEX OF SHEETS

SHEET NO.	DESCRIPTION
1	TITLE SHEET
2	INDEX OF SHEETS, HIGHWAY STANDARDS, & GENERAL NOTES
3	SUMMARY OF QUANTITIES
4	TYPICALS
5 - 7	SCHEDULES OF QUANTITIES
8 - 13	PLAN SHEETS
14	PAVING DETAILS
15	RURAL ENTRANCE AND MAILBOX TURNOUT DETAILS WITH SHOULDERS
16	DETAIL NO. 78000001

THE FOLLOWING STANDARDS ARE A PART OF THESE PLANS AND ARE INCLUDED FOLLOWING SHEET NUMBER 16:

000001-08	STANDARD SYMBOLS ABBREVIATIONS SYMBOLS AND PATTERNS
701001-02	OFF ROAD OPERATION 2L 2W - 15 FT MIN FROM EDGE OF PAVEMENT
701006-05	OFF ROAD OPERATION 2L 2W - 15 TO EDGE OF PAVEMENT
701201-05	LANE CLOSURE 2L 2W - DAY ONLY
701306-04	LANE CLOSURE 2L 2W SLOW MOVE OPERATION ONLY 45 MPH OR MORE
701311-03	LANE CLOSURE 2L 2W MOVING OPERATION DAY ONLY
701901-08	TRAFFIC CONTROL DEVICES
780001-05	TYPICAL PAVEMENT MARKING
001006	DECIMAL OF AN INCH AND OF A FOOT
442201-03	CLASS C AND D PATCHES

GENERAL NOTES

THE PROPOSED WORK IS LOCATED AT US ROUTE OLD HWY 50 IN CLAY COUNTY. THE PROJECT BEGINS AT NEW CONSTRUCTION JOINT EAST OF THE INTERSECTION WITH US 45, TO PAVEMENT JOINT WEST OF INDUSTRIAL DRIVE.

THE WORK IN THIS SECTION CONSISTS OF A MILLING, HMA RESURFACING, PAVEMENT MARKING AND AGG WEDGE SHOULDER TYPE B

THE MILLING OF THIS PROJECT IS TO NOT EXCEED 1/2" AT CENTERLINE, UNLESS DIRECTED BY THE ENGINEER.

APPLICATION	AC/PG	DESIGN AIR VOIDS	MIXTURE COMPOSITION	FRICTION AGGREGATE	QUALITY MANAGEMENT
HMA SURFACE COURSE, MIX "C", N70 (1 1/2")	PG 64-22	4.0% @ N=70	IL - 9.5	MIXTURE C	QC/QA

APPLICATION RATES:

BITUMINOUS MATERIALS (TACK COAT)	0.05 LBS / SQ FT
GRANULAR MATERIAL	2.05 TONS / CU. YD.
HOT-MIX-ASPHALT	112 LBS/ SQ YD/ INCH

REV. - MS

FILE NAME =	USER NAME = steffenmk	DESIGNED -	REVISED -	STATE OF ILLINOIS DEPARTMENT OF TRANSPORTATION	INDEX OF SHEETS AND GENERAL NOTES	F.A.U. RTÉ.	SECTION	COUNTY	TOTAL SHEETS	SHEET NO.	
pw:\plnroom.dot.illinois.gov\PIDOT\Documents\IDOT Offices\District 7\Projects\74A31\CDRAWN\CADsheets\0774A31-shr-genote.dgn		CHECKED -	REVISED -			8534	07 HMA RESURFACE 2021-1	CLAY	16	2	
	PLOT SCALE = 100.0000' / in.	DATE -	REVISED -			CONTRACT NO. 74A31					
	PLOT DATE = 4/13/2021					SCALE: NA	SHEET 1	OF 1	SHEETS	STA.	TO STA.

100%
STATE

100%
STATE

SUMMARY OF QUANTITIES			TOTAL QUANTITIES	CONSTRUCTION TYPE CODE		
CODE NO	ITEM	UNIT		0005 RURAL		
40200800	AGGREGATE SURFACE COURSE, TYPE B	TON	5	5		
40600290	BITUMINOUS MATERIALS (TACK COAT)	POUND	6606	6606		
40600990	TEMPORARY RAMP	SQ YD	10	10		
40604052	HOT-MIX-ASPHALT SURFACE COURSE, IL-9.5, MIX "C" , N70	TON	1233	1233		
40800050	INCIDENTAL HOT-MIX ASPHALT SURFACING	TON	12	12		
44201785	CLASS D PATCHES, TYPE I, 12 INCH	SQ YD	25	25		
44201789	CLASS D PATCHES, TYPE II, 12 INCH	SQ YD	65	65		
44201794	CLASS D PATCHES, TYPE III, 12 INCH	SQ YD	18	18		
44201796	CLASS D PATCHES, TYPE IV, 12 INCH	SQ YD	51	51		
48102100	AGGREGATE WEDGE SHOULDER TYPE "B"	TON	65	65		
67100100	MOBILIZATION	L SUM	1	1		
70100450	TRAFFIC CONTROL AND PROTECTION STANDARD 701201	L SUM	1	1		
70100460	TRAFFIC CONTROL AND PROTECTION STANDARD 701306	L SUM	1	1		

SUMMARY OF QUANTITIES			TOTAL QUANTITIES	CONSTRUCTION TYPE CODE		
CODE NO	ITEM	UNIT		0005 RURAL		
70107025	CHANGEABLE MESSAGE SIGN	CAL DA	28	28		
70300100	SHORT TERM PAVEMENT MARKING	FOOT	3003	3003		
70300150	SHORT TERM PAVEMENT MARKING REMOVAL	SQ FT	495	495		
* 78001110	PAINT PAVEMENT MARKING LINE 4"	FOOT	13016	13016		
X4400196	HOT-MIX ASPHALT SURFACE REMOVAL, SPECIAL	SQ YD	14679	14679		
Z0033700	LONGITUDINAL JOINT SEALANT	FOOT	6005	6005		
Z0070202	SURVEY MARKER VAULT	EACH	1	1		

* SPECIALTY ITEM

REV. - MS

MODEL: Default
 FILE NAME: p:\pub\amrnon\dot\illinc\gov\PIWDOT\Documents\DOT_Offices\District 7\Projects\74A31\CADD\DATA\CAD\Sheets\074A31-1-SQC.dgn

USER NAME = steffemk	DESIGNED -	REVISED -
	DRAWN -	REVISED -
PLOT SCALE = 100,0000' / in.	CHECKED -	REVISED -
PLOT DATE = 4/13/2021	DATE -	REVISED -

STATE OF ILLINOIS
DEPARTMENT OF TRANSPORTATION

SUMMARY OF QUANTITIES

SCALE: SHEET 1 OF 1 SHEETS STA. TO STA.

F.A.U. RTE.	SECTION	COUNTY	TOTAL SHEETS	SHEET NO.
8534	D7 HMA RESURFACE 2021-1	CLAY	16	3
CONTRACT NO. 74A31			ILLINOIS FED. AID PROJECT	

TYPICAL CROSS SECTION

STA. 1174+77 - 1234+82

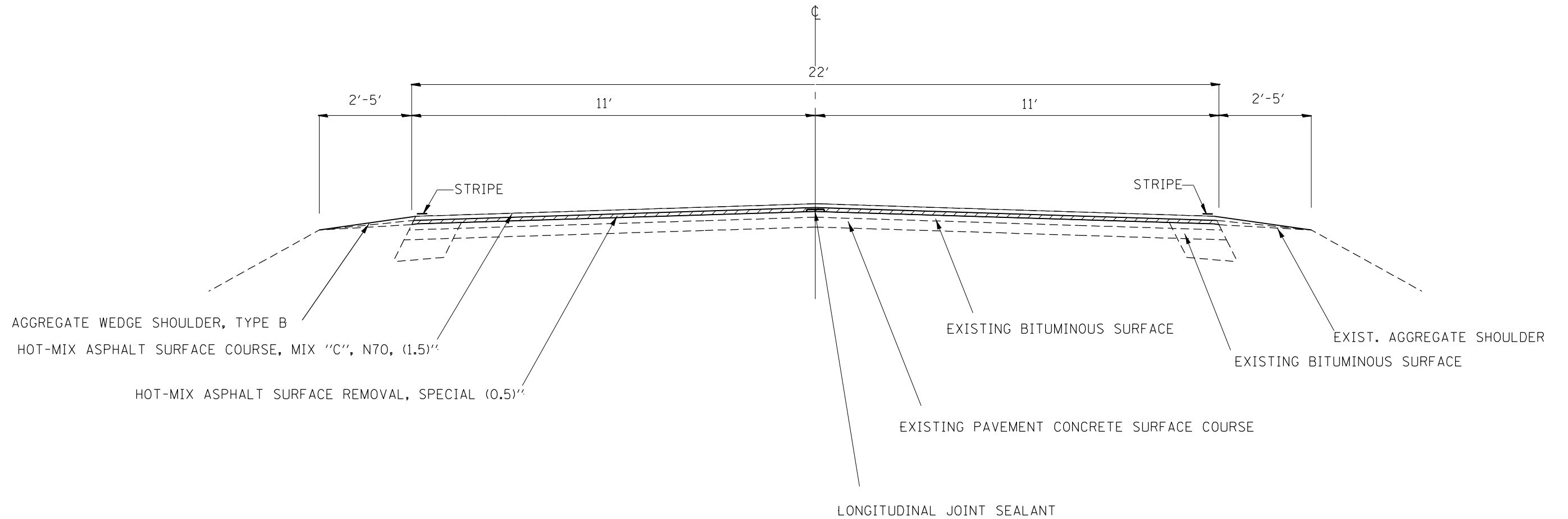

NOTE: NOT DRAWN TO SCALE

FILE NAME =	USER NAME = steffenmk	DESIGNED -	REVISED -	STATE OF ILLINOIS DEPARTMENT OF TRANSPORTATION	TYPICAL CROSS SECTION	F.A.U. RTE.	SECTION	COUNTY	TOTAL SHEETS	SHEET NO.	
pw:\planroom.dot.illinois.gov\PIDOT\Documents\IDOT Offices\District 7\Projects\74A31\CAD\CAD sheets\0774A31-sht-typic1.dgn	DESIGNED -	REVISED -	REVISED -			8534	07 HMA RESURFACE 2021-1	CLAY	16	4	
Default	PLOT SCALE = 5.0000' / in.	CHECKED -	REVISED -			SCALE: SHEET 1 OF 1 SHEETS STA. TO STA.		CONTRACT NO. 74A31			
	PLOT DATE = 4/13/2021	DATE -	REVISED -			ILLINOIS FED. AID PROJECT					

PAVING SCHEDULE											
STATIONING		LENGTH	PVMT	SHLD	SHLD	SQ FT	HMA	BITUMINOUS	LONGITUDINAL	HMA	AGGREGATE
			WIDTH	LF/RT	WIDTH		SURFACE	MATERIALS	JOINT	N70 SURFACE	SHLDS
				AGG			REMOVAL SPECIAL"	TACK COAT	SEALANT	1.5"	TYPE "B"
FROM	TO	FEET	FEET	SURF. CSE.			X4400196	40600290	Z0033700	40604002	48102100
						SQ YD	POUNDS	FOOT	TON	TONS	
1174+77	1175+77	100	22	LF/RT	2.0	2200	244.4	110	100	21	1.3
1175+77	1176+63	86	22	LT	2.0	1892	210.2	95	86	18	0.5
1176+63	1177+64	101	22	LF/RT	2.0	2222	246.9	111	101	21	1.3
1177+64	1178+11	47	22	LT	2.0	1034	114.9	52	47	10	0.3
1178+11	1178+42	31	22	LF/RT	2.0	682	75.8	34	31	6	0.4
1178+42	1178+75	33	22	LT	2.0	726	80.7	36	33	7	0.2
1178+75	1181+30	255	22	LF/RT	2.0	5610	623.3	281	255	52	3.2
1181+30	1181+99	69	22	LT	2.0	1518	168.7	76	69	14	0.4
1181+99	1182+43	44	22	LF/RT	2.0	968	107.6	48	44	9	0.6
1182+43	1182+76	33	22	LT	2.0	726	80.7	36	33	7	0.2
1182+76	1184+10	134	22	LT	2.0	2948	327.6	147	134	28	0.8
1184+10	1193+75	965	22	LF/RT	2.0	21230	2358.9	1062	965	198	12.2
1193+75	1194+63	88	22	RT	2.0	1936	215.1	97	88	18	0.6
1194+63	1201+20	657	22	LF/RT	2.0	14454	1606.0	723	657	135	8.3
1201+20	1201+36	16	22	LT	2.0	352	39.1	18	16	3	0.1
1201+36	1203+18	182	22	LF/RT	2.0	4004	444.9	200	182	37	2.3
1203+18	1203+68	50	22	RT	2.0	1100	122.2	55	50	10	0.3
1203+68	1204+74	106	22	LF/RT	2.0	2332	259.1	117	106	22	1.3
1204+74	1205+25	51	22	LT	2.0	1122	124.7	56	51	10	0.3
1205+25	1205+52	27	22	LF/RT	2.0	594	66.0	30	27	6	0.3
1205+52	1207+81	229	22	RT	2.0	5038	559.8	252	229	47	1.4
1207+81	1207+82	1	22	LF/RT	2.0	22	2.4	1	1	0	0.0
1207+82	1208+32	50	22	LT	2.0	1100	122.2	55	50	10	0.3
1208+32	1210+88	256	22	LF/RT	2.0	5632	625.8	282	256	53	3.2
1210+88	1211+32	44	22	LT	2.0	968	107.6	48	44	9	0.3
1211+32	1212+09	77	22	LF/RT	2.0	1694	188.2	85	77	16	1.0
1212+09	1212+69	60	22	RT	2.0	1320	146.7	66	60	12	0.4
1212+69	1216+30	361	22	LF/RT	2.0	7942	882.4	397	361	74	4.6
1216+30	1216+78	48	22	RT	2.0	1056	117.3	53	48	10	0.3
1216+78	1217+66	88	22	LF/RT	2.0	1936	215.1	97	88	18	1.1
1217+66	1218+88	122	22	RT	2.0	2684	298.2	134	122	25	0.8
1218+88	1219+41	53	22	LF/RT	2.0	1166	129.6	58	53	11	0.7
1219+41	1220+22	81	22	RT	2.0	1782	198.0	89	81	17	0.5
1220+22	1221+09	87	22	LF/RT	2.0	1914	212.7	96	87	18	1.1
1221+09	1223+66	257	22	RT	2.0	5654	628.2	283	257	53	1.6
1223+66	1224+82	116	22	LF/RT	2.0	2552	283.6	128	116	24	1.5
1224+82	1225+26	44	22	RT	2.0	968	107.6	48	44	9	0.3
1225+26	1225+95	69	22	NONE	2.0	1518	168.7	76	69	14	0.0
1225+95	1226+63	68	22	LT	2.0	1496	166.2	75	68	14	0.4
1226+63	1232+23	560	22	LT/RT	2.0	12320	1368.9	616	560	115	7.1
1232+23	1234+45	222	22	LT	2.0	4884	542.7	244	222	46	2.8
1234+45	1234+82	37	22	LT/RT	2.0	814	90.4	41	37	8	0.5
GROSS TOTALS							14678.9	6605.5	6005.0	1233.0	64.9

ENTRANCE SCHEDULE							
STATIONING		LT/RT	DESCRIPTION	LENGTH	SHLD. WIDTH	INCIDENTAL	AGGREGATE
FROM	TO			FEET	FEET	HMA SURFACING 40800050 TONS	SURFACE COURSE 40200800 TONS
1175+99	1176+63	LT	CONC. PE	64	2.0	0.4	
1177+64	1178+11	LT	CONC. PE	47	2.0	0.3	
1178+42	1178+75	LT	CONC. PE	33	2.0	0.2	
1178+75	1179+16	LT	MBT	41	6.0		0.8
1181+30	1181+99	LT	CONC. PE	69	2.0	0.4	
1182+43	1182+76	LT	HMA PE	33	2.0	0.2	
1182+76	1183+01	LT	MBT	25	6.0		0.5
1183+76	1184+10	LT	HMA PE	34	2.0	0.2	
1186+03	1186+27	LT	FE	24	5.0		0.4
1193+75	1194+63	RT	CONC. CE	88	2.0	0.5	
1197+68	1197+87	RT	PE	19	5.0		0.3
1201+20	1201+36	LT	HMA CE	16	2.0	0.1	
1202+31	1202+55	LT	PE	24	5.0		0.4
1202+55	1202+65	LT	MBT	10	4.0		0.1
1203+18	1203+68	RT	CONC./HMA CE	50	2.0	0.3	
1204+74	1205+25	LT	HMA CE	51	2.0	0.3	
1205+52	1207+81	RT	SIDE ROAD TO 45/50 HMA	229	2.0	1.4	
1207+82	1208+32	LT	HMA CE	50	2.0	0.3	
1210+88	1211+32	LT	AIRPORT ROAD OIL/CHIP	44	2.0	0.3	
1212+09	1212+69	RT	CONC/HMA CE	60	2.0	0.4	
1216+30	1216+78	RT	CONC/HMA CE	48	2.0	0.3	
1216+80	1217+12	LT	MBT	32	4.0		0.4
1217+12	1217+61	LT	CE	49	10.0		1.6
1217+66	1218+88	RT	CONC CE FAST STOP	122	2.0	0.8	
1218+85	1219+00	LT	PE	15	10.0		0.5
1219+41	1220+22	RT	CONC CE FAST STOP	81	2.0	0.5	
1221+09	1223+66	RT	CONC CE SOUTH CENTRAL	257	2.0	1.6	
1224+82	1225+95	RT	CONC CE SOUTHWIRE	113	2.0	0.7	
1225+26	1226+63	LT	CONC CE	137	2.0	0.9	
1232+23	1234+45	LT	IDUSTRIAL DRIVE CONC	222	2.0	1.4	
1233+83	1234+00	RT	CE	17	2.0		0.1
PROJECT TOTAL INCIDENTAL TONS =						11.5	
PROJECT TOTAL AGG SURFACE COURSE TONS =							5.0

PAVEMENT MARKING SCHEDULE							
STATIONING		LENGTH		70300100	70300150	78001110	
				SHORT TERM	SHORT TERM	PAINT PVMT	PAINT PVMT
			LT/RT	PVMT MKING	PVMT MKING	MKING LINE	MKING LINE
					REMOVAL	4" WHITE	4" YELLOW
FROM	TO	FEET		FEET	SQ FT	FEET	FEET
1174+77	1205+52	3075	LT/RT	1538	254	6150	769
1205+52	1207+81	229	LT	115	19	229	57
1207+81	1210+88	307	LT/RT	154	25	614	77
1210+88	1211+32	44	RT	22	4	44	11
1211+32	1232+23	2091	LT/RT	1046	173	4182	523
1232+23	1234+45	222	RT	111	18	222	56
1234+45	1234+82	37	LT/RT	19	3	74	9
GROSS TOTAL =				3003	495	11515	1501
						13016	

STATIONING		LENGTH	PAVT. WIDTH	TEMP. RAMP
				40600990
FROM	TO	FEET	FEET	SQ YD
Beginning of job	1174+77	22	2	4.9
END OF THE JOB	STA 1234+82	22	2.0	4.9
PROJECT TOTAL SQ YD =				9.8

POINT	STATION	OFFSET	NORTHING	EASTING	DESCRIPTION	PROPOSED PROTECT OR RESET	SURVEY MARKER VAULT EACH
100	1181+92.83	0	730519.349	953144.475	POT - mag/washer	TYPE I	1

County	Type 1 Class D	Type 2 Class D	Type 3 Class D	Type 4 Class D
Clay	44201785	44201789	44201794	44201796
	sy	sy	sy	sy
	25	65	18	51
Total =	25	65	18	51

1174+77 TO 1180+54.5

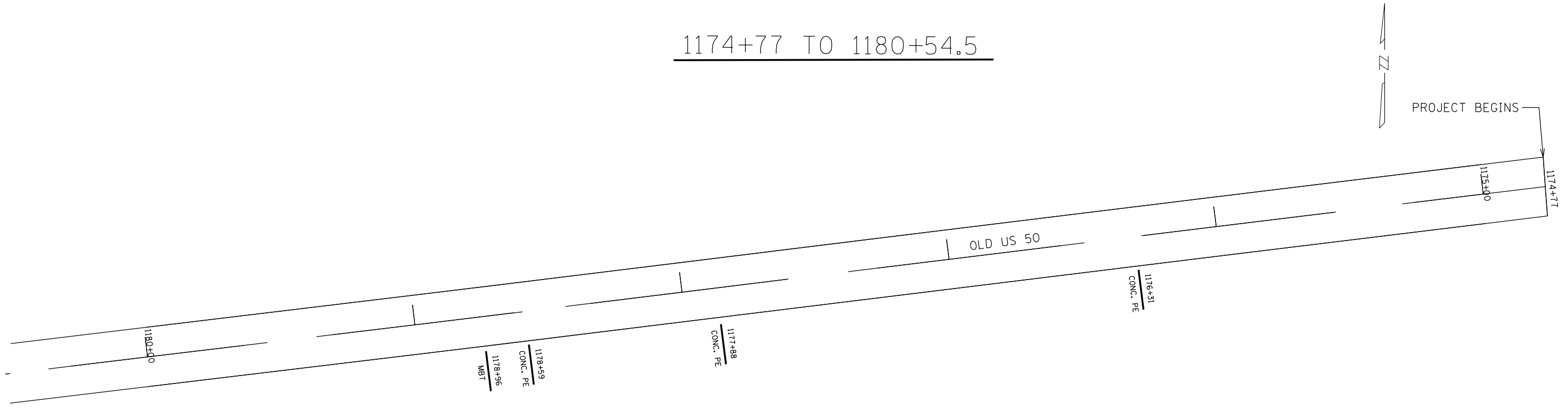

1180+54.5 TO 1186+43.9

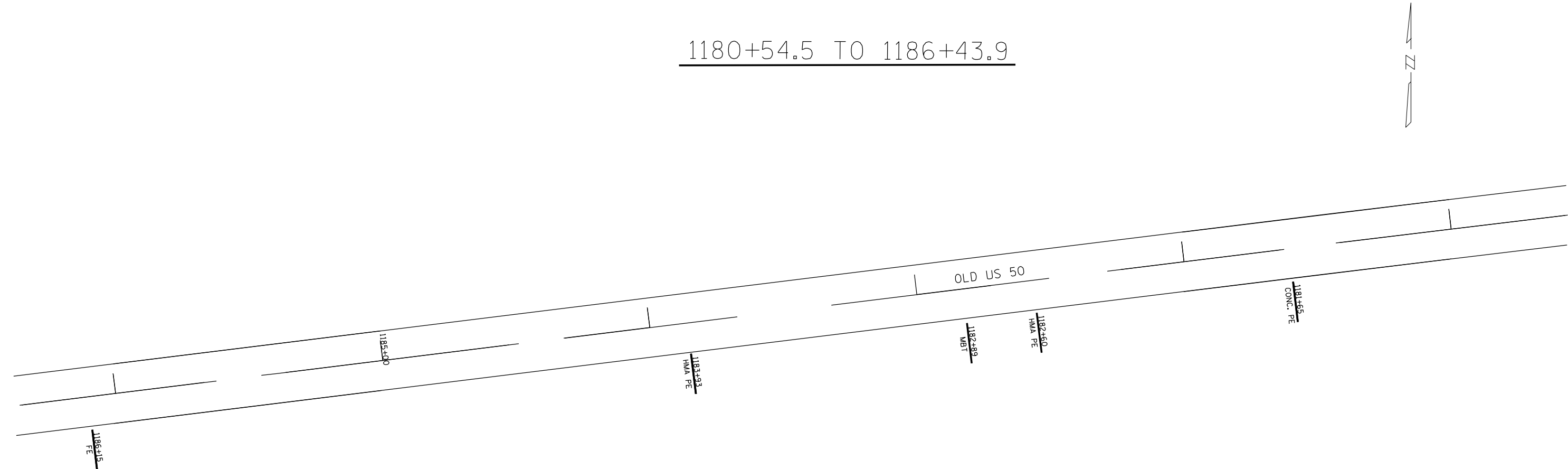

FILE NAME =	USER NAME = steffenk	DESIGNED -	REVISED -
pw:\plenroom.dot.illinois.gov\PIDOT\Documents\IDOT Offices\District 7\Projects\74A31\DRAWING\CADsheets\0774A31-sht-plen.dgn		CHECKED -	REVISED -
Default	PLOT SCALE = 376.4161' / in.	DATE -	REVISED -
	PLOT DATE = 4/13/2021		

**STATE OF ILLINOIS
DEPARTMENT OF TRANSPORTATION**

PLAN SHEET
SCALE: SHEET 1 OF 6 SHEETS STA. TO STA.

F.A.U. RTE.	SECTION	COUNTY	TOTAL SHEETS	SHEET NO.
8534	D7 HMA RESURFACE 2021-1	CLAY	16	8
CONTRACT NO. 74A31				
<small>ILLINOIS FED. AID PROJECT</small>				

1186+43.9 TO 1192+34.1

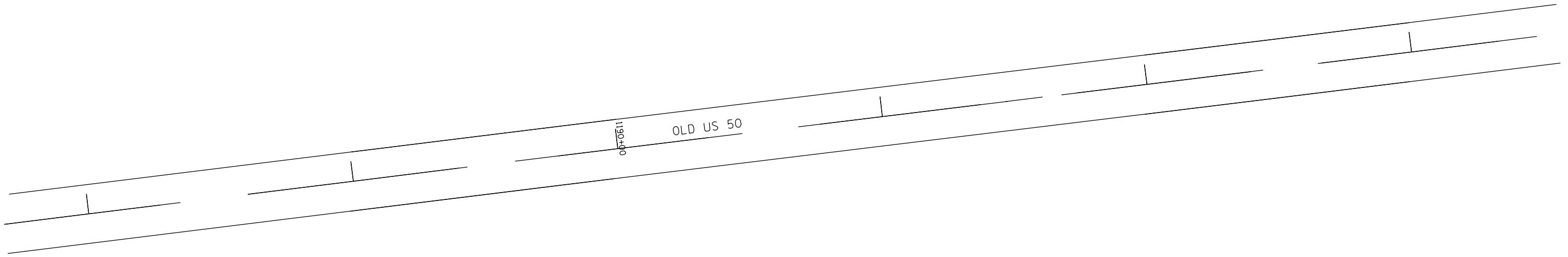
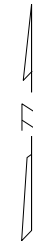

1192+34.1 TO 1198+26.0

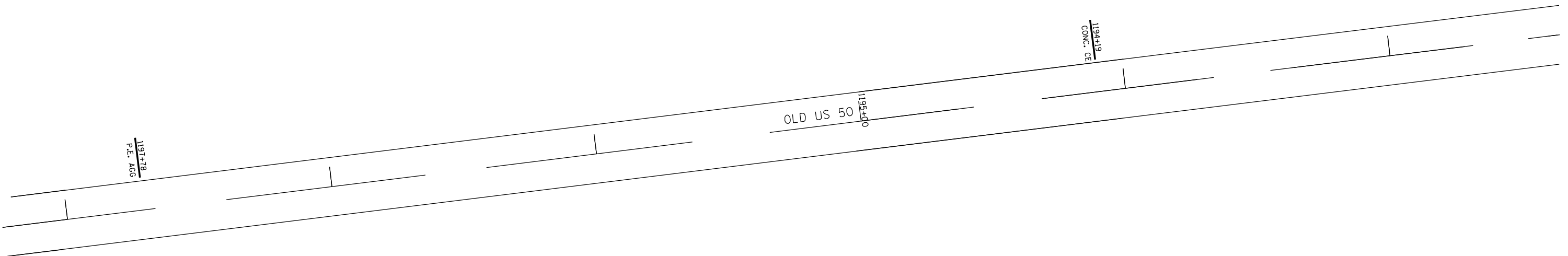
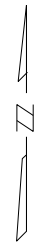

FILE NAME =	USER NAME = steffenk	DESIGNED -	REVISED -
p:\plnroom.dot.illinois.gov\PIDOT\Documents\IDOT Offices\District 7\Projects\74A31\CDRAW\CADsheets\0774A31-sht-pln.dgn		CROWN	REVISED -
Default	PLOT SCALE = 376.4161' / in.	CHECKED -	REVISED -
	PLOT DATE = 4/13/2021	DATE -	REVISED -

**STATE OF ILLINOIS
DEPARTMENT OF TRANSPORTATION**

PLAN SHEET

SCALE: SHEET 2 OF 6 SHEETS STA. TO STA.

F.A.U. RTE.	SECTION	COUNTY	TOTAL SHEETS	SHEET NO.
8534	D7 HMA RESURFACE 2021-1	CLAY	16	9
				CONTRACT NO. 74A31
ILLINOIS FED. AID PROJECT				

1198+26.0 TO 1204+19.1

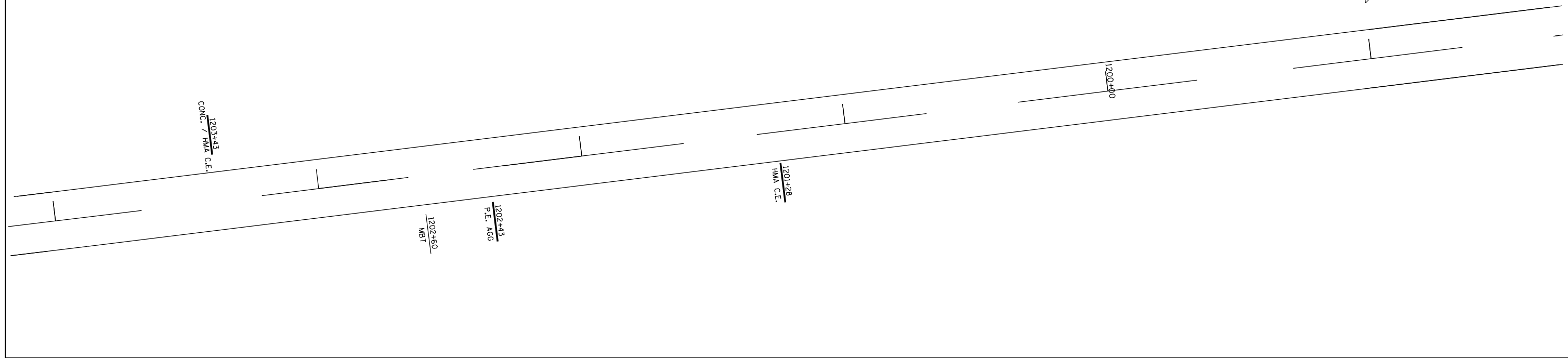

1204+19.1 TO 1210+15.8

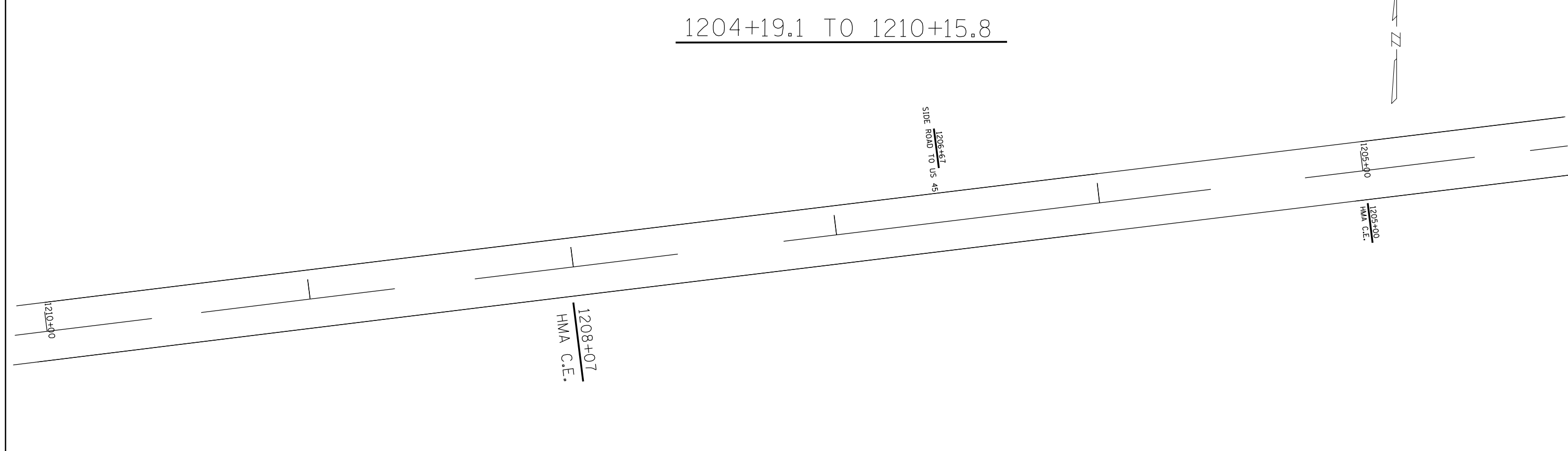

FILE NAME =	USER NAME = steffenmk	DESIGNED -	REVISED -
pw:\planroom.dot.illinois.gov\PIDOT\Documents\IDOT Offices\District 7\Projects\74A31\DRAWING\CAD\sheets\0774A31-sht-plan.dgn		CHECKED -	REVISED -
Default	PLOT SCALE = 376.4161' / in.	DATE -	REVISED -
	PLOT DATE = 4/13/2021		

**STATE OF ILLINOIS
DEPARTMENT OF TRANSPORTATION**

PLAN SHEET

SCALE: SHEET 3 OF 6 SHEETS STA. TO STA.

F.A.U. RTE.	SECTION	COUNTY	TOTAL SHEETS	SHEET NO.
8534	D7 HMA RESURFACE 2021-1	CLAY	16	10
CONTRACT NO. 74A31				
ILLINOIS FED. AID PROJECT				

1210+15.8 TO 1216+10.8

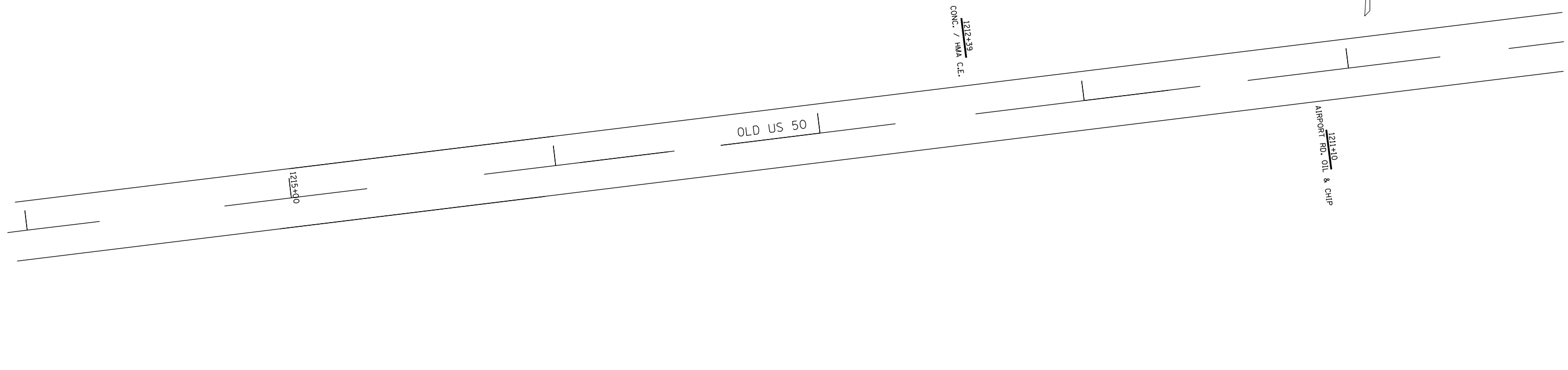

1216+10.8 TO 1221+97.9

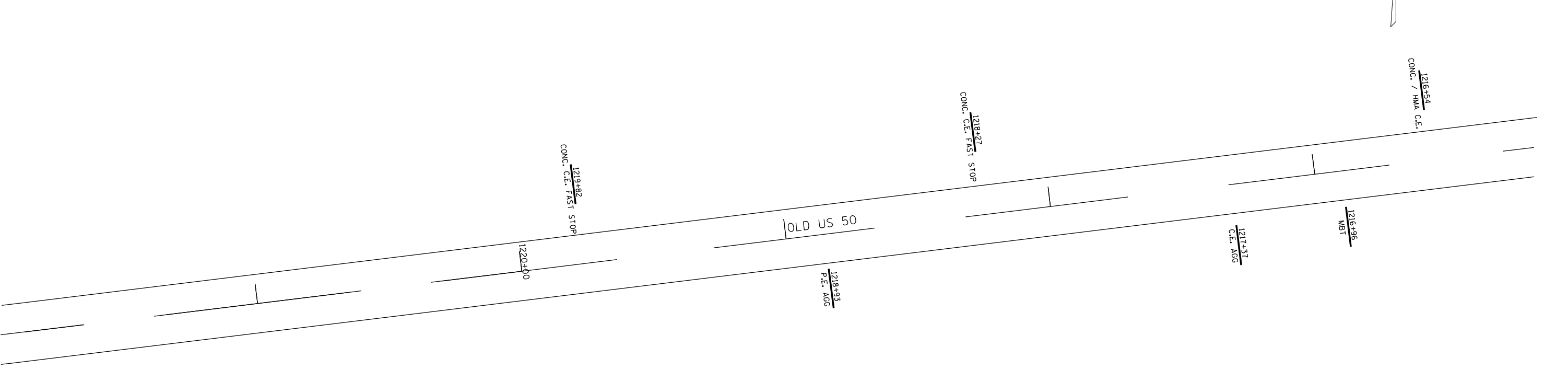

FILE NAME =	USER NAME = steffenmk	DESIGNED -	REVISED -
pw:\planroom.dot.illinois.gov\PIDOT\Documents\IDOT Offices\District 7\Projects\74A31\DRAWING\CADsheets\0774A31-sht-plen.dgn		CHECKED -	REVISED -
Default	PLOT SCALE = 376.4161' / in.	DATE -	REVISED -
	PLOT DATE = 4/13/2021		

**STATE OF ILLINOIS
DEPARTMENT OF TRANSPORTATION**

PLAN SHEET

SCALE: SHEET 4 OF 6 SHEETS STA. TO STA.

F.A.U. RTE.	SECTION	COUNTY	TOTAL SHEETS	SHEET NO.
8534	D7 HMA RESURFACE 2021-1	CLAY	16	11
ILLINOIS FED. AID PROJECT			CONTRACT NO. 74A31	

1221+97.9 TO 1227+84.6

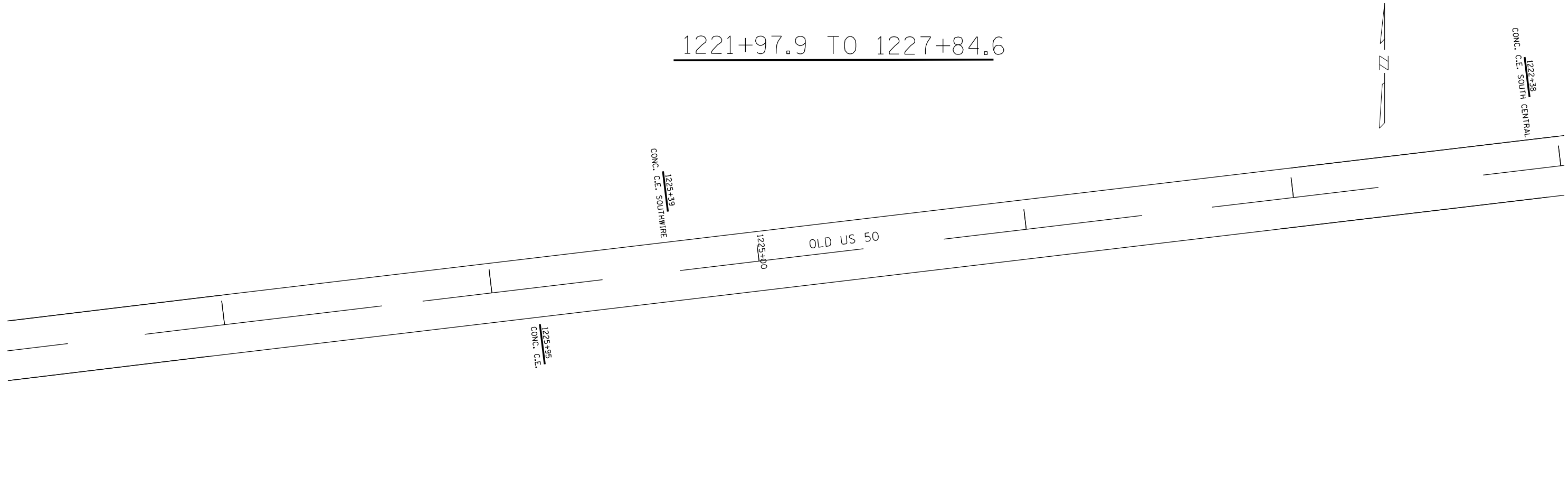

1227+84.6 TO 1233+68.5

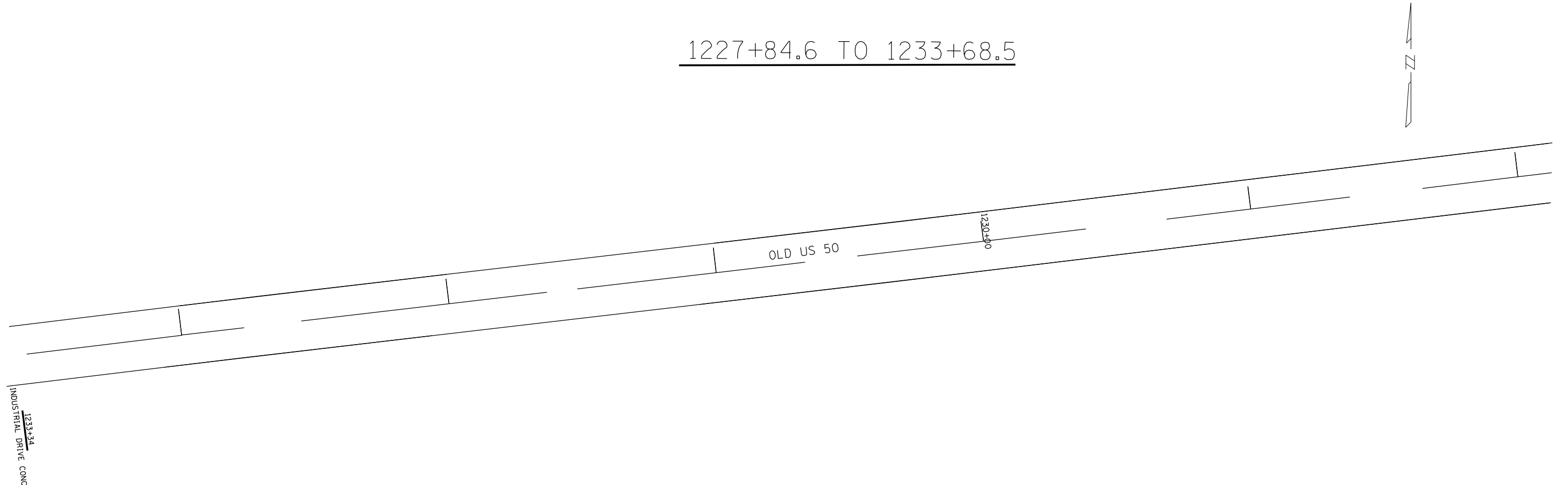

FILE NAME =	USER NAME = steffenk	DESIGNED -	REVISED -
p:\planroom.dot\illinois.gov\PIDOT\Documents\IDOT Offices\District 7\Projects\74A31\CONC\CAD\sheets\0774A31-sht-plen.dgn		CHECKED -	REVISED -
Default	PLOT SCALE = 376.4161' / in.	DATE -	REVISED -
	PLOT DATE = 4/13/2021		

**STATE OF ILLINOIS
DEPARTMENT OF TRANSPORTATION**

PLAN SHEET
SCALE: SHEET 5 OF 6 SHEETS STA. TO STA.

F.A.U. RTE.	SECTION	COUNTY	TOTAL SHEETS	SHEET NO.
8534	D7 HMA RESURFACE 2021-1	CLAY	16	12
CONTRACT NO. 74A31				
ILLINOIS FED. AID PROJECT				

1233+68.5 TO 1234+82

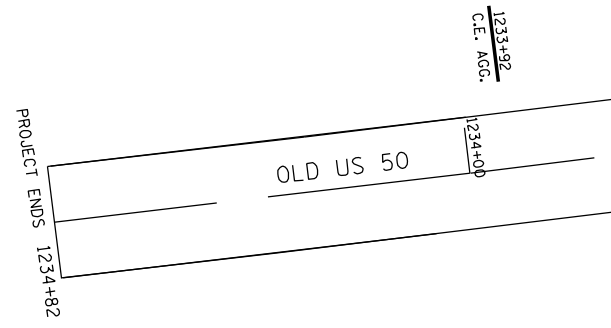

FILE NAME =	USER NAME = steffenk	DESIGNED -	REVISED -
p:\plnroom.dot\illinois.gov\PIDOT\Documents\IDOT Offices\District 7\Projects\74A31\CBRAWN\CAD\sheets\0774A31-sht-pln.dgn		CHECKED -	REVISED -
Default	PLOT SCALE = 376.4161' / in.	DATE -	REVISED -
	PLOT DATE = 4/13/2021		

**STATE OF ILLINOIS
DEPARTMENT OF TRANSPORTATION**

PLAN SHEET	
SCALE:	SHEET 6 OF 6 SHEETS STA. TO STA.

F.A.U. RTE.	SECTION	COUNTY	TOTAL SHEETS	SHEET NO.
8534	D7 HMA RESURFACE 2021-1	CLAY	16	13
CONTRACT NO. 74A31				
ILLINOIS FED. AID PROJECT				

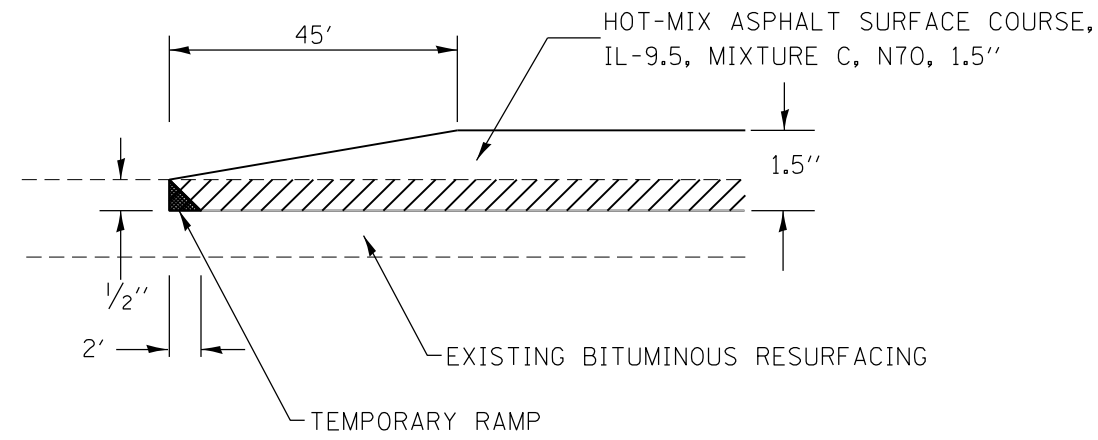

STA 1174+77 TO STA 1175+22

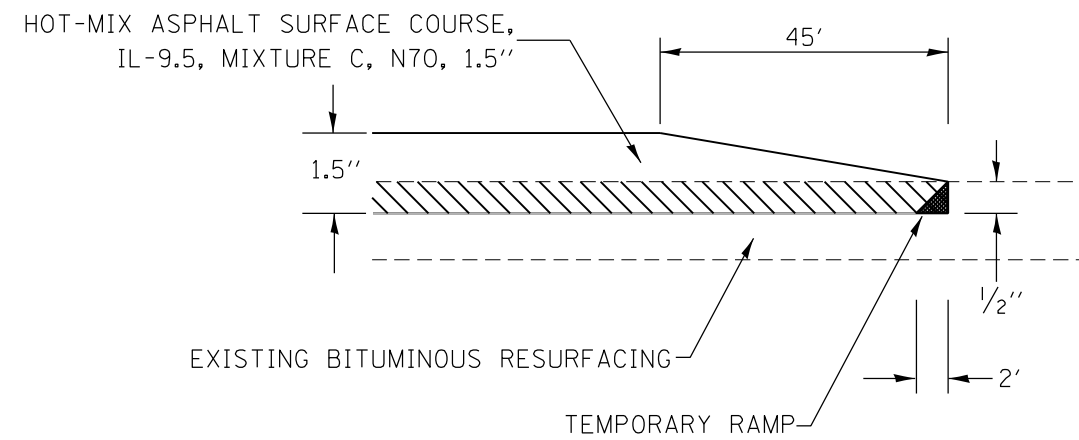

STA 1234+37 TO STA 1234+82

FILE NAME =	USER NAME = steffenmk	DESIGNED -	REVISED -
p:\planning\dot.illinois.gov\PIDOT\Documents\IDOT Offices\District 7\Projects\74A31\DRAWING\CADsheets\0774A31-sht-details.dgn		CHECKED -	REVISED -
Default	PLOT DATE = 4/13/2021	DATE -	REVISED -

**STATE OF ILLINOIS
DEPARTMENT OF TRANSPORTATION**

PAVING DETAILS

SCALE: SHEET OF SHEETS STA. TO STA.

F.A.U. RTE.	SECTION	COUNTY	TOTAL SHEETS	SHEET NO.
8534	D7 HMA RESURFACE 2021-1	CLAY	16	14
CONTRACT NO. 74A31				
ILLINOIS FED. AID PROJECT				

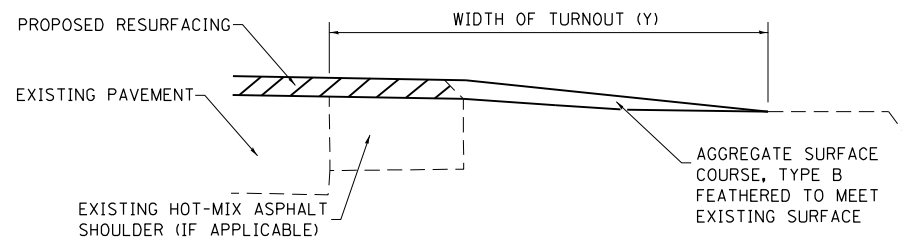
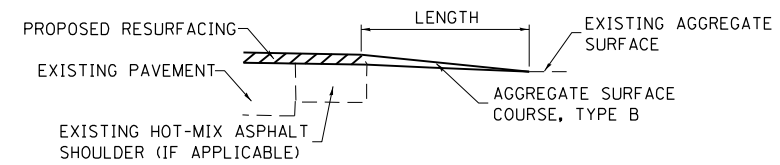
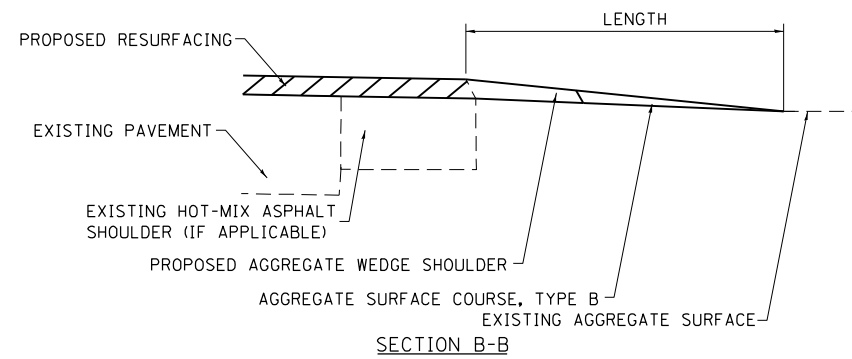
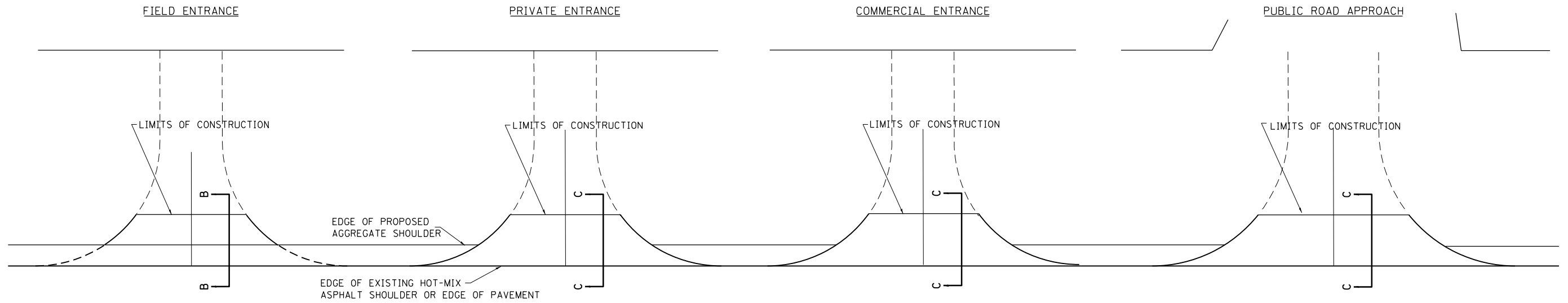

TYPICAL SECTION AT MAILBOX TURNOUT

NOTE: SEE STANDARD 406201 FOR MAILBOX TURNOUT DETAILS

NOTES

LENGTH = 2' UNLESS OTHERWISE NOTED ON PLANS

IF THERE IS NOT EXISTING HOT-MIX ASPHALT SHOULDER THEN THE ENTRANCE TAPER STARTS AT THE EDGE OF EXISTING PAVEMENT.

MODEL: Default
 FILE NAME: p:\pub\harronm.dwt
 PROJECT: 774A31\CAD\Drawings\DOT Office\Drawings\774A31-1-18-2021.dwg

USER NAME = steffnmk	DESIGNED -	REVISED -
	DRAWN -	REVISED -
PLOT SCALE = 100,0000' / in.	CHECKED -	REVISED -
PLOT DATE = 4/13/2021	DATE -	REVISED -

**STATE OF ILLINOIS
DEPARTMENT OF TRANSPORTATION**

**RURAL ENTRANCE AND MAILBOX TURNOUT DETAILS
WITH SHOULDERS**

SCALE: SHEET OF SHEETS STA. TO STA.

F.A.U. RTE.	SECTION	COUNTY	TOTAL SHEETS	SHEET NO.
8534	D7 HMA RESURFACE 2021-1	CLAY	16	15
CONTRACT NO. 74A31			ILLINOIS FED. AID PROJECT	

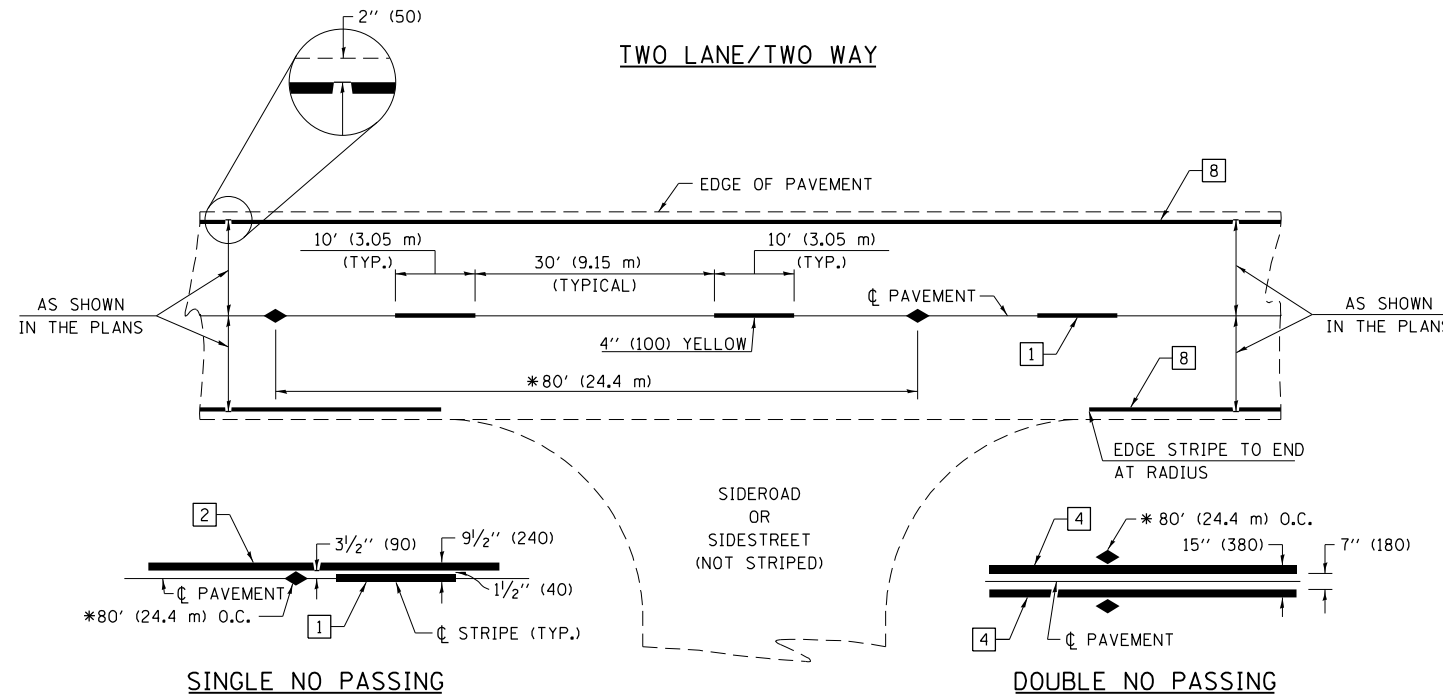

PAVEMENT MARKING LEGEND

- 1 4" (100) SKIP-DASH (YELLOW)
- 2 4" (100) SOLID (YELLOW)
- 3 12" (300) DIAGONAL (YELLOW)
- 4 4" (100) DOUBLE YELLOW (NARROW)
- 5 RESERVED
- 6 RESERVED
- 7 6" (150) SKIP-DASH (WHITE)
- 8 4" (100) SOLID (WHITE)
- 9 12" (300) DIAGONAL (WHITE)
- 10 6" (150) SOLID (WHITE)
- 11 24" (600) STOP BAR (WHITE)
- 12 8" (200) SOLID (WHITE)
- 13 4" (100) PARKING WHITE

TYPICAL PAVEMENT MARKERS LEGEND

- ◆ TWO-WAY AMBER MARKER
- ▶ ONE-WAY AMBER MARKER
- ▷ ONE-WAY CRYSTAL MARKER

RAISED REFLECTIVE PAVEMENT MARKERS

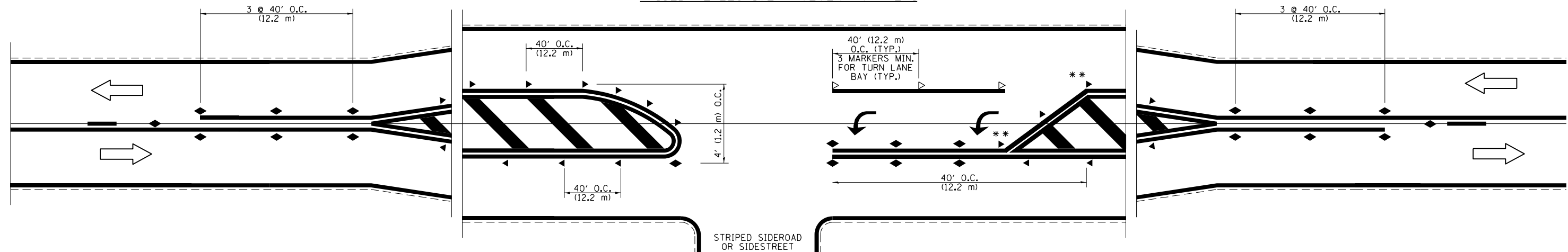

** REDUCE SPACING IF NECESSARY TO ASSURE MARKERS AT CORNER POINTS.

NOT TO SCALE

FILE NAME =	USER NAME = steffenmk	DESIGNED -	REVISED -	STATE OF ILLINOIS DEPARTMENT OF TRANSPORTATION	SCALE: NA	SHEET NO. 1 OF 4 SHEETS	STA. TO STA.	DISTRICT 7 DETAIL NO. 78000001		
pw:\plenroom.dot.illinois.gov\PIDOT\Documents\IDOT Offices\District 7\Projects\74A31\CAD\CAD sheets\0774A31-sht-details.dgn		REVISOR =	REVISED -		F.A.U. RTE.	SECTION	COUNTY		TOTAL SHEETS	SHEET NO.
		CHECKED -	REVISED -		8534	D7 HMA RESURFACE 2021-1	CLAY		16	16
		DATE -	REVISED -		CONTRACT NO. 74A31				ILLINOIS FED. AID PROJECT	