

ROUTE	SECTION	COUNTY	TOTAL SHEETS	SHEET NUMBER
VARIOUS	2007-039I	COOK	15	1

CONTRACT NO.: 60D27

FOR INDEX OF SHEETS SEE SHEET 2

STATE OF ILLINOIS
DEPARTMENT OF TRANSPORTATION
DIVISION OF HIGHWAYS
DISTRICT ONE

D-91-371-07

PROPOSED HIGHWAY PLANS

VARIOUS ROUTES
VARIOUS LOCATIONS (NEAR MIDWAY AIRPORT)
SECTION 2007-039I
CURB AND GUTTER REPAIR
COOK COUNTY
C-91-371-07

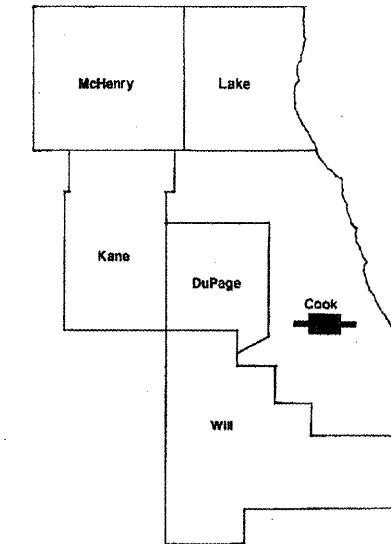

**IMPROVEMENT IS LOCATED
IN THE CITY OF CHICAGO**

LOCATION OF IMPROVEMENT INDICATED THUS: 

**IMPROVEMENT
LOCATION**

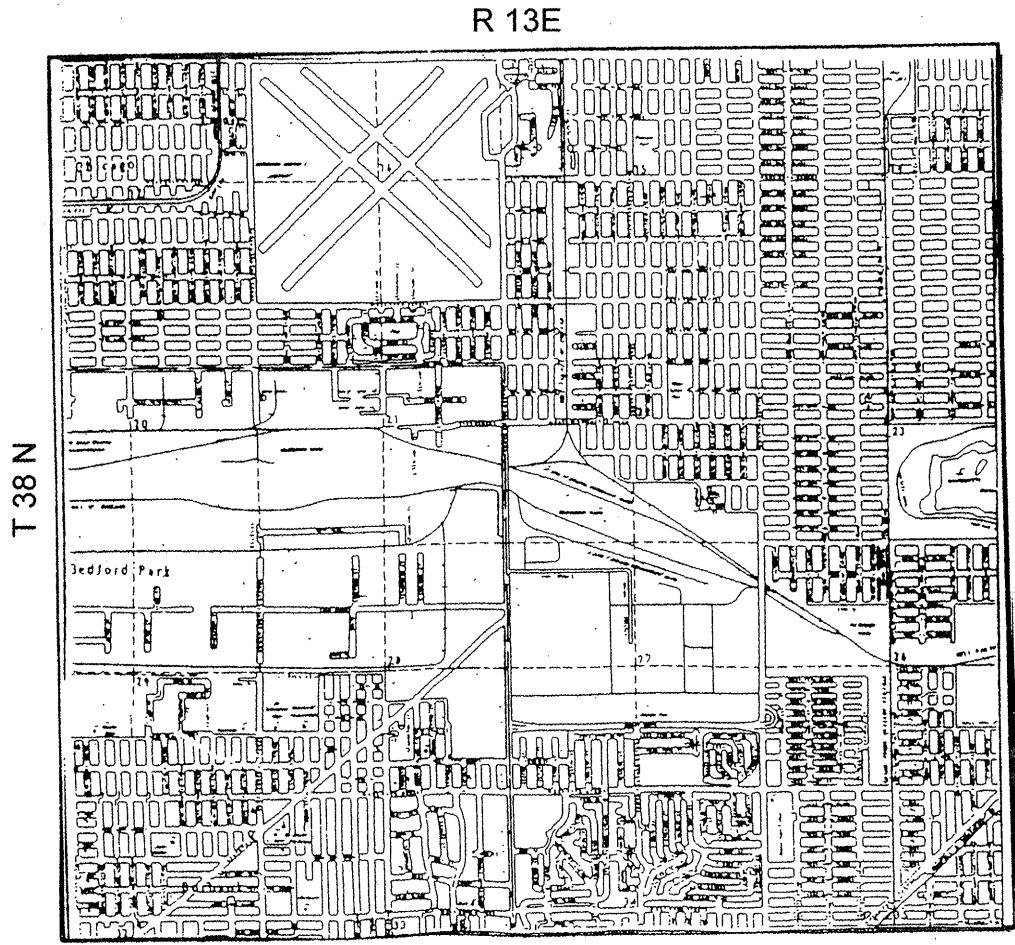

LAKE TOWNSHIP

STATE OF ILLINOIS
DEPARTMENT OF TRANSPORTATION
DIVISION OF HIGHWAYS
SUBMITTED: MARCH 30, 2009
Diana M. O'Keefe
DEPUTY DIRECTOR OF HIGHWAYS, REGION ENGINEER
May 8, 2009
Charles J. Ingersoll
ENGINEER OF DESIGN AND ENVIRONMENT
May 8, 2009
Christine M. Reed
DIRECTOR OF HIGHWAYS, CHIEF ENGINEER

**PRINTED BY THE AUTHORITY
OF THE STATE OF ILLINOIS**

C.U.A.N.: CHICAGO UTILITY ALERT
NETWORK
(312) 744-7000

DISTRICT ONE - PLAN PREPARATION ENGINEER:
KEN ENG/ R. BORO (847) 705-4178

CONTRACT NO. 60D27

ROUTE	SECTION	COUNTY	TOTAL SHEETS	SHEET NUMBER
VARIOUS	2007-039I	COOK	15	2

CONTRACT NO.: 60D27

INDEX OF SHEETS

1. TITLE SHEET
2. INDEX OF SHEETS, STATE STANDARDS, GENERAL NOTES AND MIXTURE REQUIREMENTS
3. SUMMARY OF QUANTITIES
- 4.-10. SCHEDULE OF QUANTITIES
11. DETAIL: CONCRETE DRIVEWAY
12. CURB AND GUTTER REMOVAL AND REPLACEMENT
13. CITY OF CHICAGO DETAILS FOR P.C. CONCRETE DRIVEWAY, ALLEY RETURN AND SIDEWALK
14. TRAFFIC CONTROL AND PROTECTION FOR SIDEROADS, INTERSECTIONS AND DRIVEWAYS
15. ARTERIAL ROAD INFORMATION SIGN

STATE STANDARDS

- 424001-05 SIDEWALK RAMPS ACCESSIBLE TO THE DISABLED
606001-04 CONCRETE CURB AND COMBINATION CONCRETE CURB AND GUTTER
701301-03 LANE CLOSURE, 2L, 2W, SHORT TIME OPERATIONS
701501-05 URBAN LANE CLOSURE, 2L, 2W UNDIVIDED
701801-04 LANE CLOSURE, MULTILANE, 1W OR 2W CROSSWALK OR SIDEWALK CLOSURE
701901-01 TRAFFIC CONTROL DEVICES

MIXTURE REQUIREMENTS

MIXTURE TYPE	AC TYPE	AIR VOIDS
HOT-MIX ASPHALT SURFACE COURSE, MIX "D", N50	PG 64-22	4% @ 50 GYRATIONS

NOTE: THE UNIT WEIGHT USED TO CALCULATE HOT-MIX ASPHALT SURFACE MIXTURES IS 112 LBS/SQ YD/IN.

GENERAL NOTES

BEFORE STARTING ANY EXCAVATION, THE CONTRACTOR SHALL CALL "C.U.A.N." (CHICAGO UTILITY ALERT NETWORK) AT (312)744-7000 FOR FIELD LOCATIONS OF BURIED ELECTRIC, TELEPHONE AND GAS UTILITIES. (48 HOUR NOTIFICATION IS REQUIRED).

THE CONTRACTOR WILL NOT BE ALLOWED TO SET UP A YARD OR FIELD OFFICE ON STATE PROPERTY WITHOUT WRITTEN PERMISSION FROM THE DEPARTMENT.

WHEN CONSTRUCTING SIDEWALK RAMPS FOR THE HANDICAPPED (STATE STANDARD 424001), USE TYPE B RAMPS UNLESS OTHERWISE SPECIFIED.

THESE PLANS HAVE BEEN PREPARED FROM NOTES RECEIVED FROM FIELD MAINTENANCE ENGINEERS.

THE COST OF HOT-MIX ASPHALT REMOVAL IN THE EXISTING GUTTER FLAG WILL BE INCLUDED IN THE UNIT PRICE BID FOR COMBINATION CURB AND GUTTER REMOVAL AND REPLACEMENT.

ALL DAMAGE TO EXISTING PAVEMENT MARKINGS SHALL BE REPLACED AT THE CONTRACTOR'S EXPENSE.

THE ENGINEER SHALL OBTAIN APPROVAL FROM THE DISTRICT ONE BUREAU CHIEF OF MAINTENANCE FOR ANY PROPOSED REVISIONS IN THE SCHEDULED CURB AND GUTTER REPAIR LOCATIONS.

DO NOT SCALE PLANS FOR CONSTRUCTION DIMENSIONS.

ALL CURBS AND GUTTERS ARE TYPE B6-12

PAINT CURB YELLOW AT FIRE HYDRANTS ACCORDING TO THE APPLICABLE REQUIREMENTS OF SECTION 780 OF THE STANDARD SPECIFICATIONS FOR PAINTED PAVEMENT MARKINGS, EXCEPT THE COST SHALL NOT BE PAID FOR SEPERATELY BUT SHALL BE INCLUDED IN "COMB. CONC. C&G, REMOVAL AND REPLACEMENT."

ADJACENT PARALLEL SIDEWALK, REMOVE AND REPLACE ENTIRE WIDTH OF SIDEWALK JOINT TO JOINT

ILLINOIS DEPARTMENT OF TRANSPORTATION

INDEX OF SHEETS
STATE STANDARDS
GENERAL NOTES

ROUTE	SECTION	COUNTY	TOTAL SHEETS	SHEET NUMBER
VARIOUS	2007-039I	COOK	15	3

CONTRACT NO.: 60D27

CONSTRUCTION CODE TYPE: SFTY - 1B			COOK CO.
CODE NO.	ITEMS	UNITS	TOTAL QUANTITIES
20201200	REMOVAL AND DISPOSAL OF UNSUITABLE MATERIAL	CU YD	203
40603335	HOT-MIX ASPHALT SURFACE COURSE, MIX "D", N50	TON	80
42001300	PROTECTIVE COAT	SQ YD	2,839
42300400	PORTLAND CEMENT CONCRETE DRIVEWAY PAVEMENT, 8 INCH	SQ YD	64
42400100	PORTLAND CEMENT CONCRETE SIDEWALK 4 INCH	SQ FT	16,439
42400200	PORTLAND CEMENT CONCRETE SIDEWALK 5 INCH	SQ FT	2,834
44000200	DRIVEWAY PAVEMENT REMOVAL	SQ YD	64
44000600	SIDEWALK REMOVAL	SQ FT	2,834
44001700	COMBINATION CONCRETE CURB AND GUTTER REMOVAL AND REPLACEMENT	FOOT	2850
67000400	ENGINEER'S FIELD OFFICE, TYPE A	CAL MO	4
67100100	MOBILIZATION	L SUM	1
70102620	TRAFFIC CONTROL AND PROTECTION, STANDARD 701501	L SUM	1
70102640	TRAFFIC CONTROL AND PROTECTION, STANDARD 701801	L SUM	1
X0322256	TEMPORARY INFORMATION SIGNING	SQ FT	308.4
X4400088	HOT-MIX ASPHALT SURFACE REMOVAL, FULL DEPTH	SQ YD	475

ILLINOIS DEPARTMENT OF TRANSPORTATION

SUMMARY OF QUANTITIES

ROUTE	SECTION	COUNTY	TOTAL SHEETS	SHEET NUMBER
VARIOUS	2007-0391	COOK	15	4

CONTRACT: 60D27

LOCATION	COMB. CONC. C & G R&R (LF)	HMA SURF R&R FULL DEPTH (SQ YD)	SIDEWALK 5" R&R (SQ FT) 18" CARRIAGE	SIDEWALK 5" R&R (SQ FT) 5' PARALLEL	DRIVEWAY 8" R&R (SQ FT)	SALT TOLERANT SODDING (SQ YD)	REMARKS
7742 S. Kolmar	10.0	1.7	0.0	0.0	0.0	1.7	5' behind TY1 Structure and also 5' near driveway
7738 S. Kolmar	8.0	1.3	0.0	0.0	12.0	0.0	
6149 S. Keating	5.0	0.8	7.5	0.0	0.0	0.0	
6219 S. Keating	8.0	1.3	4.5	0.0	0.0	0.8	
6013 S. Keating	6.0	1.0	4.5	0.0	0.0	0.5	
7705 S. Keating	5.0	0.8	0.0	0.0	0.0	0.8	
7728 S. Keating	10.0	1.7	0.0	0.0	0.0	1.7	
7721 S. Keating	10.0	1.7	15.0	0.0	0.0	0.0	
7717 S. Keating	5.0	0.8	0.0	0.0	0.0	0.8	
7716 S. Keating	10.0	1.7	15.0	0.0	0.0	0.0	
7706 S. Keating	10.0	1.7	0.0	0.0	4.5	1.2	
6558 S. Kolin	10.0	1.7	0.0	0.0	0.0	1.7	Curb behind Type 1 Structure
6329 S. Kolin	7.0	1.2	0.0	0.0	0.0	1.2	Curb behind Type 1 Structure
5611 S. Kolin	6.0	1.0	0.0	0.0	0.0	1.0	Adj to Sewer
6609 S. Kolin	5.0	0.8	7.5	0.0	0.0	0.0	
6758 S. Kolin	10.0	1.7	0.0	0.0	0.0	1.7	
6240 S. Kolin	5.0	0.8	0.0	0.0	0.0	0.8	
6140 S. Kolin	5.0	0.8	0.0	0.0	0.0	0.8	
6331 S. Tripp	5.0	0.8	7.5	0.0	0.0	0.0	
7742 S. Tripp	5.0	0.8	0.0	0.0	0.0	0.8	Adj to Sewer
6049 S. Tripp	5.0	0.8	7.5	0.0	0.0	0.0	
6758 S. Tripp	15.0	2.5	22.5	0.0	0.0	0.0	
6328 S. Tripp	5.0	0.8	7.5	0.0	0.0	0.0	Adj to Sewer
5546 S. Tripp	5.0	0.8	7.5	0.0	0.0	0.0	
6138 S. Tripp	5.0	0.8	4.5	0.0	0.0	0.3	
5638 S. Keeler	5.0	0.8	7.5	0.0	0.0	0.0	
5637 S. Keeler	5.0	0.8	0.0	0.0	0.0	0.8	
5910 S. Keeler	5.0	0.8	0.0	0.0	0.0	0.8	
6513 S. Keeler	10.0	1.7	9.0	0.0	0.0	0.0	Two separate locations 5' each
6835 S. Keeler	5.0	0.8	0.0	0.0	0.0	0.8	
6004 S. Keeler	12.0	2.0	9.0	0.0	0.0	1.0	
6010 S. Keeler	5.0	0.8	0.0	0.0	0.0	0.8	
6048 S. Keeler	5.0	0.8	0.0	0.0	0.0	0.8	Curb behind type 1 structure
6058 S. Keeler	5.0	0.8	0.0	0.0	0.0	0.8	Side of house on 61st St
6558 S. Keeler	6.0	1.0	9.0	0.0	0.0	0.0	No curbs on side of house
6049 - 6057 S. Keeler	20.0	3.3	0.0	0.0	0.0	3.3	Eastside By Park
6720 S. Kevdale	5.0	0.8	0.0	0.0	0.0	0.8	
5901 S. Pulaski	7.0	1.2	0.0	35.0	0.0	0.0	In front of B.P. Amocco
SUB-TOTAL	275.0	45.8	145.5	35.0	16.5	26.0	

ILLINOIS DEPARTMENT OF TRANSPORTATION

SCHEDULE OF QUANTITIES

ROUTE	SECTION	COUNTY	TOTAL SHEETS	SHEET NUMBER
VARIOUS	2007-039I	COOK	15	5

CONTRACT: 60D27

LOCATION	COMB. CONC. C & G R&R (LF)	HMA SURF R&R FULL DEPTH (SQ YD)	SIDEWALK 5" R&R (SQ FT) 18" CARRIAGE	SIDEWALK 5" R&R (SQ FT) 5' PARALLEL	DRIVEWAY 8" R&R (SQ FT)	SALT TOLERANT SODDING (SQ YD)	REMARKS
5901 S. Pulaski	7.0	1.2	0.0	35.0	0.0	0.0	In front of B.P. Amocco
6225 S. Pulaski	10.0	1.7	0.0	50.0	0.0	0.0	4 Locations totaling 10'
5734 S. Pulaski	6.0	1.0	0.0	30.0	0.0	0.0	Located side of building adjacent to asphalt.
8140 S. Knox	15.0	2.5	0.0	75.0	0.0	0.0	Sunken Curb-Holds water on pavement.
8169 S. Knox	35.0	5.8	0.0	170.0	21.0	0.0	Make Curb Handicap Accessible
7809 S. Knox	10.0	1.7	3.0	0.0	0.0	1.3	
7817 S. Kenton	5.0	0.8	0.0	0.0	7.5	0.0	
8049 S. Kenton	5.0	0.8	0.0	0.0	0.0	0.8	
7814 S. Kenton	5.0	0.8	0.0	0.0	0.0	0.8	
5738 S. Kenneth	5.0	0.8	0.0	0.0	0.0	0.8	
7842 S. Kenneth	5.0	0.8	0.0	0.0	0.0	0.8	
7835 S. Kenneth	5.0	0.8	0.0	0.0	0.0	0.8	
7826 S. Kenneth	5.0	0.8	0.0	0.0	0.0	0.8	Curb Painted Yellow
7821 S. Kenneth	8.0	1.3	0.0	0.0	0.0	1.3	
7721 S. Kenneth	5.0	0.8	0.0	0.0	0.0	0.8	Adj to sewer
7800 S. Kenneth	5.0	0.8	0.0	0.0	0.0	0.8	
7720 S. Kenneth	5.0	0.8	0.0	0.0	0.0	0.8	
7820 S. Kenneth	5.0	0.8	0.0	0.0	0.0	0.8	Curb Behind Type 1 Structure
7763 S. Kenneth	13.0	2.2	0.0	0.0	16.5	0.3	
7737 S. Kenneth	20.0	3.3	0.0	0.0	16.5	1.5	
7729 S. Kenneth	5.0	0.8	0.0	0.0	0.0	0.8	
7725 S. Kenneth	5.0	0.8	0.0	0.0	0.0	0.8	
7724 S. Kenneth	5.0	0.8	0.0	0.0	0.0	0.8	
7730 S. Kenneth	5.0	0.8	0.0	0.0	0.0	0.8	
7754 S. Kenneth	5.0	0.8	0.0	0.0	7.5	0.0	
6811 S. Kenneth	5.0	0.8	0.0	0.0	0.0	0.8	Adj to Sewer
5701 S. Kenneth	15.0	2.5	0.0	0.0	0.0	2.5	
5755 S. Kenneth	5.0	0.8	7.5	0.0	0.0	0.0	
6219 S. Kenneth	8.0	1.3	12.0	0.0	0.0	0.0	
7745 S. Kenneth	5.0	0.8	0.0	0.0	0.0	0.8	Adj to sewer
7721 S. Kenneth	5.0	0.8	0.0	0.0	0.0	0.8	
5625 S. Kenneth	10.0	1.7	0.0	0.0	0.0	1.7	
7763 S. Kilbourn	5.0	0.8	0.0	0.0	7.5	0.0	
7849 S. Kilbourn	0.0	0.0	0.0	0.0	15.0	0.0	
7717 S. Kilbourn	5.0	0.8	0.0	0.0	0.0	0.8	
7725 S. Kilbourn	5.0	0.8	0.0	0.0	4.5	0.3	
7729 S. Kilbourn	5.0	0.8	0.0	0.0	0.0	0.8	
7755 S. Kilbourn	5.0	0.8	0.0	0.0	4.5	0.3	Curb Behind Type 1 Structure
7745 S. Kilbourn	5.0	0.8	0.0	0.0	0.0	0.8	
7812 S. Kilbourn	10.0	1.7	15.0	0.0	0.0	0.0	
6359 S. Kilbourn	0.0	0.0	0.0	0.0	0.0	0.0	Install Handicap Walk on side of house
6108 S. Kilbourn	6.0	1.0	0.0	0.0	0.0	1.0	Adj to sewer
5911 S. Kilbourn	5.0	0.8	0.0	0.0	0.0	0.8	Adj to sewer
6639 S. Kilbourn	20.0	3.3	30.0	0.0	0.0	0.0	Adj to Sewer
6540 S. Kilbourn	15.0	2.5	0.0	0.0	0.0	2.5	
SUB-TOTAL	343.0	57.2	67.5	360.0	100.5	30.3	

ILLINOIS DEPARTMENT OF TRANSPORTATION

SCHEDULE OF QUANTITIES

ROUTE	SECTION	COUNTY	TOTAL SHEETS	SHEET NUMBER
VARIOUS	2007-0391	COOK	15	6

CONTRACT: 60D27

LOCATION	COMB. CONC. C & G R&R (LF)	HMA SURF R&R FULL DEPTH (SQ YD)	SIDEWALK 5" R&R (SQ FT) 18" CARRIAGE	SIDEWALK 5" R&R (SQ FT) 5' PARALLEL	DRIVEWAY 8" R&R (SQ FT)	SALT TOLERANT SODDING (SQ YD)	REMARKS
6505 S. Kilbourn	10.0	1.7	15.0	0.0	0.0	0.0	Adj to Sewer
7801 S. Kilbourn	5.0	0.8	0.0	0.0	0.0	0.8	
7803 S. Kilbourn	5.0	0.8	0.0	0.0	0.0	0.8	
8029 S. Kilbourn	5.0	0.8	0.0	25.0	0.0	0.0	
4336 W 77th Pl	5.0	0.8	0.0	0.0	0.0	0.8	
4320 W 77th Pl	10.0	1.7	0.0	0.0	15.0	0.0	
4324 W 77th Pl	10.0	1.7	0.0	0.0	15.0	0.0	
4304 W 77th Pl	5.0	0.8	0.0	0.0	0.0	0.8	
4240 W 77th Pl	10.0	1.7	0.0	0.0	15.0	0.0	Adj. to sewer
4206 W 77th Pl	10.0	1.7	0.0	0.0	15.0	0.0	
4100 W. 77th PL	12.0	2.0	0.0	60.0	0.0	0.0	
4442 W. 77th PL	5.0	0.8	0.0	0.0	7.5	0.0	
4352 W. 77th PL	5.0	0.8	0.0	0.0	0.0	0.8	
4353 W. 77th PL	11.0	1.8	0.0	0.0	16.5	0.0	
4349 W. 77th PL	5.0	0.8	0.0	0.0	0.0	0.8	Curb Behind Type 1 Structure
4348 W. 77th PL	5.0	0.8	0.0	0.0	0.0	0.8	
4343 W. 77th PL	5.0	0.8	0.0	0.0	0.0	0.8	
4344 W. 77th PL	19.0	3.2	0.0	0.0	21.0	0.8	
4340 W. 77th PL	16.0	2.7	0.0	0.0	16.5	0.8	Driveway plus 2.5' on each side.
4341 W. 77th PL	39.0	6.5	0.0	0.0	16.5	4.7	
4337 W. 77th PL	7.0	1.2	0.0	0.0	0.0	1.2	
4332 W. 77th PL	5.0	0.8	0.0	0.0	0.0	0.8	Curb Painted Yellow
4328 W. 77th PL	5.0	0.8	0.0	0.0	0.0	0.8	
4329 W. 77th PL	5.0	0.8	0.0	0.0	0.0	0.8	
4309 W. 77th PL	5.0	0.8	0.0	0.0	7.5	0.0	
4308 W. 77th PL	10.0	1.7	0.0	0.0	15.0	0.0	
4236 W. 77th PL	5.0	0.8	0.0	0.0	7.5	0.0	
4438 W. 77th PL	11.0	1.8	0.0	0.0	13.5	0.3	
4438 W. 77th PL	11.0	1.8	0.0	0.0	13.5	0.3	
4513 W. 77th St	5.0	0.8	0.0	0.0	0.0	0.8	
4304 W. 78th St.	5.0	0.8	7.5	0.0	0.0	0.0	
4305 W. 78th St.	5.0	0.8	0.0	0.0	7.5	0.0	
4309 W. 78th St.	5.0	0.8	0.0	0.0	7.5	0.0	
4324 W. 78th St.	5.0	0.8	0.0	0.0	0.0	0.8	Curb Painted Yellow
4325 W. 78th St.	5.0	0.8	7.5	0.0	0.0	0.0	
4329 W. 78th St.	5.0	0.8	7.5	0.0	0.0	0.0	
4336 W. 78th St.	5.0	0.8	0.0	0.0	0.0	0.8	
4349 W. 78th St.	5.0	0.8	0.0	0.0	7.5	0.0	
4348 W. 78th St.	5.0	0.8	0.0	0.0	7.5	0.0	
4352 W. 78th St.	5.0	0.8	0.0	0.0	7.5	0.0	
4353 W. 78th St.	5.0	0.8	0.0	0.0	7.5	0.0	
4121 W. 78th St	5.0	0.8	0.0	0.0	0.0	0.8	
4341 W 78th St	5.0	0.8	0.0	0.0	0.0	0.8	
4619 W. 79th Pl	5.0	0.8	0.0	25.0	0.0	0.0	
4620 W. 79th Pl	5.0	0.8	0.0	25.0	0.0	0.0	
7958 S. Komensky	15.0	2.5	0.0	0.0	0.0	2.5	
7721 S. Komensky	11.0	1.8	0.0	55.0	0.0	0.0	
6558 S. Komensky	15.0	2.5	4.5	0.0	0.0	2.0	
6740 S. Komensky	5.0	0.8	3.0	0.0	0.0	0.5	
8118 S. Komensky	5.0	0.8	0.0	25.0	0.0	0.0	
SUB-TOTAL	392.0	65.3	45.0	215.0	240.0	26.5	

ILLINOIS DEPARTMENT OF TRANSPORTATION
SCHEDULE OF QUANTITIES

ROUTE	SECTION	COUNTY	TOTAL SHEETS	SHEET NUMBER
VARIOUS	2007-039I	COOK	15	7

CONTRACT: 60D27

LOCATION	COMB. CONC. C & G R&R (LF)	HMA SURF R&R FULL DEPTH (SQ YD)	SIDEWALK 5" R&R (SQ FT) 18" CARRIAGE	SIDEWALK 5" R&R (SQ FT) 5' PARALLEL	DRIVEWAY 8" R&R (SQ FT)	SALT TOLERANT SODDING (SQ YD)	REMARKS
6841 S. Karlov	5.0	0.8	0.0	0.0	0.0	0.8	
6645 S. Karlov	12.0	2.0	3.0	0.0	0.0	1.7	
5532 S. Karlov	5.0	0.8	7.5	0.0	0.0	0.0	
6050 S. Karlov	7.0	1.2	0.0	0.0	0.0	1.2	Westside By Park
6243 S. Karlov	5.0	0.8	0.0	0.0	0.0	0.8	Near Alley
7939 S. Karlov	5.0	0.8	0.0	0.0	0.0	0.8	
7949 S. Karlov	5.0	0.8	0.0	0.0	0.0	0.8	
7865 S. Karlov	6.0	1.0	0.0	0.0	0.0	1.0	
6406 S. Kedvale	10.0	1.7	0.0	0.0	0.0	1.7	
6824 S. Kedvale	0.0	0.0	42.0	0.0	0.0	0.0	Carraige walk only curb Ok
5945 S. Kedvale	5.0	0.8	7.5	0.0	0.0	0.0	
6242 S. Kedvale	5.0	0.8	7.5	0.0	0.0	0.0	
7939 S. Kedvale	5.0	0.8	0.0	0.0	0.0	0.8	
5900 S. Kolmar	10.0	1.7	0.0	0.0	0.0	1.7	Adj to Sewer
6027 S. Kolmar	5.0	0.8	0.0	0.0	0.0	0.8	Adj to Sewer
6046 S. Kolmar	6.0	1.0	0.0	0.0	0.0	0.8	Adj to Sewer
7817 S. Kolmar	10.0	1.7	0.0	0.0	0.0	1.7	Adj to Sewer
7845 S. Kilpatrick	5.0	0.8	7.5	0.0	0.0	0.0	
7821 S. Kilpatrick	10.0	1.7	0.0	0.0	15.0	0.0	
6331 S Kilpatrick	5.0	0.8	7.5	0.0	0.0	0.0	Carriage walk sunk
7801 S. Kilpatrick	6.0	1.0	0.0	0.0	0.0	1.0	
7210 S. Hamlin	10.0	1.7	3.0	0.0	0.0	1.3	
7138 S. Hamlin	5.0	0.8	7.5	0.0	0.0	0.0	
7128 S. Hamlin	5.0	0.8	7.5	0.0	0.0	0.0	
7248 S. Hamlin	5.0	0.8	7.5	0.0	0.0	0.0	
7112 - 7158 S. Hamlin (Church Side)	200.0	33.3	0.0	1000.0	0.0	0.0	In Front of Church
7232 S. Ridgeway	5.0	0.8	7.5	0.0	0.0	0.0	
7230 S. Ridgeway	5.0	0.8	0.0	0.0	0.0	0.8	
7222 S. Lawndale	5.0	0.8	7.5	0.0	0.0	0.0	
7209 S. Lawndale	5.0	0.8	7.5	0.0	0.0	0.0	
7154 S. Lawndale	5.0	0.8	0.0	0.0	0.0	0.8	
7122 S. Springfield	5.0	0.8	7.5	0.0	0.0	0.0	
6732 S. Springfield	5.0	0.8	7.5	0.0	0.0	0.0	
5939 S. Springfield	10.0	1.7	0.0	0.0	0.0	0.0	
7245 S. Avers	5.0	0.8	7.5	0.0	0.0	0.0	
7215 S. Avers	5.0	0.8	0.0	0.0	0.0	0.8	
4146 W. 56th Pl	10.0	1.7	0.0	0.0	0.0	1.7	
4029 W 56th Pl	10.0	1.7	6.0	0.0	0.0	1.0	
3924 57th PL	5.0	0.8	0.0	0.0	0.0	0.8	Near Driveway - Curb behind Type 1 Structure
SUB-TOTAL	437.0	72.8	159.0	1000.0	15.0	23.0	

ILLINOIS DEPARTMENT OF TRANSPORTATION

SCHEDULE OF QUANTITIES

ROUTE	SECTION	COUNTY	TOTAL SHEETS	SHEET NUMBER
VARIOUS	2007-0391	COOK	15	8

CONTRACT: 60D27

LOCATION	COMB. CONC. C & G R&R (LF)	HMA SURF R&R FULL DEPTH (SQ YD)	SIDEWALK 5" R&R (SQ FT) 18" CARRIAGE	SIDEWALK 5" R&R (SQ FT) 5' PARALLEL	DRIVEWAY 8" R&R (SQ FT)	SALT TOLERANT SODDING (SQ YD)	REMARKS
4129 W 57th St	5.0	0.8	7.5	0.0	0.0	0.0	
4117 W. 57th St	0.0	0.0	34.5	0.0	0.0	0.0	Replace Carriage Walk Only
3906 W. 57th St	5.0	0.8	7.5	0.0	0.0	0.0	
3842 W. 57th St	10.0	1.7	0.0	0.0	0.0	1.7	
4129 W. 57th PL	10.0	1.7	9.0	0.0	0.0	0.7	Curb behind Type 1 Structure - Sunken Carriage Walk
4144 W. 57th Pl	10.0	1.7	6.0	0.0	0.0	0.7	
3946 W. 58th St	5.0	0.8	7.5	0.0	0.0	0.0	
3846 W. 58th Pl	10.0	1.7	15.0	0.0	0.0	0.0	
3721 W. 59th PL	12.0	2.0	18.0	0.0	0.0	0.0	Sunken Carriage Walk
3827 61st St.	5.0	0.8	0.0	0.0	0.0	0.8	
4720 W. 61st St	6.0	1.0	0.0	0.0	0.0	1.0	
3800 W. 62nd St	680.0	113.3	0.0	50.0	0.0	111.7	
3744 W. 62nd Pl	20.0	3.3	7.5	0.0	0.0	2.5	Sunken Carriage
6033 W. 63rd PL	5.0	0.8	7.5	0.0	0.0	0.0	26' of sunken carriage walk
6225 W. 64th St	5.0	0.8	0.0	0.0	0.0	0.8	Curb behind Type 1 Structure
6130 W. 64th St	5.0	0.8	7.5	0.0	0.0	0.0	
3708 W. 65th Pl	5.0	0.8	0.0	0.0	0.0	0.8	Adj To Sewer
3712 W. 65th Pl	5.0	0.8	0.0	0.0	0.0	0.8	
3730 W. 65th Pl	7.0	1.2	10.5	0.0	0.0	0.0	
3813 W. 65th Pl	10.0	1.7	0.0	0.0	0.0	1.7	Adj to Sewer
3858 W. 65th St	115.0	19.2	0.0	0.0	18.0	17.5	Side of house on Springfield
4517 W. 65th St	14.0	2.3	0.0	0.0	21.0	0.0	Depressed Curb
3700 W. 66th St.	6.0	1.0	0.0	0.0	9.0	0.0	Depressed Curb
4505 W. 66th St	5.0	0.8	0.0	0.0	0.0	0.8	
3742 W. 66th PL	6.0	1.0	9.0	0.0	0.0	0.0	Curb behind Type 1 Structure
3845 W. 66th PL	5.0	0.8	7.5	0.0	0.0	0.0	
3858 W. 66th PL	30.0	5.0	25.5	0.0	0.0	2.2	
3801 W. 67th PL	10.0	1.7	0.0	0.0	0.0	1.7	5' near corner/sewer 5' near alley
3839 W. 67th PL	0.0	0.0	22.5	0.0	0.0	0.0	Carriage Only Curb Ok
3845 W. 67th PL	5.0	0.8	7.5	0.0	0.0	0.0	
3810 W. 68th St	10.0	1.7	0.0	0.0	0.0	1.7	
3848 W. 68th St	5.0	0.8	7.5	0.0	0.0	0.0	
3840 W. 68th St	25.0	4.2	37.5	0.0	0.0	0.0	
3830 W. 68th St	9.0	1.5	13.5	0.0	0.0	0.0	
3704 W. 68th St	12.0	2.0	18.0	0.0	0.0	0.0	Curb and Sunken Carriage Walk
3901 W. 68th St	44.0	7.3	0.0	30.0	57.0	0.0	Driveway & Alley Wrap
3900 W. 68th St	41.0	6.8	0.0	30.0	52.5	0.0	Driveway & Alley Wrap
3926 W. 68th St	5.0	0.8	7.5	0.0	0.0	0.0	
3849 W. 68th St.	0.0	0.0	43.5	0.0	0.0	0.0	
3900 W. 68th PL	29.0	4.8	0.0	0.0	43.5	0.0	
3752 W. 69th PL	15.0	2.5	7.5	0.0	0.0	1.7	
3639 W. 69th PL	10.0	1.7	15.0	0.0	0.0	0.0	
3845 W. 69th PL	5.0	0.8	0.0	0.0	0.0	0.8	
3630 W. 70th PL	20.0	3.3	12.0	0.0	0.0	2.0	
3835 W. 70th Pl	10.0	1.7	15.0	0.0	0.0	0.0	
3901 W. 71st St	20.0	3.3	0.0	0.0	0.0	3.3	
4200 W. 82nd St	5.0	0.8	0.0	25.0	0.0	0.0	On Side Of House (Springfield)
SUB-TOTAL	1281.0	213.5	387.0	135.0	201.0	154.8	

ILLINOIS DEPARTMENT OF TRANSPORTATION

SCHEDULE OF QUANTITIES

ROUTE	SECTION	COUNTY	TOTAL SHEETS	SHEET NUMBER
VARIOUS	2007-0391	COOK	15	9

CONTRACT: 60D27

LOCATION	COMB. CONC. C & G R&R (LF)	HMA SURF R&R FULL DEPTH (SQ YD)	SIDEWALK 5" R&R (SQ FT) 18" CARRIAGE	SIDEWALK 5" R&R (SQ FT) 5' PARALLEL	DRIVEWAY 8" R&R (SQ FT)	SALT TOLERANT SODDING (SQ YD)	REMARKS
6100 S. Kildare	5.0	0.8	0.0	0.0	0.0	0.8	Side of house on 61st St
6320 S. Kildare	5.0	0.8	0.0	0.0	0.0	0.8	
6354 S. Kildare	5.0	0.8	7.5	0.0	0.0	0.0	
5501 S. Kildare	5.0	0.8	0.0	0.0	0.0	0.8	
5535 S. Kildare	5.0	0.8	0.0	0.0	0.0	0.8	
6320 S. Kildare	5.0	0.8	0.0	0.0	0.0	0.8	
5501 S. Kildare	5.0	0.8	0.0	0.0	0.0	0.8	
6354 S. Kildare	5.0	0.8	7.5	0.0	0.0	0.0	
5906 S. Kildare	5.0	0.8	0.0	0.0	0.0	0.8	
5942 S. Kildare	5.0	0.8	0.0	0.0	0.0	0.8	
6141 S. Kildare	5.0	0.8	0.0	0.0	0.0	0.8	
6332 S. Lavergne	5.0	0.8	0.0	0.0	0.0	0.8	
6417 S. Narragansett	5.0	0.8	7.5	0.0	0.0	0.0	Start North of driveway
3841 W. Marquette	6.0	1.0	30.0	0.0	0.0	0.0	
3801 W. Marquette	0.0	0.0	15.0	0.0	0.0	0.0	Curb OK-Replace Carriage Walk
3841 W. Marquette	20.0	3.3	30.0	0.0	0.0	0.0	
6416 S. Kostner	0.0	0.0	34.5	0.0	0.0	0.0	Replace Carriage Walk Only
6412 S. Kostner	0.0	0.0	43.5	0.0	0.0	0.0	Replace Carriage Walk Only
6410 S. Kostner	0.0	0.0	9.9	0.0	0.0	0.0	Replace Carriage Walk Only
6411 S. Kostner	0.0	0.0	15.0	0.0	0.0	0.0	Replace Carriage Walk Only
6415 S. Kostner	0.0	0.0	24.5	0.0	0.0	0.0	Replace Carriage Walk Only
6423 S. Kostner	0.0	0.0	14.1	0.0	0.0	0.0	Replace Carriage Walk Only
6143 S. Mason	31.0	5.2	46.5	0.0	0.0	0.0	Install Carriage Walk
SUB-TOTAL	122.0	20.3	285.5	0.0	0.0	8.3	

TOTAL FOR PROJECT	2850.0	475.0	1089.5	1745.0	573.0	269.0
--------------------------	---------------	--------------	---------------	---------------	--------------	--------------

ILLINOIS DEPARTMENT OF TRANSPORTATION

SCHEDULE OF QUANTITIES

ROUTE	SECTION	COUNTY	TOTAL SHEETS	SHEET NUMBER
VARIOUS	2007-0391	COOK	15	10

CONTRACT: 60D27

PARKWAYS

STREET	FROM	TO	LENGTH	WIDTH *	SIDEWALK 4" (SQ FT)	COMMENTS
Marquette Rd. South Side	Lawndale	Central Pk	508.0	6.6	3,352.8	
Marquette Rd. North Side	Lawndale	Central Pk	500.0	6.3	3,150.0	Include corner
Marquette Rd. South Side	Hamlin	Lawndale	492.0	6.0	2,952.0	Include corner
Marquette Rd. North Side	Hamlin	Lawndale	536.0	6.0	3,216.0	
Marquette Rd. South Side	Springfield	Pulaski	375.0	6.0	2,250.0	Up to east of alley
W.Marquette Rd.	3855 W.Marquette Rd.	N/A	30.0	6.1	183.0	
W.Marquette Rd.	3916 W.Marquette Rd.	N/A	28.0	6.2	173.6	
W.Marquette Rd.	3920 W.Marquette Rd.	N/A	37.0	6.2	229.4	
W.Marquette Rd.	3922 W.Marquette Rd.	N/A	29.0	6.2	179.8	
W.Marquette Rd.	3930 W.Marquette Rd.	N/A	48.0	6.2	297.6	
W.Marquette Rd.	3934 W.Marquette Rd.	N/A	36.0	5.0	180.0	
W.Marquette Rd.	3938 W.Marquette Rd.	N/A	35.0	5.0	175.0	
W.Marquette Rd.	3942 W.Marquette Rd.	N/A	40.0	2.5	100.0	
TOTAL =					16,439.2	

* PARKWAYS ARE DEFINED AS THE AREA BETWEEN BACK OF CURB AND THE SIDEWALK

EARTH EXCAVATION FOR THE PCC SIDEWALK 4"AND REMOVAL OF EXISTING ITEMS SUCH AS PAVER BRICKS ARE INCLUDED IN THE COST OF REMOVAL AND DISPOSAL OF UNSUITABLE MATERIAL

ILLINOIS DEPARTMENT OF TRANSPORTATION

SCHEDULE OF QUANTITIES

ROUTE	SECTION	COUNTY	TOTAL SHEETS	SHEET NUMBER
VARIOUS	2007-0391	COOK	15	11

CONTRACT NO.: 60D27

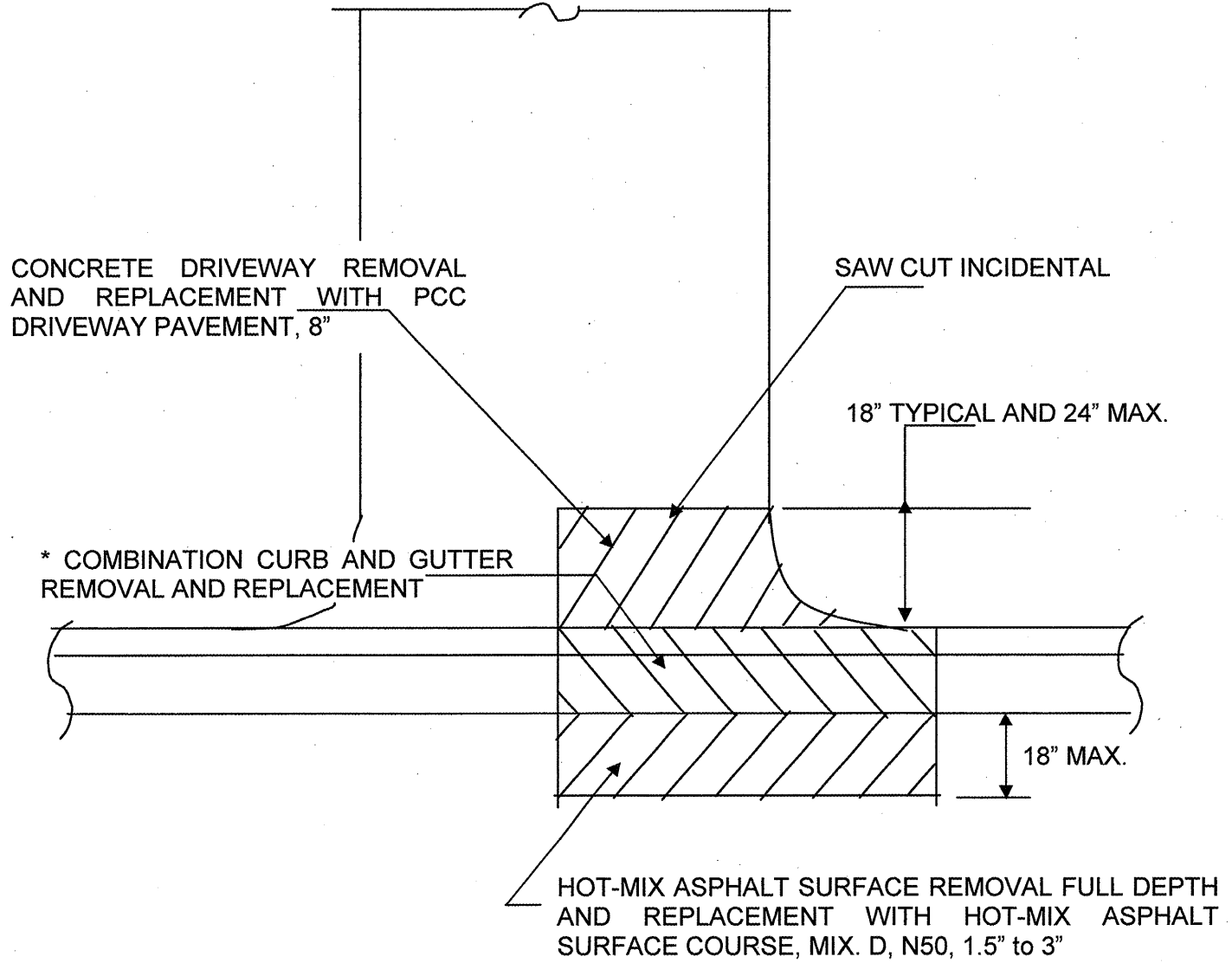

PLAN VIEW

* PROPOSED DEPRESSED CURB AND EXACT LENGTH SHALL BE DETERMINED IN THE FIELD BY THE ENGINEER (TYPICAL)

ILLINOIS DEPARTMENT OF TRANSPORTATION
DETAIL: CONCRETE DRIVEWAY

F.A. RTE.	SECTION	COUNTY	TOTAL SHEETS	SHEET NO.
	2007-0351	COOK	15	12
STA.		TO STA.		
FED. ROAD DIST. NO. 1		ILLINOIS FED. AID PROJECT		

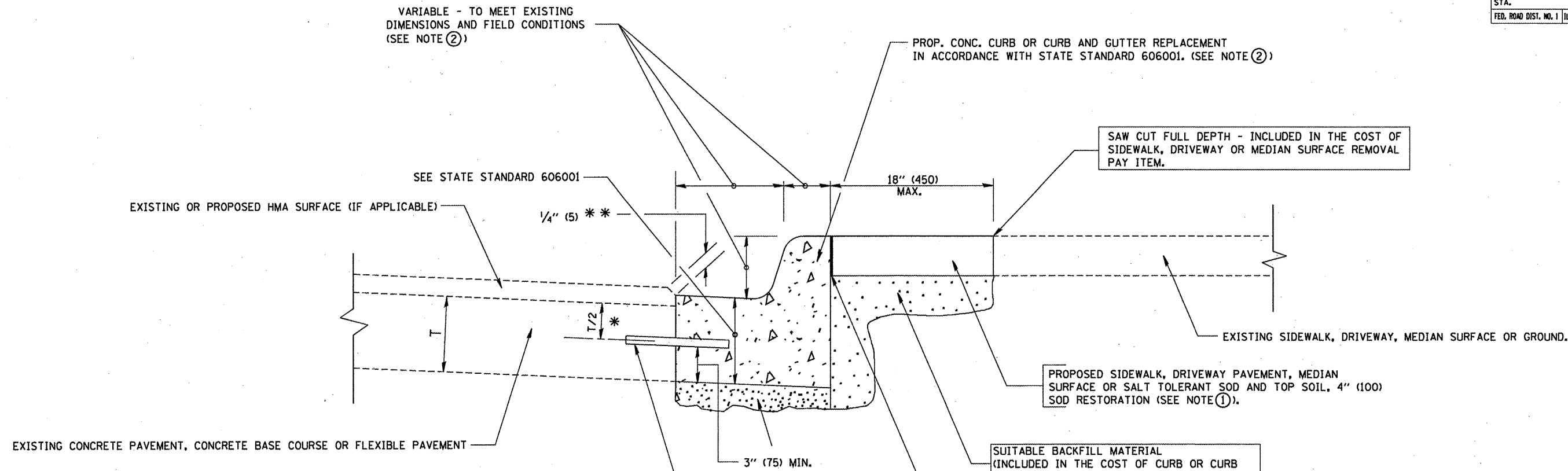

- * 3" (75) MINIMUM FROM TOP AND BOTTOM OF THE CONCRETE PAVEMENT OR BASE COURSE.
- ** IF THE FINAL SURFACE OF THE PAVEMENT IS CONCRETE, THE GUTTER IS TO BE FLUSH WITH THE PAVEMENT.

NOTE: ① SIDEWALK, DRIVEWAY PAVEMENT OR MEDIAN SURFACE SHALL BE SIMILAR TO THE MATERIAL BEING REMOVED AND WILL BE PAID FOR SEPARATELY.

SALT TOLERANT SOD AND TOP SOIL, 4" (100) RESTORATION WILL NOT BE PAID FOR SEPARATELY, BUT SHALL BE INCLUDED IN THE COST OF CURB OR CURB AND GUTTER REMOVAL AND REPLACEMENT.

- ② CURB OR CURB AND GUTTER REPLACEMENT SHALL MATCH THE SHAPE OF THE EXISTING CURB OR CURB AND GUTTER UNLESS OTHERWISE SPECIFIED.
- ③ FOR CURB OR CURB AND GUTTER REMOVAL AND REPLACEMENT ADJACENT TO FLEXIBLE PAVEMENT DELETE EPOXY COATED TIE BARS.
- ④ LONGITUDINAL BARS, IF ENCOUNTERED IN THE EXISTING CURB OR CURB AND GUTTER, ARE NOT TO BE REPLACED. CUTTING AND REMOVING LONGITUDINAL BARS SHALL BE INCLUDED IN THE COST OF CURB OR CURB AND GUTTER REMOVAL AND REPLACEMENT.
- ⑤ THE COST OF HMA SURFACE REMOVAL IN THE EXISTING GUTTER FLAG SHALL BE INCLUDED IN THE COST OF THE CURB AND GUTTER REMOVAL AND REPLACEMENT.
- ⑥ THE REMOVAL AND REPLACEMENT OF THE EXISTING CURB OR CURB AND GUTTER SHALL BE DONE IN ACCORDANCE WITH THE APPLICABLE PORTIONS OF SECTION 440 AND 606 OF THE STANDARD SPECIFICATIONS.
- ⑦ THE LOCATIONS OF REMOVAL AND REPLACEMENT OF EXISTING CURB OR CURB AND GUTTER SHALL BE DETERMINED BY THE RESIDENT ENGINEER AT THE TIME OF CONSTRUCTION.

BASIS OF PAYMENT:

THIS WORK WILL BE PAID FOR AT THE CONTRACT UNIT PRICE PER FOOT (METER) FOR "CURB REMOVAL AND REPLACEMENT" OR "COMBINATION CONCRETE CURB AND GUTTER REMOVAL AND REPLACEMENT".

ALL DIMENSIONS ARE IN INCHES (MILLIMETERS) UNLESS OTHERWISE SHOWN.

REVISIONS	
NAME	DATE
A. HOUSEH	03/11/94
R. SHAH	02/24/96
R. SHAH	03/02/96
R. SHAH	08/19/96
R. SHAH	09/12/96
R. SHAH	09/19/96
R. SHAH	10/03/96
A. ABBAS	03/21/97
M. GOMEZ	01/22/01
R. BORO	01/01/07

ILLINOIS DEPARTMENT OF TRANSPORTATION
CURB OR CURB AND GUTTER REMOVAL AND REPLACEMENT

SCALE: VERT. NONE
HORIZ.

DRAWN BY
CHECKED BY
BD600-06 (BD-24)

CURB OR CURB AND GUTTER REMOVAL AND REPLACEMENT

PLT DATE = 3/6/2007
FILE NAME = C:\Users\jg\Documents\2007-0351\12.dgn
USER NAME = jg

F.A. RTE.	SECTION	COUNTY	TOTAL SHEETS	SHEET NO.
2007-0391	Cook	15	13	
STA.		TO STA.		
FED. ROAD DIST. NO.		ILLINOIS FED. AID PROJECT		

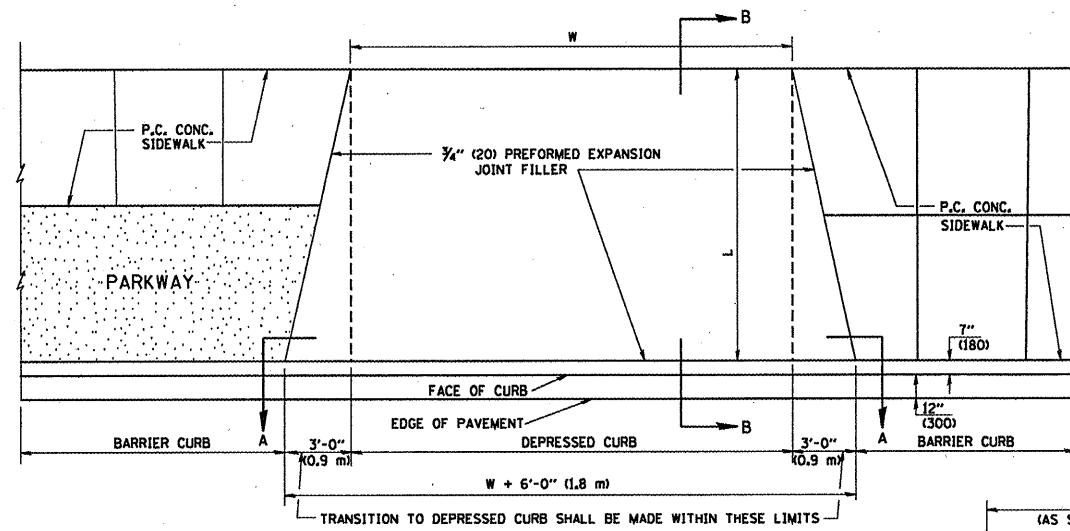

PLAN VIEW

NOTES:

1. EXPANSION JOINTS SHALL BE CONSTRUCTED AS SHOWN ON THE DETAILS FOR P.C.C. SIDEWALK.
2. THE CURB BETWEEN ADJACENT DRIVEWAYS SHALL BE FULL HEIGHT FOR A DISTANCE OF AT LEAST FOUR FEET (1.2 METERS)
3. P.C. CONCRETE DRIVEWAYS SHALL BE CONSTRUCTED AT LOCATIONS SHOWN ON THE PLANS OR AS DIRECTED BY THE ENGINEER.
4. 3/4" (20) PREFORMED EXPANSION JOINTS WILL NOT BE PAID FOR SEPARATELY BUT SHALL BE CONSIDERED INCIDENTAL TO P.C.C. DRIVEWAY PAVEMENT 8" (200).
5. COMBINATION CONC. CURB AND GUTTER SHALL BE MEASURED STRAIGHT ACROSS THE DRIVEWAY. NO ADDITIONAL COMPENSATION WILL BE ALLOWED FOR THE TRANSITION CURB AND GUTTER.

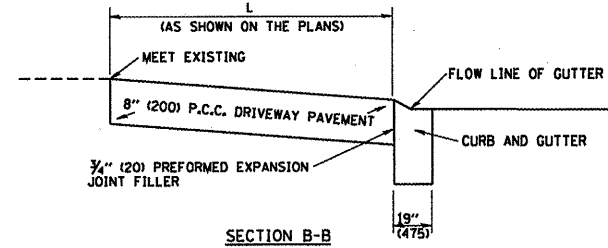

SECTION B-B

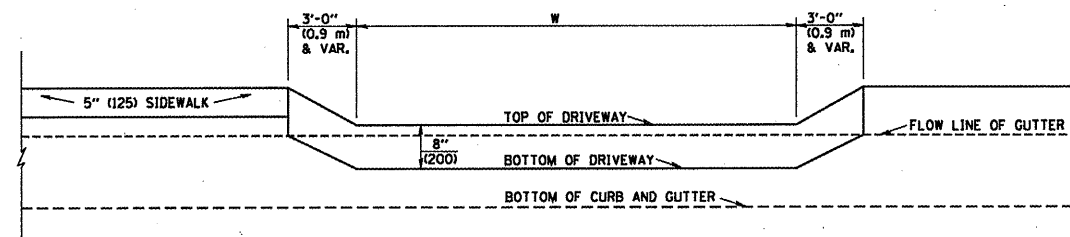

SECTION A-A

P.C.C. DRIVEWAY PAVEMENT DETAIL

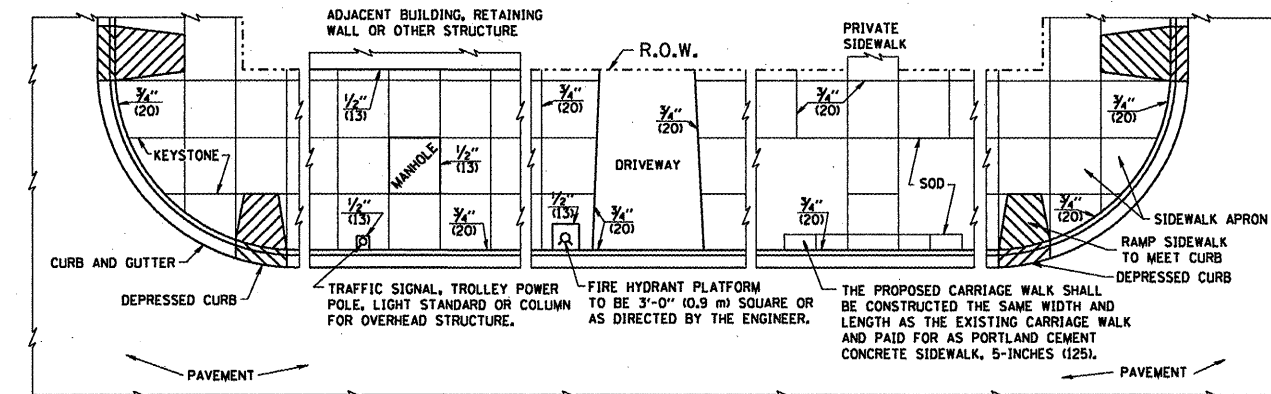

NOTES:

1. ONE-HALF INCH THICK EXPANSION JOINTS SHALL BE PLACED BETWEEN THE SIDEWALK AND ALL STRUCTURES SUCH AS LIGHT STANDARDS, TRAFFIC LIGHT STANDARDS, MANHOLES, WHICH EXTEND THROUGH THE SIDEWALK.
2. 3/4" (20) THICK EXPANSION JOINTS SHALL BE PLACED AT INTERVALS OF NOT MORE THAN 100 FEET (30 METERS) IN THE SIDEWALK, WHERE THE SIDEWALK IS CONSTRUCTED ADJACENT TO PAVEMENT OR CURB HAVING EXPANSION JOINTS, THE EXPANSION JOINTS IN THE SIDEWALK SHALL BE PLACED OPPOSITE THE EXISTING EXPANSION JOINTS AS NEARLY AS PRACTICABLE. EXPANSION JOINTS SHALL ALSO BE PLACED WHERE THE SIDEWALK ABUTS EXISTING SIDEWALKS, BETWEEN DRIVEWAY PAVEMENT AND SIDEWALK, AND BETWEEN SIDEWALK AND CURBS WHERE THE SIDEWALK ABUTS A CURB.

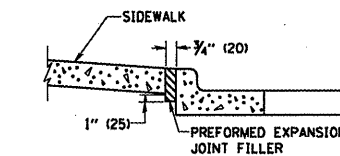

SLOPE FOR SIDEWALK
1" (25) IN 3'-0" (0.9 m) IN CHICAGO

PORTLAND CEMENT CONCRETE SIDEWALK DETAILS

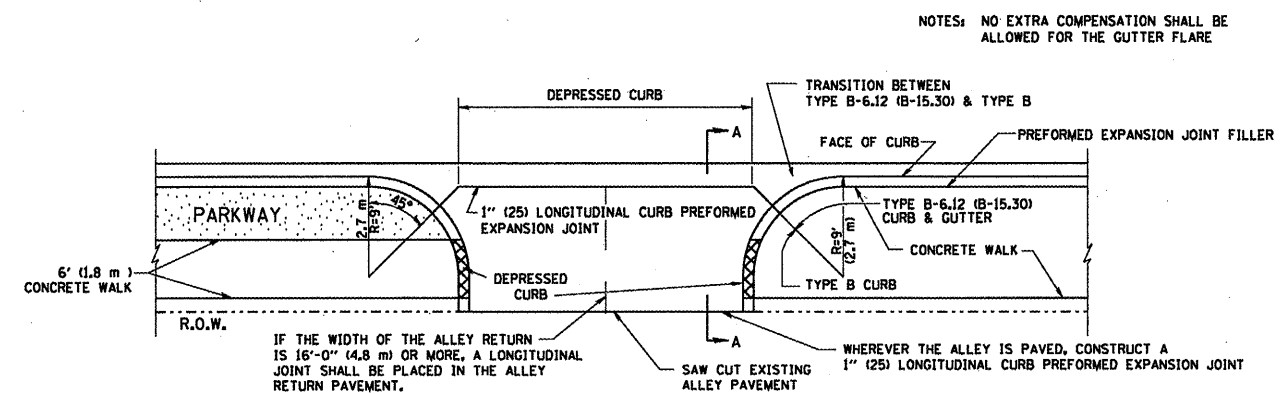

NOTES: NO EXTRA COMPENSATION SHALL BE ALLOWED FOR THE GUTTER FLARE

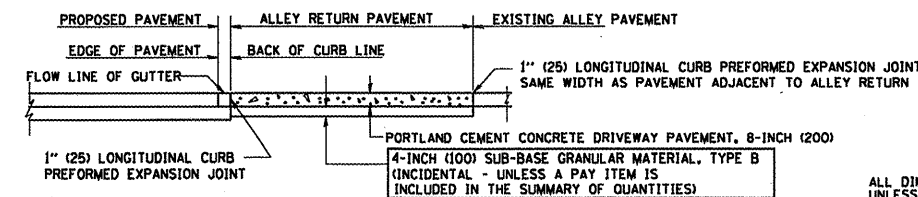

SECTION A-A

ALLEY RETURN DETAIL

REVISIONS	
NAME	DATE
M. DE YONG	06/13/90

ALL DIMENSIONS ARE IN INCHES (MILLIMETERS) UNLESS OTHERWISE SHOWN

ILLINOIS DEPARTMENT OF TRANSPORTATION
CITY OF CHICAGO
DETAILS FOR P.C. CONCRETE
DRIVEWAY, ALLEY RETURN
AND SIDEWALK

SCALE: VERT. NONE
HORIZ.

DRAWN BY
CHECKED BY

F.A. RTE.	SECTION	COUNTY	TOTAL SHEETS	SHEET NO.
	2007-035I	Cook	15	14
STA.	TO STA.			
FED. ROAD DIST. NO.	ILLINOIS	FED. AID PROJECT		

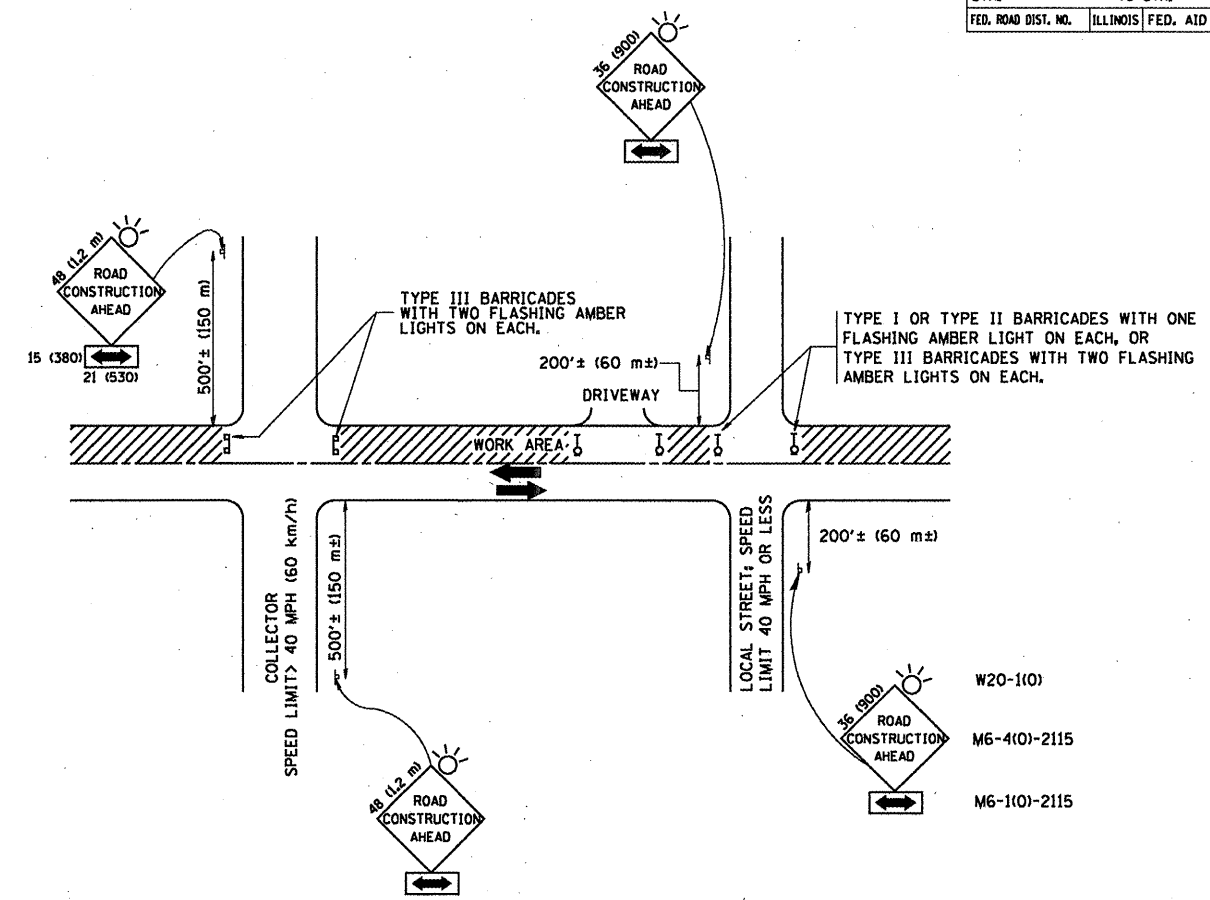

TRAFFIC CONTROL AND PROTECTION FOR SIDE ROADS, INTERSECTIONS, AND DRIVEWAYS

NOTES:

- A. FOR NO LANE RESTRICTION ON THE SIDE ROAD OR DRIVEWAYS
 1. SIDE ROAD WITH A SPEED LIMIT OF 40 MPH (60 km/h) OR LESS AS SHOWN ON THE DRAWING AND AS DIRECTED BY THE ENGINEER:
 - a) ONE ROAD CONSTRUCTION AHEAD SIGN 36 x 36 (900x900) WITH A FLASHER MOUNTED ON IT APPROXIMATELY 200' (60 m) IN ADVANCE OF THE MAIN ROUTE.
 - b) THE CLOSED PORTION OF THE MAIN ROUTE SHALL BE PROTECTED BY BLOCKING WITH TYPE I, TYPE II OR TYPE III BARRICADES, 1/3 OF THE CROSS SECTION OF THE CLOSED PORTION.
 2. SIDE ROAD WITH A SPEED LIMIT GREATER THAN 40 MPH (60 km/h) AS SHOWN ON THE DRAWING AND AS DIRECTED BY THE ENGINEER:
 - a) ONE ROAD CONSTRUCTION AHEAD SIGN 48 x 48 (1.2 m x 1.2 m) WITH A FLASHER MOUNTED ON IT APPROXIMATELY 500' (150 m) IN ADVANCE OF THE MAIN ROUTE.
 - b) THE CLOSED PORTION OF THE MAIN ROUTE SHALL BE PROTECTED BY BLOCKING WITH TYPE III BARRICADES, 1/2 OF THE CROSS SECTION OF THE CLOSED PORTION.
 3. WHEN THE SIDE ROAD LIES BETWEEN THE BEGINNING OF THE MAINLINE SIGNING AND THE WORK ZONE, A SINGLE HEADED ARROW (M6-1) SHALL BE USED IN LIEU OF THE DOUBLE HEADED ARROW (M6-4).
- B. FOR A LANE CLOSURE ON A SIDE ROAD OR DRIVEWAY:

USE APPLICABLE PORTIONS OF THE TYPICAL APPLICATION OF TRAFFIC CONTROL DEVICES (STD. 701501, STD. 701606 OR THE APPROPRIATE STANDARD). THE SPACING OF SIGNS AND BARRICADES SHALL BE ADJUSTED FOR FIELD CONDITIONS AS DIRECTED BY THE ENGINEER. THE DIRECTIONAL ARROW SHALL BE COVERED OR REMOVED WHEN NO LONGER CONSISTENT WITH THE SIDE ROAD LANE CLOSURE.
- C. ADVANCE WARNING SIGNS ARE TO BE OMITTED ON DRIVEWAY UNLESS OTHERWISE NOTED.
- D. THE TRAFFIC CONTROL AND PROTECTION FOR SIDE ROADS, INTERSECTIONS, AND DRIVEWAYS SHALL BE INCIDENTAL TO THE COST OF SPECIFIED TRAFFIC CONTROL STANDARDS OR ITEMS.

All dimensions are in millimeters (inches) unless otherwise shown.

REVISIONS		ILLINOIS DEPARTMENT OF TRANSPORTATION TRAFFIC CONTROL AND PROTECTION FOR SIDE ROADS, INTERSECTIONS, AND DRIVEWAYS
NAME	DATE	
LHA	6/89	SCALE: NONE DRAWN BY CHECKED BY TC-10
T. RAMMACHER	09/08/94	
J. OBERLE	10/18/95	
A. HOUSEH	03/06/96	
A. HOUSEH	10/15/96	
T. RAMMACHER	01/06/00	

PLOT DATE: 2/6/2007
 PLOT SCALE: 1/8"=1'-0"
 USER NAME: bward01

F.A. RTE.	SECTION	COUNTY	TOTAL SHEETS	SHEET NO.
	2007-039E	COOK	15	15
STA.		TO STA.		
FED. ROAD DIST. NO.	ILLINOIS	FED. AID PROJECT		

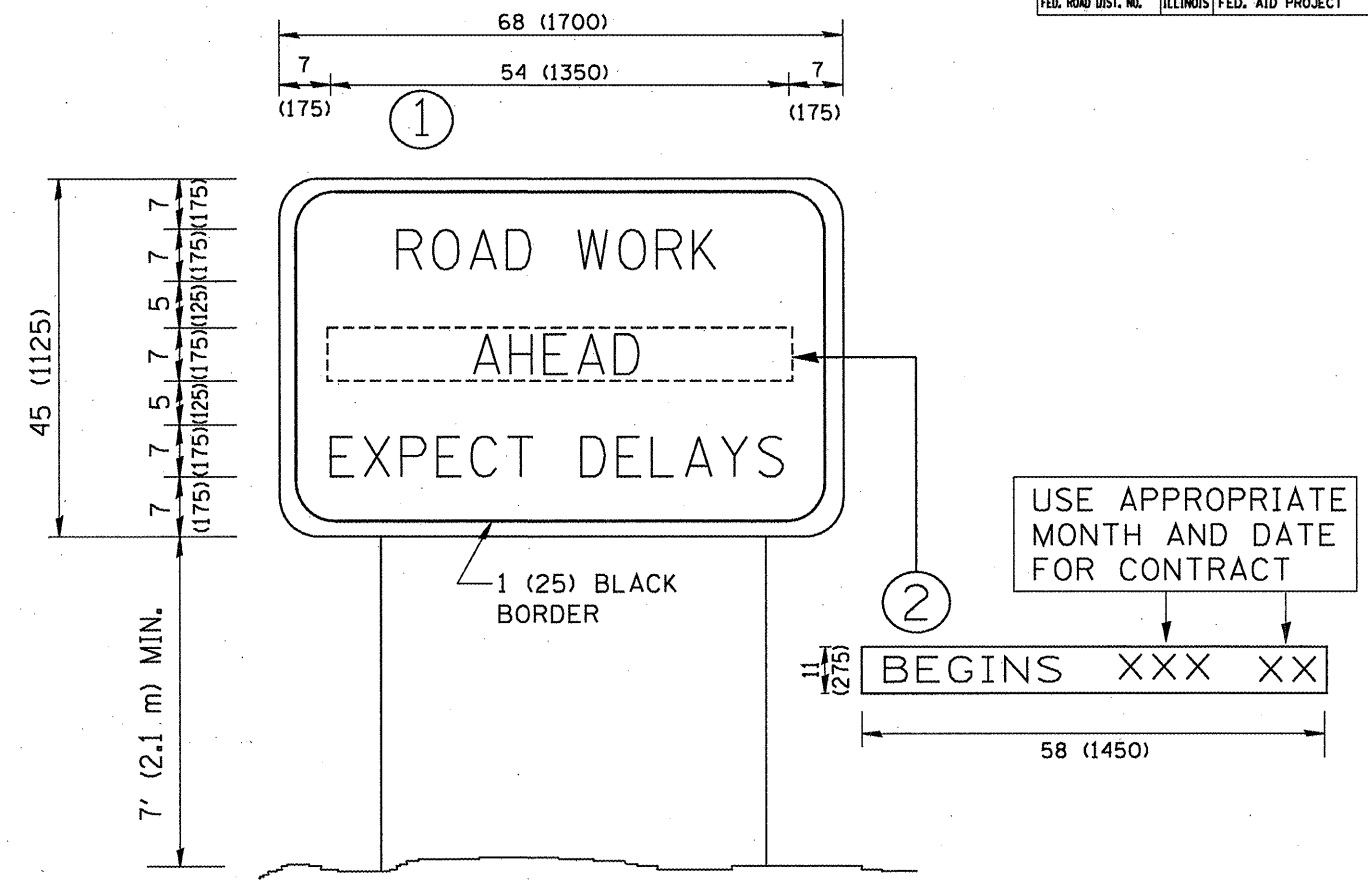

NOTES:

1. USE BLACK LETTERING ON ORANGE BACKGROUND.
2. ERECT SIGNS IN ADVANCE OF THE LOCATION FOR THE "ROAD CONSTRUCTION AHEAD" SIGN AT LOCATIONS AS DIRECTED BY THE ENGINEER.
3. ERECT SIGN ① WITH INSTALLED PANEL ② ONE WEEK PRIOR TO THE START OF CONSTRUCTION.
4. REMOVE PANEL ② SOON AFTER THE START OF CONSTRUCTION.
5. SEE SPECIAL PROVISION FOR "TEMPORARY INFORMATION SIGNING" FOR ADDITIONAL INFORMATION.
6. ONE SIGN ASSEMBLY EQUALS 25.70 SQ. FT. (2.3 SQ. M.)
7. SHALL BE PAID FOR AS TEMPORARY INFORMATION SIGNING.

ALL DIMENSIONS ARE IN INCHES (MILLIMETERS) UNLESS OTHERWISE SHOWN.

REVISIONS	
NAME	DATE
R. MIRS	9-15-97
R. MIRS	12-11-97
T. RAMMACHER	2-2-99
C. JUCIUS	1-31-07

ILLINOIS DEPARTMENT OF TRANSPORTATION
 ARTERIAL ROAD
 INFORMATION SIGN
 SCALE: NONE
 DRAWN BY DESIGN
 CHECKED BY
 TC22

PLOT DATE = 3/6/2007
 PLOT SCALE = 1/8"=1'-0"
 PLOT USER = tc22
 USER NAME = tc22