

TRAFFIC SIGNAL LEGEND

	PROPOSED	EXISTING
CONTROLLER	[Symbol]	[Symbol]
RAILROAD CONTROL CABINET	[Symbol]	[Symbol]
SERVICE INSTALLATION, (P) POLE OR (G) GROUND MOUNTED	[Symbol]	[Symbol]
SIGNAL HEAD	[Symbol]	[Symbol]
SIGNAL HEAD WITH BACKPLATE	[Symbol]	[Symbol]
SIGNAL HEAD, PEDESTRIAN	[Symbol]	[Symbol]
SIGNAL POST	[Symbol]	[Symbol]
MAST ARM ASSEMBLY AND POLE, STEEL	[Symbol]	[Symbol]
MAST ARM ASSEMBLY AND POLE, ALUMINIUM	[Symbol]	[Symbol]
COMMON TRENCH	[Symbol]	[Symbol]
UNIT DUCT	[Symbol]	[Symbol]
HANDHOLE	[Symbol]	[Symbol]
HEAVY DUTY HANDHOLE	[Symbol]	[Symbol]
DOUBLE HANDHOLE	[Symbol]	[Symbol]
G.S.CONDUIT IN TRENCH OR PUSHED	[Symbol]	[Symbol]
CAST IRON JUNCTION BOX	[Symbol]	[Symbol]
SIGNAL HEAD OPTICALLY PROGRAMMED	[Symbol]	[Symbol]
CONDUIT SPLICE	[Symbol]	[Symbol]
WOOD POLE	[Symbol]	[Symbol]
RACEWAY FOR MAGNETIC DETECTOR, TYPE I OR TYPE II	[Symbol]	[Symbol]
VEHICLE DETECTOR, NON COMPENSATED MAGNETIC TYPE	[Symbol]	[Symbol]
RAILROAD CONTROL CABINET	[Symbol]	[Symbol]
ILLUMINATED SIGN, FIBER OPTIC "NO LEFT TURN"	[Symbol]	[Symbol]
ILLUMINATED SIGN, FIBER OPTIC "NO RIGHT TURN"	[Symbol]	[Symbol]
TELEPHONE CONNECTION	[Symbol]	[Symbol]
PEDESTRIAN PUSHBUTTON DETECTOR	[Symbol]	[Symbol]
DETECTOR LOOP, TYPE I	[Symbol]	[Symbol]
PERFORMED DETECTOR LOOP	[Symbol]	[Symbol]
VIDEO DETECTOR	[Symbol]	[Symbol]
CLOSED CIRCUIT TV	[Symbol]	[Symbol]
EMERGENCY VEHICLE SYSTEM DETECTOR	[Symbol]	[Symbol]
CONFIRMATION BEACON	[Symbol]	[Symbol]
UNINTERRUPTABLE POWER SUPPLY	[Symbol]	[Symbol]
WIRELESS INTERCONNECT (ANTENNA)	[Symbol]	[Symbol]

CONSTRUCTION NOTES:

- REMOVE EXISTING CONTROLLER AND REPLACE WITH NEW CONTROLLER WITH UPS USING EXISTING FOUNDATION. RELOCATION OF EXISTING EVP PHASING UNIT SHALL BE INCLUDED IN THE UNIT COST OF NEW CONTROLLER AND CABINET PAY ITEM.
- REMOVE EXISTING SIGNAL HEAD, 1-FACE, 3-SECTION, MAST ARM MOUNTED. INSTALL NEW SIGNAL HEAD, 12" L.E.D., 1-FACE, 3-SECTION, MAST ARM MOUNTED. RE-USE EXISTING CABLE.
- REMOVE EXISTING SIGNAL HEAD, 1-FACE, 3-SECTION, BRACKET MOUNTED. INSTALL NEW SIGNAL HEAD, 12" L.E.D., 1-FACE, 3-SECTION, BRACKET MOUNTED. RE-USE EXISTING CABLE.
- REMOVE EXISTING SIGNAL HEAD, 1-FACE, 5-SECTION, MAST ARM MOUNTED. INSTALL NEW SIGNAL HEAD, 12" L.E.D., 1-FACE, 5-SECTION, MAST ARM MOUNTED. RE-USE EXISTING CABLE.
- REMOVE EXISTING SIGNAL HEAD, 2-FACE, 1-3 SECTION, 1-5 SECTION, BRACKET MOUNTED. INSTALL NEW SIGNAL HEAD, 12" L.E.D., 1-FACE, 5-SECTION, BRACKET MOUNTED. REMOVE EXISTING 5C CABLE AND RE-USE EXISTING 7C CABLE.
- INSTALL NEW PEDESTRIAN SIGNAL HEAD, 12" L.E.D., 1-FACE, BRACKET MOUNTED. INSTALL NEW ELECTRIC CABLE IN CONDUIT, SIGNAL NO. 14 3C.
- INSTALL NEW PEDESTRIAN PUSH-BUTTON. INSTALL NEW ELECTRIC CABLE IN CONDUIT, SIGNAL NO. 14 2C.

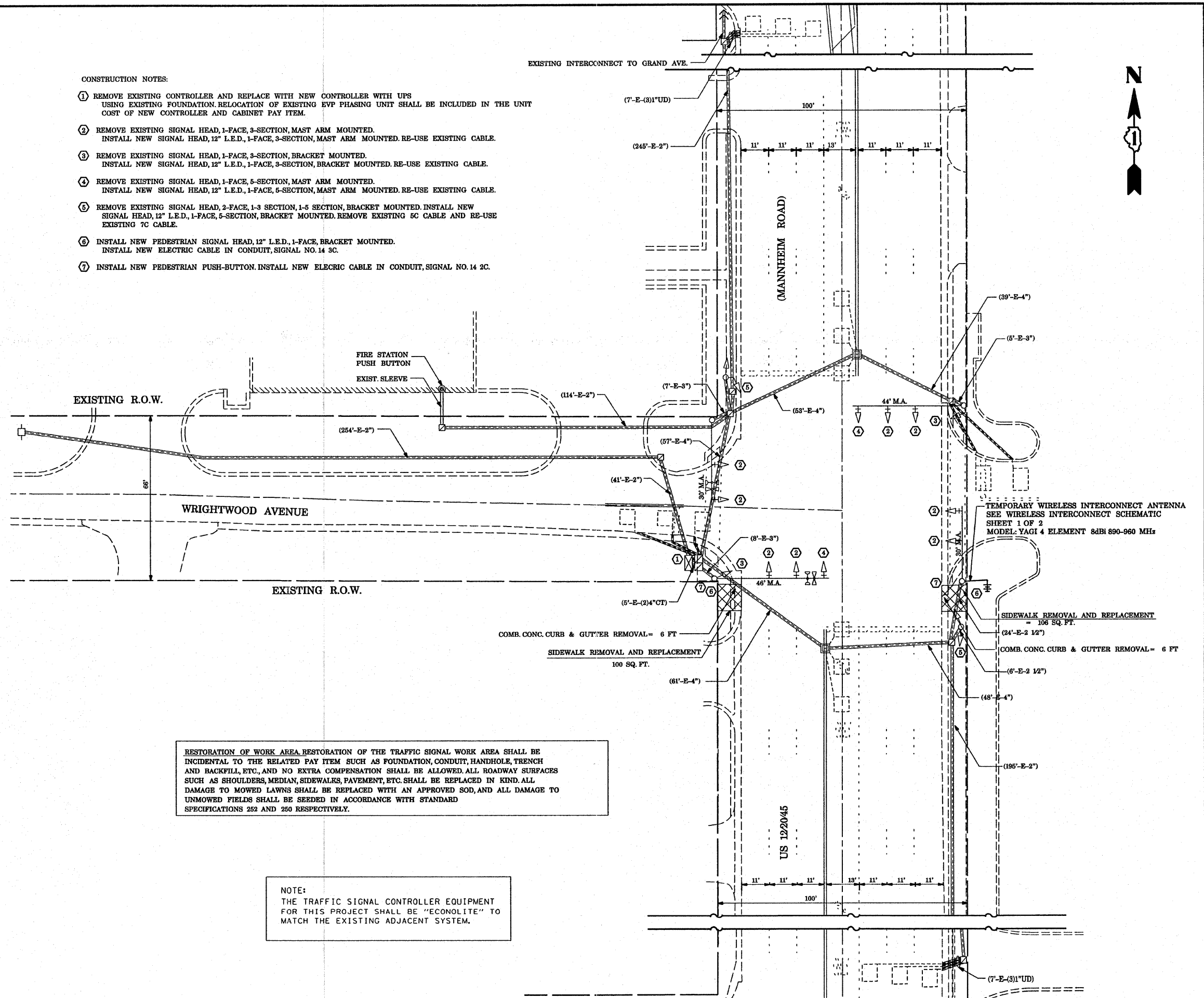

RESTORATION OF WORK AREA RESTORATION OF THE TRAFFIC SIGNAL WORK AREA SHALL BE INCIDENTAL TO THE RELATED PAY ITEM SUCH AS FOUNDATION, CONDUIT, HANDHOLE, TRENCH AND BACKFILL, ETC., AND NO EXTRA COMPENSATION SHALL BE ALLOWED. ALL ROADWAY SURFACES SUCH AS SHOULDERS, MEDIAN, SIDEWALKS, PAVEMENT, ETC. SHALL BE REPLACED IN KIND. ALL DAMAGE TO MOWED LAWNS SHALL BE REPLACED WITH AN APPROVED SOD, AND ALL DAMAGE TO UNMOWED FIELDS SHALL BE SEEDING IN ACCORDANCE WITH STANDARD SPECIFICATIONS 252 AND 250 RESPECTIVELY.

NOTE:
THE TRAFFIC SIGNAL CONTROLLER EQUIPMENT FOR THIS PROJECT SHALL BE "ECONOLITE" TO MATCH THE EXISTING ADJACENT SYSTEM.

THE FOLLOWING EXISTING TRAFFIC SIGNAL EQUIPMENT SHALL BE REMOVED BY THE CONTRACTOR, SHALL REMAIN THE PROPERTY OF THE STATE AND SHALL BE DELIVERED BY THE CONTRACTOR TO THE STATE'S TRAFFIC SIGNAL MAINTENANCE CONTRACTOR'S MAIN FACILITY AS PER THE TRAFFIC SIGNAL SPECIFICATIONS.

- 1 EACH FULL-ACTUATED CONTROLLER AND TYPE IV CABINET
- 10 EACH TRAFFIC SIGNAL BACKPLATE
- 8 EACH SIGNAL HEAD, L.E.D., 1-FACE, 3-SECTION, MAST ARM MOUNTED.
- 2 EACH SIGNAL HEAD, L.E.D., 1-FACE, 3-SECTION, BRACKET MOUNTED.
- 2 EACH SIGNAL HEAD, L.E.D., 1-FACE, 5-SECTION, MAST ARM MOUNTED.
- 2 EACH SIGNAL HEAD, L.E.D., 2-FACE, 1-3 SECTION AND 1-5 SECTION, BRACKET MOUNTED.

FILE NAME =	USER NAME = kentaphixjbc	DESIGNED - N.B.	REVISED -	STATE OF ILLINOIS DEPARTMENT OF TRANSPORTATION	EXISTING AND REMOVAL PLAN US 1220/45 (MANNHEIM RD) AT WRIGHTWOOD AVE			F.A.P. RTE. 330	SECTION 2008-006 TS	COUNTY COOK	TOTAL SHEETS 104	SHEET NO. 18
ci:\projects\traffic\072027\us12_20_45.dgn	PLOT SCALE = 48.0000' / IN.	DRAWN - N.B.	REVISED -		SCALE: 1" = 20'	SHEET NO. OF SHEETS	STA. TO STA.	FED. ROAD DIST. NO.	ILLINOIS FED. AID PROJECT	CONTRACT NO. 60E31		
PLOT DATE = 10/10/2008	DATE - 09/04/2008	CHECKED - D.B.	REVISED -									