

CONSTRUCTION NOTES:  
 ① RE-STRIPE EXISTING THERMOPLASTIC PAVEMENT MARKING STOP LINE WITH HIGH VISIBILITY THERMOPLASTIC PAVEMENT MARKING STOP LINE 24" (TYP.)

RESTORATION OF WORK AREA RESTORATION OF THE TRAFFIC SIGNAL WORK AREA SHALL BE INCIDENTAL TO THE RELATED PAY ITEM SUCH AS FOUNDATION, CONDUIT, HANDHOLE, TRENCH AND BACKFILL, ETC., AND NO EXTRA COMPENSATION SHALL BE ALLOWED. ALL ROADWAY SURFACES SUCH AS SHOULDERS, MEDIAN, SIDEWALKS, PAVEMENT, ETC. SHALL BE REPLACED IN KIND. ALL DAMAGE TO MOWED LAWNS SHALL BE REPLACED WITH AN APPROVED SOD, AND ALL DAMAGE TO UNMOWED FIELDS SHALL BE SEEDED IN ACCORDANCE WITH STANDARD SPECIFICATIONS 252 AND 250 RESPECTIVELY.

**TRAFFIC SIGNAL LEGEND**

PROPOSED	EXISTING
CONTROLLER	
RAILROAD CONTROL CABINET	
SERVICE INSTALLATION, (P) POLE OR (G) GROUND MOUNTED	
SIGNAL HEAD	
SIGNAL HEAD WITH BACKPLATE	
SIGNAL HEAD, PEDESTRIAN	
SIGNAL POST	
MAST ARM ASSEMBLY AND POLE, STEEL	
MAST ARM ASSEMBLY AND POLE, ALUMINIUM	
COMMON TRENCH	
UNIT DUCT	
HANDHOLE	
HEAVY DUTY HANDHOLE	
DOUBLE HANDHOLE	
G.S.CONDUIT IN TRENCH OR PUSHED	
CAST IRON JUNCTION BOX	
SIGNAL HEAD OPTICALLY PROGRAMMED	
CONDUIT SPLICE	
WOOD POLE	
RACEWAY FOR MAGNETIC DETECTOR, TYPE I OR TYPE II	
VEHICLE DETECTOR, NON COMPENSATED MAGNETIC TYPE	
RAILROAD CONTROL CABINET	
ILLUMINATED SIGN, FIBER OPTIC "NO LEFT TURN"	
ILLUMINATED SIGN, FIBER OPTIC "NO RIGHT TURN"	
TELEPHONE CONNECTION	
PEDESTRIAN PUSHBUTTON DETECTOR	
DETECTOR LOOP, TYPE I	
PREFORMED DETECTOR LOOP	
VIDEO DETECTOR	
CLOSED CIRCUIT TV	
EMERGENCY VEHICLE SYSTEM DETECTOR	
CONFIRMATION BEACON	
UNINTERRUPTABLE POWER SUPPLY	
PEDESTRIAN SIGNAL HEAD WITH COUNTDOWN TIMER	

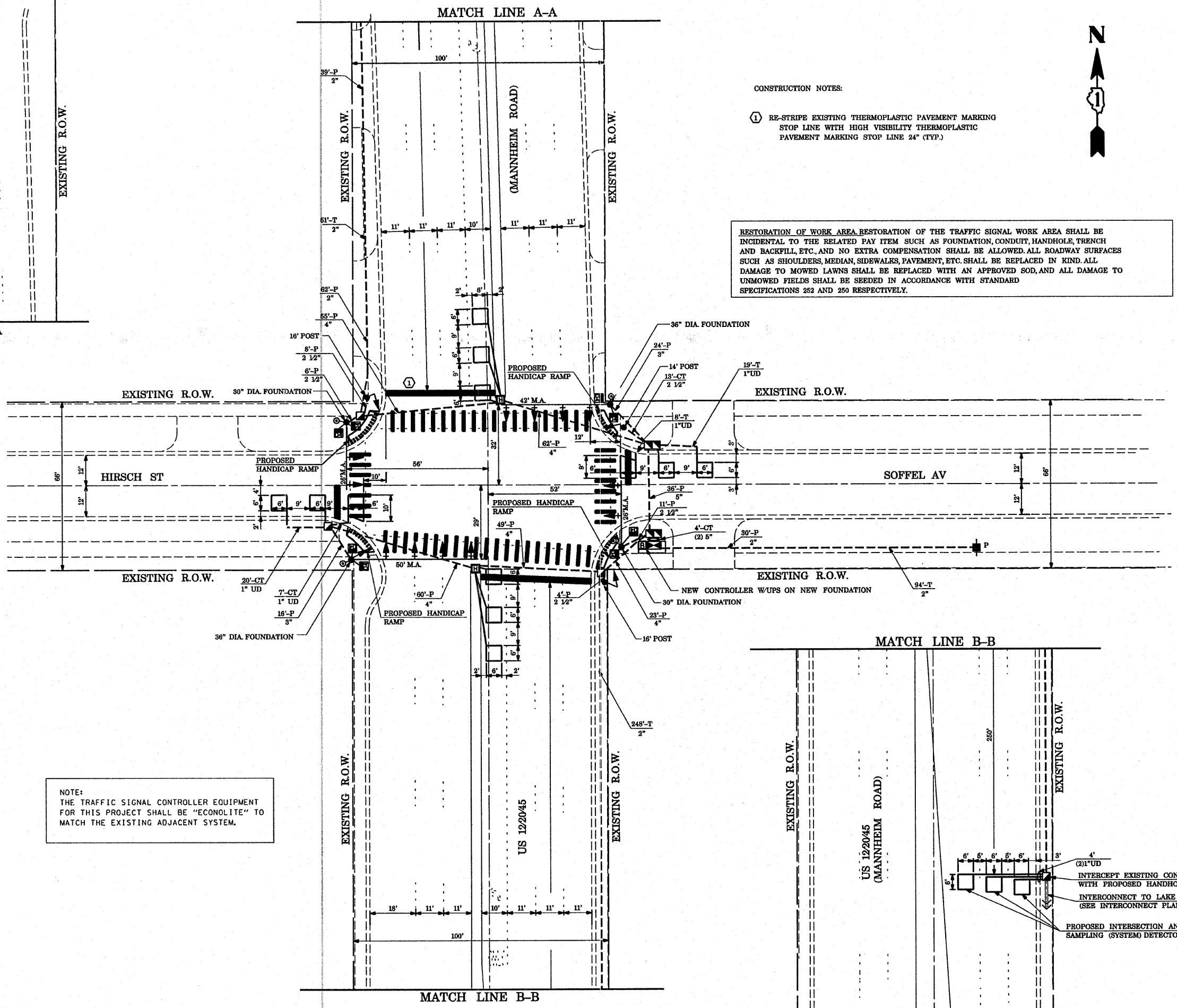

NOTE:  
 THE TRAFFIC SIGNAL CONTROLLER EQUIPMENT FOR THIS PROJECT SHALL BE "ECONOLITE" TO MATCH THE EXISTING ADJACENT SYSTEM.

FILE NAME =	USER NAME = kanthaphix@bc	DESIGNED - N.B.	REVISED -	<b>STATE OF ILLINOIS DEPARTMENT OF TRANSPORTATION</b>	<b>PROPOSED TRAFFIC SIGNAL PLAN</b>			F.A.P. RTE.	SECTION	COUNTY	TOTAL SHEETS	SHEET NO.
PROJECTS\traffic\1070027\us12_20_45.dgn		DRAWN - N.B.	REVISED -		US 12/2045 (MANNHEIM RD) AT HIRSCH ST (SOFFEL AV)			330	2008-006 TS	COOK	104	46
PLOT SCALE = 40.0000' / IN.		CHECKED - D.B.	REVISED -		SCALE: 1"=20'	SHEET NO.	OF SHEETS	STA.	TO STA.	CONTRACT NO. 60E31		
PLOT DATE = 10/10/2008		DATE = 09/04/2008	REVISED -					FED. ROAD DIST. NO.	ILLINOIS	FED. AID PROJECT		