

For Information Only

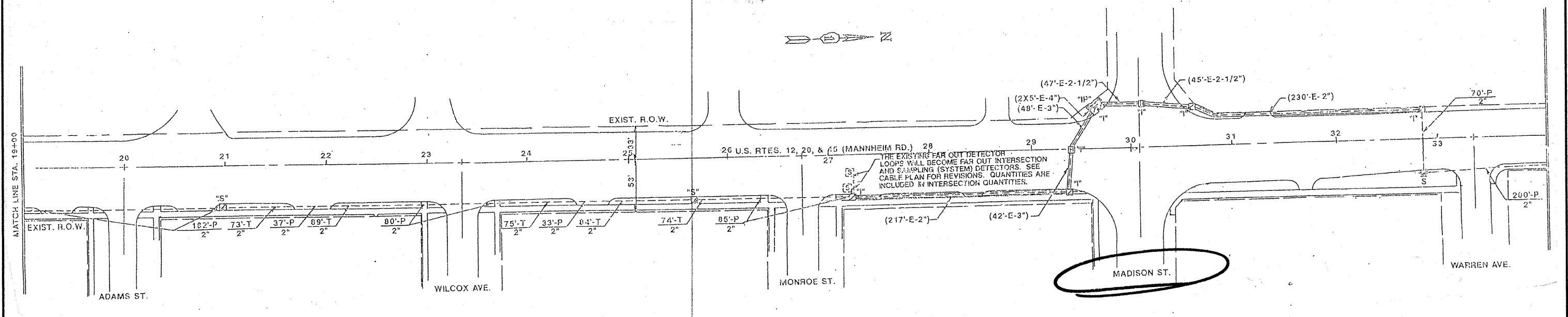

INTERCONNECT PLAN LEGEND

	PROPOSED	EXISTING
CONTROLLER		
HANDHOLE		
DOUBLE HANDHOLE		
G.S. CONDUIT IN TRENCH OR PUSHED		
DETECTOR LOOP		
COMMON TRENCH	CT	
UNIT DUCT	UD	
SYSTEM	S	
INTERSECTION	IP	
HEAVY DUTY HANDHOLE		
PUSH-PIT		

THE TRAFFIC SIGNAL CONTROL EQUIPMENT FOR THIS PROJECT SHALL BE "ECONOLITE" TO MATCH THE EXISTING ADJACENT SYSTEM.

FILE NAME =	USER NAME = kenthaphixaybc	DESIGNED - BCK	REVISED -
PROJECTS\traffic\1070027\us12_20_45.dgn		DRAWN - BCK	REVISED -
PLOT SCALE = 40,0000' / IN.		CHECKED - DAD	REVISED -
PLOT DATE = 4/16/2008		DATE -	REVISED -

STATE OF ILLINOIS  
DEPARTMENT OF TRANSPORTATION

INTERCONNECT PLAN US 12/2045 (MANNHEIM) CONGRESS STREET			
SCALE: 1"=20'	SHEET NO.	OF SHEETS	STA. TO STA.

F.A.P. RTE.	SECTION	COUNTY	TOTAL SHEETS	SHEET NO.
330	2008-006 TS	COOK	104	99
FED. ROAD DIST. NO. ILLINOIS FED. AID PROJECT			CONTRACT NO. 60E31	