

INTERCONNECT SCHEDULE OF QUANTITIES

QUANTITY	UNIT	ITEM
2367	FOOT	ELECTRIC CABLE IN CONDUIT, TRACER NO.14 1C
2367	FOOT	FIBER OPTIC CABLE IN CONDUIT, NO. 62.5125, MM12F & SM12F
2367	FOOT	REMOVE ELECTRIC CABLE FROM CONDUIT

INTERCONNECT SCHEMATIC LEGEND

	INTERSECTION CONTROLLER		EXISTING LOOP DETECTOR CABLE-2C TWISTED, SHIELDED
	EXISTING INTERSECTION CONTROLLER		TELEPHONE CONNECTION
	MASTER CONTROLLER		PROPOSED TRACER CABLE NO.14 1C
	EXISTING MASTER CONTROLLER		EXISTING INTERSECTION LOOP DETECTORS AND PROPOSED SAMPLING (SYSTEM) DETECTORS
	MASTER MASTER CONTROLLER		EXISTING TELEPHONE CONNECTION
	PROPOSED INTERSECTION & SAMPLING (SYSTEM) DETECTORS		EXISTING TRACER CABLE 1C (AS SPECIFIED)
	EXISTING INTERSECTION & SAMPLING (SYSTEM) DETECTORS		EXISTING SAMPLING (SYSTEM) DETECTORS
	PROPOSED FIBER OPTIC CABLE- NO.62.5125 2-MM12F & SM12F		PROPOSED SAMPLING (SYSTEM) DETECTORS
	INTERCONNECT CABLE-NO.18 3 PAIR TWISTED, SHIELDED		EXISTING SAMPLING (SYSTEM) DETECTORS, PROPOSED INTERSECTION AND SAMPLING (SYSTEM) DETECTORS.
	LOOP DETECTOR CABLE-2C TWISTED, SHIELDED		EXISTING INTERCONNECT CABLE-NO. 62.5125 12F FIBER OPTIC CABLE
	EXISTING FIBER OPTIC CABLE-NO. 62.5125 2-MM12F & SM12F		
	EXISTING INTERCONNECT CABLE-NO.18 3 PAIR TWISTED, SHIELDED		

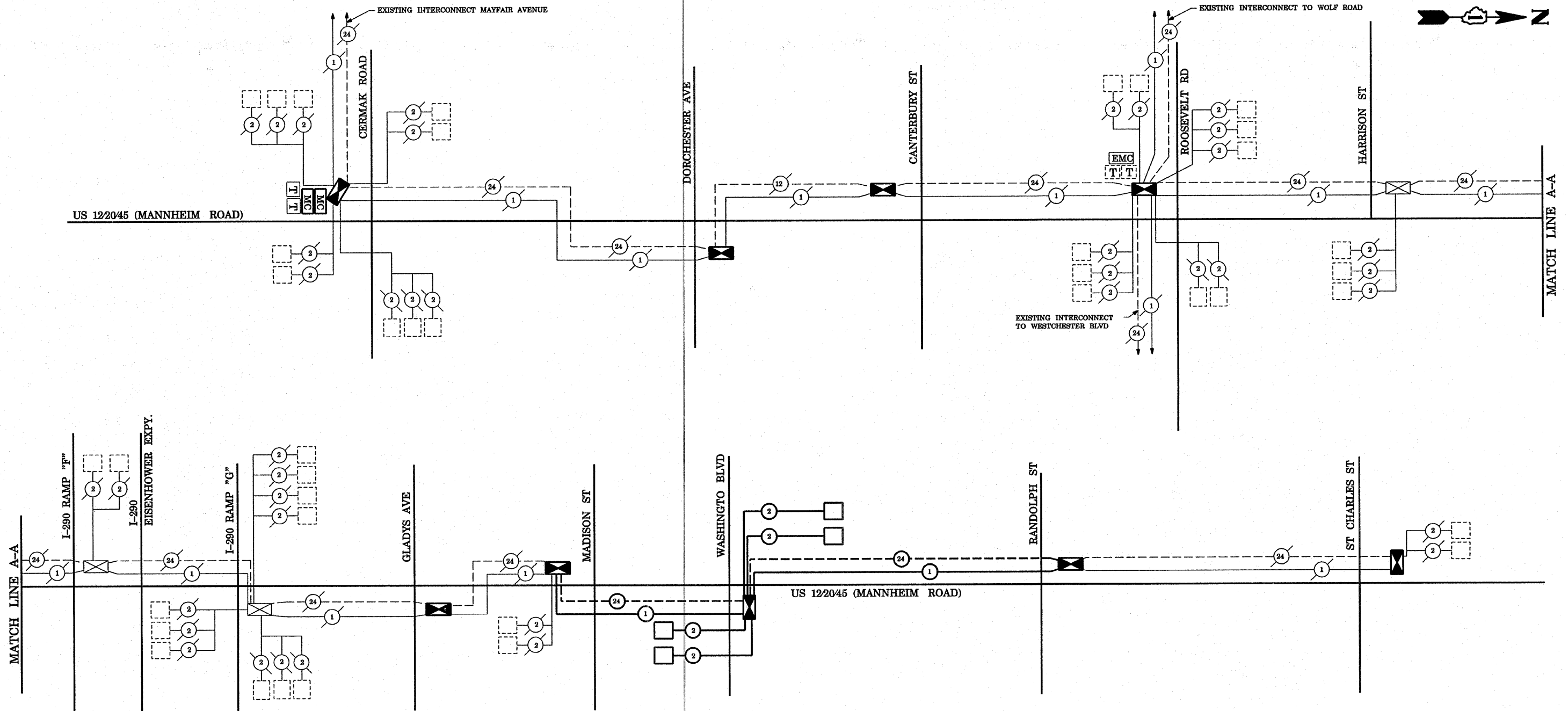

FILE NAME =	USER NAME = kenthaphixaybc	DESIGNED - N.B.	REVISED -
ci:\projects\traffic\1070027\us12_20_45.dgn		DRAWN - N.B.	REVISED -
PLOT SCALE = 40.0000 "/> <td></td> <td>CHECKED - D.B.</td> <td>REVISED -</td>		CHECKED - D.B.	REVISED -
PLOT DATE = 10/10/2008		DATE - 09/04/2008	REVISED -

**STATE OF ILLINOIS
DEPARTMENT OF TRANSPORTATION**

**INTERCONNECT SCHEMATIC (SHEET 2 OF 2)
US 12/2045 (MANNHEIM RD)
FROM CERMAK ROAD TO ST. CHARLES ROAD**

SCALE: 1"=20' SHEET NO. OF SHEETS STA. TO STA.

F.A.P. RTE.	SECTION	COUNTY	TOTAL SHEETS	SHEET NO.
330	2008-006 TS	COOK	104	102
CONTRACT NO. 60E31				
FED. ROAD DIST. NO. [ILLINOIS] FED. AID PROJECT				