

NOTE:
REMOVE THE EXISTING LIGHT POLE, MAST ARM, 400 WATT LUMINARE AND TRANSFORMER BASS TO RELOCATE IT TO THE PROPOSED LOCATION.

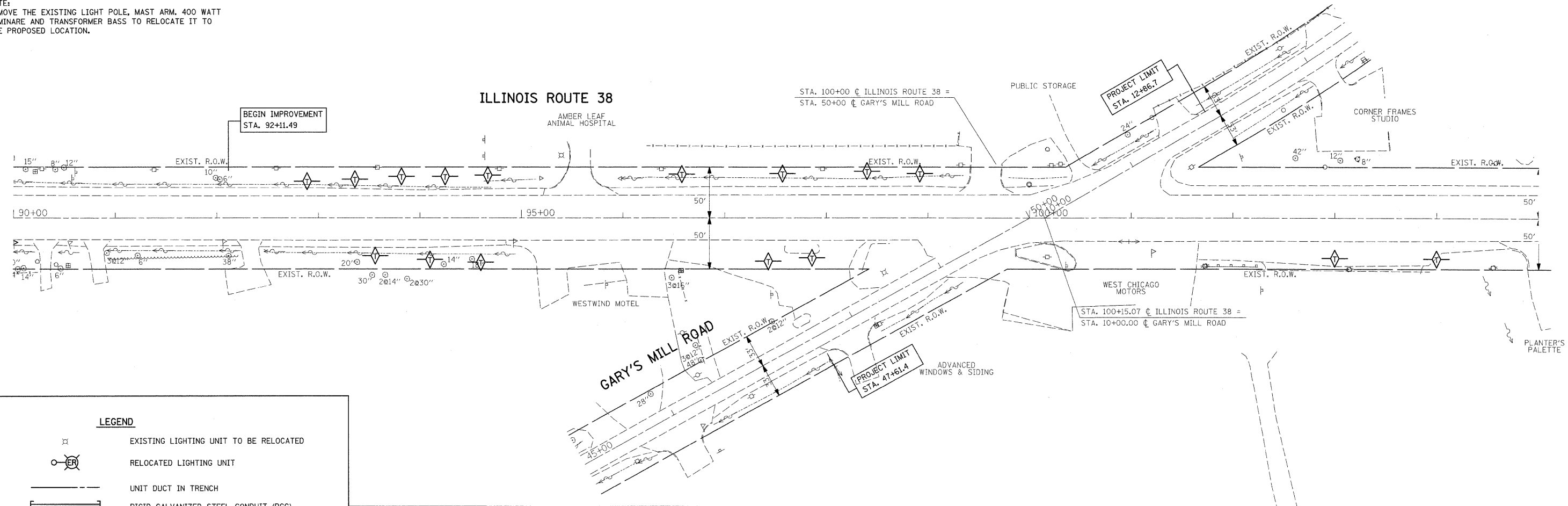

LEGEND

- EXISTING LIGHTING UNIT TO BE RELOCATED
- RELOCATED LIGHTING UNIT
- UNIT DUCT IN TRENCH
- RIGID GALVANIZED STEEL CONDUIT (RGC)
- UTILITY POLE

NOTE:
THE 4" DIAMETER PUSHED RIGID GALVANIZED STEEL CONDUIT SHALL EXTEND 3 FEET BEYOND BACK OF CURB OR EDGE OF PAVED SURFACE

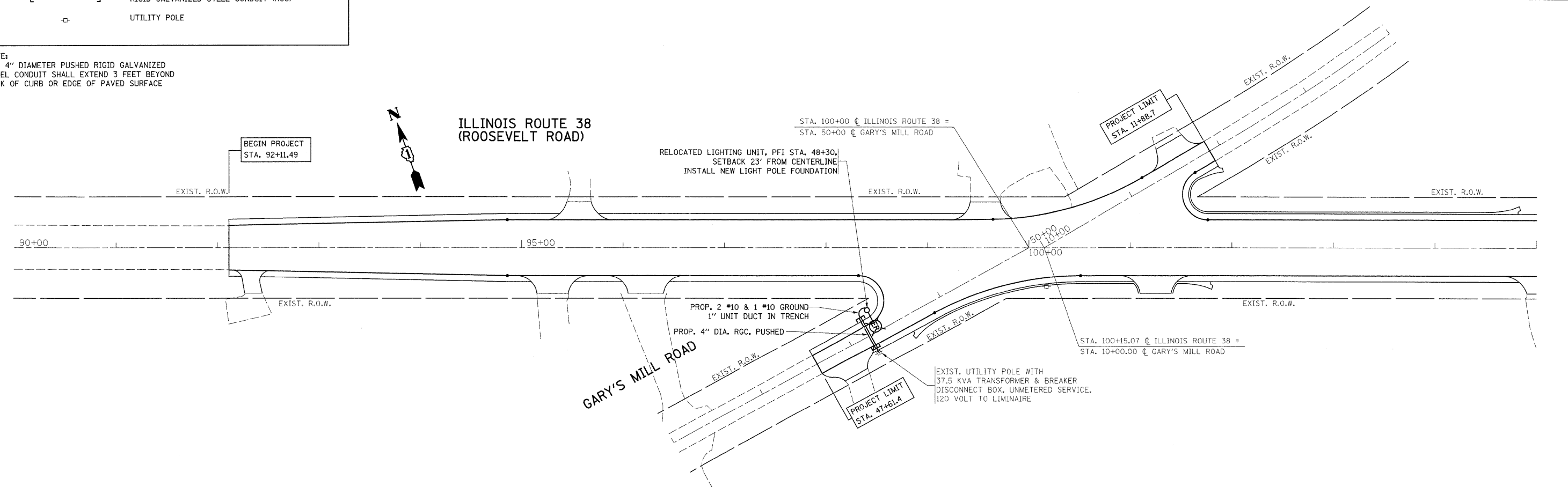

FILE NAME = P132607-shr-light.dgn

USER NAME = ulrichkd

DESIGNED -

REVISED -

DRAWN -

REVISED -

PLOT SCALE = 50.0000' / IN.

CHECKED -

REVISED -

PLOT DATE = 3/16/2009

DATE -

REVISED -

**STATE OF ILLINOIS
DEPARTMENT OF TRANSPORTATION**

**IL. ROUTE 38 AT GARY'S MILL ROAD
EXIST. & PROP. LIGHTING PLAN**

SCALE: 1"=50' SHEET NO. OF SHEETS STA. TO STA.

F.A.P. RTE. 347	SECTION 2 Y-N	COUNTY DUPAGE	TOTAL SHEETS 40	SHEET NO. 20
FED. ROAD DIST. NO. ILLINOIS FED. AID PROJECT			CONTRACT NO. 60E65	