

SECTION	COUNTY	TOTAL SHEETS	SHEET NO.
44RS-1	LAKE	25	11
STA. TO STA.			
FED. ROAD DIST. NO. 7		ILLINOIS	
		FED. AID PROJECT	

TRAFFIC SIGNAL LEGEND

	EXISTING	PROPOSED
CONTROLLER		
SERVICE INSTALLATION		
SIGNAL HEAD		
SIGNAL HEAD WITH BACKPLATE		
SIGNAL HEAD, PEDESTRIAN		
SIGNAL POST		
MAST ARM ASSEMBLY AND POLE, STEEL		
MAST ARM ASSEMBLY AND POLE, ALUMINUM		
HANDHOLE		
HEAVY DUTY HANDHOLE		
DOUBLE HANDHOLE		
G.S. CONDUIT IN TRENCH OF PUSHED		
EMERGENCY VEHICLE SYSTEM DETECTOR		
CONFIRMATION BEACON		
COMMON TRENCH		
UNIT DUCT		
PEDESTRIAN PUSHBUTTON DETECTOR		
DETECTOR LOOP		

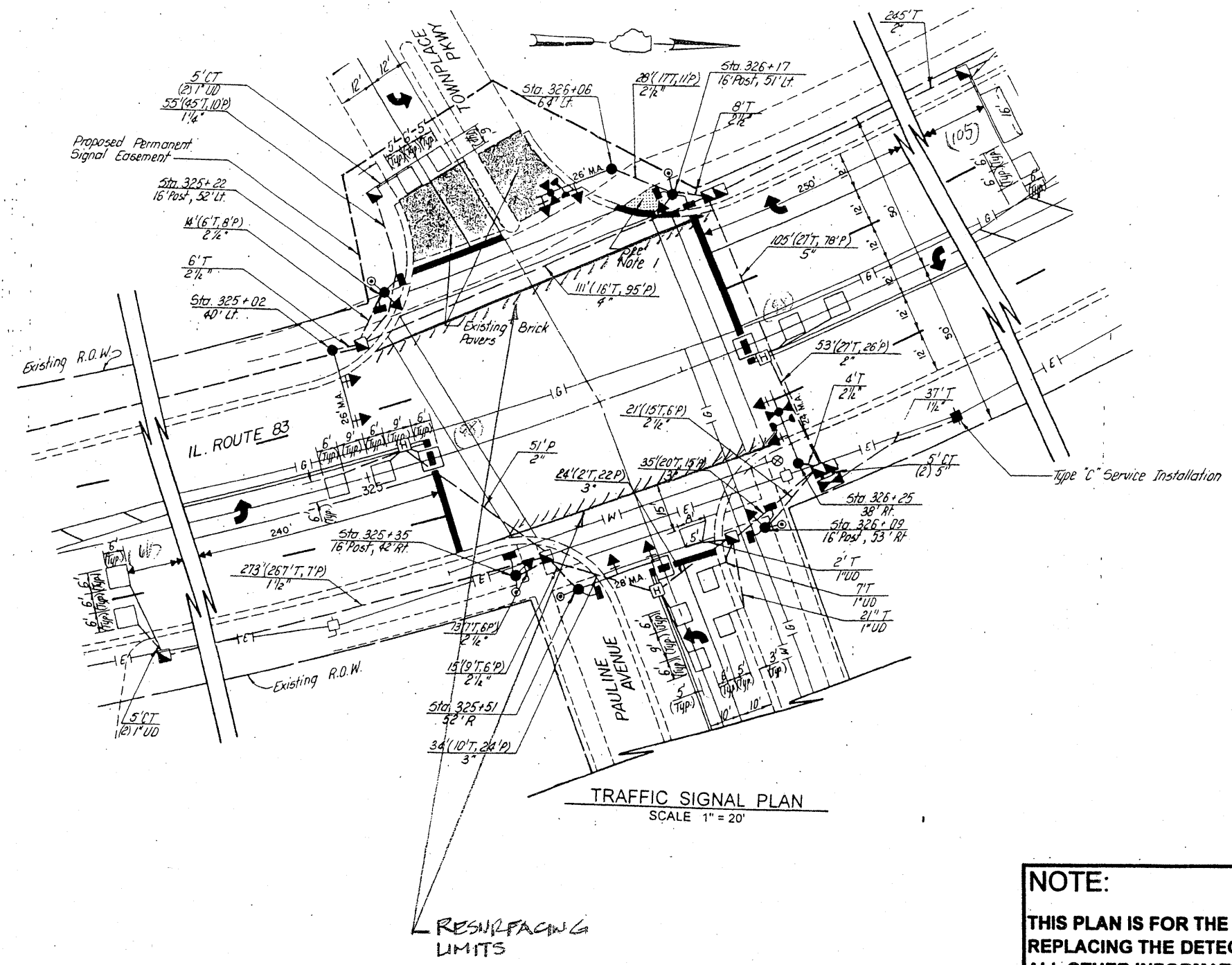

**REPLACE ALL DETECTOR LOOPS AS SHOWN**  
(WITHIN THE RESURFACING LIMITS)

CODE NO.	QUANTITY	UNIT	ITEM
80600600	367	Foot	Detector Loop Replacement

**NOTE:**  
THIS PLAN IS FOR THE PURPOSE OF REPLACING THE DETECTOR LOOPS ONLY. ALL OTHER INFORMATION SHOWN IS NOT RELATED AND WILL BE DISREGARDED.

ILLINOIS DEPARTMENT OF TRANSPORTATION  
**DETECTOR LOOP REPLACEMENT**  
ILL. ROUTE 83 @ PAULINE AVENUE

SCALE: NONE  
DATE: MAR. 2009

DRAWN BY: JHE  
DESIGNED BY: JHE  
CHECKED BY: DAD

REVISIONS	
NAME	DATE