

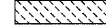

EXISTING LEGEND

-  PAVEMENT REMOVAL
-  PAVED SHOULDER REMOVAL
-  DRIVEWAY PAVEMENT REMOVAL
-  HOT-MIX ASPHALT SURFACE REMOVAL, 4"
-  TREE REMOVAL WITH UNIT DIAMETER TRUNK

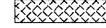

MATCH LINE SEE SHEET EX-8
WEST FRONTAGE CONNECTOR
STATION 6074+00

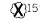
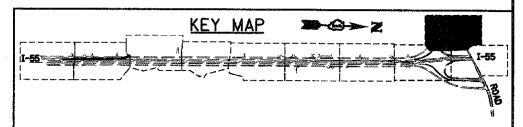
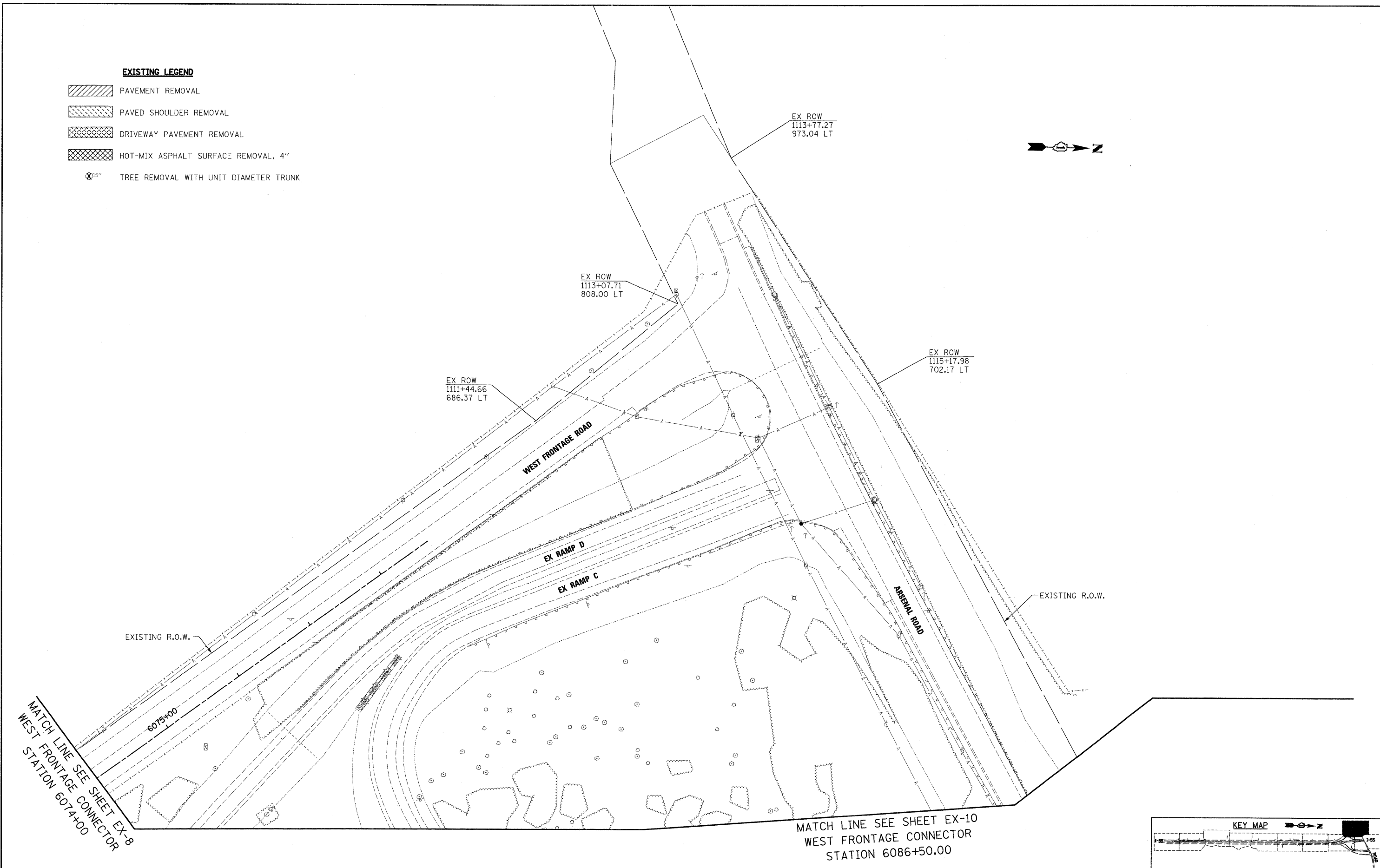
MATCH LINE SEE SHEET EX-10
WEST FRONTAGE CONNECTOR
STATION 6086+50.00

McDonough Associates Inc.
 Engineers / Architects
 130 East Randolph Street Chicago, Illinois 60601

FILE NAME = D:\6071-SHT-REM09.dgn	USER NAME = TKIuegal	DESIGNED - YSK	REVISED -	STATE OF ILLINOIS DEPARTMENT OF TRANSPORTATION	EXISTING PLAN AND REMOVALS	SCALE: 1"=50'	SHEET NO. 9 OF 10 SHEETS	STA. 6074+00.00 TO STA. 6086+50.00	F.A.I RTE. 55	SECTION 99-2HB-2-R	COUNTY WILL	TOTAL SHEETS 171	SHEET NO. 29
		DRAWN - YSK	REVISED -			FED. ROAD DIST. NO. 1 ILLINOIS FED. AID PROJECT			CONTRACT NO. 60F71				
		CHECKED - DLT	REVISED -										
		PLDT DATE = 3/19/2009	DATE = 3/20/09										

FINAL