

TYPICAL ENTRANCE/EXIT RAMP COMBINATION PAVEMENT MARKINGS

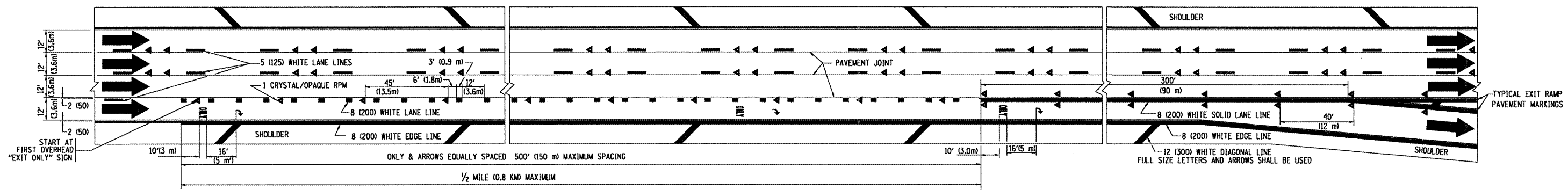

TYPICAL EXIT ONLY LANE PAVEMENT MARKINGS

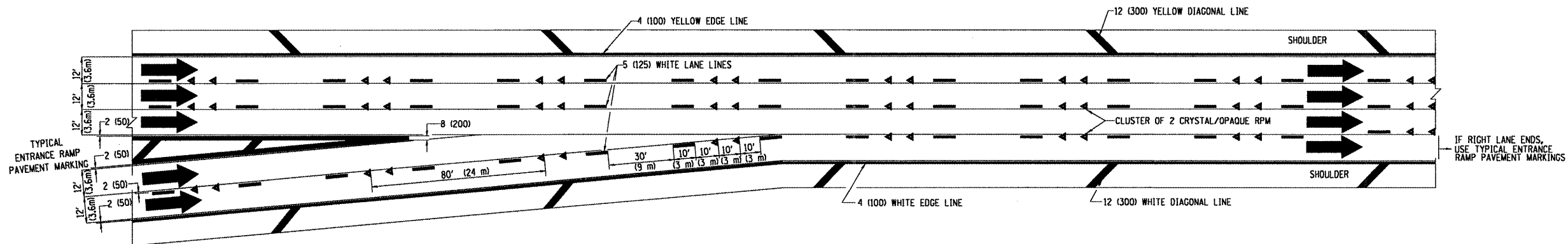

TYPICAL TWO LANE ENTRANCE RAMP PAVEMENT MARKINGS

FILE NAME =
 USER NAME = wilgreendp
 DESIGNED - D.W.S.
 DRAWN -
 PLOT SCALE = 1/8" = 1'-0"
 PLOT DATE = 3/14/2009

DESIGNED - D.W.S.
 DRAWN -
 CHECKED -
 DATE - 01-90

DESIGNED - D.W.S.
 DRAWN -
 CHECKED -
 DATE - 01-90

REVISED - A.H. 03-96
 REVISED - D.W.S. 07-96
 REVISED - J.A.F. 02-06
 REVISED - S.P.B. 01-07

**STATE OF ILLINOIS
 DEPARTMENT OF TRANSPORTATION**

**MULTI-LANE FREEWAY
 PAVEMENT MARKING DETAILS**

SCALE: NONE SHEET NO. 2 OF 2 SHEETS STA. TO STA.

F.A. RTE.	SECTION	COUNTY	TOTAL SHEETS	SHEET NO.
VAR. 2009-027 PP	TC-12	COOK	20	19
FED. ROAD DIST. NO. 1 ILLINOIS			CONTRACT NO. 60625	