

TYPICAL ENTRANCE/EXIT RAMP COMBINATION PAVEMENT MARKINGS

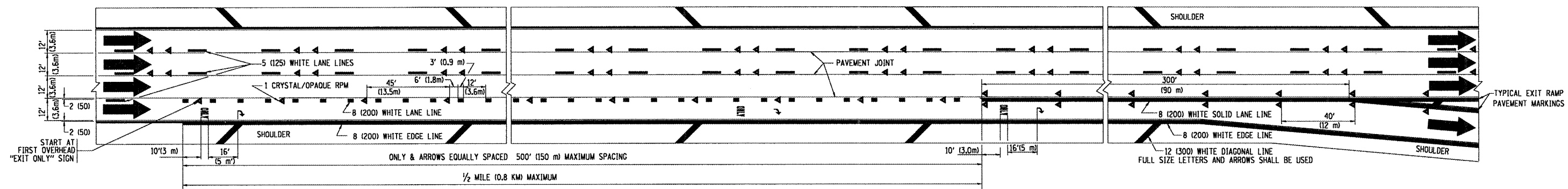

TYPICAL EXIT ONLY LANE PAVEMENT MARKINGS

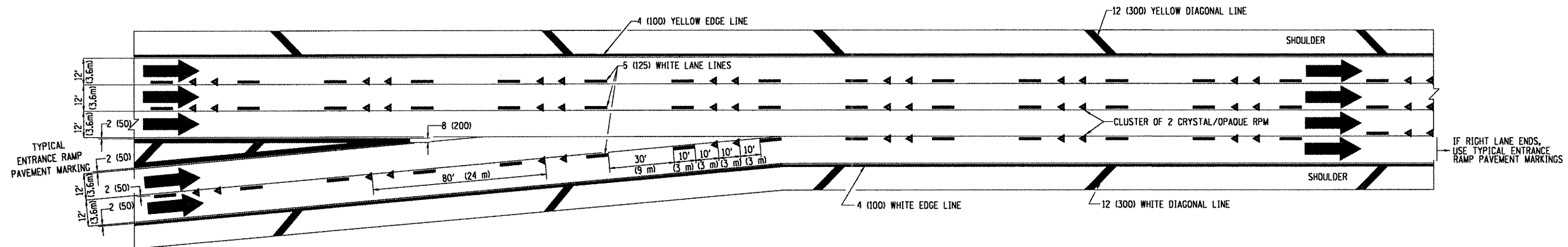

TYPICAL TWO LANE ENTRANCE RAMP PAVEMENT MARKINGS

| | | | | | | | | | | | |
|---|------------------------------|-------------------|------------------------|---|--|-------------------------|--------|---------|---|--------------------|-------|
| FILE NAME = | USER NAME = wilgreendp | DESIGNED - D.W.S. | REVISED - A.H. 03-96 | STATE OF ILLINOIS DEPARTMENT OF TRANSPORTATION | MULTI-LANE FREEWAY PAVEMENT MARKING DETAILS | | F.A. - | SECTION | COUNTY | TOTAL | SHEET |
| c:\pwwork\pawidot\wilgreendp\0125109\Di | sstd.dgn | DRAWN - | REVISED - D.W.S. 07-96 | | SCALE: NONE | SHEET NO. 2 OF 2 SHEETS | STA. | TO STA. | VAR. 2009-028 PP | DUDAGE 27 | 24 |
| | PLOT SCALE = 100.0000' / IN. | CHECKED - | REVISED - J.A.F. 02-06 | | | | | | TC-12 | CONTRACT NO. 60627 | |
| | PLOT DATE = 3/24/2009 | DATE - 01-90 | REVISED - S.P.B. 01-07 | | | | | | FED. ROAD DIST. NO. 1 [ILLINOIS] FED. AID PROJECT | | |