

CONSTRUCTION NOTES:

PRIOR TO ANY EXCAVATION, THE CONTRACTOR SHALL COORDINATE WITH THE VARIOUS UTILITIES AND CITY OF CHICAGO HEIGHTS FOR ALL BURIED UTILITIES. ALL UTILITIES WILL BE IDENTIFIED AND MARKED IN THE FIELD, CONTACT J.U.I.E. AT 1-800-892-0123.

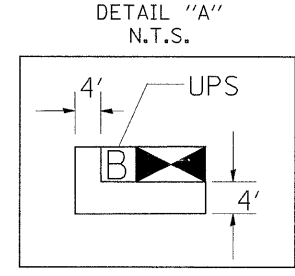
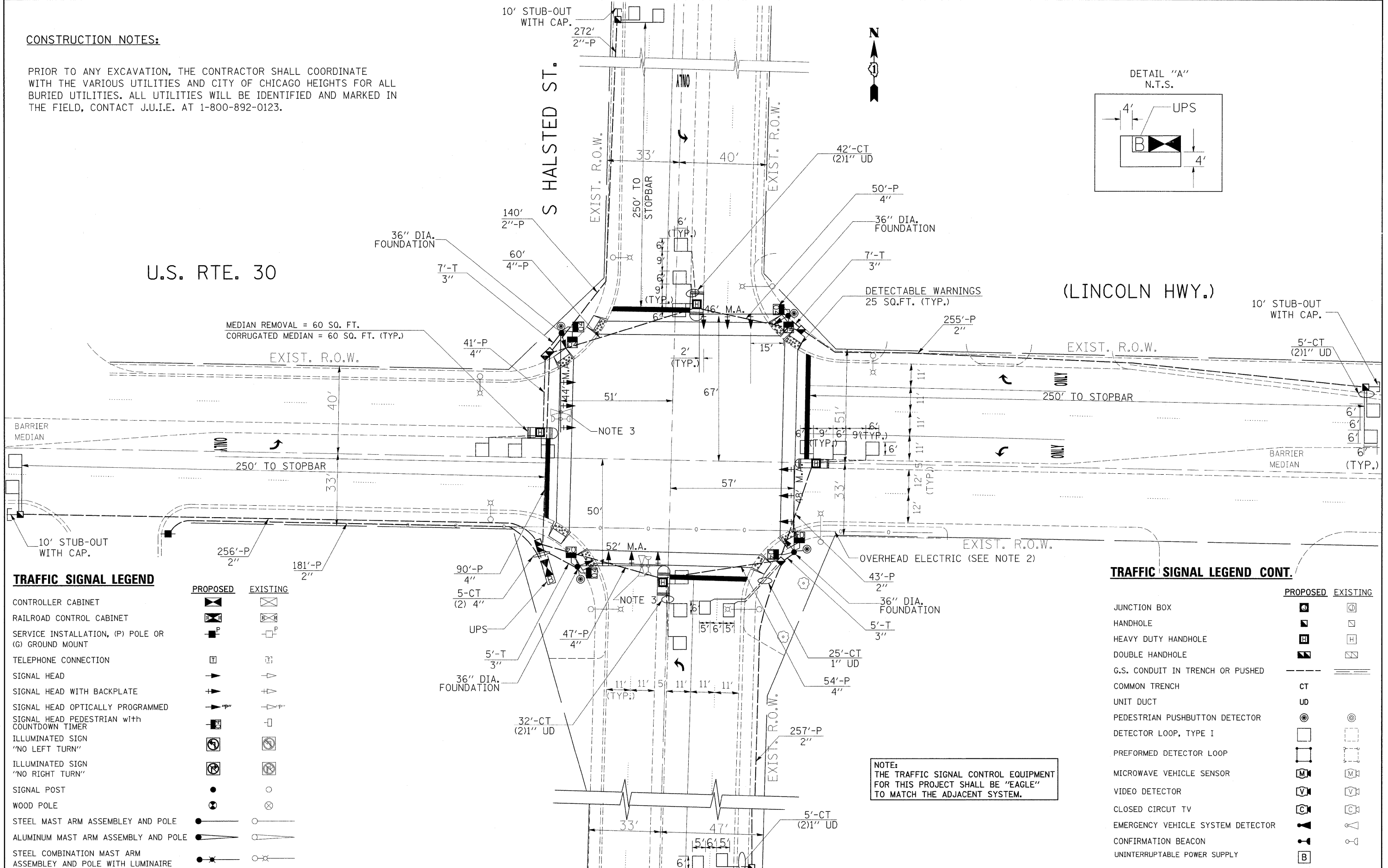

TRAFFIC SIGNAL LEGEND

| | PROPOSED | EXISTING |
|---|----------|----------|
| CONTROLLER CABINET | | |
| RAILROAD CONTROL CABINET | | |
| SERVICE INSTALLATION, (P) POLE OR (G) GROUND MOUNT | | |
| TELEPHONE CONNECTION | | |
| SIGNAL HEAD | | |
| SIGNAL HEAD WITH BACKPLATE | | |
| SIGNAL HEAD OPTICALLY PROGRAMMED | | |
| SIGNAL HEAD PEDESTRIAN with COUNTDOWN TIMER | | |
| ILLUMINATED SIGN "NO LEFT TURN" | | |
| ILLUMINATED SIGN "NO RIGHT TURN" | | |
| SIGNAL POST | | |
| WOOD POLE | | |
| STEEL MAST ARM ASSEMBLY AND POLE | | |
| ALUMINUM MAST ARM ASSEMBLY AND POLE | | |
| STEEL COMBINATION MAST ARM ASSEMBLY AND POLE WITH LUMINAIRE | | |

TRAFFIC SIGNAL LEGEND CONT.

| | PROPOSED | EXISTING |
|-----------------------------------|----------|----------|
| JUNCTION BOX | | |
| HANDHOLE | | |
| HEAVY DUTY HANDHOLE | | |
| DOUBLE HANDHOLE | | |
| G.S. CONDUIT IN TRENCH OR PUSHED | | |
| COMMON TRENCH | CT | |
| UNIT DUCT | UD | |
| PEDESTRIAN PUSHBUTTON DETECTOR | | |
| DETECTOR LOOP, TYPE I | | |
| PERFORMED DETECTOR LOOP | | |
| MICROWAVE VEHICLE SENSOR | | |
| VIDEO DETECTOR | | |
| CLOSED CIRCUIT TV | | |
| EMERGENCY VEHICLE SYSTEM DETECTOR | | |
| CONFIRMATION BEACON | | |
| UNINTERRUPTABLE POWER SUPPLY | B | |

NOTE:
THE TRAFFIC SIGNAL CONTROL EQUIPMENT FOR THIS PROJECT SHALL BE "EAGLE" TO MATCH THE ADJACENT SYSTEM.